

A STREET VACATION AND DEDICATION PLAT TO LEHI CITY
ASHTON BLVD. ROAD DEDICATION PLAT
LOCATED IN THE NORTHWEST QUARTER OF SECTION 6, TOWNSHIP 5 SOUTH,
RANGE 1 EAST, SALT LAKE BASE AND MERIDIAN

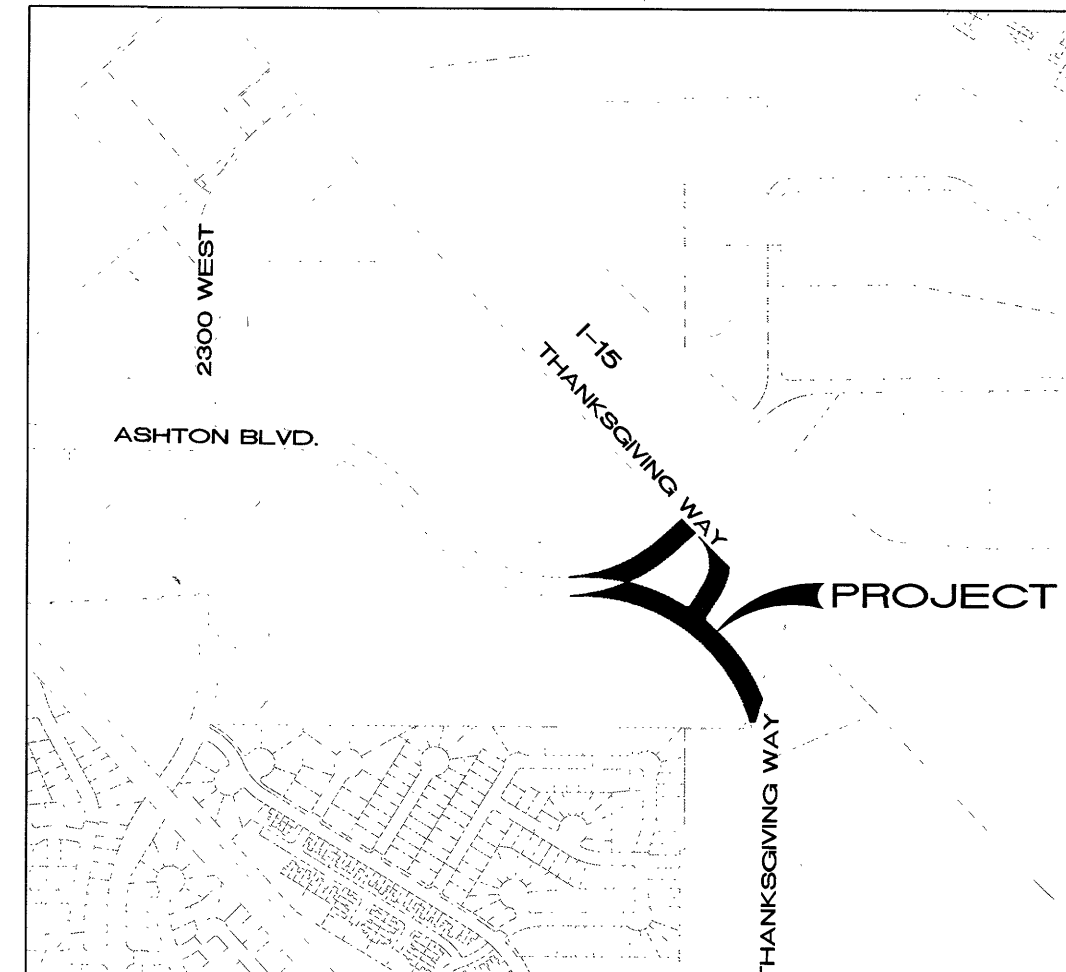

VACINITY MAP

VACATED DESCRIPTION
Commencing at a point which is South 00°14'20" East 705.49 feet along the section line and East 2177.94 feet from the Northeast Corner of Section 6, Township 5 South, Range 1 East, Salt Lake Base and Meridian; thence Northeastly 425.93 feet along the arc of a 635.00 foot radius curve to the left, through a central angle of 38°25'54" the cord of which bears North 66°46'24" East 417.99 feet; thence North 47°33'28" East 119.47 feet; thence South 44°29'47" East 80.05 feet; thence South 47°33'27" West 122.34 feet; thence Southwesterly 231.24 feet along the arc of a 715.00 foot radius curve to the right, through a central angle of 18°31'50" the cord of which bears South 56°49'22" West 230.24 feet; thence Northwesterly 247.17 feet along the arc of a 815.00 foot radius curve to the left, through a central angle of 17°22'36" the cord of which bears North 85°17'51" West 246.23 feet to the point of beginning.
Parcel contains: 0.75 acres

SURVEYOR'S CERTIFICATE
I, TRAVIS TRANE, DO HEREBY CERTIFY THAT I AM A REGISTERED LAND SURVEYOR, AND THAT I HOLD CERTIFICATE NO. 5152741 AS PRESCRIBED UNDER THE LAWS OF THE STATE OF UTAH. I FURTHER CERTIFY BY AUTHORITY OF THE OWNERS, I HAVE MADE A SURVEY OF THE TRACT OF LAND SHOWN ON THIS PLAT AND DESCRIBED BELOW, AND HAVE SUBDIVIDED SAID TRACT OF LAND INTO A STREET.

DEDICATED DESCRIPTION

Commencing at a point which is South 00°14'20" East 785.31 feet along the section line and East 2177.03 feet from the Northwest Corner of Section 6, Township 5 South, Range 1 East, Salt Lake Base and Meridian; thence Northeastly 248.52 feet along the arc of a 715.00 foot radius curve to the left, through a central angle of 19°54'55" the cord of which bears North 76°02'44" East 247.27 feet; thence Southeastly 265.42 feet along the arc of a non-tangent 815.00 foot radius curve to the right, through a central angle of 18°39'33" the cord of which bears South 67°16'47" East 264.25 feet; thence Easterly 23.56 feet along the arc of a 15.00 foot radius curve to the left, through a central angle of 89°59'38" the cord of which bears North 77°03'11" East 21.21 feet; thence North 32°03'22" East 163.49 feet; thence Northeastly 54.26 feet along the arc of a 240.00 foot radius curve to the right, through a central angle of 12°57'14" the cord of which bears North 38°31'59" East 54.15 feet; thence Northerly 23.43 feet along the arc of a 15.00 foot radius curve to the left, through a central angle of 89°30'23" the cord of which bears North 00°15'24" East 21.12 feet; thence South 44°29'47" East 110.01 feet; thence Westerly 23.79 feet along the arc of a 15.00 foot radius curve to the left, through a central angle of 90°52'05" the cord of which bears North 89°53'50" West 21.37 feet; thence Southwesterly 35.13 feet along the arc of a 160.00 foot radius curve to the left, through a central angle of 12°34'46" the cord of which bears South 38°20'45" West 35.06 feet; thence South 32°03'22" West 170.80 feet; thence Southerly 21.57 feet along the arc of a 15.00 foot radius curve to the left, through a central angle of 82°23'25" the cord of which bears South 09°08'21" East 19.76 feet; thence Southeastly 405.88 feet along the arc of a 815.00 foot radius curve to the right, through a central angle of 28°32'02" the cord of which bears South 36°04'02" East 401.70 feet; thence South 18°00'52" West 100.97 feet; thence North 89°59'08" West 20.06 feet; thence Northwesterly 22.83 feet along the arc of a 960.00 foot radius curve to the left, through a central angle of 01°21'45" the cord of which bears North 17°24'17" West 22.83 feet; thence Northwesterly 973.52 feet along the arc of a 735.00 foot radius curve to the left, through a central angle of 75°53'22" the cord of which bears North 56°03'08" West 903.90 feet to the point of beginning.
Parcel contains: 2.02 acres

Oct 13, 2015
DATE

Travis Trane
SURVEYOR
(See Seal Below)

OWNER'S DEDICATION

KNOW ALL MEN BY THESE PRESENTS THAT WE, ALL OF THE UNDERSIGNED OWNERS OF ALL OF THE PROPERTY DESCRIBED IN THE SURVEYOR'S CERTIFICATE HEREON AND SHOWN ON THIS MAP, HAVE CAUSED THE SAME TO BE SUBDIVIDED INTO LOTS, BLOCKS, STREETS AND EASEMENTS AND DO HEREBY DEDICATE THE STREETS AND OTHER PUBLIC AREAS AS INDICATED HEREON FOR PERPETUAL USE OF THE PUBLIC.

IN WITNESS WHEREOF WE HAVE HEREUNTO SET OUR HANDS THIS 28th DAY OF October, A.D. 2015

Thanksgiving Station, LLC & Thanksgiving Park Five, LLC
Authorized Agent
Andrew E. Bybee

ENT 99530-2015 Map # 14816
JEFFERY SMITH
UTAH COUNTY RECORDER
2015 Nov 02 3:56 PM FEE 0.00 BY SS
RECORDED FOR LEHI CITY CORPORATION

STATE OF UTAH)
COUNTY OF UTAH) S.S.

ON THE 28th DAY OF October, A.D. 2015 PERSONALLY APPEARED BEFORE ME THE SIGNERS OF THE FOREGOING DEDICATION WHO DULY ACKNOWLEDGE TO ME THAT THEY DID EXECUTE THE SAME.

MY COMMISSION EXPIRES 4-7-17
comm. # 682452
Notary Public
(See Seal Below)

ACCEPTANCE BY THE CITY OF LEHI
City of Lehi, Utah
City Engineer
Lehi City

THE COUNTY OF UTAH, APPROVES THIS SUBDIVISION AND HEREBY ACCEPTS THE DEDICATION OF ALL STREETS, EASEMENTS, AND OTHER PARCELS OF LAND INTENDED FOR PUBLIC PURPOSES FOR THE PERPETUAL USE OF THE PUBLIC THIS 27 DAY OF January, A.D. 2015

Beit Nelson
City Engineer
Lehi City

APPROVED _____
ENGINEER
(See Seal Below)

ATTEST _____
CLERK-RECORDER
(See Seal Below)

PLANNING COMMISSION APPROVAL
APPROVED THIS 7th DAY OF January, A.D. 2015, BY THE PLANNING COMMISSION

DIRECTOR-SECRETARY _____
CHAIRMAN, PLANNING COMMISSION

A STREET VACATION AND DEDICATION PLAT TO LEHI CITY

ASHTON BLVD.
ROAD DEDICATION PLAT

LEHI, UTAH COUNTY, UTAH

SCALE: 1" = 60' FEET

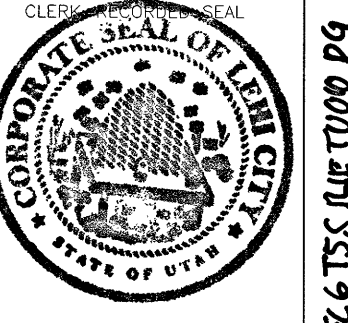
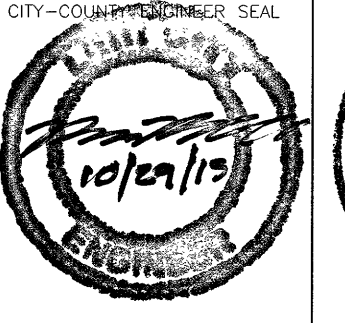
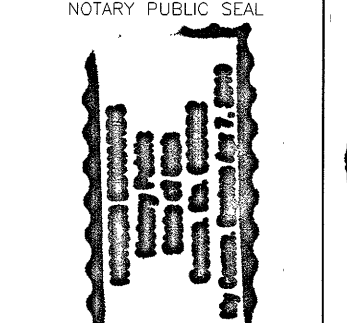
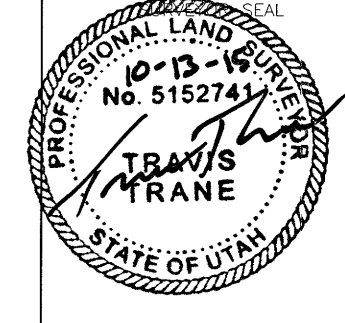

SEC 6 T5S R1E T000 P4

NW CORNER SEC. 6
T5S, R1E, SLB&M
FOUND BRASS MONUMENT

THANKSGIVING STATION LLC

THANKSGIVING POINT
STREET DEDICATION PLAT
ENTRY# 60290:2000

AREA TO REMAIN AS
PERMANENT LEHI CITY
UTILITY EASEMENT

32,845. sq.ft.
0.75 acres

50' STORM DRAIN EASEMENT
ENTRY NO. 72577:2000

THANKSGIVING STATION LLC

50' STORM DRAIN EASEMENT
ENTRY NO. 72578:2000

88,196. sq.ft.
2.02 acres

THANKSGIVING STATION LLC

THANKSGIVING PARK FIVE LLC

MEADOW POINT
LOT 1

MEADOW POINT
LOT 5

CURVE TABLE						
CURVE	LENGTH	RADIUS	DELTA	TANGENT	CHORD	CHORD BEARING
C1	248.52	715.00	19°54'55"	125.53	247.27	N76°02'44"E
C2	265.42	815.00	18°39'33"	133.89	264.25	S67°16'47"E
C3	23.56	15.00	89°59'38"	15.00	21.21	N77°03'11"E
C4	54.26	240.00	12°57'14"	27.25	54.15	N38°31'59"E
C5	23.43	15.00	89°30'23"	14.87	21.12	N0°15'24"E
C6	21.57	15.00	82°23'25"	13.13	19.76	S9°08'21"E
C7	405.88	815.00	28°32'02"	207.24	401.70	S36°04'02"E
C8	22.83	960.00	1°21'45"	11.42	22.83	N17°24'17"W
C9	973.52	735.00	75°53'22"	573.10	903.90	N56°03'08"W
C10	425.93	635.00	38°25'54"	221.33	417.99	N66°46'24"E
C11	231.24	715.00	18°31'50"	116.64	230.24	S56°49'22"W
C12	247.17	815.00	17°22'36"	124.54	246.23	N85°17'51"W
C13	853.76	775.00	63°07'06"	476.02	811.24	N49°40'00"W
C14	46.73	200.00	13°23'13"	23.47	46.62	N38°44'58"E
C15	483.88	775.00	35°46'24"	250.12	476.06	N35°59'39"W
C16	369.88	775.00	27°20'42"	188.53	366.38	N67°33'12"W
C17	172.74	775.00	12°46'16"	86.73	172.39	N87°36'41"W
C18	23.79	15.00	90°52'05"	15.23	21.37	N89°55'50"W
C19	35.13	160.00	12°34'46"	17.63	35.06	S38°20'45"W

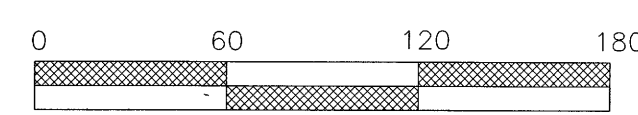

(24"x36")
SCALE: 1" = 60'
(11"x17")
SCALE: 1" = 120'

- SECTION CORNER
- SECTION LINE
- BOUNDARY LINE
- ROAD CENTER LINE
- EASEMENT LINE
- HATCHED AREA TO BE VACATED
- HATCHED AREA TO BE DEDICATED TO LEHI CITY

14816