

# GRANITE OAKS SUBDIVISION AMENDED

AMENDING LOTS 10, 11, 12, 13, 14, 15, 17, 4 18 AND CREATING LOT 39

LOCATED IN THE SOUTHWEST QUARTER OF SECTION 1 AND THE NORTHWEST QUARTER OF SECTION 12, TOWNSHIP 3 SOUTH, RANGE 1 EAST, SALT LAKE BASE 4 MERIDIAN, SALT LAKE COUNTY, UTAH

This map is provided solely for the purpose of assisting in locating the property and Cottonwood Title Insurance Agency, Inc. assumes no liability for variation, if any, with any actual survey.

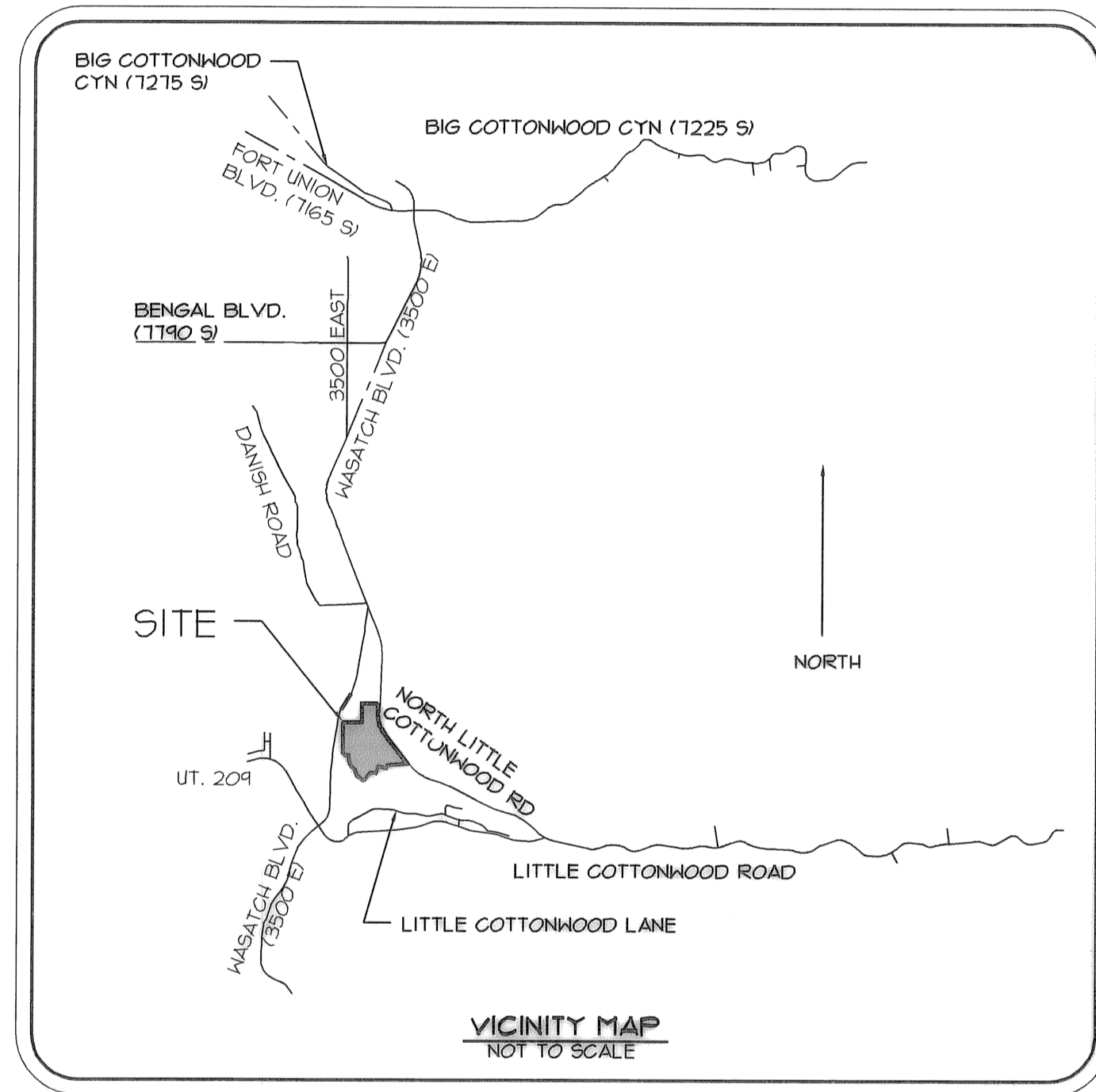

**SURVEYOR'S CERTIFICATE**  
I, PATRICK M. HARRIS do hereby certify that I am a Licensed Land Surveyor, and that I hold certificate No. 286882 as prescribed under laws of the State of Utah. I further certify that by authority of the Owners, I have made a survey of the tract of land shown on this plat and described below, and have subdivided said tract of land into lots and streets, hereafter to be known as GRANITE OAKS SUBDIVISION AMENDED, and that the same has been correctly surveyed and staked on the ground as shown on this plat. I further certify that all lots meet frontage width and area requirements of the applicable zoning ordinances.

**BOUNDARY DESCRIPTION**  
Beginning at the Northwest Corner of Section 12, Township 3 South, Range 1 East, Salt Lake Base and Meridian, and running:  
Thence North 84°51'03" East 467.76 feet along the section line;  
Thence North 10°08'30" East 526.51 feet;  
Thence South 74°51'30" East 415.83 feet to the west line of the North Little Cottonwood Canyon Road;  
Thence South 02°33'54" West 391.6 feet along the west line of the North Little Cottonwood Canyon Road;  
Thence southeasterly 74.86 feet along the arc of a 1030.31 foot radius curve to the left, (center bears South 81°26'06" East and long chord bears South 0°20'41" West 74.86 feet, with a central angle of 4°26'26") along the west line of North Little Cottonwood Canyon Road;  
Thence South 10°05'03" West 330.13 feet;  
Thence North 84°51'07" East 121.61 to the west line of North Little Cottonwood Canyon Road;  
Thence southeasterly 314.52 feet along the arc of a 1030.31 foot radius curve to the left (center bears North 64°38'54" East and the long chord bears South 24°14'28" East 314.52 feet with a central angle of 174.6047) along the west line of North Little Cottonwood Canyon Road;  
Thence South 38°07'30" East 183.62 feet along the west line of North Little Cottonwood Canyon Road;  
Thence South 85°41'58" West 194.22 feet;  
Thence South 28°15'11" West 204.64 feet;  
Thence South 63°46'41" East 104.10 feet;  
Thence South 28°55'38" West 686.10 feet to the north line of The La Caille Subdivision;  
Thence South 84°18'23" West 3.50 feet along the north line of The La Caille Subdivision;  
Thence South 47°23'24" West 105.00 feet along the north line of The La Caille Subdivision;  
Thence South 38°48'00" West 158.00 feet along the north line of The La Caille Subdivision;  
Thence South 10°26'22" West 43.55 feet along the north line of The La Caille Subdivision;  
Thence North 44°11'33" West 61.00 feet along the north line of The La Caille Subdivision;  
Thence North 55°51'00" West 144.52 feet along the north line of The La Caille Subdivision;  
Thence North 20°22'26" West 193.38 feet along the north line of The La Caille Subdivision;  
Thence North 50°04'00" West 104.00 feet along the north line of The La Caille Subdivision;  
Thence North 28°36'10" West 119.50 feet along the north line of The La Caille Subdivision;  
Thence North 11°14'35" West 19.75 feet along the north line of The La Caille Subdivision;  
Thence North 04°00'00" West 140.00 feet along the north line of The La Caille Subdivision;  
Thence North 82°58'30" West 41.90 feet along the north line of The La Caille Subdivision;  
Thence North 47°24'00" West 69.87 feet along the north line of The La Caille Subdivision to the section line;  
Thence North 00°38'44" West 126.33 feet along the section line to the Northwest Corner of said Section 12,  
to the point of beginning.  
Contains 1473541 square feet, 33.824 acres, 31 lots, 1 parcel.

Nov. 28, 2006  
Date  
Patrick M. Harris  
License no. 286882

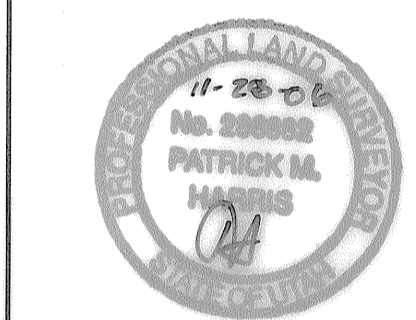

**OWNER'S DEDICATION**  
Know all men by these presents that \_\_\_\_\_, the undersigned owner ( ) of the above described tract of land having caused same to be subdivided into lots and streets to be hereafter known as the **GRANITE OAKS SUBDIVISION AMENDED** AMENDING LOTS 10, 11, 12, 13, 14, 15, 17, 4 18 AND CREATING LOT 39 do hereby dedicate for perpetual use of the public all parcels of land shown on this plat as intended for public use. In witness whereof \_\_\_\_\_ have hereunto set \_\_\_\_\_ this \_\_\_\_\_ day of \_\_\_\_\_ A.D., 20\_\_\_\_.

*Grant S. Webster*  
GRANT S. WEBSTER  
*Jon Baker*  
JON BAKER  
*Richard S. Despain*  
RICHARD S. DESPAIN  
*Mary G. Good*  
MARY G. GOOD  
*Martin W. Merrill*  
MARTIN W. MERRILL

**ACKNOWLEDGMENT**  
STATE OF UTAH ) S.S.  
County of Salt Lake )  
On the \_\_\_\_\_ day of \_\_\_\_\_ A.D., 20\_\_\_\_, personally appeared before me, the undersigned Notary Public, in and for said County of Salt Lake in said State of Utah, the signer ( ) of the above Owner's dedication, \_\_\_\_\_ in number, who duly acknowledged to me that \_\_\_\_\_ signed it freely and voluntarily and for the uses and purposes therein mentioned.  
MY COMMISSION EXPIRES: \_\_\_\_\_ NOTARY PUBLIC  
RESIDING IN SALT LAKE COUNTY

**ACKNOWLEDGMENT**  
STATE OF UTAH )  
COUNTY OF \_\_\_\_\_ )  
ON THE \_\_\_\_\_ DAY OF \_\_\_\_\_, 20\_\_\_\_ PERSONALLY APPEARED BEFORE ME \_\_\_\_\_ IS/ARE THE \_\_\_\_\_ WHO BEING BY ME DULY SWORN OR AFFIRMED, DID SAY THAT \_\_\_\_\_ OF \_\_\_\_\_ AND THAT THE WITHIN OWNER'S DEDICATION WAS SIGNED IN BEHALF OF SAID \_\_\_\_\_ BY AUTHORITY OF \_\_\_\_\_ AND THE SAID \_\_\_\_\_ ACKNOWLEDGED TO ME THAT SAID \_\_\_\_\_ EXECUTED THE SAME.  
MY COMMISSION EXPIRES \_\_\_\_\_ NOTARY PUBLIC  
RESIDING IN \_\_\_\_\_

**ACKNOWLEDGMENT**  
STATE OF UTAH )  
COUNTY OF \_\_\_\_\_ )  
ON THE \_\_\_\_\_ DAY OF \_\_\_\_\_, 20\_\_\_\_ PERSONALLY APPEARED BEFORE ME \_\_\_\_\_ IS/ARE THE \_\_\_\_\_ WHO BEING BY ME DULY SWORN OR AFFIRMED, DID SAY THAT \_\_\_\_\_ OF \_\_\_\_\_ AND THAT THE WITHIN OWNER'S DEDICATION WAS SIGNED IN BEHALF OF SAID \_\_\_\_\_ BY AUTHORITY OF \_\_\_\_\_ AND THE SAID \_\_\_\_\_ ACKNOWLEDGED TO ME THAT SAID \_\_\_\_\_ EXECUTED THE SAME.  
MY COMMISSION EXPIRES \_\_\_\_\_ NOTARY PUBLIC  
RESIDING IN \_\_\_\_\_

**ACKNOWLEDGMENT**  
STATE OF UTAH )  
COUNTY OF Salt Lake )  
ON THE 1st DAY OF Dec 2006 PERSONALLY APPEARED BEFORE ME GRANT S. WEBSTER  
WHO BEING BY ME DULY SWORN OR AFFIRMED, DID SAY THAT WE IS/ARE THE MANAGING MEMBERS OF L.C. CANYON PARTNERS, LLC AND THAT THE WITHIN OWNER'S DEDICATION WAS SIGNED IN BEHALF OF SAID L.C. CANYON PARTNERS, LLC BY AUTHORITY OF THE COMPANY AND THE SAID GRANT S. WEBSTER ACKNOWLEDGED TO ME THAT SAID GRANT S. WEBSTER EXECUTED THE SAME.  
MY COMMISSION EXPIRES Nov 28, 2007 NOTARY PUBLIC  
RESIDING IN SLD, UT

**ACKNOWLEDGMENT**  
STATE OF UTAH ) S.S.  
County of Salt Lake )  
On the 8th day of Dec AD, 2006 personally appeared before me, the undersigned Notary Public, in and for said County of Salt Lake in said State of Utah, the signer ( ) of the above Owner's dedication, \_\_\_\_\_ in number, who duly acknowledged to me that \_\_\_\_\_ signed it freely and voluntarily and for the uses and purposes therein mentioned.  
MY COMMISSION EXPIRES: 4-19-2008 NOTARY PUBLIC  
RESIDING IN SALT LAKE COUNTY

**DEVELOPER:**  
LITTLE COTTONWOOD CANYON PARTNERS LLC  
**CONTACT:**  
IRV EASTHAM  
(801) 252-5478

**ENSIGN**  
engineering planning surveying  
90 East Fort Union Blvd., Suite 100 (801) 255-0529  
Midvale, Utah 84047 fax (801)-255-4449

**GRANITE OAKS SUBDIVISION AMENDED**  
AMENDING LOTS 10, 11, 12, 13, 14, 15, 17, 4 18  
LOCATED IN THE SOUTHWEST QUARTER OF SECTION 1 AND THE NORTHWEST QUARTER OF SECTION 12, TOWNSHIP 3 SOUTH, RANGE 1 EAST, SALT LAKE BASE 4 MERIDIAN, SALT LAKE COUNTY, UTAH

**NOTES:**  
QUESTAR APPROVES THIS PLAT SOLELY FOR THE PURPOSE OF CONFIRMING THAT THE PLAT CONTAINS PUBLIC UTILITY EASEMENTS. QUESTAR MAY REQUIRE OTHER EASEMENTS IN ORDER TO SERVE THIS DEVELOPMENT. THIS APPROVAL DOES NOT CONSTITUTE ABROGATION OR WAIVER OF ANY OTHER EXISTING RIGHTS, OBLIGATIONS OR LIABILITIES PROVIDED BY LAW OR EQUITY. THIS APPROVAL DOES NOT CONSTITUTE ACCEPTANCE, APPROVAL OR ACKNOWLEDGMENT OF ANY TERMS CONTAINED IN THE PLAT, INCLUDING THOSE SET FORTH IN THE OWNERS DEDICATION AND THE NOTES AND DOES NOT CONSTITUTE A GUARANTEE OF PARTICULAR TERMS OF NATURAL GAS SERVICE. FOR FURTHER INFORMATION PLEASE CONTACT QUESTAR'S RIGHT-OF-WAY DEPARTMENT AT 1-800-366-8532.

STREET NAMES APPROVED DATE: 12-4-06 SIGNED: [Signature]	CHECKED FOR ZONING ZONE: R-1-15/20 80' 15,000/16 ACRES 5-10' R-16 WIDTH 60' AREA 111,000 SQ FT DATE: Dec 5, 2006 SIGNED: [Signature]	PLANNING COMMISSION APPROVED THIS _____ DAY OF _____ A.D., 20____ BY THE SALT LAKE COUNTY PLANNING COMMISSION. CHAIRMAN, SALT LAKE Co. PLANNING COM. [Signature]	SALT LAKE VALLEY HEALTH DEPARTMENT APPROVED THIS _____ DAY OF _____ A.D., 20____ DIRECTOR, S.L. VALLEY HEALTH DEPT. [Signature]	Planning and Development Services I HEREBY CERTIFY THAT THIS OFFICE HAS EXAMINED THIS PLAT AND IT IS CORRECT IN ACCORDANCE WITH INFORMATION ON FILE IN THIS OFFICE. DATE: 12/6/06 DIRECTOR: [Signature]	APPROVAL AS TO FORM APPROVED AS TO FORM THIS _____ DAY OF _____ A.D., 20____ SALT LAKE COUNTY DISTRICT ATTORNEY: [Signature]	SALT LAKE COUNTY MAYOR PRESENTED TO THE SALT LAKE COUNTY MAYOR THIS _____ DAY OF _____ A.D., 20____, AT WHICH TIME THIS SUBDIVISION WAS APPROVED AND ACCEPTED. MAYOR OR DESIGNEE: [Signature]	RECORDED # 9935501 STATE OF UTAH, COUNTY OF SALT LAKE, RECORDED AND FILED AT THE REQUEST OF L.C. CANYON PARTNERS, LLC DATE: 12/11/06 TIME: 1:23 BOOK: 1000 PAGE: 314 FEE \$ 890.00 SALT LAKE COUNTY RECORDER: [Signature]	
28-01-31, 28-12-11							28-01-352-011-Ann-014 28-01-357-001-Ann-002	28-12-101-017-Ann-052 28-12-105-001-Ann-011 28-12-105-001-Ann-011 28-12-104-001-Ann-003

CURVE TABLE														
CURVE	LENGTH	RADIUS	TANGENT	CHORD	CH BRG	DELTA	CURVE	LENGTH	RADIUS	TANGENT	CHORD	CH BRG	DELTA	
C1	NOT USED	-	-	-	-	-	C12	10.00	331.50	46.23	6.81	N80°08'51"E	17°36'04"	
C2	NOT USED	-	-	-	-	-	C13	10.00	331.50	46.23	6.81	N46°24'07"E	17°36'04"	
C3	NOT USED	-	-	-	-	-	C14	10.00	331.50	46.23	6.81	N54°12'02"E	21°24'03"	
C4	122.44	1030.31	61.41	122.01	S23°45'12"E	6°41'32"	C15	8.48	362.50	40.81	6.31	S46°53'51"W	12°52'41"	
C5	138.71	1030.31	66.95	138.61	S30°32'00"E	7°56'06"	C16	196.01	362.50	68.82	195.22	S64°05'01"W	21°24'03"	
C6	63.61	1030.31	31.69	63.66	S36°21'11"E	5°32'21"	C17	211.48	362.50	121.8	214.24	S91°04'14"W	34°22'34"	
C7	52.36	1142.81	16.38	52.35	S38°08'46"E	1°14'05"	C18	10.40	331.50	87.05	10.34	S60°22'15"W	28°55'38"	
C8	54.28	1142.81	17.25	54.11	S30°46'55"E	1°24'38"	C19	32.10	331.50	16.06	31.08	S43°08'58"W	5°26'55"	
C9	184.83	1142.81	42.60	184.65	S22°21'11"E	8°51'34"	C20	103.62	362.50	33.71	103.21	N48°38'02"E	16°22'34"	
C10	NOT USED	-	-	-	-	-	C21	103.62	362.50	33.71	103.21	N48°38'02"E	16°22'34"	
C11	276.51	1142.81	68.81	276.51	S11°11'53"E	1°19'14"	C22	103.62	362.50	33.71	103.21	N48°38'02"E	16°22'34"	
C12	121.8	1142.81	30.62	121.07	S01°46'06"E	5°48'21"	C23	103.62	362.50	33.71	103.21	N48°38'02"E	16°22'34"	
C13	68.43	4102.7	42.04	68.10	S46°10'08"E	9°12'02"	C24	NOT USED	-	-	-	-	-	-
C14	NOT USED	-	-	-	-	-	C25	103.62	362.50	33.71	103.21	N48°38'02"E	16°22'34"	
C15	NOT USED	-	-	-	-	-	C26	103.62	362.50	33.71	103.21	N48°38'02"E	16°22'34"	
C16	NOT USED	-	-	-	-	-	C27	103.62	362.50	33.71	103.21	N48°38'02"E	16°22'34"	
C17	NOT USED	-	-	-	-	-	C28	103.62	362.50	33.71	103.21	N48°38'02"E	16°22'34"	
C18	88.96	1142.81	18.61	88.60	S68°02'28"E	3°84'13"	C29	103.62	362.50	33.71	103.21	N48°38'02"E	16°22'34"	
C19	88.11	52.00	18.38	88.01	S81°04'38"W	4°14'36"	C30	103.62	362.50	33.71	103.21	N48°38'02"E	16°22'34"	
C20	82.02	52.00	17.31	81.78	S12°55'46"E	4°02'23"	C31	103.62	362.50	33.71	103.21	N48°38'02"E	16°22'34"	
C21	110.74	52.00	22.11	109.14	S35°58'52"W	8°84'04"	C32	103.62	362.50	33.71	103.21	N48°38'02"E	16°22'34"	
C22	25.85	25.00	14.28	24.87	N82°22'35"W	5°12'18"	C33	103.62	362.50	33.71	103.21	N48°38'02"E	16°22'34"	
C23	10.11	121.81	3.81	10.10	S00°43'33"W	3°18'36"	C34	103.62	362.50	33.71	103.21	N48°38'02"E	16°22'34"	
C24	36.21	121.81	12.81	36.14	S04°10'30"E	6°24'30"	C35	103.62	362.50	33.71	103.21	N48°38'02"E	16°22'34"	
C25	128.16	121.81	44.44	128.10	S10°24'28"E	6°09'21"	C36	103.62	362.50	33.71	103.21	N48°38'02"E	16°22'34"	
C26	38.12	121.81	12.81	38.01	S30°41'56"E	5°32'21"	C37	103.62	362.50	33.71	103.21	N48°38'02"E	16°22'34"	
C27	38.52	25.00	24.26	38.42	S81°04'38"W	4°14'36"	C38	103.62	362.50	33.71	103.21	N48°38'02"E	16°22'34"	
C28	103.62	121.81	36.61	103.63	S18°12'25"E	4°51'24"	C39	103.62	362.50	33.71	103.21	N48°38'02"E	16°22'34"	
C29	128.16	121.81	44.44	128.10	S10°24'28"E	6°09'21"	C40	103.62	362.50	33.71	103.21	N48°38'02"E	16°22'34"	
C30	128.16	121.81	44.44	128.10	S10°24'28"E	6°09'21"	C41	103.62	362.50	33.71	103.21	N48°38'02"E	16°22'34"	
C31	128.16	121.81	44.44	128.10	S10°24'28"E	6°09'21"	C42	103.62	362.50	33.71	103.21	N48°38'02"E	16°22'34"	
C32	128.16	121.81	44.44	128.10	S10°24'28"E	6°09'21"	C43	103.62	362.50	33.71	103.21	N48°38'02"E	16°22'34"	
C33	128.16	121.81	44.44	128.10	S10°24'28"E	6°09'21"	C44	103.62	362.50	33.71	103.21	N48°38'02"E	16°22'34"	
C34	128.16	121.81	44.44	128.10	S10°24'28"E	6°09'21"	C45	103.62	362.50	33.71	103.21	N48°38'02"E	16°22'34"	
C35	128.16	121.81	44.44	128.10	S10°24'28"E	6°09'21"	C46	103.62	362.50	33.71	103.21	N48°38'02"E	16°22'34"	
C36	128.16	121.81	44.44	128.10	S10°24'28"E	6°09'21"	C47	103.62	362.50	33.71	103.21	N48°38'02"E	16°22'34"	
C37	128.16	121.81	44.44	128.10	S10°24'28"E	6°09'21"	C48	103.62	362.50	33.71	103.21	N48°38'02"E	16°22'34"	
C38	128.16	121.81	44.44	128.10	S10°24'28"E	6°09'21"	C49	103.62	362.50	33.71	103.21	N48°38'02"E	16°22'34"	
C39	128.16	121.81	44.44	128.10	S10°24'28"E	6°09'21"	C50	103.62	362.50	33.71	103.21	N48°38'02"E	16°22'34"	
C40	128.16	121.81	44.44	128.10	S10°24'28"E	6°09'21"	C51	103.62	362.50	33.71	103.21	N48°38'02"E	16°22'34"	
C41	128.16	121.81	44.44	128.10	S10°24'28"E	6°09'21"	C52	103.62	362.50	33.71	103.21	N48°38'02"E	16°22'34"	
C42	128.16	121.81	44.44	128.10	S10°24'28"E	6°09'21"	C53	103.62	362.50	33.71	103.21	N48°38'02"E	16°22'34"	
C43	128.16	121.81	44.44	128.10	S10°24'28"E	6°09'21"	C54	103.62	362.50	33.71	103.21	N48°38'02"E	16°22'34"	
C44	128.16	121.81	44.44	128.10	S10°24'28"E	6°09'21"	C55	103.62	362.50	33.71	103.21	N48°38'02"E	16°22'34"	
C45	128.16	121.81	44.44	128.10	S10°24'28"E	6°09'21"	C56	103.62	362.50	33.71	103.21	N48°38'02"E	16°22'34"	
C46	128.16	121.81	44.44	128.10	S10°24'28"E	6°09'21"	C57	103.62	362.50	33.71	103.21	N48°38'02"E	16°22'34"	
C47	128.16	121.81	44.44	128.10	S10°24'28"E	6°09'21"	C58	103.62	362.50	33.71	103.21	N48°38'02"E	16°22'34"	
C48	128.16	121.81	44.44	128.10	S10°24'28"E	6°09'21"	C59	103.62	362.50	33.71	103.21	N48°38'02"E	16°22'34"	
C49	128.16	121.81	44.44	128.10	S10°24'28"E	6°09'21"	C60	103.62	362.50	33.71	103.21	N48°38'02"E	16°22'34"	
C50	128.16	121.81	44.44	128.10	S10°24'28"E	6°09'21"	C61	103.62	362.50	33.71	103.21	N48°38'02"E	16°22'34"	
C51	128.16	121.81	44.44	128.10	S10°24'28"E	6°09'21"	C62	103.62	362.50	33.71	103.21	N48°38'02"E	16°22'34"	
C52	128.16	121.81	44.44	128.10	S10°24'28"E	6°09'21"	C63	103.62	362.50	33.71	103.21	N48°38'02"E	16°22'34"	
C53	128.16	121.81	44.44	128.10	S10°24'28"E	6°09'21"	C64	103.62	362.50	33.71	103.21	N48°38'02"E	16°22'34"	
C54	128.16	121.81	44.44	128.10	S10°24'28"E	6°09'21"	C65	103.62	362.50	33.71	103.21	N48°38'02"E	16°22'34"	
C55	128.16	121.81	44.44	128.10	S10°24'28"E	6°09'21"	C66	103.62	362.50	33.71	103.21	N48°38'02"E	16°22'34"	
C56	128.16	121.81	44.44	128.10	S10°24'28"E	6°09'21"	C67	103.62	362.50	33.71	103.21	N48°38'02"E	16°22'34"	
C57	128.16	121.81	44.44	128.10	S10°24'28"E	6°09'21"	C68	103.62	362.50	33.71	103.21	N48°38'02"E	16°22'34"	
C58	128.16	121.81	44.44	128.10	S10°24'28"E	6°09'21"	C69	103.62	362.50	33.71	103.21	N48°38'02"E	16°22'34"	
C59	128.16	121.81	44.44	128.10	S10°24'28"E	6°09'21"	C70	103.62	362.50	33.71	103.21	N48°38'02"E	16°22'34"	
C60	128.16	121.81	44.44	128.10	S10°24'28"E	6°09'21"	C71	103.62	362.50	33.71	103.21	N48°38'02"E	16°22'34"	
C61	128.16	121.81	44.44	128.10	S10°24'28"E	6°09'21"	C72	103.62	362.50	33.71	103.21	N48°38'02"E	16°22'34"	
C62	128.16	121.81	44.44	128.10	S10°24'28"E	6°09'21"	C73	103.62	362.50	33.71	103.21	N48°38'02"E	16°22'34"	
C63	128.16	121.81	44.44	128.10	S10°24'28"E	6°09'21"	C74	103.62	362.50	33.71	103.21	N48°38'02"E	16°22'34"	
C64	128.16	121.81	44.44	128.10	S10°24'28"E	6°09'21"	C75	103.62	362.50	33.71	103.21	N48°38'02"E	16°22'34"	
C65	128.16	121.81	44.44	128.10	S10°24'28"E	6°09'21"	C76	103.62	362.50	33.71	103.21	N48°38'02"E	16°22'34"	
C66	128.16	121.81	44.44	128.10	S10°24'28"E	6°09'21"	C77	103.62	362.50	33.71	103.21	N48°38'02"E	16°22'34"	
C67	128.16	121.81	44.44	128.10	S10°24'28"E	6°09'21"	C78	103.62	362.50	33.71	103.21	N48°38'02"E	16°22'34"	
C68	128.16	121.81	44.44	128.10	S10°24'28"E	6°09'21"	C79	103.62	362.50	33.71	103.21	N48°38'02"E	16°22'34"	
C69	128.16	121.81	44.44	128.10	S10°24'28"E	6°09'21"	C80	103.62	362.50	33.71	103.21	N48°38'02"E	16°22'34"	
C70	128.16	121.81	44.44	128.10	S10°24'28"E	6°09'21"	C81	103.62	362.50	33.71	103.21	N48°38'02"E	16°22'34"	
C71	128.16	121.81	44.44	128.10	S10°24'28"E	6°09'21"	C82	103.62	362.50	33.71	103.21	N48°38'02"E	16°22'34"	
C72	128.16	121.81	44.44	128.10	S10°24'28"E	6°09'21"	C83	103.62	362.50	33.71	103.21	N48°38'02"E	16°22'34"	
C73	128.16	121.81	44.44	128.10	S10°24'28"E	6°09'21"	C84	103.62	362.50	33.71	103.21	N48°38'02"E	16°22'34"	
C74	128.16	121.81	44.44	128.10	S10°24'28"E	6°09'21"	C85	103.62	362.50	33.71	103.21	N48°38'02"E	16°22'34"	
C75	128.16	121.81	44.44	128.10	S10°24'28"E	6°09'21"	C86	103.62	362.50	33.71	103.21	N48°38'02"E	16°22'34"	
C76	128.16	121.81	44.44	128.10	S10°24'28"E	6°09'21"	C87	103.62	362.50	33.71	103.21	N48°38'02"E	16°22'34"	
C77	128.16	121.81	44.44	128.10	S10°24'28"E	6°09'21"	C88	103.62	362.50	33.71	103.21	N48°38'02"E	16°22'34"	
C78	128.16	121.81	44.44	128.10	S10°24'28"E	6°09'21"	C89	103.62	362.50	33.71	103.21	N48°38'02"E	16°22'34"	
C79	128.16	121.81	44.44	128.10	S10°24'28"E	6°09'21"	C90	103.62	362.50	33.71	103.21	N48°38'02"E	16°22'34"	
C80	128.16	121.81	44.44	128.10	S10°24'28"E	6°09'21"	C91	103.62						