

GRANITE OAKS SUBDIVISION

LOCATED IN THE SOUTHWEST QUARTER OF SECTION 1 AND THE NORTHWEST QUARTER OF SECTION 12, TOWNSHIP 3 SOUTH, RANGE 1 EAST, SALT LAKE BASE 4 MERIDIAN, SALT LAKE COUNTY, UTAH

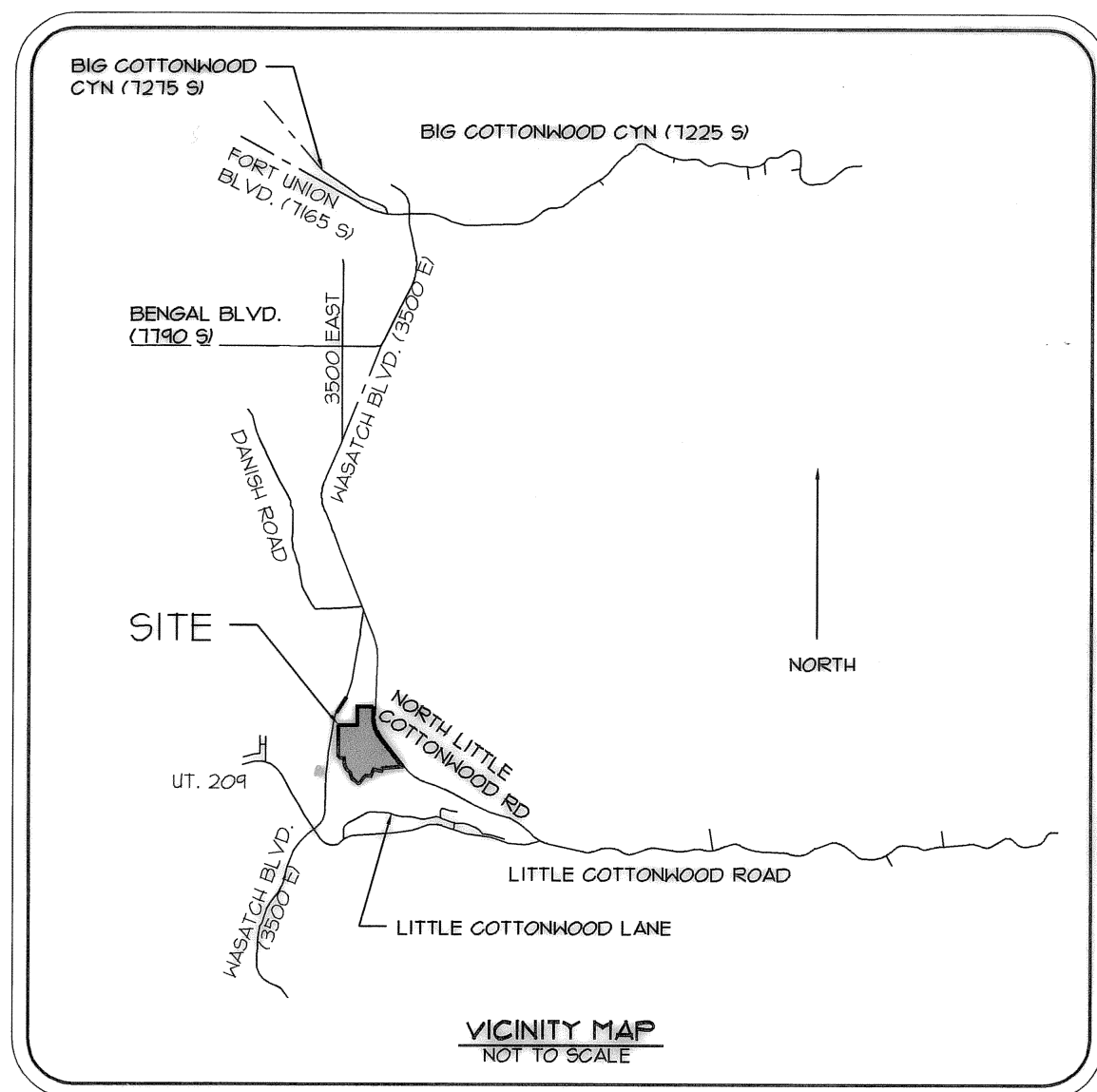

NOTARY PUBLIC
REIKO TATEOKA
2001 So. State St., S3800
Salt Lake City, UT 84199-1200
My Commission Expires
December 17, 2007
STATE OF UTAH

ACKNOWLEDGMENT
STATE OF UTAH)
COUNTY OF Salt Lake)
ON the 15 day of May, 2006 PERSONALLY
APPEARED BEFORE ME
Richard R. Despain
WHO BEING BY ME DULY SWORN OR AFFIRMED, DID SAY
THAT he IS/ARE THE General Partner
OF The Despain Family Limited Partnership
AND THAT THE WITHIN OWNER'S
DEDICATION WAS SIGNED IN BEHALF OF SAID
BY AUTHORITY OF its partnership
AND THE SAID
ACKNOWLEDGED TO ME THAT SAID
The Despain Family Limited Partnership
EXECUTED THE SAME.
MY COMMISSION EXPIRES 12-17-07 NOTARY PUBLIC
RESIDING IN Salt Lake County, Utah

ACKNOWLEDGMENT
STATE OF UTAH)
COUNTY OF)
ON the ___ day of ___, 20___ PERSONALLY
APPEARED BEFORE ME
WHO BEING BY ME DULY SWORN OR AFFIRMED, DID SAY
THAT ___ IS/ARE THE ___
OF ___
AND THAT THE WITHIN OWNER'S
DEDICATION WAS SIGNED IN BEHALF OF SAID
BY AUTHORITY OF ___
AND THE SAID ___
ACKNOWLEDGED TO ME THAT SAID ___
EXECUTED THE SAME.
MY COMMISSION EXPIRES ___ NOTARY PUBLIC
RESIDING IN ___

STATE OF UTAH)
County of Salt Lake) ss.
On this 16 day of May, 2006 personally appeared before me
Bruce Gilbert Despain/Bruce G. Despain
the signer(s) of the Owner's Dedication, 0116 in number, who duly acknowledged to me that
he/she/they signed it freely and voluntarily and for the uses and purposes therein mentioned.
My Commission Expires 12-17-07 NOTARY PUBLIC
Residing at Salt Lake County, Utah

STATE OF UTAH) ss.
County of Salt Lake)
On the 16 day of May, A.D., 2006 personally appeared before me, the
undersigned Notary Public, in and for said County of Salt Lake in said State of
Utah, the signer(s) of the above Owner's dedication, 1100 in number, who duly
acknowledged to me that they signed it freely and voluntarily and
for the uses and purposes therein mentioned.
My Commission Expires 12-17-07 NOTARY PUBLIC
Richard R. Despain/Richard R. Despain
Michael John Despain/Michael J. Despain
RESIDING IN SALT LAKE COUNTY

DEVELOPER:
LITTLE COTTONWOOD
CANYON PARTNERS LLC
CONTACT:
IRV EASTHAM
(801) 252-5418

ENGINEERING PLANNING SURVEYING
90 East Fort Union Blvd., Suite 100
Midvale, Utah 84047 (801) 255-0529
fax (801)-255-4449

SURVEYOR'S CERTIFICATE
I, PATRICK M. HARRIS do hereby certify that I am a Licensed Land Surveyor,
and that I hold certificate No. 286882 as prescribed under laws of the
State of Utah. I further certify that by authority of the Owners, I have made a
survey of the tract of land shown on this plat and described below, and have
subdivided said tract of land into lots and streets, hereinafter to be known as
GRANITE OAKS SUBDIVISION and that the same has been correctly
surveyed and staked on the ground as shown on this plat. I further certify that
all lots meet frontage width and area requirements of the applicable zoning
ordinances.

BOUNDARY DESCRIPTION
Beginning at the Northwest Corner of Section 12, Township 3 South, Range 1 East, Salt Lake Base
and Meridian, and running:
Thence North 84°51'03" East 467.16 feet along the section line;
Thence North 10°08'30" East 526.51 feet;
Thence South 79°51'30" East 415.83 feet to the west line of the North Little Cottonwood Canyon
Road;
Thence South 02°33'54" West 39.18 feet along the west line of the North Little Cottonwood
Canyon Road;
Thence southeasterly 19.86 feet along the arc of a 1030.31 foot radius curve to the left,
(center bears South 81°26'06" East and long chord bears South 0°20'41" West 19.85 feet, with a
central angle of 4°26'26") along the west line of North Little Cottonwood Canyon Road;
Thence South 10°09'03" West 330.13 feet;
Thence North 84°51'01" East 121.61 to the west line of North Little Cottonwood Canyon Road;
Thence southeasterly 319.52 feet along the arc of a 1030.31 foot radius curve to the left (center
bears North 64°38'34" East and the long chord bears South 24°14'28" East 318.25 feet with a central
angle of 11°46'04") along the west line of North Little Cottonwood Canyon Road;
Thence South 38°01'30" East 183.62 feet along the west line of North Little Cottonwood Canyon
Road;
Thence South 85°41'58" West 114.22 feet;
Thence South 26°19'19" West 204.64 feet;
Thence South 63°46'41" East 104.10 feet;
Thence South 28°55'38" West 686.70 feet to the north line of The La Caille Subdivision;
Thence South 84°18'23" West 3.50 feet along the north line of The La Caille Subdivision;
Thence South 41°23'24" West 105.00 feet along the north line of The La Caille Subdivision;
Thence South 38°48'00" West 158.00 feet along the north line of The La Caille Subdivision;
Thence South 10°26'22" West 43.55 feet along the north line of The La Caille Subdivision;
Thence North 44°11'33" West 61.00 feet along the north line of The La Caille Subdivision;
Thence North 55°10'00" West 144.52 feet along the north line of The La Caille Subdivision;
Thence North 20°22'26" West 183.38 feet along the north line of The La Caille Subdivision;
Thence North 50°04'00" West 101.40 feet along the north line of The La Caille Subdivision;
Thence North 28°36'10" West 195.50 feet along the north line of The La Caille Subdivision;
Thence North 11°19'35" West 19.75 feet along the north line of The La Caille Subdivision;
Thence North 04°00'00" West 140.00 feet along the north line of The La Caille Subdivision;
Thence North 82°58'30" West 91.40 feet along the north line of The La Caille Subdivision;
Thence North 41°24'00" West 69.81 feet along the north line of The La Caille Subdivision to the
section line.
Thence North 00°38'44" West 126.33 feet along the section line to the Northwest Corner of
said Section 12;
to the point of beginning.

Contains 1473,591 square feet, 33,829 acres, 36 lots, 1 parcel.
DATE: MAY 1, 2006
Date: May 1, 2006
Patrick M. Harris
License no. 286882

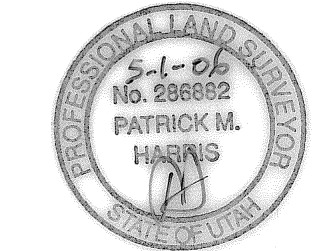

OWNER'S DEDICATION
Know all men by these presents that, the undersigned owner () of the
above described tract of land having caused same to be subdivided into lots
and streets to be hereafter known as the

GRANITE OAKS SUBDIVISION
do hereby dedicate for perpetual use of the public all parcels of land shown
on this plat as intended for public use. In witness whereof, have hereunto
set this ___ day of ___, A.D., 20___.

THE DESPAIN FAMILY LIMITED PARTNERSHIP
Richard R. Despain/Bruce G. Despain
Camille B. Despain/Richard R. Despain
Suzanne B. Despain/Michael J. Despain
Bruce Gilbert Despain/Bruce G. Despain

ACKNOWLEDGMENT
STATE OF UTAH) ss.
County of Salt Lake)
On the 15 day of May, A.D., 2006 personally appeared before me, the
undersigned Notary Public, in and for said County of Salt Lake in said State of
Utah, the signer(s) of the above Owner's dedication, 1100 in number, who duly
acknowledged to me that they signed it freely and voluntarily and
for the uses and purposes therein mentioned.
My Commission Expires 12-17-07 NOTARY PUBLIC
Richard R. Despain/Richard R. Despain
Michael John Despain/Michael J. Despain
RESIDING IN SALT LAKE COUNTY

GRANITE OAKS SUBDIVISION
LOCATED IN THE SOUTHWEST QUARTER OF SECTION 1 AND THE NORTHWEST QUARTER OF SECTION 12, TOWNSHIP 3 SOUTH, RANGE 1 EAST, SALT LAKE BASE 4 MERIDIAN, SALT LAKE COUNTY, UTAH

NOTES:
QUESTAR APPROVES THIS PLAT SOLELY FOR THE PURPOSE OF CONFIRMING THAT THE PLAT CONTAINS PUBLIC UTILITY EASEMENTS. QUESTAR MAY REQUIRE OTHER EASEMENTS IN ORDER TO SERVE THIS DEVELOPMENT. THIS APPROVAL DOES NOT CONSTITUTE ABROGATION OR WAIVER OF ANY OTHER EXISTING RIGHTS, OBLIGATIONS OR LIABILITIES PROVIDED BY LAW OR EQUITY. THIS APPROVAL DOES NOT CONSTITUTE ACCEPTANCE, APPROVAL OR ACKNOWLEDGMENT OF ANY TERMS CONTAINED IN THE PLAT, INCLUDING THOSE SET FORTH IN THE OWNERS DEDICATION AND THE NOTES AND DOES NOT CONSTITUTE A GUARANTEE OF PARTICULAR TERMS OF NATURAL GAS SERVICE. FOR FURTHER INFORMATION PLEASE CONTACT QUESTAR'S RIGHT-OF-WAY DEPARTMENT AT 1-800-366-8532.

STREET NAMES APPROVED 5-2-06 SIGNED: <u>[Signature]</u>	CHECKED FOR ZONING ZONE <u>R-1-15/BC</u> 30' 15,000 / 1/2 ON DRIVEWAY SETBACKS MAY 2, 2006 SIGNED: <u>[Signature]</u>	PLANNING COMMISSION APPROVED THIS <u>15TH</u> DAY OF <u>MAY</u> , A.D., 20 <u>06</u> BY THE SALT LAKE COUNTY PLANNING COMMISSION. <u>[Signature]</u> CHAIRMAN, SALT LAKE Co. PLANNING COMM.	SALT LAKE VALLEY HEALTH DEPARTMENT APPROVED THIS <u>15TH</u> DAY OF <u>MAY</u> , A.D., 20 <u>06</u> <u>[Signature]</u> DIRECTOR, S.L. VALLEY HEALTH DEPT.	Planning and Development Services I HEREBY CERTIFY THAT THIS OFFICE HAS EXAMINED THIS PLAT AND IT IS CORRECT IN ACCORDANCE WITH INFORMATION ON FILE IN THIS OFFICE. 5/16/06 <u>[Signature]</u> DATE DIRECTOR	APPROVAL AS TO FORM APPROVED AS TO FORM THIS <u>16TH</u> DAY OF <u>May</u> , A.D., 20 <u>06</u> . <u>[Signature]</u> SALT LAKE COUNTY DISTRICT ATTORNEY	SALT LAKE COUNTY MAYOR PRESENTED TO THE SALT LAKE COUNTY MAYOR THIS <u>16</u> DAY OF <u>May</u> , A.D., 20 <u>06</u> , AT WHICH TIME THIS SUBDIVISION WAS APPROVED AND ACCEPTED. <u>[Signature]</u> MAYOR OF DESIGNEE	RECORDED # <u>9725616</u> STATE OF UTAH, COUNTY OF SALT LAKE, RECORDED AND FILED AT THE REQUEST OF <u>Bonneville Superior Title</u> DATE <u>5-16-2006</u> , TIME <u>5:32</u> PM, BOOK <u>2006</u> PAGE <u>157</u> \$96.00 FEE \$ <u>[Signature]</u> SALT LAKE COUNTY RECORDER date: JULY 13, 2005 job no: 3019 PAGE 1 OF 2
---	---	---	---	--	---	--	--

PLANNING AND DEVELOPMENT SERVICES DIVISION, 100 SOUTH STATE STREET, SUITE 100, SALT LAKE CITY, UT 84143, TEL: (801) 468-2500, FAX: (801) 468-2501

CURVE TABLE													
CURVE	LENGTH	RADIUS	TANGENT	CHORD	CH BRG	DELTA	CURVE	LENGTH	RADIUS	TANGENT	CHORD	CH BRG	DELTA
C1	74.86	1030.31	34.45	148.4	S00°20'41"W	4°26'26"	C2	41.40	331.50	46.23	41.61	N60°08'31"E	5°36'04"
C2	NOT USED	-	-	-	-	-	C3	10.00	331.50	35.12	64.81	N46°24'00"E	1°55'28"
C3	NOT USED	-	-	-	-	-	C4 (TOTAL)	161.90	331.50	82.54	160.35	N54°12'00"E	21°29'03"
C4	122.14	1030.31	61.14	122.07	S23°45'12"E	6°41'32"	C5	81.48	362.50	40.41	81.31	S46°53'51"W	12°52'41"
C5	133.71	1030.31	66.45	133.61	S30°52'00"E	7°26'06"	C6	136.01	362.50	68.82	135.22	S46°12'01"W	21°24'52"
C6	63.61	1111.01	24.85	63.62	S32°22'11"E	5°32'22"	C7 (TOTAL)	271.48	362.50	122.19	244.24	S51°04'41"W	34°23'34"
C7	52.36	142.87	16.28	52.25	S38°08'46"E	1°19'05"	C8	170.40	331.50	81.05	168.94	S60°22'15"W	28°39'38"
C8	54.28	142.87	17.25	54.17	S30°46'55"E	1°24'38"	C9	32.10	331.50	16.06	32.08	S43°10'38"W	5°26'55"
C9	184.83	145.34	42.60	184.65	S22°21'11"E	8°51'34"	C10 (TOTAL)	202.44	331.50	104.40	194.41	S51°36'41"W	34°22'34"
C10	NOT USED	-	-	-	-	-	C11	103.62	362.50	52.71	103.21	N48°18'50"E	16°22'41"
C11	216.57	145.34	48.81	216.39	S11°15'31"E	1°15'14"	C12	102.21	362.50	39.24	101.6	N62°22'22"E	11°62'22"
C12	121.5	145.34	40.62	121.01	S01°46'06"E	5°48'21"	C13 (TOTAL)	175.89	362.50	88.65	172.23	N54°12'02"E	21°29'03"
C13	65.43	41.00	42.04	65.10	S46°51'06"W	41°26'02"	C14	NOT USED	-	-	-	-	-
C14	NOT USED	-	-	-	-	-	C15	NOT USED	-	-	-	-	-
C15	NOT USED	-	-	-	-	-	C16	NOT USED	-	-	-	-	-
C16	NOT USED	-	-	-	-	-	C17	NOT USED	-	-	-	-	-
C17	NOT USED	-	-	-	-	-	C18	8.46	280.00	4.86	8.60	S68°02'38"E	1°50'33"
C18	86.11	280.00	46.62	86.38	S81°02'38"W	1°14'36"	C19	83.93	200.00	10.88	83.14	S34°58'55"E	3°10'44"
C19	82.02	52.00	52.34	81.38	S21°55'46"E	4°02'23"	C20 (TOTAL)	144.44	200.00	106.00	141.31	S36°51'11"E	5°55'04"
C20	102.14	52.00	121.14	103.14	S35°58'32"W	1°08'44"	C21	65.32	200.00	32.45	65.03	N11°11'11"W	8°42'43"
C21	25.95	25.00	24.28	24.80	N28°22'55"W	5°11'25"	C22	83.93	195.00	4.21	83.55	S25°22'39"E	2°32'05"
C22	16.81	171.61	35.31	16.30	S00°41'33"W	3°36'36"	C23	10.00	400.00	80.22	102.01	S21°01'44"E	2°35'14"
C23	136.21	121.81	68.18	136.14	S04°43'00"E	6°24'30"	C24	42.92	193.21	21.95	42.83	S20°16'52"E	1°24'33"
C24	28.16	121.81	14.24	28.10	S07°24'28"E	6°02'21"	C25	46.43	193.21	23.33	46.32	S01°10'58"E	1°46'10"
C25	38.52	25.00	34.82	38.52	N30°41'56"E	8°46'16"	C26	45.44	195.00	45.44	45.44	S39°23'41"E	26°29'48"
C26	38.52	25.00	34.82	38.52	N61°02'41"W	8°46'16"	C27	45.44	195.00	45.44	45.44	S39°23'41"E	26°29'48"
C27	103.26	121.81	51.66	103.23	S11°12'55"E	1°51'21"	C28	45.44	195.00	45.44	45.44	S39°23'41"E	26°29'48"
C28	103.26	121.81	51.66	103.23	S11°12'55"E	1°51'21"	C29	45.44	195.00	45.44	45.44	S39°23'41"E	26°29'48"
C29	103.26	121.81	51.66	103.23	S11°12'55"E	1°51'21"	C30	45.44	195.00	45.44	45.44	S39°23'41"E	26°29'48"
C30	103.26	121.81	51.66	103.23	S11°12'55"E	1°51'21"	C31	45.44	195.00	45.44	45.44	S39°23'41"E	26°29'48"
C31	103.26	121.81	51.66	103.23	S11°12'55"E	1°51'21"	C32	45.44	195.00	45.44	45.44	S39°23'41"E	26°29'48"
C32	103.26	121.81	51.66	103.23	S11°12'55"E	1°51'21"	C33	45.44	195.00	45.44	45.44	S39°23'41"E	26°29'48"
C33	103.26	121.81	51.66	103.23	S11°12'55"E	1°51'21"	C34	45.44	195.00	45.44	45.44	S39°23'41"E	26°29'48"
C34	103.26	121.81	51.66	103.23	S11°12'55"E	1°51'21"	C35	45.44	195.00	45.44	45.44	S39°23'41"E	26°29'48"
C35	103.26	121.81	51.66	103.23	S11°12'55"E	1°51'21"	C36	45.44	195.00	45.44	45.44	S39°23'41"E	26°29'48"
C36	103.26	121.81	51.66	103.23	S11°12'55"E	1°51'21"	C37	45.44	195.00	45.44	45.44	S39°23'41"E	26°29'48"
C37	103.26	121.81	51.66	103.23	S11°12'55"E	1°51'21"	C38	45.44	195.00	45.44	45.44	S39°23'41"E	26°29'48"
C38	103.26	121.81	51.66	103.23	S11°12'55"E	1°51'21"	C39	45.44	195.00	45.44	45.44	S39°23'41"E	26°29'48"
C39	103.26	121.81	51.66	103.23	S11°12'55"E	1°51'21"	C40	45.44	195.00	45.44	45.44	S39°23'41"E	26°29'48"
C40	103.26	121.81	51.66	103.23	S11°12'55"E	1°51'21"	C41	45.44	195.00	45.44	45.44	S39°23'41"E	26°29'48"
C41	103.26	121.81	51.66	103.23	S11°12'55"E	1°51'21"	C42	45.44	195.00	45.44	45.44	S39°23'41"E	26°29'48"
C42	103.26	121.81	51.66	103.23	S11°12'55"E	1°51'21"	C43	45.44	195.00	45.44	45.44	S39°23'41"E	26°29'48"
C43	103.26	121.81	51.66	103.23	S11°12'55"E	1°51'21"	C44	45.44	195.00	45.44	45.44	S39°23'41"E	26°29'48"
C44	103.26	121.81	51.66	103.23	S11°12'55"E	1°51'21"	C45	45.44	195.00	45.44	45.44	S39°23'41"E	26°29'48"
C45	103.26	121.81	51.66	103.23	S11°12'55"E	1°51'21"	C46	45.44	195.00	45.44	45.44	S39°23'41"E	26°29'48"
C46	103.26	121.81	51.66	103.23	S11°12'55"E	1°51'21"	C47	45.44	195.00	45.44	45.44	S39°23'41"E	26°29'48"
C47	103.26	121.81	51.66	103.23	S11°12'55"E	1°51'21"	C48	45.44	195.00	45.44	45.44	S39°23'41"E	26°29'48"
C48	103.26	121.81	51.66	103.23	S11°12'55"E	1°51'21"	C49	45.44	195.00	45.44	45.44	S39°23'41"E	26°29'48"
C49	103.26	121.81	51.66	103.23	S11°12'55"E	1°51'21"	C50	45.44	195.00	45.44	45.44	S39°23'41"E	26°29'48"
C50	103.26	121.81	51.66	103.23	S11°12'55"E	1°51'21"	C51	45.44	195.00	45.44	45.44	S39°23'41"E	26°29'48"
C51	103.26	121.81	51.66	103.23	S11°12'55"E	1°51'21"	C52	45.44	195.00	45.44	45.44	S39°23'41"E	26°29'48"
C52	103.26	121.81	51.66	103.23	S11°12'55"E	1°51'21"	C53	45.44	195.00	45.44	45.44	S39°23'41"E	26°29'48"
C53	103.26	121.81	51.66	103.23	S11°12'55"E	1°51'21"	C54	45.44	195.00	45.44	45.44	S39°23'41"E	26°29'48"
C54	103.26	121.81	51.66	103.23	S11°12'55"E	1°51'21"	C55	45.44	195.00	45.44	45.44	S39°23'41"E	26°29'48"
C55	103.26	121.81	51.66	103.23	S11°12'55"E	1°51'21"	C56	45.44	195.00	45.44	45.44	S39°23'41"E	26°29'48"
C56	103.26	121.81	51.66	103.23	S11°12'55"E	1°51'21"	C57	45.44	195.00	45.44	45.44	S39°23'41"E	26°29'48"
C57	103.26	121.81	51.66	103.23	S11°12'55"E	1°51'21"	C58	45.44	195.00	45.44	45.44	S39°23'41"E	26°29'48"
C58	103.26	121.81	51.66	103.23	S11°12'55"E	1°51'21"	C59	45.44	195.00	45.44	45.44	S39°23'41"E	26°29'48"
C59	103.26	121.81	51.66	103.23	S11°12'55"E	1°51'21"	C60	45.44	195.00	45.44	45.44	S39°23'41"E	26°29'48"
C60	103.26	121.81	51.66	103.23	S11°12'55"E	1°51'21"	C61	45.44	195.00	45.44	45.44	S39°23'41"E	26°29'48"
C61	103.26	121.81	51.66	103.23	S11°12'55"E	1°51'21"	C62	45.44	195.00	45.44	45.44	S39°23'41"E	26°29'48"
C62	103.26	121.81	51.66	103.23	S11°12'55"E	1°51'21"	C63	45.44	195.00	45.44	45.44	S39°23'41"E	26°29'48"
C63	103.26	121.81	51.66	103.23	S11°12'55"E	1°51'21"	C64	45.44	195.00	45.44	45.44	S39°23'41"E	26°29'48"
C64	103.26	121.81	51.66	103.23	S11°12'55"E	1°51'21"	C65	45.44	195.00	45.44	45.44	S39°23'41"E	26°29'48"
C65	103.26	121.81	51.66	103.23	S11°12'55"E	1°51'21"	C66	45.44	195.00	45.44	45.44	S39°23'41"E	26°29'48"
C66	103.26	121.81	51.66	103.23	S11°12'55"E	1°51'21"	C67	45.44	195.00	45.44	45.44	S39°23'41"E	26°29'48"
C67	103.26	121.81	51.66	103.23	S11°12'55"E	1°51'21"	C68	45.44	195.00	45.44	45.44	S39°23'41"E	26°29'48"
C68	103.26	121.81	51.66	103.23	S11°12'55"E	1°51'21"	C69	45.44	195.00	45.44	45.44	S39°23'41"E	26°29'48"
C69	103.26	121.81	51.66	103.23	S11°12'55"E	1°51'21"	C70	45.44	195.00	45.44	45.44	S39°23'41"E	26°29'48"
C70	103.26	121.81	51.66	103.23	S11°12'55"E	1°51'21"	C71	45.44	195.00	45.44	45.44	S39°23'41"E	26°29'48"
C71	103.26	121.81	51.66	103.23	S11°12'55"E	1°51'21"	C72	45.44	195.00	45.44	45.44	S39°23'41"E	26°29'48"
C72	103.26	121.81	51.66	103.23	S11°12'55"E	1°51'21"	C73	45.44	195.00	45.44	45.44	S39°23'41"E	26°29'48"
C73	103.26	121.81	51.66	103.23	S11°12'55"E	1°51'21"	C74	45.44	195.00	45.44	45.44	S39°23'41"E	26°29'48"
C74	103.26	121.81	51.66	103.23	S11°12'55"E								