

When Recorded Return To: WCWCD
136 N. 100 E.
St. George, Utah 84770

00929680 Bk 1717 Pg 2676
RUSSELL SHIRTS * WASHINGTON CO RECORDER
2005 MAR 01 16:28 PM FEE \$.00 BY AMH
FOR: WASHINGTON COUNTY WATER CONSERV DIS

VACATION AND REGRANT OF RIGHT-OF-WAY EASEMENT

The WASHINGTON COUNTY WATER CONSERVANCY DISTRICT, Grantee under that certain Easement Agreement dated August 25, 2000, and recorded on September 11, 2000, in Book 1379, Pages 2063-2104, Document 00696150 , in the records of the Washington County Recorder, with WINDING RIVER ASSOCIATES, LLC, a Utah limited liability company as Grantor, hereby vacates the maintenance easement described in Exhibit C therein and attached hereto and incorporated herein as Exhibit A. Grantee relinquishes said easement and re-grants the same, without warranty, to the original grantor and hereby waives any rights thereto, taking nothing by the earlier grant.

WITNESS the hand of said Grantee, this 31st day of August, 2004.

WASHINGTON COUNTY WATER CONSERVANCY DISTRICT

By Ronald W. Thompson
Ronald W. Thompson, General Manager

STATE OF UTAH)
)ss.
COUNTY OF WASHINGTON)

On this 31st day of August, 2004, before me personally appeared RONALD W. THOMPSON whose identity is personally known to or proved to me on the basis of satisfactory evidence, and who, being by me duly sworn (or affirmed), did say that he is the manager of WASHINGTON COUNTY WATER CONSERVANCY DISTRICT and that the foregoing document was signed by him on behalf of Washington County Water Conservancy District by appropriate authority and he acknowledged before me that Washington County Water Conservancy District executed the document and the document was the act of Washington County Water Conservancy District for its stated purpose.

Roberta McMullin
NOTARY PUBLIC

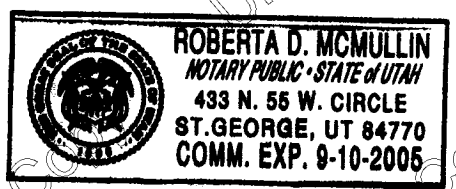

ALPHA ENGINEERING COMPANY

148 East Tabernacle, St. George, UT 84770 • (435) 628-6500 • Fax: (435) 628-6553

EXHIBIT A

**LEGAL DESCRIPTION FOR
50' WIDE MAINTENANCE EASEMENT
FOR SAND HOLLOW PIPE LINE
(August 9, 2000)**

A 50.00-foot wide pipe line maintenance easement, described as follows:

Commencing at the Northeast Corner of Section 1, Township 42 South, Range 14 West, Salt Lake Base and Meridian; **Thence** N 89°52'11" W along the Section line 1914.75 feet; **Thence** South 867.36 feet to the **POINT OF BEGINNING**, said point being on the Southerly right-of-way line of Highway SR-9; **Thence** S 15°48'33" E, a distance of 436.87 feet to the point of curvature to the right having a radius of 1,002.00 feet and a central angle of 23°28'36"; **thence** southerly along the arc of said curve a distance of 410.56 feet; **Thence** S 07°40'03" W, a distance of 220.69 feet to the point of curvature to the left having a radius of 998.00 feet and a central angle of 19°59'26"; **thence** southerly along the arc of said curve a distance of 348.20 feet; **Thence** S 12°19'24" E, a distance of 447.22 feet to the point of curvature to the right having a radius of 2,002.00 feet and a central angle of 21°20'21"; **thence** southerly along the arc of said curve a distance of 745.62 feet; **Thence** S 09°00'57" W, a distance of 2,010.25 feet to the point of curvature to the left having a radius of 1,998.00 feet and a central angle of 08°58'21"; **thence** southerly along the arc of said curve a distance of 312.89 feet; **Thence** S 00°02'36" W, a distance of 4,486.99 feet; **Thence** S 45°00'00" E, a distance of 104.34 feet; **Thence** N 89°39'02" W, a distance of 22.84 feet; **Thence** S 00°02'36" W, a distance of 47.98 feet; **Thence** N 45°00'00" W, a distance of 142.73 feet; **Thence** N 00°02'36" E, a distance of 4,507.72 feet to the point of curvature to the right having a radius of 2,048.00 feet and a central angle of 08°58'21"; **thence** northerly along the arc of said curve a distance of 320.72 feet; **Thence** N 09°00'57" E, a distance of 2,010.25 feet to the point of curvature to the left having a radius of 1,952.00 feet and a central angle of 21°20'21"; **thence** northerly along the arc of said curve a distance of 727.00 feet; **Thence** N 12°19'24" W, a distance of 447.22 feet to the point of curvature to the right having a radius of 1,048.00 feet and a central angle of 19°59'26"; **thence** northerly along the arc of said curve a distance of 365.65 feet; **Thence** N 07°40'03" E, a distance of 220.69 feet to the point of curvature to the left having a radius of 952.00 feet and a central angle of 23°28'36"; **thence** northerly along the arc of said curve a distance of 390.08 feet; **Thence** N 15°48'33" W, a distance of 436.47 feet to a point on the southerly right-of-way of said Highway SR-9; **Thence** N 73°43'59" E, along said right-of-way line a distance of 50.00 feet to the **Point of Beginning**.

Containing: 10.95 acres, more or less.

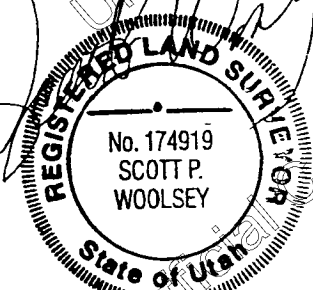

8/9/00