

LAND USE AGREEMENT
TOLMAN WELL #4

00878341 Bk 1636 Pg 0889
RUSSELL SHIRTS * WASHINGTON CO RECORDER
2004 MAY 07 11:14 AM FEE \$.00 BY EMM
FOR: ST GEORGE CITY

DRINKING WATER SOURCE PROTECTION PLAN
ST. GEORGE CITY
WASHINGTON COUNTY, UTAH

We, the undersigned landowner, acknowledge the Drinking Water Source Protection Plan for the City of St. George's Tolman Well #4. We agree to not locate or allow the location of uncontrolled potential contamination sources or pollution sources, as defined in R309-113-6(1)(w) of the Utah Administrative Code (attached), within zone one. Zone one is the area within a 100-foot radius from the wellhead.

More particularly described as a 100.00 foot radius circle being the perimeter boundary for zone one of Tolman Well #4, the center of which is described as follows: beginning at a point N89°46'26" E 957.22 feet along the Section Line and S00°00'00"W 317.78 feet from the East ¼ Corner of Section 23, Township 41 South, Range 16 West, Salt Lake Base and Meridian said point being the center of a 100.00 foot radius circle being the perimeter boundary of said zone one.

The extent of zone one is portrayed on the attached figure, herein incorporated by reference as part of this agreement. The portion of zone one that is covered by this agreement encompasses approximately 0.72 acres.

If at such time, the well is abandoned as a drinking water source for the City of St. George, then this Land Use Agreement is considered null and void. This agreement is binding on all heirs, successors and assigns.

R.C. Tolman
RC Tolman

State of)
County of)

on this the 7th day of May, 2004 before me Dorothy H. Nielson, a Notary Public, personally appeared R.C. Tolman, personally known to me to be the persons whose names are subscribed to on this instrument, and acknowledged that they executed the same.

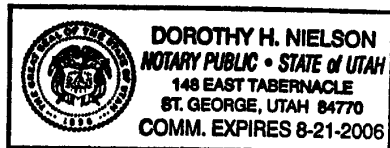

Dorothy H. Nielson
Notary Public

8-21-06
My commission expires

00878341 Bk 1636 Pg 0890

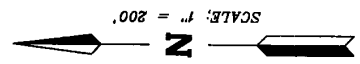

WELL SITE #1

EAST 1/4 CORNER SECTION 23,
T. 41 S. R. 16 W. SLB&M.

N89°46'26"E

957.22'

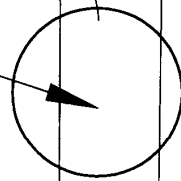

517.78'
SOUTH

PACIFICORP.

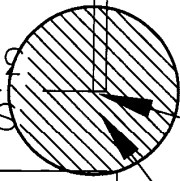

100' RADIUS

TOLMAN WELL #4
0.72 ACRES

TOLMAN WELL #4
LAND USE AGREEMENT EXHIBIT
(041-69-WELL4-EXHIBIT.DWG)
APRIL 27, 2004

& ALPHA
ENGINEERING COMPANY
148 E TABERNACLE ST GEORGE, UT 84770
Telephone: (435) 628-6500