

WHEN RECORDED MAIL TO:

Questar Regulated Services Company  
P.O. Box 45360, Right-of-Way  
Salt Lake City, UT 84145-0360  
05810nrw.26

ENT 60616;2002 PG 1 of 7  
RANDALL A. COVINGTON  
UTAH COUNTY RECORDER  
2002 May 29 10:48 am FEE 23.00 BY JRD  
RECORDED FOR QUESTAR GAS COMPANY

*Space above for County Recorder's use*

**NOTICE OF EXISTING RIGHT-OF-WAY AND EASEMENT**  
UT 05810

QUESTAR GAS COMPANY (Questar Gas) is the present owner of a right-of way and easement (Easement) dated March 16, 1953 from David Shuler aslo known as Dave Shuler and Erma N. Shuler to Utah Natural Gas Company recorded April 23, 1953 as Entry #4741 in Book 615 at Pages 482-484 of the records of Utah County, State of Utah. Questar Gas more specifically defines the Easement as a 60.0 foot wide strip of land (Reserved Right-of-Way) for a natural gas pipeline(s) with all rights contained in the Easement, including rights of ingress and egress to said Reserved Right-of-Way. The centerline of the Reserved Right-of-Way crosses the following described lands:

BEGINNING AT A POINT WHICH IS SOUTH 89°59'55" EAST 42.39 FEET FROM THE NORTH QUARTER CORNER OF SECTION 26, T.9S., R.2E. SALT LAKE BASE AND MERIDIAN TO A POINT ON SAID ORIGINAL PARCEL; THENCE SOUTH 37°55'27" WEST 67.73 FEET; THENCE SOUTH 38°02'03" WEST 452.15 FEET; THENCE SOUTH 37°54'03" WEST 570.77 FEET; THENCE SOUTH 37°59'15" WEST 198.84 FEET; THENCE SOUTH 38°14'17" WEST 226.53 FEET; THENCE SOUTH 36°44'33" WEST 68.72 FEET; THENCE SOUTH 38°16'53" WEST 168.97 FEET; THENCE SOUTH 38°09'43" WEST 148.17 FEET; THENCE SOUTH 37°56'12" WEST 157.85 FEET; THENCE SOUTH 38°52'06" WEST 135.11 FEET; THENCE SOUTH 37°59'42" WEST 4000.19 FEET; THENCE SOUTH 37°42'49" WEST 188.63 FEET TO THE POINT OF TERMINUS.

ALSO BEGINNING AT A POINT WHICH IS WEST 527.16 FEET AND SOUTH 4.74 FEET FROM THE EAST QUARTER CORNER OF SECTION 23, T.9S., R.2E., SALT LAKE BASE AND MERIDIAN; THENCE S 33°09'58" WEST, 25.14 FEET; THENCE S 38°02'41" WEST, 539.80 FEET; THENCE S 37°57'31" WEST, 2881.83 FEET; TO THE POINT OF TERMINUS.

The Reserved Right-of-Way is shown on the attached Exhibits A and B and is by this reference made a part of this document.

Questar Gas has the right of ingress and egress over and across the Reserved Right-of-Way for the purpose of laying, maintaining, operating, replacing and removing said natural gas pipeline(s). Questar Gas interprets the Easement and the Reserved Right-of-Way to mean that above ground structures and buildings are prohibited within the Reserved Right-of-Way. This prohibition applies to brick, concrete or block fences. As a matter of policy Questar Gas will permit wooden and/or chain link fences on the Reserved Right-of-Way, if the owners follow the property line and cross the Reserved Right-of-Way at an angle which is not less than 30° to the pipeline location and a 36 inch high gate is installed at each pipeline crossing for patrol and maintenance access. Landscaped areas are permitted within the Reserved Right-of-Way and over the pipeline as long as Questar Gas is notified of development plans and approves all proposed work prior to construction. Trees are not permitted within the Reserved Right-of-Way. The placement of lawn within the Reserved Right-of-Way does not require approval. Concrete and asphalt are not permitted within the Reserved Right-of-Way without the prior written consent of Questar Gas except for access to a home. Other utilities may be installed within the Reserved Right-of-Way with the written permission of Questar Gas. Such utilities must maintain a minimum of three feet horizontal clearance (five feet preferred), and a minimum of 12 inches vertical clearance at the crossing point between other said utilities and the pipeline. A minimum of three feet, but not more than six feet of cover must be maintained over the pipeline at all times. The ground contour cannot be changed within the Reserved Right-of-Way or anywhere near the Reserved Right-of-Way if these depths are compromised. Other utilities located within the Reserved Right-of-Way must comply with the Damage to Underground Facilities Act, Utah Code Ann. §§ 54-82-1 et seq.

For additional information contact Questar Regulated Services Company, Right-of-Way Department, 1140 West 200 South, P.O. Box 45360, Salt Lake City, Utah 84145- 0360, Telephone: (801)324-5555.

Dated this 24<sup>th</sup> day of May, 2002.

QUESTAR GAS COMPANY

By: Todd C. Cassity  
Todd C. Cassity, Attorney-In-Fact

STATE OF UTAH )  
 ) ss.  
COUNTY OF SALT LAKE )

ENT 60616:2002 PG 3 of 7

On the 24<sup>th</sup> day of May, 2002, personally appeared before me Todd C. Cassity, who, being duly sworn, did say that he is Attorney-In-Fact for QUESTAR GAS COMPANY, and that the foregoing instrument was signed on behalf of said corporation by authority of a resolution of its Board of Directors, an official certification of which is recorded as Entry #94697, at Book 5194, Page 253, in the Office of the Utah County Recorder.

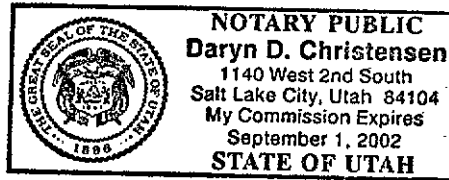

*Daryn D. Christensen*  
Notary Public

22 26  
27 26

KERRY O. ABAY  
EUNICE H. ABAY  
PARCEL ID# 800780088  
UT# 0580

(BASIS OF BEARING)  
S89°24'57"W  
2482.49'

DEBBERT KNOLLS LTD.  
PARCEL ID# 800700005  
UT# 0580

THOMAS B. MANN  
NORMA J. MANN  
PARCEL ID# 800670005  
UT# 0580

OAK BURN ESTATES  
SUBDIVISION  
PLAT 10

OAK BLISS ESTATES  
SUBDIVISION  
PLAT 11

MECHAM DEVELOPMENT  
UT# 0580

PAYSON CITY  
PARCEL ID# 800780074  
UT# 0580

RONALD C. COLLINGS  
JOYCE V. COLLINGS  
PARCEL ID# 800780228  
UT# 0580

LPM PROPERTIES LLC  
PARCEL ID# 800780230  
UT# 0580

KARL H. BRULER  
SHARON P. BRULER  
PARCEL ID# 800780008  
UT# 0580

ENT 60616:2002 PG 4 of 7

JOHN BK. KAUNE JR.  
PARCEL ID# 800780088  
UT# 0580

DAVID L. PALFREYMAN  
KATHLEEN S. PALFREYMAN  
PARCEL ID# 800780058  
UT# 0580

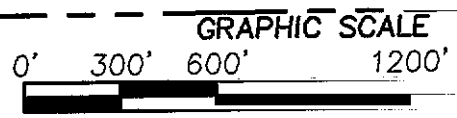

Scale: 1"=600'

27 26  
34 05

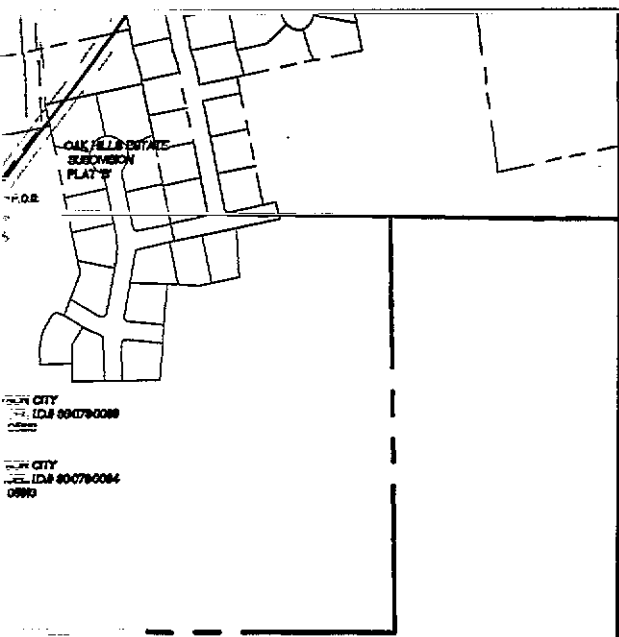

UTAH CITY  
 I.D.# 000790088  
 0896

UTAH CITY  
 I.D.# 000790084  
 0896

SECTION 23  
 TOWNSHIP 9 SOUTH  
 RANGE 2 EAST  
 SALT LAKE MERIDIAN  
 UTAH COUNTY, UT

ORIGINAL R.O.W. UT # 05810:

CENTERLINE DESCRIPTION OF AN EXISTING 60' R.O.W. RESERVED FOR QUESTAR GAS CO.:  
 BEGINNING AT A POINT WHICH IS S 89°59'55" E, 42.39 FT FROM THE NORTH QUARTER CORNER OF SECTION 26, T.9S., R.2E., SALT LAKE BASE AND MERIDIAN TO A POINT ON SAID ORIGINAL PARCEL; THENCE S 37°55'27" W, 67.73 FT; THENCE S 38°02'03" W, 452.15 FT; THENCE S 37°54'03" W, 570.77 FT; THENCE S 37°59'15" W, 198.84 FT; THENCE S 38°14'17" W, 226.53 FT; THENCE S 36°44'33" W, 68.72 FT; THENCE S 38°16'53" W, 168.97 FT; THENCE S 38°09'43" W, 148.17 FT; THENCE S 37°56'12" W, 157.85 FT; THENCE S 38°52'06" W, 135.11 FT; THENCE S 37°59'42" W, 4000.19 FT; THENCE S 37°42'49" W, 188.63 FT; TO THE POINT OF TERMINUS.

THE ABOVE DESCRIPTIONS WERE PREPARED UNDER THE SUPERVISION OF JAMES DALE PITKIN, PROFESSIONAL LAND SURVEYOR IN UTAH #171546, FROM THE RESULTS OF A FIELD SURVEY FOR QUESTAR GAS COMPANY.

BASIS OF BEARING, IS BETWEEN TWO FOUND SECTION CORNERS, BEING THE NORTH 1/4 CORNER OF SECTION 13, (A FOUND BRASS CAP), AND THE NORTHEAST CORNER OF SAID SECTION 13, TOWNSHIP 9 SOUTH, RANGE 2 EAST, SALT LAKE BASE AND MERIDIAN, (A FOUND BRASS CAP), MEASURED BETWEEN FOUND MONUMENTS SOUTH 89°24'57" WEST 2662.49 FT.

**EXHIBIT "A"**

ENT 60616:2002 PG 5 of 7

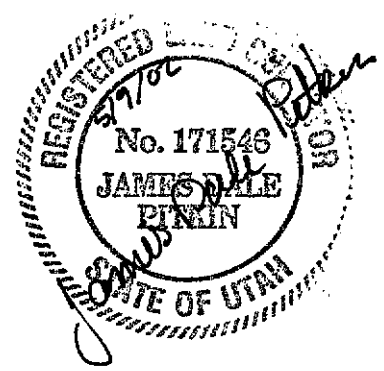

1800'

ENGINEERING RECORD			QUESTAR Gas	
W.O. -	PROJECT ENGINEER: B. LEE		<b>RIGHT-OF-WAY REQUIRED</b> <b>for a 24' PIPELINE</b> <b>UT # 05810</b>	
SURVEYED: G. PRATT 05/01	SECTION: 23			
DRAWN: E. PAEZ 04/02	TOWNSHIP: 9 S RANGE: 2 E			
CHECKED: J. PITKIN 04/02	COUNTY/STATE: UTAH CO. UTAH			
APPROVED: C. MOORE 04/02	LINE/AREA FEEDER LINE 26 / UT			
REVISIONS			SCALE: 1"=600'	DRAWING NUMBER
NO.	DESCRIPTION	DATE/BY	SHEET No. 1	05810A
-	-	-	CAD FILE: 5810A	REV. 0
-	-	-		
-	-	-		
-	-	-		
-	-	-		
REFERENCE DRAWINGS				
NO.	DESCRIPTION			
-	-			
-	-			
-	-			
-	-			

ELK RIDGE CORP.

SOUTH 4.74'  
S33°09'58"W 25.14'

THE  
PAR  
PAR  
UT#

W +  
PAR  
UT#

WAF  
CI  
PAR  
UT#

SALEM HILLS  
SUBDIVISION  
PLAT 'G'  
UT# 05810

SALEM HILLS  
SUBDIVISION  
PLAT 'I'  
UT# 05810

SAI  
SU  
PLA  
UT#

SALEM HILLS  
SUBDIVISION  
PLAT 'E'  
UT# 05810

ENT 60616:2002 PG 6 of 7

SALEM HILLS  
SUBDIVISION  
PLAT 'I'  
UT# 05810

OAK HILLS ESTATE  
SUBDIVISION  
PLAT 'B'  
UT# 05810

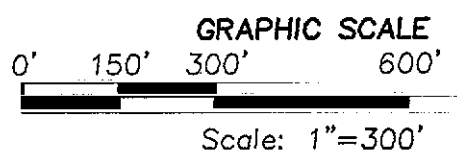

E 1/4 CORNER SECTION 23  
T. 9S, R. 2E, S.L.B. AND M.

WEST  
527.16' 23-24

BROWN FAMILY LTD.  
SHIP  
ID.# 30-075-0106  
HO

BROWN FAMILY LTD.  
ID.# 30-075-0107  
HO

D. BROWN +  
EEN S. BROWN  
ID.# 30-075-0108  
HO

HILLS  
VISION  
D'  
310

SECTION 23  
TOWNSHIP 9 SOUTH  
RANGE 2 EAST  
SALT LAKE MERIDIAN  
UTAH COUNTY, UT

ORIGINAL R.O.W. UT # 05810:

CENTERLINE DESCRIPTION OF AN EXISTING 60' R.O.W. RESERVED FOR QUESTAR GAS CO.:

BEGINNING AT A POINT WHICH IS WEST 527.16 FT AND SOUTH 4.74 FT FROM THE EAST QUARTER CORNER OF SECTION 23, T.9S., R.2E., SALT LAKE BASE AND MERIDIAN TO A POINT ON THE SOUTHERN BOUNDARY LINE OF ORIGINAL UT ROW PARCEL #05812; THENCE S 33°09'58" W, 25.14 FT; THENCE S 38°02'41" W, 539.80 FT; THENCE S 37°57'31" W, 2881.83 FT; TO A POINT ON THE NORTHERN BOUNDARY LINE OF ORIGINAL UT ROW PARCEL #05810; ALSO BEING THE POINT OF TERMINUS.

THE ABOVE DESCRIPTIONS WERE PREPARED UNDER THE SUPERVISION OF JAMES DALE PITKIN, PROFESSIONAL LAND SURVEYOR IN UTAH #171546, FROM THE RESULTS OF A FIELD SURVEY FOR QUESTAR GAS COMPANY.

BASIS OF BEARING, IS BETWEEN TWO FOUND SECTION CORNERS, BEING THE NORTH 1/4 CORNER OF SECTION 13,(A FOUND BRASS CAP), AND THE NORTHEAST CORNER OF SAID SECTION 13, TOWNSHIP 9 SOUTH, RANGE 2 EAST, SALT LAKE BASE AND MERIDIAN,(A FOUND BRASS CAP), MEASURED BETWEEN FOUND MONUMENTS SOUTH 89°24'57" WEST 2662.49 FT.

ENT 60616:2002 PG 7 of 7 !!

EXHIBIT "B"

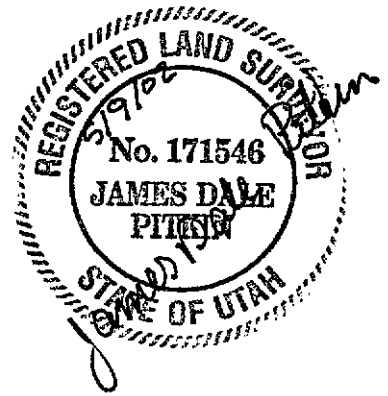

ENGINEERING RECORD				QUESTAR Gas		
W.O. -	PROJECT ENGINEER: B. LEE			RIGHT-OF-WAY REQUIRED for a 24' PIPELINE UT# 05810		
SURVEYED: G. PRATT	05/01	SECTION: 23				
DRAWN: E. PAEZ	04/02	TOWNSHIP: 9 S RANGE: 2 E				
CHECKED: J. PITKIN	04/02	COUNTY/STATE: UTAH CO. UTAH				
APPROVED: C. MOORE	04/02	LINE/AREA: FEEDER LINE 26 / UT				
REVISIONS						
NO.	DESCRIPTION	DATE	BY	SCALE: 1"=300'	DRAWING NUMBER	REV.
-	-	-	-	SHEET No. 1	05810B	0
-	-	-	-	CAD FILE: 5810B		
-	-	-	-			
REFERENCE DRAWINGS						
NO.	DESCRIPTION					
-	-					
-	-					
-	-					
-	-					

900'