

Land Use Agreement

Execution of this agreement by Circle Four Farms (Operator) and Circle Four Farms (Grantor) signifies supercedence over, and complete negation of a previous Land Use Agreement executed for the same purpose, dated and signed by Grantor on the. After test pumping of the subject wells, the original protections zones or LAND have been changed to reflect actual conditions of the aquifer and water source in the area.

RECITALS. Circle Four Farms desires to secure adequate protection for drinking water wells located as shown in Exhibit A of this Agreement. More specifically, the locations of these wells are: Well # BMS1, located North 110 feet and East 521 feet, from the Southwest Corner of Section 7, Township 31 South, Range 13 West, Salt Lake Base and Meridian; Well # BMS2, located North 270 feet and East 715 feet from the South Quarter Corner of Section 7, Township 31 South, Range 13 West, Salt Lake Base and Meridian; and Well # BMS3, located South 2,349 feet and East 240 feet from the North Quarter corner of Section 18, Township 31 South, Range 13 West, Salt Lake Base and Meridian. For the purposes of this Agreement, Zones 1 and 2 encompassing the above referenced wells are identified as shown in Exhibit A and includes those portions which partially lie within the Grantors land, specifically within the South ½ of Section 7, Township 31 South Range 13 West, Salt Lake Base and Meridian, and those portions shown in the East ½ of Section 18 Township 31 South, Range 13 West, Salt Lake Base and Meridian.

AGREEMENT.

Circle Four Farms (Grantor) acknowledges the Drinking Water Source Protection Plan(s) for the above referenced wells. Circle Four Farms agrees not to allow the location of any uncontrolled potential contamination sources, as defined in R309-600-6(1)(u) of the Utah Administrative Code within Zone 1. Circle Four also agrees not to locate or allow the location of any pollution sources as defined in R309-600-6(1)(t) of the Utah Administrative Code within Zone 2, unless design standards are implemented to prevent contaminated discharges.

The controls and limitations of this Agreement within Zones 1 and 2 are binding with all successors, heirs, and assigns for as long as the well is used for culinary purposes.

Circle Four Farms (Operator) and Circle Four Farms (Grantor) agrees that a previous Land Use Agreement executed on April 4, 2001 becomes null and void.

00467978 Bk00876 Pg00883-00885
FATSY CUTLER - IRON COUNTY RECORDER
2003 JUN 30 11:03 AM FEE \$15.00 BY PTC
REQUEST: CIRCLE FOUR FARMS

Witness, the hand of said Operator and Grantor this 20th day of June, A.D. 2007³

By: [Signature]
K. Erik Jacobsen, General Manager, Circle Four Farms

State of Utah, County of Iron.

On the 20th day of June, A.D., 2007³, personally appeared before me,
K. Erik Jacobsen of Circle Four Corporation, the witness of this
instrument, who duly acknowledges to me the execution of the same.

[Signature]
Notary Public

My Commission Expires 01.13.05. Residing in Milford, Utah.

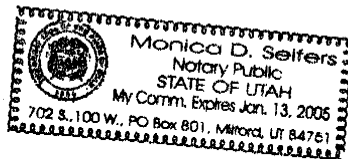

00467978 Bk00876 Pg00884

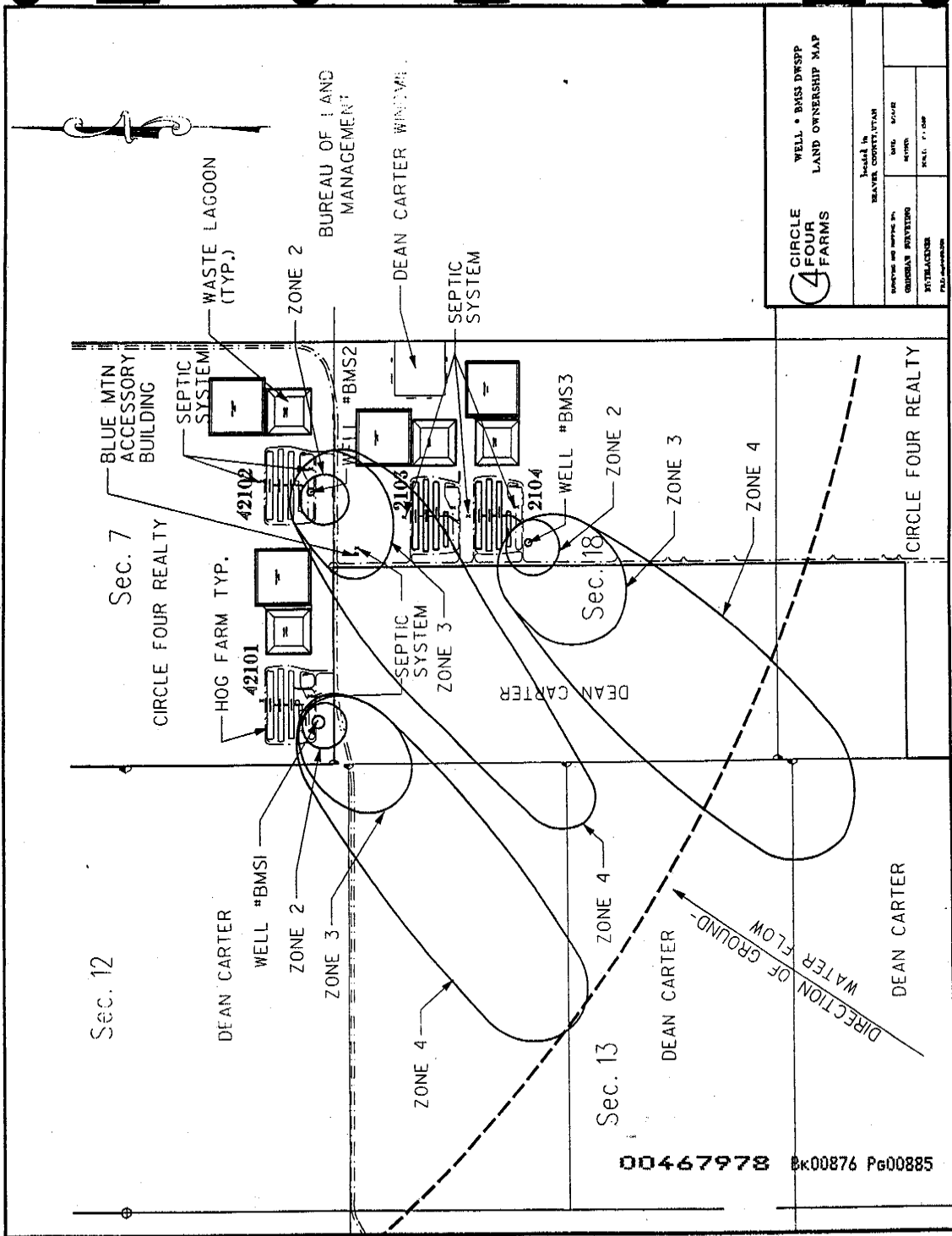

| | | |
|---|---|----------------------|
| CIRCLE FOUR FARMS WELL # BMS1 DRSP LAND OWNERSHIP MAP | Section 13 BEAVER COUNTY, UTAH | |
| | SURVEY AND MAP BY: GEORGE H. HAYES REGISTERED PROFESSIONAL SURVEYOR | DATE: 10/10/02 |
| PROJECT NO.: 00467978 | | SHEET NO.: 000885 |
| FIELD NO.: 000885 | | SCALE: 1" = 100' |

00467978 Bk00876 Pg00885