

ORDINANCE #87-20

AN ORDINANCE MODIFYING THE OFFICIAL STREET MAP OF SANDY CITY ESTABLISHING THE ALIGNMENT AND A WIDTH OF 106 FEET FOR THE RIGHT OF WAY FOR 2000 EAST, ALSO KNOWN AS HIGHLAND DRIVE, FROM 9800 SOUTH, RUNNING SOUTH TO THE SOUTHERN BORDER OF SANDY CITY; AND ESTABLISHING AN EFFECTIVE DATE.

BE IT KNOWN AND REMEMBERED that the City Council of Sandy City, State of Utah finds and determines as follows:

WHEREAS, the City Council has been granted specific authority to regulate, plan and establish public streets within Sandy City and may amend such regulations and plans, under provisions of Section 10-9-23, Utah Code Annotated 1953; and

WHEREAS, a modification to the official street map has been proposed; and

WHEREAS, the Planning Commission of Sandy City has held a public meeting on March 5, 1987 to consider said proposal and has approved such modification; and

WHEREAS, the City Council has held a public hearing on April 7, 1987 to consider said proposal; and

WHEREAS, the hearing was preceded by public notice, posted in Sandy City Hall on March 16, 1987 and published in the Sandy Sentinel on March 19, 1987; and

WHEREAS, the establishment of an alignment and a width of 106 feet for the right-of-way for 2000 East, also known as Highland Drive, from 9800 South running south to the southern border of the City is in the best interest of the health, safety and welfare of the City's residents; and

WHEREAS, the effect of this alignment will be to restore 2000 East to its original 106 foot width;

NOW, THEREFORE, BE IT ORDAINED by the City Council of Sandy, State of Utah, that the Official Street Map of Sandy city is hereby modified by establishing the alignment and a width of 106 feet for the right-of-way for 2000 East, also known as Highland Drive, from 9800 South running south to the southern border of the City as shown on Exhibit A which is attached hereto and by this reference made a part hereof.

Section 2: All former ordinances or parts thereof conflicting or inconsistent with the provisions of this

ordinance hereby adopted are hereby repealed.

Section 3. The provisions of this ordinance shall be severable; and if any provision thereof, or the application of such provision under any circumstances is held invalid, it shall not affect any other provision of this ordinance, or the application in a different circumstance.

Section 4. This ordinance shall become effective upon its publication as required by law.

PASSED AND APPROVED by the Sandy City Council this 28th day of April, 1987.

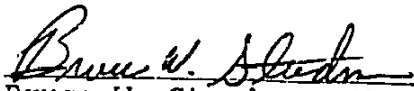

Bruce W. Steadman, Chairman
Sandy City Council

PRESENTED to the Mayor of Sandy City for his approval this 6th day of May, 1987.

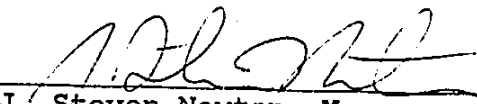
APPROVED by the Mayor of Sandy City this 8th day of May, 1987.



J. Steven Newton, Mayor

ATTEST:

City Recorder

RECORDED this 12th day of May, 1987.

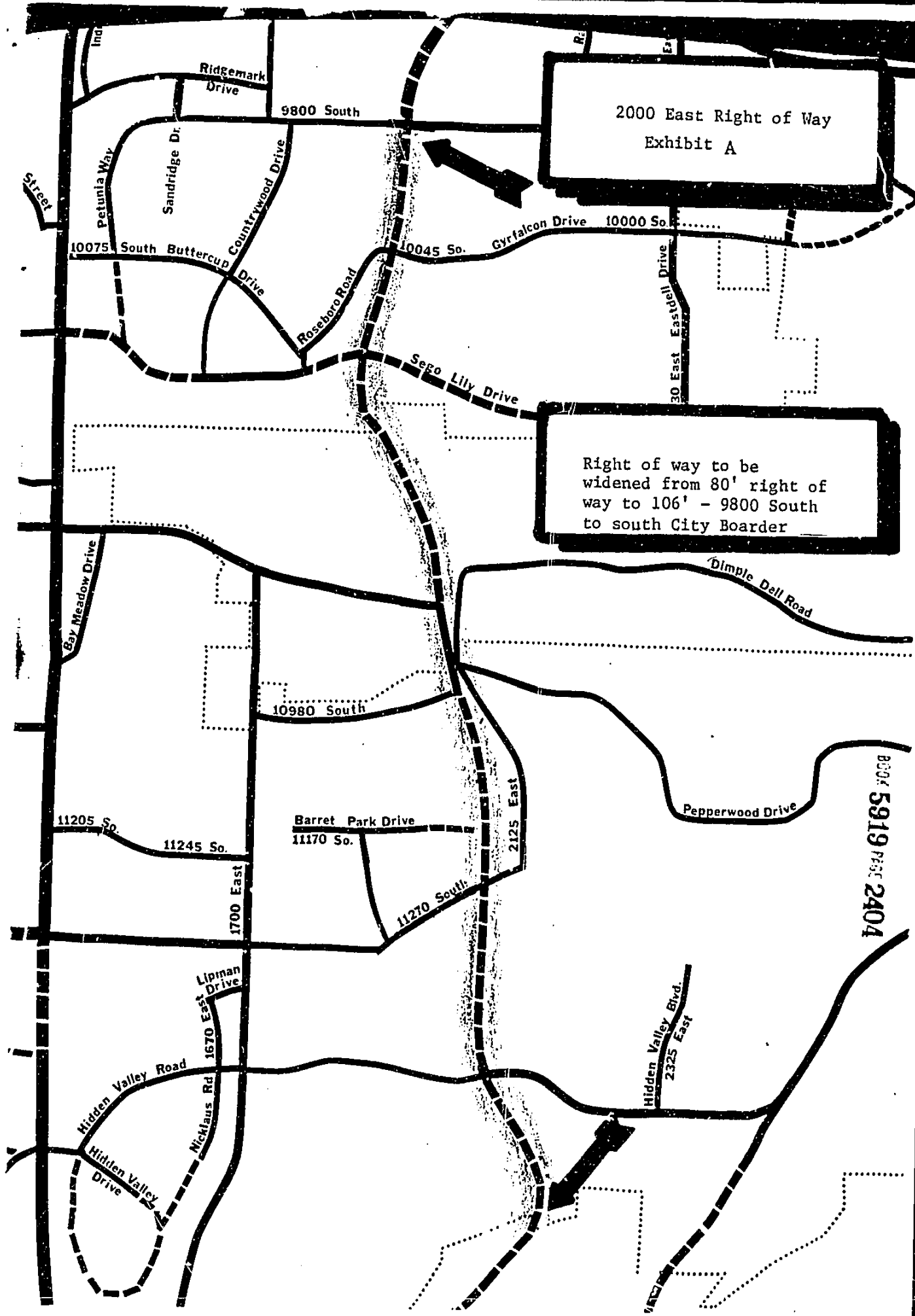
BOOK 5919 PAGE 2403



2000 East Right of Way
Exhibit A

Right of way to be
widened from 80' right of
way to 106' - 9800 South
to south City Boarder

8804 5919 Part 2404

Ridgemark Drive
9800 South

Sandridge Dr.
Countrywood Drive
10075 South Buttercup Drive

10045 So. Gyrfalcon Drive 10000 So.

Roseboro Road
Sego Lily Drive

Bay Meadow Drive

10980 South

11205 So.
11245 So.

Barret Park Drive
11170 So.

11270 South

Lipnan Drive

Hidden Valley Road

Hidden Valley Drive

Nicklaus Rd. 1670 East

Hidden Valley Blvd. 2325 East