

When Recorded Return To:  
Focus Engineering and Surveying, LLC  
ATTN: Justin D. Lundberg  
6949 South High Tech Drive, Suite 200  
Midvale, UT 84047



ENT 4404:2022 PG 1 of 1  
ANDREA ALLEN  
UTAH COUNTY RECORDER  
2022 Jan 11 2:32 pm FEE 40.00 BY LT  
RECORDED FOR FOCCUS ENGINEERING

### SURVEYOR'S AFFIDAVIT

I, Evan J. Wood, being a duly licensed Professional Land Surveyor in the State of Utah, holding Certificate No. 183395, do hereby swear:

That a Subdivision Plat was prepared by Focus Engineering and Surveying, and certified by Spencer W. Llewelyn, said Subdivision being, MADISON MEADOWS EAST recorded in the Office of the Utah County Recorder's Office, Entry No. 200544:2021 December 1<sup>st</sup> 2021.

Said Plat contains the following errors and omissions:

- The easterly boundary of MADISON MEADOWS EAST, was established by two (2) previous survey's, a survey by George B. Wilson, dated Feb. 27, 2004 filed in the Utah County Surveyors Office as No. 04-113 and an unfiled survey prepared by Cole Surveying and Engineering dated July 9, 2014. In said survey's the easterly boundary of said subdivision is called to run along an existing wire fence. Said easterly boundary is intended to be coincident with the boundary between Madison Meadows LLC, Parcel No. 13:008:0014 and Robert W. Kirkham, Parcel No. 13:008:0005.

Further sayeth Affiant naught.

*Evan J. Wood*  
 \_\_\_\_\_  
 Evan J. Wood PLS #183395  
 Focus Engineering & Surveying, LLC  
 6949 South High Tech Drive, Suite 200  
 Midvale, Utah 84047

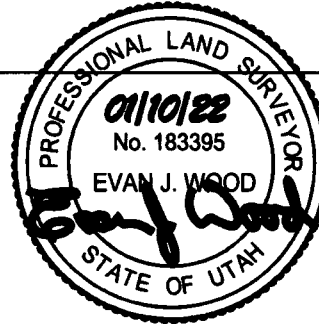

*01/10/2022*  
Date

STATE OF UTAH

COUNTY OF UTAH

On the 10 day of January A.D., 2022, personally appeared before me, the undersigned Notary Public, in and for the County of Utah in said State of Utah, Evan J. Wood who duly acknowledged to me that he is a Professional Land Surveyor in the State of Utah and that he did sign the forgoing instrument.

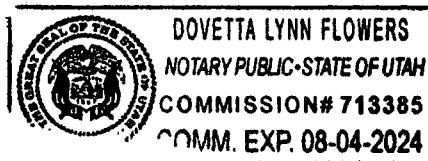

*Dovetta Lynn Flowers*  
A Notary Public Commissioned in Utah