

N 1/4 COR. SEC. 10,
T. 2 S., R. 1 E.,
S. L. B. & M.

ORIGINAL DESCRIPTION:
Beginning at a point which is 174.44 feet N 15°28'30" W and 187.18 feet S 65°41'30" W and 135.67 feet S 45°30' E from the North Quarter Corner of Section 10, T. 2 S., R. 1 E., S. L. B. & M.; thence S 45°30' E 31.06 feet; thence S 59°31'56" W 209.38 feet; thence N 46°25' W 32.38 feet; thence N 65°41'30" E 78.79 feet; thence N 26°21'03" W 108.00 feet; thence N 65°41'30" E 24.00 feet; thence S 26°21'03" E 108.00 feet; thence N 65°41'30" E 144.53 feet; thence N 24°18'30" W 114.91 feet; thence N 65°41'30" E 132.00 feet; thence N 24°18'30" W 114.91 feet; thence N 65°41'30" E 30.00 feet; thence S 24°18'30" E 111.93 feet; thence N 59°31'56" E 171.82 feet to the point of beginning.

NEW DESCRIPTION:
Beginning at a point which is 21.94 feet South and 99.28 feet West from the North quarter corner of Section 10, T. 2 S., R. 1 E., S. L. B. & M.; thence S 45°30' E 31.06 feet; thence S 59°31'56" W 209.38 feet; thence S 65°41'30" W 239.15 feet; thence N 46°25' W 32.38 feet; thence N 65°41'30" E 78.79 feet; thence N 26°21'03" W 108.00 feet; thence N 65°41'30" E 24.00 feet; thence S 26°21'03" E 108.00 feet; thence N 65°41'30" E 144.53 feet; thence N 24°18'30" W 114.91 feet; thence N 65°41'30" E 30.00 feet; thence S 24°18'30" E 111.93 feet; thence N 59°31'56" E 171.82 feet to the point of beginning.

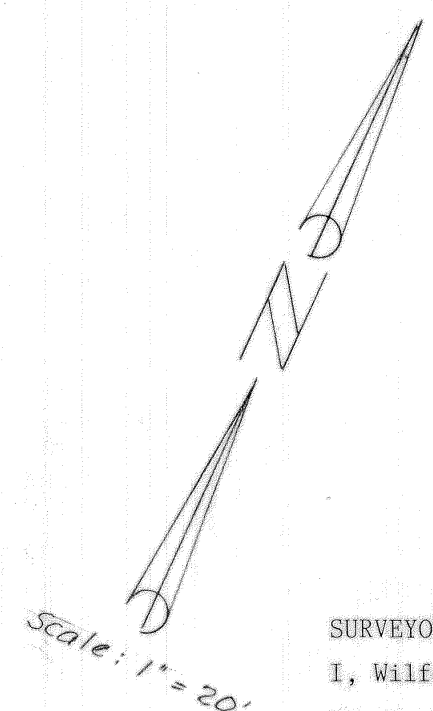

HOLLADAY VILLA "B"
APARTMENT HOMES

RECORDED # 439079
STATE OF UTAH, COUNTY OF SALT LAKE, RECORDED AND FILED AT THE REQUEST OF
L. A. Jolley
DATE 1-26-87 TIME 4:46 PM BOOK 87-1 PAGE 5
FEE \$ 16.00
Andrew Jolley
DEPUTY SALT LAKE COUNTY RECORDER

SURVEYOR'S CERTIFICATE:
I, Wilford W. Ruf, certify that I am a Registered Land Surveyor as prescribed by the laws of the State of Utah, holding certificate #4782; I further certify that the survey shown on this plat was done under my supervision and that the location, distances and bearings are as shown hereon.

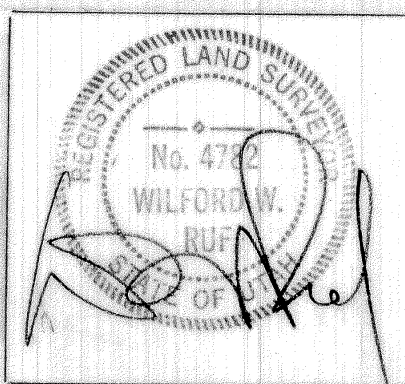

PREPARED BY
KING ASSOCIATES
325 EAST EXECUTIVE PARK DRIVE SUITE "A"
SALT LAKE CITY, UTAH 84117
(801) 261-5657

HOLLADAY DENTAL CENTER RELOCATION	DATE 12/3
CORRECTED EASEMENT LOCATION	JOB 2039
FOR DICK RANDLE & LEE JOLLEY	SHEET 1

22-10-12 \$16.00 **87-1-5**

87-1-5