

MEMORANDUM OF Filed By CBM
EXPLORATION AND DEVELOPMENT AGREEMENT FOR UTE ENERGY & MINERALS
WASATCH COUNTY CORPORATION

THIS MEMORANDUM OF EXPLORATION AND DEVELOPMENT AGREEMENT ("Memorandum") dated July 13, 2004, as amended and restated September 24, 2004, sets forth a summary of the material provisions of the Exploration and Development Agreement (the "EDA"), by and between the UTE INDIAN TRIBE OF THE UINTAH AND OURAY RESERVATION, P.O. Box 190, Fort Duchesne, Utah 84026, (the "Ute Indian Tribe") and BILL BARRETT CORPORATION ("BBC"), 1099 18th Street, Suite 2300 Denver, CO 80202, and BERRY PETROLEUM COMPANY ("Berry"), 410 17th Street, Suite 2440, Denver, CO 80202 (jointly, the "Company"), and the UTE DISTRIBUTION CORPORATION ("UDC"), P.O. Box 696, Roosevelt, Utah 84066, dated July 13, 2004, as amended September 24, 2004.

The EDA, together with its various exhibits, provides that the Company shall have the exclusive right for fifteen years to enter onto and evaluate, explore, drill exploratory wells and obtain oil and gas leases (the "Leases") in order to drill wells and install necessary facilities to develop oil and gas resources, including coalbed methane, owned by Ute Indian Tribe and UDC and underlying certain lands in Duchesne and Wasatch Counties, Utah, as more particularly described in Exhibit A hereto (referred to as the "Contract Premises"). Further, the EDA includes, but is not limited to, the following terms and conditions:

1. Payments to Ute Indian Tribe and UDC. Company will pay and Ute Indian Tribe and UDC will receive specified bonus and royalty payments and the Ute Indian Tribe also will receive specified throughput payments from Company, all in accordance with the terms of the EDA, and the terms of various agreements to be entered into by the parties pursuant to the EDA.

2. Oil and Gas Leases. Company will earn the Leases by drilling exploration wells and by drilling development wells, and undertaking related obligations pursuant to specific terms of the EDA, subject to the normal and customary approval of such Leases by the Secretary of the Interior.

3. Ute Indian Tribe's Right to Participate. The Ute Indian Tribe has and may exercise a right to participate as a 25% working interest owner in the Leases and wells under conditions specified in the EDA.

4. Access to Surface. Company and the "Gathering System Entity", which will be formed pursuant to the EDA, shall have full rights of ingress and egress to enter the surface of the Lands, and to install, construct and maintain any and all facilities and equipment related to operations under the EDA including operations under each Lease. This includes drilling wells, construction of roads and pipelines, and installation and operation of equipment and facilities, including tank batteries, serving one or more Leases.

I hereby certify this document to be a true and complete copy of the original document, containing 17 pages, on file on this office

Memorandum of Agreement

BIA Agency/Office

10/05/2004

Date

Stella C. Slack

Signature

5. Gathering System Entity. A new entity will be formed to own and operate the gathering system for operations under the EDA and Leases issued pursuant to the EDA. The Ute Indian Tribe has and may exercise a right to participate as a 25% owner in the Gathering System Entity.

6. Exclusivity. The rights granted to Company under the EDA are exclusive for the term of the EDA. Except with respect to portions of the Contract Premises which might be surrendered or relinquished by Company pursuant to the EDA and/or the Leases, the Ute Indian Tribe and UDC will not grant any third party rights to evaluate data related to oil and gas development, conduct exploration activities, or develop the oil and gas resources anywhere on the Contract Premises without Company's prior written consent.

7. Exploration Term. Subject to Company's Option to Extend, and unless sooner terminated or expiring, the Exploration Term of the EDA shall commence on the Effective Date and shall end at the end of the Fifth Exploration Year, and may be extended for two consecutive five-year periods commencing upon termination of the Exploration Term.

8. Term. The EDA shall continue in force, according to the terms and conditions of the EDA, until all operations then being conducted pursuant to the EDA cease or upon the termination of the last Lease issued under the EDA, and all obligations of the parties have been fully discharged.

9. Area of Mutual Interest and AMI Leases. Various Areas of Mutual Interest will be established throughout the Contract Premises, based on Leases in which the Ute Indian Tribe has exercised its election to participate, whereby each Party is obligated to offer to the other an undivided interest in any oil and gas interest that such offering party acquires within any Area of Mutual Interest.

10. Confidentiality. The Ute Indian Tribe, Company, and UDC agree to keep the specific terms of the EDA confidential, except as set forth in this Memorandum and in the various Leases, Rights-of-Way and other instruments that are or might be recorded or filed in the future in public records of the Ute Indian Tribe, Duchesne and Wasatch Counties, the State of Utah or the U.S. Government.

11. Assignment. Company may not assign or transfer its rights under the EDA or any Leases without the prior written consent of the Ute Indian Tribe, the UDC and the Superintendent, which consent will not be unreasonably withheld.

This Memorandum is executed by the parties and placed of record for the purpose of placing all persons on notice of the existence of the EDA regarding the Contract Premises. This Memorandum is not intended to, and shall not, supersede, terminate or otherwise alter any provisions of the EDA in any respect.

IN WITNESS WHEREOF, this Memorandum is executed by the undersigned duly authorized representatives of each party on the date and year first above written.

UTE INDIAN TRIBE OF THE UINTAH
AND OURAY RESERVATION

UTE DISTRIBUTION CORPORATION

By: *Maxine Natchees*
Maxine Natchees
Uintah and Ouray Tribal Business
Committee Chairman

By: *Leis LaRose*
Name: *Leis LaRose*
Title: *President*

BILL BARRETT CORPORATION

BERRY PETROLEUM COMPANY

By: *Wm J. Barrett IM*
William J. Barrett
Chairman and CEO

By: *Robert F. Heinemann*
Robert F. Heinemann
President and CEO

STATE OF COLORADO)
)
CITY AND COUNTY OF DENVER) ss.

On this 24th day of September, 2004, before me personally appeared William J. Barrett, Chairman and CEO of Bill Barrett Corporation, who, being duly sworn by me, acknowledged that he executed the foregoing instrument in the name of said entity, that he had the authority to execute the same, and that he executed the same as the act and deed of said entity for the uses and purposes therein stated.

My commission expires: 10/03/06

Amber Gulsvig
Notary Public



My Commission Expires 10/03/2006

On this 29th day of September, 2004, before me, the undersigned, a Notary Public for the state, personally appeared Robert F. Heinemann, President and CEO of Berry Petroleum Company, personally known to me (~~or proved to me on the basis of satisfactory evidence~~) to be the person whose name is subscribed to the within instrument and acknowledged to me that he executed the foregoing instrument in the name of said entity, that he had the authority to execute the same, and that he executed the same as the act and deed of said entity for the uses and purposes therein stated.



My commission expires: 9-18-08
Teresa Alvarez
Notary Public

(This certificate is attached to Memorandum of Exploration and Development Agreement dated July 13, 2004, of 5 pages.)

STATE OF UTAH)
Uintah Div)
COUNTY OF SALT LAKE) ss.

On this 28th day of September, 2004, before me personally appeared Maxine Natchees, Chairman of the Uintah and Ouray Tribal Business Committee, who, being duly sworn by me, acknowledged that she executed the foregoing instrument in the name of said entity, that she had the authority to execute the same, and that she executed the same as the act and deed of said entity for the uses and purposes therein stated for the Berry (Berrett) Mem. of Exp + Development Agreement approved by Res 04-163 on June 29, 2004, signed on page 3.

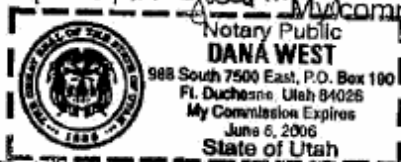

My commission expires: 6-6-2006
Dana West
Notary Public

STATE OF UTAH)
Duchesne)
COUNTY OF SALT LAKE) ss.

On this 28th day of September, 2004, before me personally appeared Lois LaRose, President of the Ute Distribution Corporation, who, being duly sworn by me, acknowledged that he executed the foregoing instrument in the name of said entity, that he had the authority to execute the same, and that he executed the same as the act and deed of said entity for the uses and purposes therein stated.

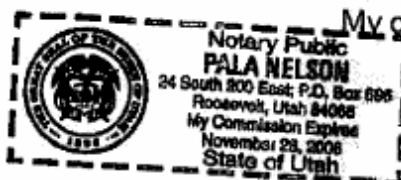

My commission expires: 11-28-06
Pala Nelson
Notary Public

Exhibit AE 3 3133 R M305 P 301
Ent 358657 Bk 1013 Pg 0537**(UTE INDIAN TRIBE/BBC/BERRY EXPLORATION AND
DEVELOPMENT AGREEMENT, DATED JULY 13, 2004)****Contract Premises Acreage Description**

County	Township	Range	Section	Lot and Description	Net Mineral Acres
Duchesne	3 S	7 W	30	Lot 3,4,E½SW¼,SE¼	310.23
Duchesne	3 S	7 W	31	Lot 1,2,E½NW¼,NE¼	310.93
Duchesne	3 S	7 W	31	Lot 3,4,E½SW¼,SE¼	311.75
Duchesne	3 S	8 W	25	N½	320.00
Duchesne	3 S	8 W	25	S½	320.00
Duchesne	3 S	8 W	26	N½	320.00
Duchesne	3 S	8 W	26	S½	320.00
Duchesne	3 S	8 W	27	SE¼NE¼	40.00
Duchesne	3 S	8 W	27	W½NE¼,S½NW¼	160.00
Duchesne	3 S	8 W	27	SW¼	160.00
Duchesne	3 S	8 W	27	W½SE¼	80.00
Duchesne	3 S	8 W	27	E½SE¼	80.00
Duchesne	3 S	8 W	28	NE¼NE¼	40.00
Duchesne	3 S	8 W	28	S½	320.00
Duchesne	3 S	8 W	29	S½NW¼	80.00
Duchesne	3 S	8 W	29	W½SW¼	80.00
Duchesne	3 S	8 W	29	E½SW¼,W½SE¼	160.00
Duchesne	3 S	8 W	29	E½SE¼	80.00
Duchesne	3 S	8 W	30	S½NE¼	80.00
Duchesne	3 S	8 W	30	Lot 1,2,E½NW¼	155.75
Duchesne	3 S	8 W	30	Lot 3,4,E½SW¼,SE¼	316.05
Duchesne	3 S	8 W	31	Lot 1,2,E½NW¼,NE¼	316.45
Duchesne	3 S	8 W	31	Lot 3,4,E½SW¼,SE¼	316.95
Duchesne	3 S	8 W	32	NE¼,N½NW¼	240.00
Duchesne	3 S	8 W	32	SE¼	160.00
Duchesne	3 S	8 W	33	N½	320.00
Duchesne	3 S	8 W	33	S½	320.00
Duchesne	3 S	8 W	34	NE¼NE¼	40.00
Duchesne	3 S	8 W	34	NW¼NE¼,NE¼NW¼	80.00
Duchesne	3 S	8 W	34	W½NW¼,SE¼NW¼,SW¼NE¼	160.00
Duchesne	3 S	8 W	34	SE¼NE¼,NE¼SE¼	80.00
Duchesne	3 S	8 W	34	SW¼,W½SE¼,SE¼SE¼	280.00
Duchesne	3 S	8 W	35	N½,E½SW¼,SE¼	560.00

County	Township	Range	Section	Lot and Description	Net Mineral Acres
Duchesne	3 S	8 W	35	W $\frac{1}{2}$ SW $\frac{1}{4}$	80.00
Duchesne	3 S	8 W	36	N $\frac{1}{2}$	320.00
Duchesne	3 S	8 W	36	S $\frac{1}{2}$	320.00
Duchesne	3 S	9 W	13	E $\frac{1}{2}$ SW $\frac{1}{4}$,W $\frac{1}{2}$ SE $\frac{1}{4}$	160.00
Duchesne	3 S	9 W	14	W $\frac{1}{2}$ E $\frac{1}{2}$	160.00
Duchesne	3 S	9 W	15	E $\frac{1}{2}$ W $\frac{1}{2}$	160.00
Wasatch	3 S	9 W	17	W $\frac{1}{2}$ NW $\frac{1}{4}$	80.00
Wasatch	3 S	9 W	18	NE $\frac{1}{4}$ NE $\frac{1}{4}$	40.00
Wasatch	3 S	9 W	20	SE $\frac{1}{4}$ SE $\frac{1}{4}$	40.00
Wasatch	3 S	9 W	21	S $\frac{1}{2}$ SW $\frac{1}{4}$,SW $\frac{1}{4}$ SE $\frac{1}{4}$	120.00
Duchesne	3 S	9 W	22	W $\frac{1}{2}$ NE $\frac{1}{4}$	80.00
Duchesne	3 S	9 W	23	NE $\frac{1}{4}$	160.00
Duchesne	3 S	9 W	23	SW $\frac{1}{4}$ SW $\frac{1}{4}$	40.00
Duchesne	3 S	9 W	23	S $\frac{1}{2}$ SE $\frac{1}{4}$,SE $\frac{1}{2}$ SW $\frac{1}{4}$	120.00
Duchesne	3 S	9 W	24	S $\frac{1}{2}$ SW $\frac{1}{4}$,SW $\frac{1}{4}$ SE $\frac{1}{4}$	120.00
Duchesne	3 S	9 W	26	N $\frac{1}{2}$ NW $\frac{1}{4}$	80.00
Duchesne	3 S	9 W	26	N $\frac{1}{2}$ S $\frac{1}{2}$	160.00
Duchesne	3 S	9 W	27	N $\frac{1}{2}$ NE $\frac{1}{4}$	80.00
Duchesne	3 S	9 W	27	SW $\frac{1}{4}$ NW $\frac{1}{4}$,NW $\frac{1}{4}$ SW $\frac{1}{4}$	80.00
Duchesne	3 S	9 W	27	NE $\frac{1}{4}$ SW $\frac{1}{4}$,N $\frac{1}{2}$ SE $\frac{1}{4}$	120.00
Wasatch	3 S	9 W	29	N $\frac{1}{2}$ NE $\frac{1}{4}$,NE $\frac{1}{4}$ NW $\frac{1}{4}$,S $\frac{1}{2}$ NW $\frac{1}{4}$	200.00
Wasatch	3 S	9 W	30	S $\frac{1}{2}$ NE $\frac{1}{4}$,SE $\frac{1}{4}$ NW $\frac{1}{4}$	120.00
Duchesne	4 S	5 W	19	Lot 1,2,3,4,E/2W/2,E/2	640.32
Duchesne	4 S	5 W	20	All	640.00
Duchesne	4 S	5 W	21	N/2NE/4,SW/4NE/4,W/2, SE/4SE/4	480.00
Duchesne	4 S	5 W	21	SE/4NE/4,N/2SE/4,SW/4SE/4	160.00
Duchesne	4 S	5 W	22	E/2,S/2NW/4,SW/4	560.00
Duchesne	4 S	5 W	22	N/2NW/4	80.00
Duchesne	4 S	5 W	23	All	640.00
Duchesne	4 S	5 W	24	S/2	320.00
Duchesne	4 S	5 W	24	N/2	see Sched. 1
Duchesne	4 S	5 W	25	All	640.00
Duchesne	4 S	5 W	26	All	640.00
Duchesne	4 S	5 W	27	All	640.00
Duchesne	4 S	5 W	28	E/2,SE/4NW/4,SW/4	520.00
Duchesne	4 S	5 W	29	N/2NE/4,NW/4,NW/4SW/4, S/2SE/4	360.00
Duchesne	4 S	5 W	29	SW/4NE/4	40.00
Duchesne	4 S	5 W	30	Lot 1,2,3,4,E/2W/2,E/2	642.72

County	Township	Range	Section	Lot and Description	Net Mineral Acres
Duchesne	4 S	5 W	31	Lot 1,2,3,4,E/2NW/4, NW/4NE/4, S/2SE/4,NE/4SE/4	405.25
Duchesne	4 S	5 W	31	E/2SW/4	80.00
Duchesne	4 S	5 W	32	E/2,E/2NW/4,SW/4NW/4,SW/4	600.00
Duchesne	4 S	5 W	33	All	640.00
Duchesne	4 S	5 W	34	N/2	320.00
Duchesne	4 S	5 W	34	S/2	320.00
Duchesne	4 S	5 W	35	N/2	320.00
Duchesne	4 S	5 W	35	S/2	320.00
Duchesne	4 S	5 W	36	N/2	320.00
Duchesne	4 S	5 W	36	S/2	320.00
Duchesne	4S	6W	19	All	636.40
Duchesne	4S	6W	20	N½	320.00
Duchesne	4S	6W	20	S½	320.00
Duchesne	4S	6W	21	All	640.00
Duchesne	4S	6W	22	All	640.00
Duchesne	4S	6W	23	N½	320.00
Duchesne	4S	6W	23	S½	320.00
Duchesne	4S	6W	24	All	640.00
Duchesne	4S	6W	25	All	640.00
Duchesne	4S	6W	26	N½	320.00
Duchesne	4S	6W	26	S½	320.00
Duchesne	4S	6W	27	N½	320.00
Duchesne	4S	6W	27	S½	320.00
Duchesne	4S	6W	28	Lot 1,E½,NE¼NW¼,SE¼SW¼	437.90
Duchesne	4S	6W	28	Lot 2-4,SW¼SW¼	101.45
Duchesne	4S	6W	28	W½NW¼	80.00
Duchesne	4S	6W	29	E½NE¼	80.00
Duchesne	4S	6W	29	W/2E/2,W/2	480.00
Duchesne	4S	6W	29	E½SE¼	80.00
Duchesne	4S	6W	30	Lot 3,4,E½SW¼,SE¼,NE¼,E½NW	554.56
Duchesne	4S	6W	31	All	639.20
Duchesne	4S	6W	32	N½	320.00
Duchesne	4S	6W	33	N½	320.00
Duchesne	4S	6W	33	S½	320.00
Duchesne	4S	6W	34	N½	320.00
Duchesne	4S	6W	34	S½	320.00
Duchesne	4S	6W	35	N½	320.00
Duchesne	4S	6W	35	SW¼	160.00
Duchesne	4S	6W	35	SE¼	160.00
Duchesne	4S	6W	36	N½,N½SW¼,SE¼SW¼,SE¼	600.00

County	Township	Range	Section	Lot and Description	Net Mineral Acres
Duchesne	4S	6W	36	SW $\frac{1}{4}$ SW $\frac{1}{4}$	40.00
Duchesne	4S	7W	6	Lot 1-5,S $\frac{1}{2}$ NE $\frac{1}{4}$,SE $\frac{1}{4}$ NW $\frac{1}{4}$	312.50
Duchesne	4S	7W	6	Lot 6,7,E $\frac{1}{2}$ SW $\frac{1}{4}$,SE $\frac{1}{4}$	313.18
Duchesne	4S	7W	7	Lot 1,2,W $\frac{1}{2}$ NE $\frac{1}{4}$,E $\frac{1}{2}$ NW $\frac{1}{4}$, SE $\frac{1}{4}$ NE $\frac{1}{4}$	273.84
Duchesne	4S	7W	7	Lot 3,4,E $\frac{1}{2}$ SW $\frac{1}{4}$,SE $\frac{1}{4}$	314.48
Duchesne	4S	7W	17	N $\frac{1}{2}$ N $\frac{1}{2}$,SW $\frac{1}{4}$ NE $\frac{1}{4}$,SE $\frac{1}{4}$ NW $\frac{1}{4}$	240.00
Duchesne	4S	7W	17	SE $\frac{1}{4}$ NE $\frac{1}{4}$,NE $\frac{1}{4}$ SE $\frac{1}{4}$	80.00
Duchesne	4S	7W	17	S $\frac{1}{2}$ S $\frac{1}{2}$	160.00
Duchesne	4S	7W	18	Lot 1,2,NE $\frac{1}{4}$,E $\frac{1}{2}$ NW $\frac{1}{4}$	315.14
Duchesne	4S	7W	18	Lot 3,NE $\frac{1}{4}$ SW $\frac{1}{4}$,SE $\frac{1}{4}$	237.82
Duchesne	4S	7W	19	Lot 1,2,NE $\frac{1}{4}$,E $\frac{1}{2}$ NW $\frac{1}{4}$	316.50
Duchesne	4S	7W	19	Lot 3,4,E $\frac{1}{2}$ SW $\frac{1}{4}$,SE $\frac{1}{4}$	317.18
Duchesne	4S	7W	20	N $\frac{1}{2}$	320.00
Duchesne	4S	7W	20	Lot 1,2,SW $\frac{1}{4}$,N $\frac{1}{2}$ SE $\frac{1}{4}$	299.45
Duchesne	4S	7W	21	N $\frac{1}{2}$ N $\frac{1}{2}$	160.00
Duchesne	4S	7W	21	NE $\frac{1}{4}$ SE $\frac{1}{4}$	40.00
Duchesne	4S	7W	22	E $\frac{1}{2}$	320.00
Duchesne	4S	7W	22	NW $\frac{1}{4}$	160.00
Duchesne	4S	7W	22	SW $\frac{1}{4}$	160.00
Duchesne	4S	7W	23	Lot 1,W $\frac{1}{2}$ NE $\frac{1}{4}$,SE $\frac{1}{4}$ NE $\frac{1}{4}$,W $\frac{1}{2}$,SE $\frac{1}{4}$	634.85
Duchesne	4S	7W	26	N $\frac{1}{2}$	320.00
Duchesne	4S	7W	27	Lot 1,2,S $\frac{1}{2}$ NE $\frac{1}{4}$,NW $\frac{1}{4}$	299.35
Duchesne	4S	7W	27	S $\frac{1}{2}$	320.00
Duchesne	4S	7W	28	NE $\frac{1}{4}$	160.00
Duchesne	4S	7W	28	NW $\frac{1}{4}$,SE $\frac{1}{4}$	320.00
Duchesne	4S	7W	28	SW $\frac{1}{4}$	160.00
Duchesne	4S	7W	29	All	640.00
Duchesne	4S	7W	30	Lot 1,2,NE $\frac{1}{4}$,E $\frac{1}{2}$ NW $\frac{1}{4}$	317.84
Duchesne	4S	7W	31	All	638.80
Duchesne	4S	7W	32	N $\frac{1}{2}$	320.00
Duchesne	4S	7W	32	S $\frac{1}{2}$	320.00
Duchesne	4S	7W	35	S $\frac{1}{2}$	320.00
Duchesne	4S	7W	36	Lot 1,2,NE $\frac{1}{4}$ NE $\frac{1}{4}$,S $\frac{1}{2}$ N $\frac{1}{2}$,NW $\frac{1}{4}$ NW $\frac{1}{4}$, S $\frac{1}{2}$	639.65
Duchesne	4S	8W	1	Lot 1-4,S $\frac{1}{2}$ N $\frac{1}{2}$	319.60
Duchesne	4S	8W	1	S $\frac{1}{2}$	320.00
Duchesne	4S	8W	2	Lot 1-4	159.20
Duchesne	4S	8W	2	S $\frac{1}{2}$ NE $\frac{1}{4}$,SE $\frac{1}{4}$	240.00
Duchesne	4S	8W	2	W $\frac{1}{2}$ SW $\frac{1}{4}$	80.00

County	Township	Range	Section	Lot and Description	Net Mineral Acres
Duchesne	4S	8W	3	Lot 1-4,S½N½	319.96
Duchesne	4S	8W	3	S½	320.00
Duchesne	4S	8W	10	N½	320.00
Duchesne	4S	8W	10	S½	320.00
Duchesne	4S	8W	11	NE¼	160.00
Duchesne	4S	8W	11	W½NW¼	80.00
Duchesne	4S	8W	11	NW¼SW¼,S½S½,NE¼SE¼	240.00
Duchesne	4S	8W	12	N½	320.00
Duchesne	4S	8W	12	S½	320.00
Duchesne	4S	8W	13	N½	320.00
Duchesne	4S	8W	13	N½S½,SE¼SE¼	200.00
Duchesne	4S	8W	14	N½	320.00
Duchesne	4S	8W	14	S½	320.00
Duchesne	4S	8W	15	All	640.00
Duchesne	4S	8W	16	All	640.00
Duchesne	4S	8W	17	All	640.00
Duchesne	4S	8W	18	All	637.48
Duchesne	4S	8W	19	Lot 1,2,NE¼,E½NW¼	318.94
Duchesne	4S	8W	19	Lot 3,4,E½SW¼,SE¼	319.38
Duchesne	4S	8W	20	N½	320.00
Duchesne	4S	8W	20	S½	320.00
Duchesne	4S	8W	21	N½	320.00
Duchesne	4S	8W	22	S½N½,S½	480.00
Duchesne	4S	8W	23	N½N½	160.00
Duchesne	4S	8W	23	S½N½,S½	480.00
Duchesne	4S	8W	24	NE¼NE¼,S½N½	200.00
Duchesne	4S	8W	24	S½	320.00
Duchesne	4S	8W	25	Lot 1-4,N½,SW¼	602.85
Duchesne	4S	8W	26	All	640.00
Duchesne	4S	8W	27	N½	320.00
Duchesne	4S	8W	27	S½	320.00
Duchesne	4S	8W	28	N½	320.00
Duchesne	4S	8W	29	N½	320.00
Duchesne	4S	8W	29	S½	320.00
Duchesne	4S	8W	30	Lot 1,2,NE¼,E½NW¼	319.57
Duchesne	4S	8W	30	Lot 3,4,E½SW¼,SE¼	319.51
Duchesne	4S	8W	31	Lot 1,2,NE¼,E½NW¼	319.61
Duchesne	4S	8W	31	Lot 3,4,E½SW¼,SE¼	319.87
Duchesne	4S	8W	32	N½	320.00
Duchesne	4S	8W	32	S½	320.00
Duchesne	4S	8W	33	N½	320.00
Duchesne	4S	8W	33	S½	320.00

County	Township	Range	Section	Lot and Description	Net Mineral Acres
Duchesne	4S	8W	34	N½	320.00
Duchesne	4S	8W	34	S½	320.00
Duchesne	4S	8W	35	All	640.00
Duchesne	4S	8W	36	N½	320.00
Duchesne	4S	8W	36	S½	320.00
Wasatch	4 S	9 W	7	Lot 3,NE¼SW¼	79.17
Wasatch	4 S	9 W	7	Lot 4,SE¼SW¼	79.19
Wasatch	4 S	9 W	9	N½	320.00
Duchesne	4 S	9 W	9	S½	320.00
Duchesne	4 S	9 W	10	All	640.00
Duchesne	4 S	9 W	11	All	640.00
Duchesne	4 S	9 W	12	N½	320.00
Duchesne	4 S	9 W	12	S½	320.00
Duchesne	4 S	9 W	13	N½, N½S½,SE¼SE¼	520.00
Duchesne	4 S	9 W	13	S½SW¼,SW¼SE¼	120.00
Duchesne	4 S	9 W	14	N½	320.00
Duchesne	4 S	9 W	14	S½	320.00
Duchesne	4 S	9 W	15	N½	320.00
Duchesne	4 S	9 W	15	N½S½	160.00
Duchesne	4 S	9 W	15	S½SW¼	80.00
Duchesne	4 S	9 W	15	SE¼SE¼	40.00
Wasatch	4 S	9 W	16	N½	320.00
Wasatch	4 S	9 W	16	N½SE¼,NE¼SW¼	120.00
Wasatch	4 S	9 W	16	NW¼SW¼, S½S½	200.00
Wasatch	4 S	9 W	17	N½	320.00
Wasatch	4 S	9 W	17	S½	320.00
Wasatch	4 S	9 W	18	Lot 1,2,E½NW¼,NE¼	318.63
Wasatch	4 S	9 W	18	Lot 3,4,E½SW¼,SE¼	319.09
Wasatch	4 S	9 W	19	Lot 1,2,E½NW¼,NE¼	319.37
Wasatch	4 S	9 W	19	Lot 3,4,E½SW¼,SE¼	319.47
Wasatch	4 S	9 W	20	N½	320.00
Wasatch	4 S	9 W	20	S½	320.00
Wasatch	4 S	9 W	21	N½	320.00
Duchesne	4 S	9 W	22	N½NE¼,SE¼NE¼	120.00
Duchesne	4 S	9 W	22	NE¼SE¼	40.00
Duchesne	4 S	9 W	23	N½	320.00
Duchesne	4 S	9 W	23	S½	320.00
Duchesne	4 S	9 W	24	N½	320.00
Duchesne	4 S	9 W	24	S½	320.00
Duchesne	5S	5W	6	All	see Sched. 1

County	Township	Range	Section	Lot and Description	Net Mineral Acres
Duchesne	5S	5W	7	All	see Sched. 1
Duchesne	5S	5W	18	All	see Sched. 1
Duchesne	5S	5W	19	All	see Sched. 1
Duchesne	5S	5W	30	All	see Sched. 1
Duchesne	5S	5W	31	All	see Sched. 1
Duchesne	5S	6W	1	Lot 2,3,4, SW $\frac{1}{4}$ NW $\frac{1}{4}$, NW $\frac{1}{4}$ SW $\frac{1}{4}$, SE $\frac{1}{4}$	see Sched. 1
Duchesne	5S	6W	2	Lot 1-4, S $\frac{1}{2}$ N $\frac{1}{2}$	309.96
Duchesne	5S	6W	2	S $\frac{1}{2}$	320.00
Duchesne	5S	6W	3	Lot 1-4, S $\frac{1}{2}$ N $\frac{1}{2}$	310.04
Duchesne	5S	6W	3	S $\frac{1}{2}$	320.00
Duchesne	5S	6W	4	Lot 1-4, S $\frac{1}{2}$ N $\frac{1}{2}$	311.88
Duchesne	5S	6W	4	S $\frac{1}{2}$	320.00
Duchesne	5S	6W	5	Lot 1-4, S $\frac{1}{2}$ N $\frac{1}{2}$	312.28
Duchesne	5S	6W	5	S $\frac{1}{2}$	320.00
Duchesne	5S	6W	7	NE $\frac{1}{4}$	160.00
Duchesne	5S	6W	7	Lot 1,2, E $\frac{1}{2}$ NW $\frac{1}{4}$	155.88
Duchesne	5S	6W	7	Lot 3,4, E $\frac{1}{2}$ SW $\frac{1}{4}$, SE $\frac{1}{4}$	315.80
Duchesne	5S	6W	8	All	640.00
Duchesne	5S	6W	9	N $\frac{1}{2}$	320.00
Duchesne	5S	6W	9	S $\frac{1}{2}$	320.00
Duchesne	5S	6W	10	N $\frac{1}{2}$	320.00
Duchesne	5S	6W	10	S $\frac{1}{2}$	320.00
Duchesne	5S	6W	11	W $\frac{1}{2}$ NE $\frac{1}{4}$, NW $\frac{1}{4}$	240.00
Duchesne	5S	6W	11	N $\frac{1}{2}$ SW $\frac{1}{4}$, NW $\frac{1}{4}$ SE $\frac{1}{4}$, S $\frac{1}{2}$ SW $\frac{1}{4}$, SW $\frac{1}{4}$ SE $\frac{1}{4}$	240.00
Duchesne	5S	6W	11	SE $\frac{1}{4}$ SE $\frac{1}{4}$, NE $\frac{1}{4}$ SE $\frac{1}{4}$	80.00
Duchesne	5S	6W	12	S $\frac{1}{2}$, NE $\frac{1}{4}$, E $\frac{1}{2}$ NW $\frac{1}{4}$, SW $\frac{1}{4}$ NW $\frac{1}{4}$	see Sched. 1
Duchesne	5S	6W	13	All	see Sched. 1
Duchesne	5S	6W	14	E $\frac{1}{2}$ NE $\frac{1}{4}$, E $\frac{1}{2}$ SW $\frac{1}{4}$, SE $\frac{1}{4}$, NE $\frac{1}{4}$ NW $\frac{1}{4}$, SW $\frac{1}{4}$ NW $\frac{1}{4}$, W $\frac{1}{2}$ SW $\frac{1}{4}$	480.00
Duchesne	5S	6W	15	NW $\frac{1}{4}$ NE $\frac{1}{4}$, N $\frac{1}{2}$ NW $\frac{1}{4}$, SW $\frac{1}{4}$ NW $\frac{1}{4}$, E $\frac{1}{2}$ SW $\frac{1}{4}$, N $\frac{1}{2}$ SE $\frac{1}{4}$, SW $\frac{1}{4}$ SE $\frac{1}{4}$, SE $\frac{1}{4}$ NW $\frac{1}{4}$, E $\frac{1}{2}$ NE $\frac{1}{4}$, SW $\frac{1}{4}$ NE $\frac{1}{4}$	520.00
Duchesne	5S	6W	16	N $\frac{1}{2}$	320.00
Duchesne	5S	6W	16	SW $\frac{1}{4}$, N $\frac{1}{2}$ SE $\frac{1}{4}$	240.00
Duchesne	5S	6W	17	All	640.00
Duchesne	5S	6W	18	Lot 1,2, NE $\frac{1}{4}$, E $\frac{1}{2}$ NW $\frac{1}{4}$	315.72
Duchesne	5S	6W	18	Lot 3,4, E $\frac{1}{2}$ SW $\frac{1}{4}$, SE $\frac{1}{4}$	315.64
Duchesne	5S	6W	19	Lot 1-4,7, NE $\frac{1}{4}$, E $\frac{1}{2}$ NW $\frac{1}{4}$, NE $\frac{1}{4}$ SW $\frac{1}{4}$, NW $\frac{1}{4}$ SE $\frac{1}{4}$	470.77
Duchesne	5S	6W	20	Lot 1-7, SE $\frac{1}{4}$ NE $\frac{1}{4}$, N $\frac{1}{2}$ NW $\frac{1}{4}$, E $\frac{1}{2}$ SE $\frac{1}{4}$, NW $\frac{1}{4}$ SW $\frac{1}{4}$ & mining claims	440.00
Duchesne	5S	6W	21	All	640.00

County	Township	Range	Section	Lot and Description	Net Mineral Acres
				E 373133 B M 305 o 300	
Duchesne	5S	6W	22	NW $\frac{1}{4}$ NE $\frac{1}{4}$,NW $\frac{1}{4}$,NW $\frac{1}{4}$ SW $\frac{1}{4}$	240.00
Duchesne	5S	6W	22	S $\frac{1}{2}$ NE $\frac{1}{4}$	80.00
Duchesne	5S	6W	22	E $\frac{1}{2}$ SE $\frac{1}{4}$,SW $\frac{1}{4}$ SE $\frac{1}{4}$	120.00
Duchesne	5S	6W	23	All	640.00
Duchesne	5S	6W	24	All	see Sched. 1
Duchesne	5S	6W	25	All	see Sched. 1
Duchesne	5S	6W	26	N $\frac{1}{2}$	320.00
Duchesne	5S	6W	26	S $\frac{1}{2}$	320.00
Duchesne	5S	6W	27	NE $\frac{1}{4}$,E $\frac{1}{2}$ NW $\frac{1}{4}$,SW $\frac{1}{4}$ NW $\frac{1}{4}$	280.00
Duchesne	5S	6W	27	NW $\frac{1}{4}$ NW $\frac{1}{4}$	40.00
Duchesne	5S	6W	27	S $\frac{1}{2}$	320.00
Duchesne	5S	6W	28	N $\frac{1}{2}$ NE $\frac{1}{4}$,SW $\frac{1}{4}$ NE $\frac{1}{4}$,NW $\frac{1}{4}$	280.00
Duchesne	5S	6W	28	SW $\frac{1}{4}$	160.00
Duchesne	5S	6W	28	SE $\frac{1}{4}$ SE $\frac{1}{4}$	40.00
Duchesne	5S	6W	29	N $\frac{1}{2}$	320.00
Duchesne	5S	6W	29	S $\frac{1}{2}$	320.00
Duchesne	5S	6W	30	Lot 3-6,S $\frac{1}{2}$ NE $\frac{1}{4}$,SE $\frac{1}{4}$ NW $\frac{1}{4}$,E $\frac{1}{2}$ SW $\frac{1}{4}$, SE $\frac{1}{4}$	494.57
Duchesne	5S	6W	31	All	631.52
Duchesne	5S	6W	32	N $\frac{1}{2}$	320.00
Duchesne	5S	6W	32	S $\frac{1}{2}$	320.00
Duchesne	5S	6W	33	N $\frac{1}{2}$	320.00
Duchesne	5S	6W	33	S $\frac{1}{2}$	320.00
Duchesne	5S	6W	34	N $\frac{1}{2}$	320.00
Duchesne	5S	6W	34	S $\frac{1}{2}$	320.00
Duchesne	5S	6W	35	All	see Sched. 1
Duchesne	5S	6W	36	N $\frac{1}{2}$	see Sched. 1
Duchesne	5S	7W	1	All	634.32
Duchesne	5S	7W	2	All	637.60
Duchesne	5S	7W	3	All	638.80
Duchesne	5S	7W	4	Lot 1-4,S $\frac{1}{2}$ N $\frac{1}{2}$	318.40
Duchesne	5S	7W	4	S $\frac{1}{2}$	320.00
Duchesne	5S	7W	5	All	637.28
Duchesne	5S	7W	6	Lot 3-5,SE $\frac{1}{4}$ NW $\frac{1}{4}$	149.63
Duchesne	5S	7W	6	Lot 6,7,NE $\frac{1}{4}$ SW $\frac{1}{4}$	112.61
Duchesne	5S	7W	7	Lot 1,2,SE $\frac{1}{4}$ NW $\frac{1}{4}$	112.42
Duchesne	5S	7W	7	Lot 3,4,E $\frac{1}{2}$ SW $\frac{1}{4}$	152.30
Duchesne	5S	7W	8	All	640.00
Duchesne	5S	7W	9	N $\frac{1}{2}$	320.00
Duchesne	5S	7W	9	S $\frac{1}{2}$	320.00
Duchesne	5S	7W	10	All	640.00
Duchesne	5S	7W	11	N $\frac{1}{2}$,SW $\frac{1}{4}$,N $\frac{1}{2}$ SE $\frac{1}{4}$,SW $\frac{1}{4}$ SE $\frac{1}{4}$	600.00

E 31.33 M 305 P 305

County	Township	Range	Section	Lot and Description	Net Mineral Acres
Duchesne	5S	7W	13	All	640.00
Duchesne	5S	7W	14	E $\frac{1}{2}$ SW $\frac{1}{4}$,SE $\frac{1}{4}$	240.00
Duchesne	5S	7W	15	N $\frac{1}{2}$,SW $\frac{1}{4}$,N $\frac{1}{2}$ SE $\frac{1}{4}$,SW $\frac{1}{4}$ SE $\frac{1}{4}$	600.00
Duchesne	5S	7W	16	N $\frac{1}{2}$	320.00
Duchesne	5S	7W	16	S $\frac{1}{2}$	320.00
Duchesne	5S	7W	17	N $\frac{1}{2}$	320.00
Duchesne	5S	7W	17	S $\frac{1}{2}$	320.00
Duchesne	5S	7W	18	Lot 1,2,NE $\frac{1}{4}$,E $\frac{1}{2}$ NW $\frac{1}{4}$	312.29
Duchesne	5S	7W	19	Lot 1,2,NE $\frac{1}{4}$,E $\frac{1}{2}$ NW $\frac{1}{4}$	312.36
Duchesne	5S	7W	19	Lot 3,4,E $\frac{1}{2}$ SW $\frac{1}{4}$,SE $\frac{1}{4}$	312.20
Duchesne	5S	7W	20	N $\frac{1}{2}$	320.00
Duchesne	5S	7W	20	S $\frac{1}{2}$	320.00
Duchesne	5S	7W	21	N $\frac{1}{2}$,SW $\frac{1}{4}$,N $\frac{1}{2}$ SE $\frac{1}{4}$	560.00
Duchesne	5S	7W	22	N $\frac{1}{2}$ NW $\frac{1}{4}$,SW $\frac{1}{4}$ NW $\frac{1}{4}$	120.00
Duchesne	5S	7W	22	SE $\frac{1}{4}$ SW $\frac{1}{4}$,E $\frac{1}{2}$ SE $\frac{1}{4}$,SW $\frac{1}{4}$ SE $\frac{1}{4}$	160.00
Duchesne	5S	7W	22	NW $\frac{1}{4}$ SE $\frac{1}{4}$	40.00
Duchesne	5S	7W	23	All	640.00
Duchesne	5S	7W	24	N $\frac{1}{2}$	320.00
Duchesne	5S	7W	24	S $\frac{1}{2}$	320.00
Duchesne	5S	7W	25	N $\frac{1}{2}$ N $\frac{1}{2}$,SW $\frac{1}{4}$ NW $\frac{1}{4}$,SE $\frac{1}{4}$ SW $\frac{1}{4}$,SE $\frac{1}{4}$	400.00
Duchesne	5S	7W	26	N $\frac{1}{2}$,SW $\frac{1}{4}$,N $\frac{1}{2}$ SE $\frac{1}{4}$,SW $\frac{1}{4}$ SE $\frac{1}{4}$	600.00
Duchesne	5S	7W	27	N $\frac{1}{2}$	320.00
Duchesne	5S	7W	27	S $\frac{1}{2}$	320.00
Duchesne	5S	7W	28	NE $\frac{1}{4}$ NE $\frac{1}{4}$	40.00
Duchesne	5S	7W	28	S $\frac{1}{2}$	320.00
Duchesne	5S	7W	29	Lot 1,4,E $\frac{1}{2}$ NE $\frac{1}{4}$,N $\frac{1}{2}$ SW $\frac{1}{4}$	222.55
Duchesne	5S	7W	29	Lot 2,3,W $\frac{1}{2}$ NW $\frac{1}{4}$	156.80
Duchesne	5S	7W	30	Lot 1,2,NE $\frac{1}{4}$,E $\frac{1}{2}$ NW $\frac{1}{4}$	312.23
Duchesne	5S	7W	30	Lot 3,4,E $\frac{1}{2}$ SW $\frac{1}{4}$,SE $\frac{1}{4}$	312.45
Duchesne	5S	7W	31	Lot 1,2,W $\frac{1}{2}$ NE $\frac{1}{4}$,E $\frac{1}{2}$ NW $\frac{1}{4}$	232.61
Duchesne	5S	7W	31	Lot 3,4,E $\frac{1}{2}$ SW $\frac{1}{4}$,NW $\frac{1}{4}$ SE $\frac{1}{4}$	192.71
Duchesne	5S	7W	32	NE $\frac{1}{4}$ NE $\frac{1}{4}$,S $\frac{1}{2}$ N $\frac{1}{2}$,NE $\frac{1}{4}$ NW $\frac{1}{4}$	240.00
Duchesne	5S	7W	35	S $\frac{1}{2}$ SW $\frac{1}{4}$	80.00
Duchesne	5S	8W	1	All	631.60
Duchesne	5S	8W	2	Lot 1-4,S $\frac{1}{2}$ NW $\frac{1}{4}$,W $\frac{1}{2}$ SW $\frac{1}{4}$,E $\frac{1}{2}$ SE $\frac{1}{4}$,SW $\frac{1}{4}$ SE $\frac{1}{4}$	432.40
Duchesne	5S	8W	2	SE $\frac{1}{4}$ NE $\frac{1}{4}$	40.00
Duchesne	5S	8W	3	Lot 1,SE $\frac{1}{4}$ NE $\frac{1}{4}$	78.22
Duchesne	5S	8W	3	S $\frac{1}{2}$	320.00
Duchesne	5S	8W	9	N $\frac{1}{2}$	320.00
Duchesne	5S	8W	10	All	640.00
Duchesne	5S	8W	11	E $\frac{1}{2}$,SE $\frac{1}{4}$ NW $\frac{1}{4}$,E $\frac{1}{2}$ SW $\frac{1}{4}$	440.00

County	Township	Range	Section	Lot and Description	Net Mineral Acres
Duchesne	5S	8W	11	SW $\frac{1}{4}$ SW $\frac{1}{4}$	40.00
Duchesne	5S	8W	12	All	640.00
Duchesne	5S	8W	13	N $\frac{1}{2}$	320.00
Duchesne	5S	8W	13	S $\frac{1}{2}$	320.00
Duchesne	5S	8W	14	NE $\frac{1}{4}$,E $\frac{1}{2}$ NW $\frac{1}{4}$	240.00
Duchesne	5S	8W	14	W $\frac{1}{2}$ NW $\frac{1}{4}$,NW $\frac{1}{4}$ SW $\frac{1}{4}$	120.00
Duchesne	5S	8W	14	E $\frac{1}{2}$ SW $\frac{1}{4}$,SW $\frac{1}{4}$ SW $\frac{1}{4}$,SE $\frac{1}{4}$	280.00
Duchesne	5S	8W	15	E $\frac{1}{2}$ NE $\frac{1}{4}$	80.00
Duchesne	5S	8W	15	W $\frac{1}{2}$ E $\frac{1}{2}$,W $\frac{1}{2}$	480.00
Duchesne	5S	8W	15	NE $\frac{1}{4}$ SE $\frac{1}{4}$	40.00
Duchesne	5S	8W	15	SE $\frac{1}{4}$ SE $\frac{1}{4}$	40.00
Duchesne	5S	8W	16	All	640.00
Duchesne	5S	8W	19	Lot 1,2,NE $\frac{1}{4}$,E $\frac{1}{2}$ NW $\frac{1}{4}$	306.56
Duchesne	5S	8W	19	Lot 3,4,E $\frac{1}{2}$ SW $\frac{1}{4}$,SE $\frac{1}{4}$	306.08
Duchesne	5S	8W	20	All	640.00
Duchesne	5S	8W	21	All	640.00
Duchesne	5S	8W	22	N $\frac{1}{2}$ NE $\frac{1}{4}$,SW $\frac{1}{4}$ NE $\frac{1}{4}$	120.00
Duchesne	5S	8W	22	NW $\frac{1}{4}$,W $\frac{1}{2}$ SW $\frac{1}{4}$,E $\frac{1}{2}$ SE $\frac{1}{4}$,SW $\frac{1}{4}$ SE $\frac{1}{4}$	360.00
Duchesne	5S	8W	22	SE $\frac{1}{4}$ NE $\frac{1}{4}$	40.00
Duchesne	5S	8W	23	All	640.00
Duchesne	5S	8W	24	N $\frac{1}{2}$	320.00
Duchesne	5S	8W	24	S $\frac{1}{2}$	320.00
Duchesne	5S	8W	25	N $\frac{1}{2}$	320.00
Duchesne	5S	8W	25	S $\frac{1}{2}$	320.00
Duchesne	5S	8W	26	All	640.00
Duchesne	5S	8W	27	E $\frac{1}{2}$,E $\frac{1}{2}$ SW $\frac{1}{4}$,SW $\frac{1}{4}$ SW $\frac{1}{4}$	440.00
Duchesne	5S	8W	27	NW $\frac{1}{4}$ NW $\frac{1}{4}$	40.00
Duchesne	5S	8W	28	N $\frac{1}{2}$ NE $\frac{1}{4}$,NW $\frac{1}{4}$	240.00
Duchesne	5S	8W	28	NW $\frac{1}{4}$ SW $\frac{1}{4}$	40.00
Duchesne	5S	8W	28	S $\frac{1}{2}$ SE $\frac{1}{4}$	80.00
Duchesne	5S	8W	29	N $\frac{1}{2}$	320.00
Duchesne	5S	8W	29	S $\frac{1}{2}$	320.00
Duchesne	5S	8W	30	Lot 1,2,NE $\frac{1}{4}$,E $\frac{1}{2}$ NW $\frac{1}{4}$	305.63
Duchesne	5S	8W	30	Lot 3,4,E $\frac{1}{2}$ SW $\frac{1}{4}$,SE $\frac{1}{4}$	305.21
Duchesne	5S	8W	31	Lot 1,2,NE $\frac{1}{4}$,E $\frac{1}{2}$ NW $\frac{1}{4}$	305.45
Duchesne	5S	8W	31	Lot 3,4,E $\frac{1}{2}$ SW $\frac{1}{4}$,SE $\frac{1}{4}$	306.35
Duchesne	5S	8W	32	NW $\frac{1}{4}$ NE $\frac{1}{4}$,NW $\frac{1}{4}$,W $\frac{1}{2}$ SW $\frac{1}{4}$,E $\frac{1}{2}$ SE $\frac{1}{4}$	360.00
Duchesne	5S	8W	33	E $\frac{1}{2}$,E $\frac{1}{2}$ NW $\frac{1}{4}$,SW $\frac{1}{4}$ NW $\frac{1}{4}$,SW $\frac{1}{4}$	600.00
Duchesne	5S	8W	34	All	640.00
Duchesne	5S	8W	35	N $\frac{1}{2}$	320.00
Duchesne	5S	8W	35	S $\frac{1}{2}$	320.00
Duchesne	5S	8W	36	N $\frac{1}{2}$	320.00

County	Township	Range	Section	Lot and Description	Net Mineral Acres
Duchesne	5S	8W	36	S½	320.00
Duchesne	5 S	9 W	25	All	640.00
Duchesne	5 S	9 W	26	N/2	320.00
Duchesne	5 S	9 W	27	N/2	320.00
Wasatch	5 S	9 W	33	N/2NE/4	80.00
Duchesne	5 S	9 W	34	SE/4,NE/4,SE/2NW/4	120.00
Duchesne	5 S	9 W	34	W/2NW/4	80.00
Duchesne	5 S	9 W	35	SW/4NW/4	40.00
Duchesne	5 S	9 W	36	N/2	320.00
Duchesne	5 S	9 W	36	S/2	320.00
Duchesne	6 S	8W	5	Lot 1,2,S½NE	161.11
Duchesne	6 S	8W	5	E½SW¼,SE¼	240.00
Duchesne	6 S	8W	6	Lot 4	33.31
Duchesne	6 S	8W	6	Lot 6,7,E½SW,SE¼	305.36
Duchesne	6 S	8W	7	Lot 1,2,NE¼,E½NW¼	304.74
Duchesne	6 S	8W	7	Lot 3,4,E½SW¼,SE¼	304.46
Duchesne	6 S	8W	8	NE¼,N½NW¼	240.00
Duchesne	6 S	8W	8	S½NW¼	80.00
Duchesne	6 S	8W	8	W½SW¼	80.00
Duchesne	6 S	8W	8	E½SW¼,SE¼	240.00
Duchesne	6 S	8W	17	NE¼,NE¼NW¼	200.00
Duchesne	6 S	8W	17	W½NW¼,SE¼NW¼, NE¼SW¼	160.00
Duchesne	6 S	8W	18	Lot 1,2,NE¼,E½NW¼	304.25
Duchesne	6 S	8W	18	Lot 3,4,E½SW¼,SE¼	304.08
Duchesne	6 S	9 W	1	Lot 1,2,3,4,S½NW¼,SW/4NE/4	279.60
Duchesne	6 S	9 W	1	N½SW¼,NW¼SE¼	120.00
Duchesne	6 S	9 W	2	Lot 1,2,3,4,S½N½	320.09
Duchesne	6 S	9 W	2	SW¼,W½SE¼,SE¼SE¼	280.00
Duchesne	6 S	9 W	2	NE¼SE¼	40.00
Tribal Net Mineral Acres =					124,555.50

Exhibit A

Attached to and made a part of that certain Memorandum of Exploration and Development Agreement Dated July 13, 2004, as amended and restated on September 24, 2004, by and between The Ute Indian Tribe, Bill Barrett Corporation, Berry Petroleum Company, and the Ute Distribution Corporation

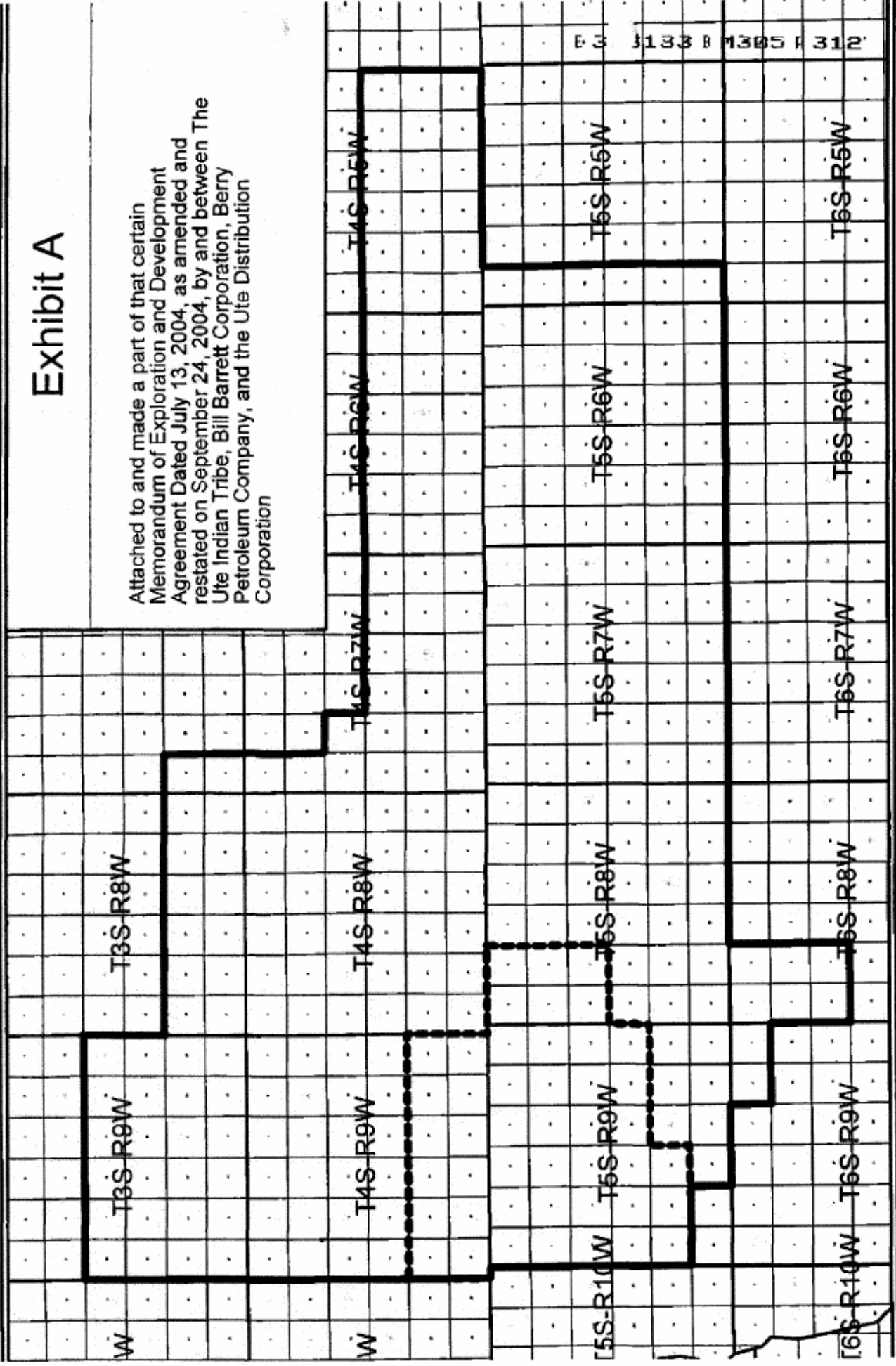

BIA LEASE NO: 14-20-H62-5500
TAAMS ID NO: 2OG0005500

CERTIFICATION OF ACKNOWLEDGEMENT

I certify this to be a true and correct copy of the original Memorandum of Exploration and Development Agreement (EDA) No. 14-20-H62-5500 on file with the Bureau of Indian Affairs, Branch of Real Estate Services – Minerals and Mining Office at Fort Duchesne, Utah. This document was approved on **10/05/2004** by the Superintendent, Uintah and Ouray Agency, Fort Duchesne, Utah.

Dated: 10/05/2004 Signed:



Paula C. Black, Realty Specialist – Minerals & Mining