

WHEN RECORDED, RETURN TO:
Cameron Cuch
Ute Energy Upstream Holding LLC
P.O Box 789
7074 East 900 South
Fort Duchesne, UT 84026

Ent 358252 Bk 1012 Pg 841-898
Date: 02-APR-2010 1:15:09PM
Fee: \$164.00 Check Filed By: JP
ELIZABETH PALMIER, Recorder
WASATCH COUNTY CORPORATION
For: UTE ENERGY UPSTREAM HOLDINGS LL
C

ASSIGNMENT AND ASSUMPTION AGREEMENT

This ASSIGNMENT AND ASSUMPTION AGREEMENT (this "Assignment") dated as of the dates set forth in the notary certifications below but effective for all purposes as of 7:00 a.m. in Houston, Texas on March 5, 2010 ("Effective Date"), is by and among Ute Energy LLC, a Delaware limited liability company, with an office at Ft. Duchesne, Utah ("Assignor") and Ute Energy Upstream Holdings LLC, a Delaware limited liability company, with an office at Fort Duchesne, Utah ("Assignee").

RECITALS:

1. The Ute Indian Tribe of the Uintah and Ouray Reservation ("**Tribe**"), Bill Barrett Corporation ("**BBC**"), and the Ute Distribution Corporation ("**UDC**"), entered into the Blacktail Ridge Exploration and Development Agreement dated December 22, 2006, (the "**Blacktail Ridge EDA**"), and approved by the Bureau of Indian Affairs ("**BIA**") on February 23, 2007, a memorandum of which was recorded in Duchesne County, Utah on April 23, 2007, in Book M316, Page 534, Entry No. 394685, affecting land in Duchesne County, Utah as more specifically described in **Exhibit A** to this Assignment and incorporated hereto; and, further, the Tribe assigned certain rights and obligations in the Blacktail Ridge EDA, as amended, to Assignor in that Assignment, Assumption, and Bill of Sale, among the Tribe, Jurrius Ogle Group, LLC, and Assignor, dated May 16, 2007 ("**May 16, 2007 Assignment**"); and
2. The Tribe, UDC, and Newfield Production Company ("**Newfield**"), entered into the Monument Butte Exploration and Development Agreement dated December 22, 2006, (the "**Monument Butte EDA**"), and approved by BIA on February 23, 2007, said agreement having been amended July 1, 2009 and approved by BIA December 22, 2009, a memorandum of which was recorded in Duchesne County, Utah on January 29, 2007, in Book M315, Page 49, Entry No. 392274, and in Uintah County, Utah on February 6, 2007, in Book 1016, Page 81, Entry No. 2007001429, affecting land in Duchesne County, Utah and Uintah County, Utah as more specifically described in **Exhibit B** to this Assignment and incorporated hereto; and, further, the Tribe assigned certain rights and obligations in the Monument Butte EDA to Assignor in the May 16, 2007 Assignment; and
3. The Tribe, UDC, Newfield, and Assignor entered into the Bridgeland Exploration and Development Agreement dated July 1, 2008, (the "**Bridgeland EDA**"), and approved by

BIA on October 15, 2008, affecting land in Duchesne County, Utah as more specifically described in **Exhibit C** to this Assignment and incorporated hereto; and

4. The Tribe, UDC, BBC, and Berry Petroleum Corporation ("**Berry**"), entered into the Lake Canyon Exploration and Development Agreement dated July 13, 2004, as amended and restated September 24, 2004 (the "**Lake Canyon EDA**"), and approved by BIA on October 5, 2004, a memorandum of which was recorded in Duchesne County, Utah on November 2, 2004, in Book M305, Page 297, Entry No. 373133, affecting land in Duchesne County, Utah and Wasatch County, Utah as more specifically described in **Exhibit D** to this Assignment and incorporated hereto; and, further, the Tribe assigned certain rights and obligations in the Lake Canyon EDA to Assignor in that Assignment, Assumption, and Bill of Sale, among the Tribe, Jurrius Ogle Group, LLC, Ute Energy Holding LLC, and Assignor, dated May 4, 2005 and approved by BIA on April 22, 2005 ("**May 4, 2005 Assignment**"), and recorded in Duchesne County on August 25, 2005, in Book M308, Page 760, Entry No. 379522 and in Uintah County, Utah on August 31, 2005, in Book 940, Page 842, Entry No. 2005007368, and

5. The Tribe, UDC, and Questar Exploration and Production Company ("**Questar**"), entered into the Wolf Flat Exploration and Development Agreement dated March 31, 2005, (the "**Wolf Flat EDA**"), approved by BIA on May 24, 2005, affecting land in Uintah County, Utah as more specifically described in **Exhibit E** to this Assignment and incorporated hereto; and, further, the Tribe assigned certain rights and obligations in the Wolf Flat EDA to Assignor in the May 4, 2005 Assignment; and

6. Assignor and Questar entered into that Pooling Agreement dated effective September 15, 2006, (the "**Section 36 Pooling Agreement**"), affecting lands in Uintah County, Utah as more specifically described in **Exhibit F** to this Assignment and incorporated hereto.

7. Assignor desires to assign all of its interest in the Blacktail Ridge EDA, Monument Butte EDA, Bridgeland EDA, Lake Canyon EDA, Wolf Flat EDA, and the Section 36 Pooling Agreement and all lands subject to the aforesaid agreements whether or not described in Exhibits A through F (the "Assets"), and Assignee desires to assume all rights and obligations of Assignor in and to the Blacktail Ridge EDA, Monument Butte EDA, Bridgeland EDA, Lake Canyon EDA, Wolf Flat EDA, and the Section 36 Pooling Agreement and all lands subject to the aforesaid agreements whether or not described in Exhibits A through F (the "Obligations").

AGREEMENT

NOW, THEREFORE, for and in consideration of the covenants and promises contained herein and other good and valuable consideration, the receipt and sufficiency of which are hereby acknowledged, Assignor and Assignee hereby agree, as of the Effective Date, as follows:

1. Assignor hereby conveys, transfers and assigns to Assignee all of Assignor's right, title, and interest in and to the Assets.

2. Assignee hereby accepts the foregoing conveyance, transfer and assignment and assumes all Obligations of Assignor relating to the Assets.

3. Assignor warrants title to the Assets, unto Assignee, its successors and assigns, against all persons claiming or to claim the same or any part thereof by, through, or under Assignor, but not otherwise. **EXCEPT AS PROVIDED IN THE PRECEDING SENTENCE, ASSIGNOR MAKES NO, AND EXPRESSLY DISCLAIMS AND NEGATES ANY, REPRESENTATION OR WARRANTY, EXPRESS OR IMPLIED, AS TO TITLE TO ANY OF THE ASSETS.** Assignor hereby assigns to Assignee all rights, claims, and causes of action on title warranties given or made by Assignors' predecessors (other than Affiliates of Assignor), and Assignee is specifically subrogated to all rights which Assignor may have against its predecessors (other than Affiliates of the Assignor), to the extent that Assignor may legally transfer such rights and grant such subrogation.

4. The Assets are assigned **AS IS, WHERE IS, AND WITH ALL FAULTS, AND ASSIGNOR MAKES NO, AND EXPRESSLY DISCLAIMS AND NEGATES ANY, REPRESENTATION OR WARRANTY, EXPRESS OR IMPLIED, AS TO (A) MERCHANTABILITY OF SUCH PERSONAL PROPERTY, (B) FITNESS OF SUCH PERSONAL PROPERTY FOR ANY PARTICULAR PURPOSE, (C) CONDITION OF SUCH PERSONAL PROPERTY, (D) INFRINGEMENTS BY SUCH PERSONAL PROPERTY OF INTELLECTUAL PROPERTY RIGHTS AND (E) CONFORMITY OF SUCH PERSONAL PROPERTY TO MODELS OR SAMPLES OF MATERIALS.**

5. This Assignment shall be binding upon, and inure to the benefit of Assignor and Assignee and each of their respective successors and assigns.

6. As evidence of this Assignment, Assignor and Assignee hereby agree to cause this Assignment to be recorded in the real property records of Duchesne County, Utah, Wasatch County, Utah, and Uintah County, Utah.

7. This Assignment may be executed in any number of counterparts, and by different parties in separate counterparts, and each counterpart hereof shall be deemed to be an original instrument, but all such counterparts shall constitute but one instrument.

8. Delivery of an executed counterpart signature page by facsimile is as effective as executing and delivering this Assignment in the presence of the other party to this Assignment.

[REMAINDER OF THIS PAGE INTENTIONALLY LEFT BLANK]

IN WITNESS WHEREOF, Assignor and Assignee have caused this Assignment to be executed on the day and year first referenced above and delivered effective as of the Effective Date above.

UTE ENERGY LLC

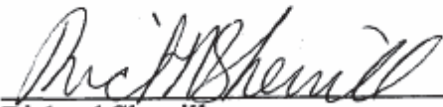
By: 
Name: Richard Sherrill
Title: President

UTE ENERGY UPSTREAM HOLDINGS LLC

By: 
Name: Richard Sherrill
Title: President

STATE OF TEXAS §

COUNTY OF HARRIS §

The foregoing instrument was acknowledged before me this 5 day of March, 2010, by Richard Sherrill, as President, on behalf of Ute Energy LLC a Delaware limited liability company.

My commission expires: 10-29-2011

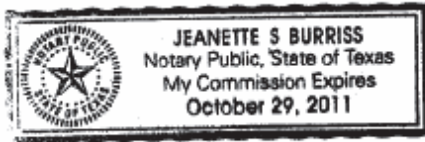

Jeanette S. Burriss
Signature

Jeanette S. Burriss
Name (Printed, Typed or Stamped)
Notary Public in and for the State of Texas

STATE OF TEXAS §

COUNTY OF HARRIS §

The foregoing instrument was acknowledged before me this 5 day of March, 2010, by Richard Sherrill, as President, on behalf of the Ute Energy Upstream Holdings LLC a Delaware limited liability company.

My commission expires: 10-29-2011

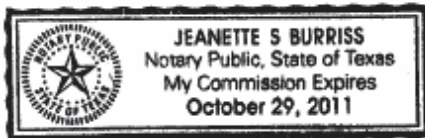

Jeanette S. Burriss
Signature

Jeanette S. Burriss
Name (Printed, Typed or Stamped)
Notary Public in and for the State of Texas

ASSIGNMENT AND ASSUMPTION AGREEMENT

APPROVAL

It has been determined that approval of this document is not such a major federal action significantly affecting the quality of the human environment as to require the preparation of an environmental impact statement under Section 102 (c) of the National Environmental Policy Act of 1969 (42 U.S.C. §4332(s)(c)).

DATED AND APPROVED this 1st day of **April 2010**, by the United States of America, acting through the Bureau of Indian Affairs, and delegated to the Superintendent by Phoenix Area Redelegation Order No. 3, Amendment 6, Section 2.17 (34 Fed. Reg. 11109), and pursuant to authority delegated to the Assistant Secretary - Indian Affairs by 209 DM 8, 230 DM 1, and to the Western Regional Director by 3 IAM 4 (Release No. 99-03), and to the Superintendent/Field Representative by 10 BIAM 11, as amended by Western Regional Release No. 97-1, and any further delegations needed to effectuate the reorganization embodied in DM Releases dated April 21, 2003.



Superintendent
Bureau of Indian Affairs
Uintah and Ouray Agency
Fort Duchesne, Utah 84026

ACKNOWLEDGEMENT OF SUPERINTENDENT

STATE OF UTAH)
) ss
COUNTY OF UINTAH

BEFORE ME, a Notary Public, in and for said county and State, on this 1st day of **April 2010**, personally appeared **Daniel C. Picard**, whose name is subscribed to the foregoing **Assignment and Assumption Agreement** as Superintendent, Uintah and Ouray Agency, Bureau of Indian Affairs, and who acknowledged that he now is and was at the time of signing the same Superintendent of the Uintah and Ouray Agency, Bureau of Indian Affairs, and he personally acknowledged to me that he executed this said document in his official capacity and pursuant to authority delegated to him for the use and purpose set forth therein.

NOTARY PUBLIC
My Commission Expires: 9/3/2013

THIS LEASE IN ITS ENTIRETY MAY NOT BE ALTERED WITHOUT PRIOR APPROVAL OF THE SECRETARY



Ute Energy Projects	
PROSPECT	Contract #
Blacktail	2OG0005608
Brundage	14-20-H62-5032
Lake Canyon - Shallow	14-20-H62-5500
Lake Canyon - Deep	14-20-H62-5500
Little Canyon	2OG0005607
Monument Butte	2OG0005609
NOSR	
Section 36	
Wolf Flat	14-20-H62-5521
CDX	
Bridgeland	14-20-H62-6154

EXHIBIT A
to
Assignment and Assumption Agreement
Dated effective March 5, 2010

EXHIBIT "A"
Ute Tribal Minerals Description
 To Exploration and Development Agreement
 between Bill Barrett Corporation and
 the Ute Indian Tribe
 Covering the Blacktail Ridge Area of Mutual Interest

Twp.	Rng.	Sec.	Land Description	Acres	Tribal Minerals	Tribal Land Status
3S	5W	1	Lot 1, SE $\frac{1}{4}$ NE $\frac{1}{4}$, E $\frac{1}{2}$ SE $\frac{1}{4}$	160.10	oil, gas, oil shale and nitrogen only	Open
3S	5W	2	Lot 4, SW $\frac{1}{2}$ NW $\frac{1}{4}$, W $\frac{1}{2}$ SW $\frac{1}{4}$, SE $\frac{1}{2}$ SW $\frac{1}{4}$	199.58	all minerals	STC
3S	5W	3	E $\frac{1}{2}$ SE $\frac{1}{4}$	80.00	oil, gas, oil shale and nitrogen only	STC
3S	5W	3	Lots 1, 2, SE $\frac{1}{2}$ NE $\frac{1}{4}$	118.86	all minerals	STC
3S	5W	4	Lots 3, 4, S $\frac{1}{2}$ NW $\frac{1}{4}$	158.08	oil, gas, oil shale and nitrogen only	Open
3S	5W	4	N $\frac{1}{2}$ S $\frac{1}{4}$	160.00	oil, gas, oil shale and nitrogen only	Open
3S	5W	5	Lots 1, 2, 3, 4, S $\frac{1}{2}$ NW $\frac{1}{4}$	236.00	oil, gas, oil shale and nitrogen only	STC
3S	5W	5	S $\frac{1}{2}$ SW $\frac{1}{4}$, NW $\frac{1}{2}$ SW $\frac{1}{4}$	120.00	oil, gas, oil shale and nitrogen only	STC
3S	5W	5	S $\frac{1}{2}$ NE $\frac{1}{4}$, N $\frac{1}{2}$ SE $\frac{1}{4}$	160.00	all minerals	STC
3S	5W	6	Lots 6, 7, E $\frac{1}{2}$ SW $\frac{1}{4}$, SE $\frac{1}{4}$	307.80	all minerals	HBP
3S	5W	7	Lots 1, 2, E $\frac{1}{2}$ NW $\frac{1}{4}$, NE $\frac{1}{4}$	308.73	oil, gas, oil shale and nitrogen only	HBP
3S	5W	7	Lots 3, 4, E $\frac{1}{2}$ SW $\frac{1}{4}$, SE $\frac{1}{4}$	309.39	oil, gas, oil shale and nitrogen only	HBP
3S	5W	11	W $\frac{1}{2}$ SW $\frac{1}{4}$, SE $\frac{1}{2}$ SW $\frac{1}{4}$, SW $\frac{1}{2}$ SE $\frac{1}{4}$	160.00	oil, gas, oil shale and nitrogen only	STC
3S	5W	11	W $\frac{1}{2}$ NE $\frac{1}{4}$, NW $\frac{1}{4}$, NE $\frac{1}{2}$ SW $\frac{1}{4}$, NW $\frac{1}{2}$ SE $\frac{1}{4}$	320.00	all minerals	STC
3S	5W	12	W $\frac{1}{2}$ E $\frac{1}{4}$	160.00	all minerals	Open
3S	5W	13	W $\frac{1}{2}$ E $\frac{1}{4}$	160.00	all minerals	STC
3S	5W	14	E $\frac{1}{2}$ W $\frac{1}{2}$	160.00	oil, gas, oil shale and nitrogen only	Open
3S	5W	14	SW $\frac{1}{2}$ SW $\frac{1}{4}$	40.00	oil, gas, oil shale and nitrogen only	Open
3S	5W	14	SW $\frac{1}{2}$ SW $\frac{1}{4}$	40.00	oil, gas, oil shale and nitrogen only	Open
3S	5W	15	NW $\frac{1}{2}$ NE $\frac{1}{4}$	40.00	oil, gas, oil shale and nitrogen only	Open
3S	5W	18	Lots 1, 2, E $\frac{1}{2}$ NW $\frac{1}{4}$, NE $\frac{1}{4}$	310.02	oil, gas, oil shale and nitrogen only	HBP
3S	5W	18	Lots 3, 4, E $\frac{1}{2}$ SW $\frac{1}{4}$, SE $\frac{1}{4}$	310.62	oil, gas, oil shale and nitrogen only	HBP
3S	5W	21	SW $\frac{1}{2}$ NW $\frac{1}{4}$, N $\frac{1}{2}$ SW $\frac{1}{4}$, SW $\frac{1}{2}$ SW $\frac{1}{4}$	160.00	all minerals	Open
3S	5W	22	S $\frac{1}{2}$ SW $\frac{1}{4}$, SW $\frac{1}{2}$ SE $\frac{1}{4}$	120.00	oil, gas, oil shale and nitrogen only	Open
3S	5W	26	E $\frac{1}{2}$ SW $\frac{1}{4}$	80.00	oil, gas, oil shale and nitrogen only	Open
3S	5W	26	W $\frac{1}{2}$ SE $\frac{1}{4}$	80.00	oil, gas, oil shale and nitrogen only	Open

3S	5W	27	NW/4NE/4,N/4NW/4	120.00	oil, gas, oil shale and nitrogen only	Open
3S	5W	28	SE/4NW/4	40.00	oil, gas, oil shale and nitrogen only	Open
3S	5W	28	SW/4SW/4	40.00	oil, gas, oil shale and nitrogen only	Open
3S	5W	28	E/4SW/4,SE/4	240.00	oil, gas, oil shale and nitrogen only	Open
3S	5W	29	N/4	320.00	oil, gas, oil shale and nitrogen only	Open
3S	5W	29	N/4SW/4,SW/4SW/4,NW/4SE/4	160.00	oil, gas, oil shale and nitrogen only	Open
3S	5W	29	SE/4SW/4	40.00	oil, gas, oil shale and nitrogen only	Open
3S	5W	30	Lots 1,2,E/4NW/4,NE/4	312.16	oil, gas, oil shale and nitrogen only	HBP
3S	5W	30	Lots 3,4,E/4SW/4,SE/4	312.32	oil, gas, oil shale and nitrogen only	HBP
3S	5W	31	Lots 1,2,SW/4NE/4,N/4NE/4,E/4NW/4	272.90	oil, gas, oil shale and nitrogen only	HBP
3S	5W	31	Lot 3	36.82	oil, gas, oil shale and nitrogen only	HBP
3S	5W	31	SE/4SE/4	40.00	all minerals	HBP
3S	5W	32	SE/4NE/4	40.00	oil, gas, oil shale and nitrogen only	Open
3S	5W	32	NE/4NW/4	40.00	oil, gas, oil shale and nitrogen only	Open
3S	5W	32	NW/4NW/4	40.00	oil, gas, oil shale and nitrogen only	Open
3S	5W	32	N/4SE/4	80.00	oil, gas, oil shale and nitrogen only	Open
3S	5W	32	S/4SW/4,SW/4SE/4	120.00	all minerals	Open
3S	5W	32	SE/4SE/4	40.00	all minerals	Open
3S	5W	33	NE/4,E/4NW/4,SW/4NW/4	280.00	oil, gas, oil shale and nitrogen only	Open
3S	5W	33	NW/4NW/4	40.00	oil, gas, oil shale and nitrogen only	Open
3S	5W	33	S/4	320.00	oil, gas, oil shale and nitrogen only	Open
3S	5W	34	NW/4NW/4,S/4NW/4	120.00	oil, gas, oil shale and nitrogen only	Open
3S	5W	34	N/4SW/4	80.00	oil, gas, oil shale and nitrogen only	Open
3S	5W	34	SW/4SW/4	40.00	oil, gas, oil shale and nitrogen only	Open
3S	5W	34	E/4NE/4	80.00	all minerals	Open
3S	6W	1	Lots 1,2,3,4,S/4N/4,S/4	640.24	all minerals	HBP
3S	6W	2	Lots 1,2,3,4,S/4N/4,S/4	640.80	all minerals	STC
3S	6W	3	Lots 1,2,3,4,S/4N/4,S/4	641.20	all minerals	STC
3S	6W	4	Lots 1,2,3,4,S/4N/4,S/4	641.92	all minerals	STC
3S	6W	5	Lots 1,2,3,4,S/4N/4,S/4	642.16	all minerals	HBP
3S	6W	6	Lots 1,2,3,4,5,6,7,S/4NE/4,SE/4NW/4,E/4SW/4,SE/4	624.28	all minerals	Open
3S	6W	7	Lots 1,2,3,4,E/4W/4,E/4	624.80	all minerals	Open
3S	6W	8	All	640.00	all minerals	Open
3S	6W	9	All	640.00	all minerals	STC
3S	6W	10	N/4	320.00	all minerals	Open
3S	6W	10	S/4	320.00	oil, gas, oil shale and nitrogen only	Open

3S	6W	11	All		640.00	all minerals	STC
3S	6W	12	All		640.00	all minerals	HBP
3S	6W	13	N $\frac{1}{2}$		320.00	oil, gas, oil shale and nitrogen only	STC
3S	6W	13	S $\frac{1}{2}$		320.00	oil, gas, oil shale and nitrogen only	STC
3S	6W	14	N $\frac{1}{2}$		320.00	oil, gas, oil shale and nitrogen only	HBP
3S	6W	14	S $\frac{1}{2}$		320.00	oil, gas, oil shale and nitrogen only	HBP
3S	6W	15	N $\frac{1}{2}$		320.00	oil, gas, oil shale and nitrogen only	HBP
3S	6W	15	S $\frac{1}{2}$		320.00	oil, gas, oil shale and nitrogen only	HBP
3S	6W	16	N $\frac{1}{2}$		320.00	oil, gas, oil shale and nitrogen only	Open
3S	6W	16	N $\frac{1}{2}$ SW $\frac{1}{4}$, SE $\frac{1}{2}$ SW $\frac{1}{4}$, SE $\frac{1}{2}$		280.00	oil, gas, oil shale and nitrogen only	Open
3S	6W	17	All		640.00	all minerals	HBP
3S	6W	18	Lots 1,2,3,4,E $\frac{1}{2}$ W $\frac{1}{4}$,E $\frac{1}{2}$		626.32	all minerals	Open
3S	6W	19	Lots 1,2,E $\frac{1}{2}$ NW $\frac{1}{4}$,NE $\frac{1}{2}$		313.60	oil, gas, oil shale and nitrogen only	HBP
3S	6W	19	Lots 3,4,E $\frac{1}{2}$ SW $\frac{1}{4}$,SE $\frac{1}{2}$		313.76	oil, gas, oil shale and nitrogen only	HBP
3S	6W	21	S $\frac{1}{2}$ NE $\frac{1}{4}$,NW $\frac{1}{4}$		240.00	oil, gas, oil shale and nitrogen only	Open
3S	6W	21	S $\frac{1}{2}$		320.00	oil, gas, oil shale and nitrogen only	Open
3S	6W	22	N $\frac{1}{2}$		320.00	oil, gas, oil shale and nitrogen only	HBP
3S	6W	23	N $\frac{1}{2}$		320.00	oil, gas, oil shale and nitrogen only	STC
3S	6W	23	S $\frac{1}{2}$		320.00	oil, gas, oil shale and nitrogen only	STC
3S	6W	24	N $\frac{1}{2}$		320.00	oil, gas, oil shale and nitrogen only	HBP
3S	6W	24	S $\frac{1}{2}$		320.00	oil, gas, oil shale and nitrogen only	HBP
3S	6W	25	NE $\frac{1}{4}$		160.00	oil, gas, oil shale and nitrogen only	STC
3S	6W	25	S $\frac{1}{2}$		320.00	oil, gas, oil shale and nitrogen only	STC
3S	6W	26	S $\frac{1}{2}$ NE $\frac{1}{4}$		80.00	oil, gas, oil shale and nitrogen only	STC
3S	6W	26	S $\frac{1}{2}$		320.00	oil, gas, oil shale and nitrogen only	STC
3S	6W	27	N $\frac{1}{2}$		320.00	oil, gas, oil shale and nitrogen only	HBP
3S	6W	27	S $\frac{1}{2}$		320.00	oil, gas, oil shale and nitrogen only	HBP
3S	6W	28	N $\frac{1}{2}$		320.00	oil, gas, oil shale and nitrogen only	HBP
3S	6W	28	S $\frac{1}{2}$		320.00	oil, gas, oil shale and nitrogen only	HBP
3S	6W	29	N $\frac{1}{2}$		320.00	oil, gas, oil shale and nitrogen only	Open
3S	6W	29	S $\frac{1}{2}$		320.00	oil, gas, oil shale and nitrogen only	Open
3S	6W	30	Lots 1,2,E $\frac{1}{2}$ NW $\frac{1}{4}$,NE $\frac{1}{2}$		313.98	oil, gas, oil shale and nitrogen only	Open
3S	6W	30	Lots 3,4,E $\frac{1}{2}$ SW $\frac{1}{4}$,SE $\frac{1}{2}$		314.26	oil, gas, oil shale and nitrogen only	Open
3S	6W	31	Lots 1,2,E $\frac{1}{2}$ NW $\frac{1}{4}$,NE $\frac{1}{2}$		314.72	oil, gas, oil shale and nitrogen only	Open
3S	6W	31	Lots 3,4,E $\frac{1}{2}$ SW $\frac{1}{4}$,SE $\frac{1}{2}$		315.36	oil, gas, oil shale and nitrogen only	Open
3S	6W	32	N $\frac{1}{2}$		320.00	oil, gas, oil shale and nitrogen only	Open
3S	6W	32	S $\frac{1}{2}$		320.00	oil, gas, oil shale and nitrogen only	Open

20G0005608

3S	6W	33	N½		320.00	oil, gas, oil shale and nitrogen only	HBP
3S	6W	33	S½		320.00	oil, gas, oil shale and nitrogen only	HBP
3S	6W	34	N½		320.00	oil, gas, oil shale and nitrogen only	HBP
3S	6W	34	S½		320.00	oil, gas, oil shale and nitrogen only	HBP
3S	6W	35	N½		320.00	oil, gas, oil shale and nitrogen only	HBP
3S	6W	35	S½		320.00	oil, gas, oil shale and nitrogen only	HBP
3S	6W	36	All		640.00	all minerals	STC
3S	7W	5	Lots 4, SW¼NW¼		79.98	oil, gas, oil shale and nitrogen only	Open
3S	7W	6	Lots 1, 2, S½NE¼		160.00	oil, gas, oil shale and nitrogen only	Open
3S	7W	7	Lot 1, NE¼NW¼, NW¼NE¼		112.91	oil, gas, oil shale and nitrogen only	Open
3S	7W	7	Lots 3, 4		66.55	all minerals	Open
3S	7W	11	S½		320.00	oil, gas, oil shale and nitrogen only	Open
3S	7W	12	S½		320.00	oil, gas, oil shale and nitrogen only	Open
3S	7W	13	N½		320.00	oil, gas, oil shale and nitrogen only	Open
3S	7W	13	S½		320.00	oil, gas, oil shale and nitrogen only	Open
3S	7W	14	N½		320.00	all minerals	Open
3S	7W	14	S½		320.00	oil, gas, oil shale and nitrogen only	Open
3S	7W	16	NW¼SW¼		320.00	oil, gas, oil shale and nitrogen only	Open
3S	7W	17	W¼NW¼		40.00	all minerals	Open
3S	7W	17	NE¼, E¼NW¼		80.00	all minerals	Open
3S	7W	17	SW¼, NW¼SE¼		240.00	oil, gas, oil shale and nitrogen only	Open
3S	7W	17	SW¼SE¼, E¼SE¼		200.00	oil, gas, oil shale and nitrogen only	Open
3S	7W	18	E¼NE¼		120.00	all minerals	Open
3S	7W	18	Lots 1, 2		80.00	all minerals	Open
3S	7W	19	Lots 3, 4, E¼SW¼, SE¼		67.10	all minerals	Open
3S	7W	20	S½		308.43	oil, gas, oil shale and nitrogen only	Open
3S	7W	21	S½N½		320.00	oil, gas, oil shale and nitrogen only	Open
3S	7W	21	S½		160.00	oil, gas, oil shale and nitrogen only	Open
3S	7W	22	S½N½		320.00	oil, gas, oil shale and nitrogen only	Open
3S	7W	22	S½		160.00	oil, gas, oil shale and nitrogen only	Open
3S	7W	23	S½N½		320.00	oil, gas, oil shale and nitrogen only	Open
3S	7W	23	S½		160.00	oil, gas, oil shale and nitrogen only	Open
3S	7W	24	S½N½		320.00	oil, gas, oil shale and nitrogen only	Open
3S	7W	24	S½		160.00	oil, gas, oil shale and nitrogen only	Open
3S	7W	25	N½		320.00	oil, gas, oil shale and nitrogen only	HBP
3S	7W	25	S½		320.00	oil, gas, oil shale and nitrogen only	HBP
3S	7W	25	S½		320.00	oil, gas, oil shale and nitrogen only	Open

3S	7W	26	N1/2		320.00	oil, gas, oil shale and nitrogen only	Open
3S	7W	26	S1/2		320.00	oil, gas, oil shale and nitrogen only	Open
3S	7W	27	N1/2		320.00	oil, gas, oil shale and nitrogen only	Open
3S	7W	27	S1/2		320.00	oil, gas, oil shale and nitrogen only	Open
3S	7W	29	N1/2		320.00	oil, gas, oil shale and nitrogen only	Open
3S	7W	29	S1/2		320.00	oil, gas, oil shale and nitrogen only	Open
3S	7W	32	S1/2		320.00	oil, gas, oil shale and nitrogen only	Open
3S	7W	33	N1/2		320.00	oil, gas, oil shale and nitrogen only	Open
3S	7W	33	S1/2		320.00	oil, gas, oil shale and nitrogen only	Open
3S	7W	34	N1/2		320.00	oil, gas, oil shale and nitrogen only	Open
3S	7W	34	S1/2		320.00	oil, gas, oil shale and nitrogen only	Open
3S	7W	35	N1/2		320.00	oil, gas, oil shale and nitrogen only	Open
3S	7W	35	S1/2		320.00	oil, gas, oil shale and nitrogen only	Open
3S	7W	36	N1/2		320.00	oil, gas, oil shale and nitrogen only	Open
3S	7W	36	S1/2		320.00	oil, gas, oil shale and nitrogen only	Open
4S	5W	2	Lots 2, 3, 4, SE1/2NW1/4, SW1/2NE1/4, NW1/2SE1/4, NE1/2SW1/4		70.34	1/2 interest in all minerals	Open
4S	5W	2	SW1/4NW1/4		40.00	oil, gas, oil shale and nitrogen only	Open
4S	5W	2	SE1/2SE1/4		40.00	oil, gas, oil shale and nitrogen only	Open
4S	5W	2	W1/2SW1/4, SE1/2SW1/4, SW1/2SE1/4		160.00	all minerals	Open
4S	5W	3	Lots 1, 2, 3, 4		160.68	all minerals	Open
4S	5W	3	S1/2N1/2, S1/2		480.00	all minerals	Open
4S	5W	4	Lots 1, 2, 3, 4, S1/2N1/2, S1/2		639.20	all minerals	Open
4S	5W	5	Lots 1, 2, 3, 4, S1/2N1/2, S1/2		638.80	all minerals	STC
4S	5W	6	Lots 1, 2, 3, 5, 6, 7, S1/2NE1/4, SE1/2NW1/4, E1/2SW1/4, SE1/4		593.90	all minerals	Open
4S	5W	7	Lots 1, 2, 3, 4, E1/2W1/4, E1/4		635.64	all minerals	Open
4S	5W	8	All		640.00	all minerals	Open
4S	5W	9	All		640.00	all minerals	STC
4S	5W	10	All		640.00	all minerals	STC
4S	5W	12	All		640.00	all minerals	STC
4S	5W	13	All		640.00	all minerals	Open
4S	5W	14	SW1/2SW1/4, SE1/4		200.00	all minerals	Open
4S	5W	15	N1/2SW1/4, SW1/2SW1/4		120.00	oil, gas, oil shale and nitrogen only	Open
4S	5W	15	SE1/2SW1/4		40.00	oil, gas, oil shale and nitrogen only	Open
4S	5W	15	NW1/4		160.00	all minerals	Open
4S	5W	16	NW1/2NE1/4, SE1/2NE1/4		80.00	all minerals	Open
4S	5W	16	NE1/2NE1/4, SW1/2NE1/4, W1/2, SE1/4		560.00	all minerals	Open

4S	5W	17	All	640.00	all minerals	Open
4S	5W	18	Lots 1,2,3,4,E½W½,E½	638.00	all minerals	Open
4S	6W	1	Lots 3,4	80.24	all minerals	Open
4S	6W	1	SE½NE½	40.00	oil, gas, oil shale and nitrogen only	Open
4S	6W	1	S½	160.00	all minerals	Open
4S	6W	2	Lots 1,2,3	120.61	oil, gas, oil shale and nitrogen only	Open
4S	6W	2	S½	320.00	all minerals	Open
4S	6W	3	Lots 1-4,S½NW½,SW½NE½	280.56	all minerals	STC
4S	6W	3	N½SW½	80.00	oil, gas, oil shale and nitrogen only	STC
4S	6W	4	Lots 1-5,S½NW½,NE½SW½	401.11	all minerals	HBP
4S	6W	4	N½SE½	80.00	oil, gas, oil shale and nitrogen only	HBP
4S	6W	5	Lots 8	9.55	all minerals	STC
4S	6W	5	Lots 1-4,S½NW½	321.84	oil, gas, oil shale and nitrogen only	STC
4S	6W	5	Lots 5,6,7,N½SW½,SW½SW½	175.10	oil, gas, oil shale and nitrogen only	STC
4S	6W	6	Lots 1-5,S½NE½,SE½NW½	316.58	oil, gas, oil shale and nitrogen only	HBP
4S	6W	6	Lots 6,7,E½SW½,SE½	316.21	oil, gas, oil shale and nitrogen only	HBP
4S	6W	7	NE½NE½	40.00	oil, gas, oil shale and nitrogen only	Open
4S	6W	7	Lots 1,2,W½NE½,E½NW½	236.60	oil, gas, oil shale and nitrogen only	Open
4S	6W	7	Lot 3,NE½SW½	78.45	oil, gas, oil shale and nitrogen only	Open
4S	6W	7	SE½NE½,N½SE½	120.00	oil, gas, oil shale and nitrogen only	Open
4S	6W	8	SW½NW½	40.00	oil, gas, oil shale and nitrogen only	Open
4S	6W	8	S½NE½,SE½NW½,S½	440.00	all minerals	Open
4S	6W	9	S½NW½	80.00	oil, gas, oil shale and nitrogen only	Open
4S	6W	9	SW½	160.00	oil, gas, oil shale and nitrogen only	Open
4S	6W	10	Lots 1,2	69.21	oil, gas, oil shale and nitrogen only	Open
4S	6W	10	S½NW½	80.00	oil, gas, oil shale and nitrogen only	Open
4S	6W	10	E½SE½	80.00	all minerals	Open
4S	6W	11	All	640.00	all minerals	HBP
4S	6W	12	All	640.00	all minerals	Open
4S	6W	13	All	640.00	all minerals	Open
4S	6W	14	Lots 5,6,S½SW½,SE½	316.90	oil, gas, oil shale and nitrogen only	HBP
4S	6W	14	Lots 1,4,7,8,NE½	271.62	all minerals	HBP
4S	6W	15	Lots 1,N½NE½,SW½NE½,W½,SE½	629.74	all minerals	HBP
4S	6W	16	All	640.00	all minerals	Open
4S	6W	17	W½SW½	80.00	oil, gas, oil shale and nitrogen only	Open
4S	6W	17	N½,E½SW½,SE½	560.00	all minerals	Open

4S	6W	18	SE $\frac{1}{2}$ NE $\frac{1}{4}$	40.00	oil, gas, oil shale and nitrogen only	Open
4S	6W	18	SW $\frac{1}{2}$ NE $\frac{1}{4}$, E $\frac{1}{2}$ SW $\frac{1}{4}$	120.00	all minerals	Open
4S	6W	18	Lots 2-4, SE $\frac{1}{2}$ NW $\frac{1}{4}$, E $\frac{1}{2}$ SE $\frac{1}{4}$, W $\frac{1}{2}$ SE $\frac{1}{4}$	316.40	all minerals	Open
4S	7W	1	Lots 1-4, S $\frac{1}{2}$ N $\frac{1}{2}$	320.40	oil, gas, oil shale and nitrogen only	Open
4S	7W	1	S $\frac{1}{2}$	320.00	oil, gas, oil shale and nitrogen only	Open
4S	7W	2	Lots 1-4, S $\frac{1}{2}$ N $\frac{1}{2}$	320.40	oil, gas, oil shale and nitrogen only	Open
4S	7W	2	S $\frac{1}{2}$	320.00	oil, gas, oil shale and nitrogen only	Open
4S	7W	3	Lots 1-4, S $\frac{1}{2}$ N $\frac{1}{2}$	320.60	oil, gas, oil shale and nitrogen only	Open
4S	7W	3	S $\frac{1}{2}$	320.00	oil, gas, oil shale and nitrogen only	Open
4S	7W	4	Lots 1-4, S $\frac{1}{2}$ N $\frac{1}{2}$	321.00	oil, gas, oil shale and nitrogen only	Open
4S	7W	4	S $\frac{1}{2}$	320.00	oil, gas, oil shale and nitrogen only	Open
4S	7W	5	Lots 1-4, S $\frac{1}{2}$ N $\frac{1}{2}$	320.40	oil, gas, oil shale and nitrogen only	Open
4S	7W	5	S $\frac{1}{2}$	320.00	oil, gas, oil shale and nitrogen only	Open
4S	7W	8	N $\frac{1}{2}$	320.00	oil, gas, oil shale and nitrogen only	Open
4S	7W	8	S $\frac{1}{2}$	320.00	oil, gas, oil shale and nitrogen only	Open
4S	7W	9	N $\frac{1}{2}$	320.00	oil, gas, oil shale and nitrogen only	Open
4S	7W	9	S $\frac{1}{2}$	320.00	oil, gas, oil shale and nitrogen only	Open
4S	7W	10	Lots 1, 2, N $\frac{1}{2}$ SW $\frac{1}{4}$, SE $\frac{1}{4}$	305.65	oil, gas, oil shale and nitrogen only	Open
4S	7W	10	N $\frac{1}{2}$	320.00	oil, gas, oil shale and nitrogen only	Open
4S	7W	11	Lot 1, N $\frac{1}{2}$ NE $\frac{1}{4}$, SE $\frac{1}{2}$ NE $\frac{1}{4}$, NW $\frac{1}{4}$	319.99	oil, gas, oil shale and nitrogen only	Open
4S	7W	12	N $\frac{1}{2}$	320.00	oil, gas, oil shale and nitrogen only	Open
4S	7W	12	N $\frac{1}{2}$ S $\frac{1}{2}$	160.00	oil, gas, oil shale and nitrogen only	Open
4S	7W	13	NE $\frac{1}{2}$ NE $\frac{1}{4}$, S $\frac{1}{2}$ N $\frac{1}{2}$	200.00	oil, gas, oil shale and nitrogen only	Open
4S	7W	13	S $\frac{1}{2}$	320.00	oil, gas, oil shale and nitrogen only	Open
4S	7W	13	NE $\frac{1}{2}$ NW $\frac{1}{4}$	40.00	all minerals	Open
4S	7W	14	NW $\frac{1}{2}$ NW $\frac{1}{4}$	40.00	oil, gas, oil shale and nitrogen only	Open
4S	7W	14	SE $\frac{1}{2}$ NE $\frac{1}{4}$, E $\frac{1}{2}$ SW $\frac{1}{4}$, SW $\frac{1}{2}$ SW $\frac{1}{4}$, SE $\frac{1}{4}$	320.00	all minerals	Open
4S	7W	15	SE $\frac{1}{2}$ NE $\frac{1}{4}$	40.00	oil, gas, oil shale and nitrogen only	Open
4S	7W	15	NW $\frac{1}{2}$ SW $\frac{1}{4}$	40.00	oil, gas, oil shale and nitrogen only	Open
4S	7W	15	SW $\frac{1}{2}$ SW $\frac{1}{4}$	40.00	oil, gas, oil shale and nitrogen only	Open
4S	7W	15	S $\frac{1}{2}$ SE $\frac{1}{4}$	80.00	oil, gas, oil shale and nitrogen only	Open
4S	7W	16	N $\frac{1}{2}$	320.00	oil, gas, oil shale and nitrogen only	Open
4S	7W	16	N $\frac{1}{2}$ SW $\frac{1}{4}$	80.00	oil, gas, oil shale and nitrogen only	Open
4S	7W	16	S $\frac{1}{2}$ SW $\frac{1}{4}$	80.00	oil, gas, oil shale and nitrogen only	Open
4S	7W	16	NE $\frac{1}{2}$ SE $\frac{1}{4}$	40.00	oil, gas, oil shale and nitrogen only	Open
4S	7W	16	W $\frac{1}{2}$ SE $\frac{1}{4}$, SE $\frac{1}{2}$ SE $\frac{1}{4}$	120.00	oil, gas, oil shale and nitrogen only	Open

2000000000

XXXXXXXXXX

	66,101.47		
TOTAL TRIBAL MINERAL ACRES IN AMI:			
		Status of Tribal Minerals as of the Effective Date	
	40,444.24	Open - Available to Lease	
	10,984.21	STC - Existing lease terminated and is subject to cancellation by BIA (in progress), making the lands available to lease.	
	14,602.68	HBP - Leased & held by production by others	

Covering the Blacktail Ridge Area of Mutual Interest (AMI)

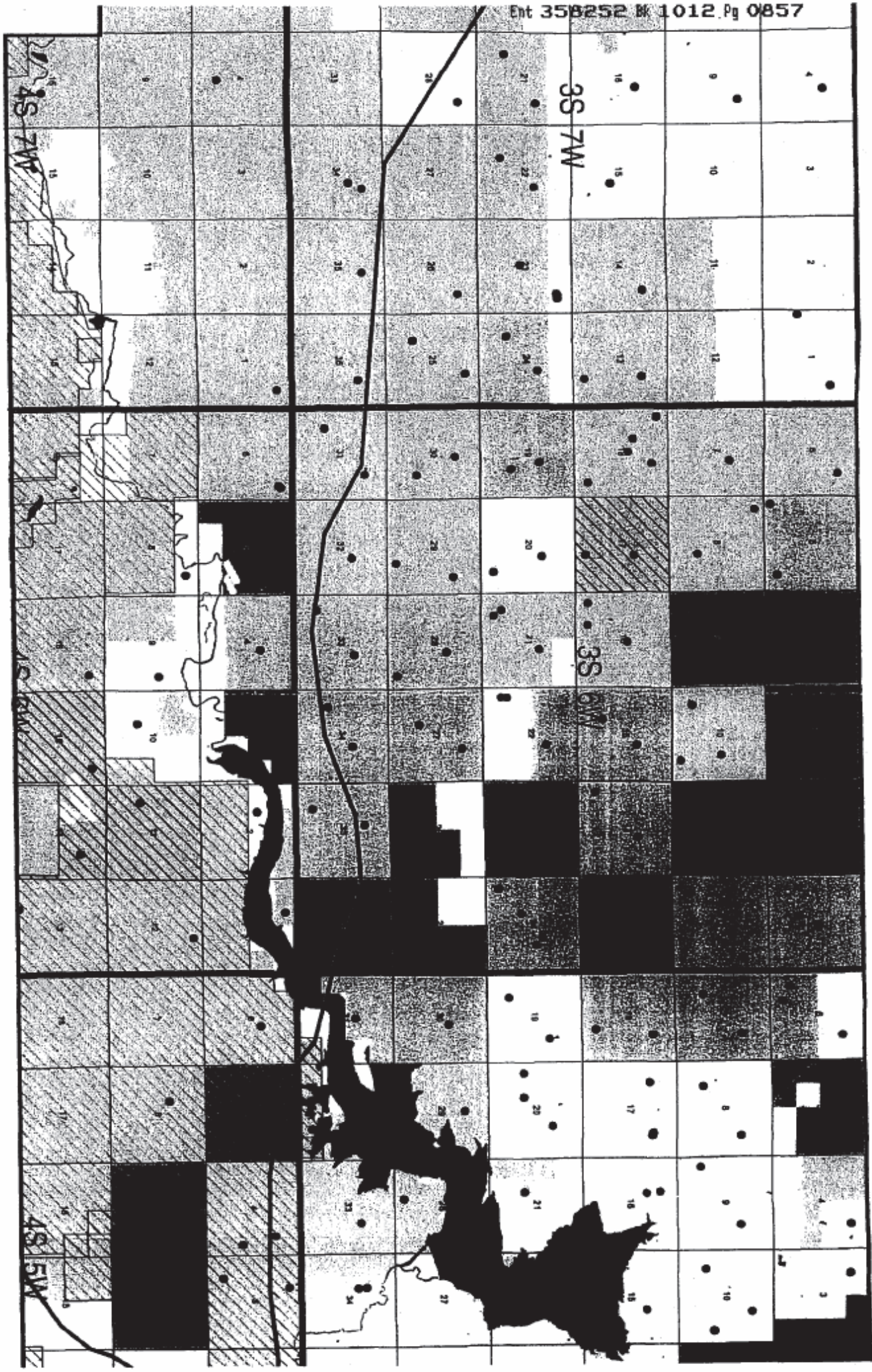

EXHIBIT B
to
Assignment and Assumption Agreement
dated effective March 5, 2010

EXHIBIT B - Ute Tribal Lands

to Exploration and Development Agreement between the Ute Indian Tribe, Newfield Production Company
and the Ute Distribution Corporation Covering Lands in the Monument Butte Area

LEGEND:

- UTS Ute Tribal Surface
- UTM Ute Tribal Minerals
- UIN Uintah County
- DUC Duchesne County
- TWP Township
- RNG Range
- SEC Section

Twp. Rng. County Sec.

Drilling Block A

Legal Description:

UTM Gross Acres UTM Net Acres

Use Tribal Mineral Ownership

UTS Gross Acres

Drilling Block A		Legal Description:		UTM Gross Acres UTM Net Acres		Use Tribal Mineral Ownership	UTS Gross Acres
				MINERALS			SURFACE
4S 2W	Duc	1	Lot 1, SE 1/4 NE 1/4	83.03	83.03	oil, gas, oil shale and nitrogen only	0.00
4S 2W	Duc	1	Lot 2, SW 1/4 NE 1/4	82.86	82.86	oil, gas, oil shale and nitrogen only	0.00
4S 2W	Duc	1	NW 1/4 SE 1/4	40.00	40.00	oil, gas, oil shale and nitrogen only	0.00
4S 2W	Duc	4	Lots 3, 4, SW 1/4 NW 1/4	127.18	127.18	oil and gas only	0.00
4S 2W	Duc	5	Lot 1, SE 1/4 NE 1/4, NE 1/4 SE 1/4	123.55	123.55	oil and gas only	0.00
4S 2W	Duc	5	SE 1/4 SE 1/4	40.00	40.00	oil, gas, oil shale and nitrogen only	0.00
4S 2W	Duc	7	Lot 1, 2, E 1/4 NW 1/4, S 1/4 NE 1/4, NW 1/4 NE 1/4	279.04	279.04	oil, gas, oil shale and nitrogen only	0.00
4S 2W	Duc	7	Lot 3, NE 1/4 SW 1/4, NW 1/4 SE 1/4	159.70	159.70	all minerals	0.00
4S 2W	Duc	8	NE 1/4 NE 1/4, S 1/4 NE 1/4	120.00	120.00	oil, gas, oil shale and nitrogen only	0.00
4S 2W	Duc	8	SE 1/4	160.00	160.00	oil, gas, oil shale and nitrogen only	0.00
4S 2W	Duc	11	N 1/4 S 1/4	160.00	160.00	all minerals	0.00
4S 2W	Duc	11	SW 1/4 SW 1/4	40.00	40.00	oil, gas, oil shale and nitrogen only	0.00
4S 2W	Duc	11	SE 1/4 SE 1/4	40.00	40.00	oil, gas, oil shale and nitrogen only	0.00
4S 2W	Duc	12	E 1/4 NE 1/4, SW 1/4 NE 1/4	120.00	120.00	oil, gas, oil shale and nitrogen only	120.00
4S 2W	Duc	12	W 1/4 SW 1/4	80.00	80.00	all minerals	0.00
4S 2W	Duc	12	E 1/4 SE 1/4	80.00	80.00	oil, gas, oil shale and nitrogen only	0.00
4S 2W	Duc	13	NW 1/4	160.00	160.00	oil, gas, oil shale and nitrogen only	0.00
4S 2W	Duc	14	Lot 1, NW 1/4 SE 1/4, SW 1/4 NE 1/4, SE 1/4 NW 1/4	151.00	151.00	oil, gas, oil shale and nitrogen only	0.00
4S 2W	Duc	14	NW 1/4 NW 1/4	40.00	40.00	oil, gas, oil shale and nitrogen only	0.00
4S 2W	Duc	14	Lot 2, SW 1/4 NW 1/4, W 1/4 SW 1/4	152.75	152.75	oil, gas, oil shale and nitrogen only	0.00
4S 2W	Duc	14	parts of SE 1/4 SW 1/4, SW 1/4 SE 1/4	16.25	16.25	all minerals	16.25
4S 2W	Duc	16	E 1/4 NW 1/4, SW 1/4 NW 1/4	120.00	120.00	all minerals	0.00
4S 2W	Duc	16	NW 1/4 NW 1/4	40.00	40.00	oil, gas, oil shale and nitrogen only	0.00
4S 2W	Duc	17	N 1/4 NE 1/4, SW 1/4 NE 1/4	120.00	120.00	oil, gas, oil shale and nitrogen only	0.00
4S 2W	Duc	17	SE 1/4 NE 1/4, N 1/4 SE 1/4, NW 1/4 NW 1/4 SW 1/4	320.00	320.00	all minerals	0.00
4S 2W	Duc	18	Lot 2, E 1/4 NW 1/4	119.97	119.97	oil, gas, oil shale and nitrogen only	0.00
4S 2W	Duc	18	Lot 1	39.91	39.91	all minerals	0.00
4S 2W	Duc	18	Lot 3, 4, E 1/4 SW 1/4, SE 1/4	320.12	320.12	oil, gas, oil shale and nitrogen only	0.00
4S 2W	Duc	19	Lot 1, 2, E 1/4 NW 1/4, W 1/4 NE 1/4	240.20	240.20	oil, gas, oil shale and nitrogen only	0.00
4S 2W	Duc	19	Lot 3, 4, E 1/4 SW 1/4, SE 1/4	320.12	320.12	oil, gas, oil shale and nitrogen only	0.00
4S 2W	Duc	21	S 1/4 NE 1/4, SE 1/4 S 1/4 SW 1/4	320.00	320.00	all minerals	0.00
4S 2W	Duc	21	NW 1/4	160.00	160.00	oil, gas, oil shale and nitrogen only	0.00
4S 2W	Duc	22	S 1/4	320.00	320.00	all minerals	0.00
4S 2W	Duc	23	Lot 1, 6, 7, NE 1/4 NE 1/4	82.00	82.00	oil, gas, oil shale and nitrogen only	0.00
4S 2W	Duc	23	W 1/4 SW 1/4	80.00	80.00	all minerals	0.00
4S 2W	Duc	23	parts of S 1/4 NE 1/4, NW 1/4 NE 1/4, NE 1/4 NW 1/4	45.15	45.15	all minerals	45.15
4S 2W	Duc	24	Lot 1, NE 1/4 SW 1/4	79.05	79.05	oil, gas, oil shale and nitrogen only	0.00
4S 2W	Duc	26	Lot 4	6.89	6.89	all minerals	0.00

Twp.	Rng.	County	Sec.	Legal Description:	UTM Gross Acres	UTM Net Acres	Use Tribal Mineral Ownership	UTS Gross Acres
4S	2W	Duc	27	Lots 1,2,3,4	26.59	26.59	all minerals	0.00
4S	2W	Duc	28	Lots 1,2,3,4	126.64	126.64	all minerals	0.00
4S	2W	Duc	30	Lots 1,2,3,4,5,6,NE¼,E¼NW¼	475.16	475.16	all minerals	0.00
Total UTM Acres - Block A					5,617.16	5,617.16	Total UTS Acres - Block A	181.40

UTE TRIBAL LANDS [ALLOTTED]					UTM Gross Acres	UTM Net Acres	Use Tribal Mineral Ownership	UTS Gross Acres
4S	2W	Duc	5	SW¼SE¼,SE¼SW¼	80.00	2.04	all minerals	0.00
4S	2W	Duc	8	NW¼NE¼,NE¼NW¼	80.00	2.04	all minerals	0.00
Total UTM [Allotted] Acres - Block A					160.00	4.08	Total UTS [Allotted] Acres - Block A	0.00
Total All UTM Acres - Block A					5,777.16	5,621.24	Total All UTS Acres - Block A	181.40

Drilling Block B					UTE TRIBAL LANDS		MINERALS		SURFACE	
4S	1W	Uln	1	Lots 1,2,3,4,5,6,7,SW¼NE¼,S¼NW¼	397.68	397.68	all minerals	397.68	all minerals	397.68
4S	1W	Uln	1	SW¼,W¼SE¼	240.00	240.00	all minerals	240.00	all minerals	240.00
4S	1W	Uln	2	S¼SE¼,NE¼SE¼	120.00	120.00	all minerals	120.00	all minerals	120.00
4S	1W	Duc Uln	3	Lots 1,2,3,4,S¼NW¼,W¼SW¼	330.52	330.52	all minerals	330.52	all minerals	330.52
4S	1W	Duc	4	Lots 1,2,S¼NE¼,S¼SW¼,NE¼SW¼,SE¼	447.91	447.91	all minerals	447.91	all minerals	447.91
4S	1W	Duc	5	Lots 1,2,S¼NE¼,S¼SW¼,NE¼SW¼	291.97	291.97	all minerals	291.97	all minerals	291.97
4S	1W	Duc	5	W¼SE¼,SE¼SE¼	120.00	120.00	all minerals	120.00	all minerals	120.00
4S	1W	Duc	5	Lot 4	46.83	46.83	all minerals	46.83	all minerals	46.83
4S	1W	Duc	6	Lot 1,S¼NE¼	127.43	127.43	all minerals	127.43	all minerals	127.43
4S	1W	Duc	6	Lots 2,3,4,SE¼NW¼	177.51	177.51	all minerals	177.51	all minerals	177.51
4S	1W	Duc	6	NE¼SE¼	40.00	40.00	all minerals	40.00	all minerals	40.00
4S	1W	Duc	6	S¼SE¼	80.00	80.00	all minerals	80.00	all minerals	80.00
4S	1W	Duc	7	Lots 1,2,NE¼NE¼,NE¼,N¼SE¼	349.33	349.33	all minerals	349.33	all minerals	349.33
4S	1W	Duc	7	Lot 4,SE¼SW¼	74.53	74.53	all minerals	74.53	all minerals	74.53
4S	1W	Duc	7	S¼SE¼	80.00	80.00	all minerals	80.00	all minerals	80.00
4S	1W	Duc	8	ALL	640.00	640.00	all minerals	640.00	all minerals	640.00
4S	1W	Duc	9	S¼	320.00	320.00	all minerals	320.00	all minerals	320.00
4S	1W	Duc Uln	10	SE¼NE¼	40.00	40.00	all minerals	40.00	all minerals	40.00
4S	1W	Uln	11	E¼,E¼NW¼,SW¼ANW¼,SW¼	600.00	600.00	all minerals	600.00	all minerals	600.00
4S	1W	Uln	12	Lots 1,2,3,4,W¼E¼,W¼	636.05	636.05	all minerals	636.05	all minerals	636.05
4S	1W	Uln	13	Lots 1,2,W¼NE¼,NW¼	317.66	317.66	all minerals	317.66	all minerals	317.66
4S	1W	Uln	14	N¼	320.00	320.00	all minerals	320.00	all minerals	320.00
4S	1W	Uln	14	SE¼	160.00	160.00	all minerals	160.00	all minerals	160.00
4S	1W	Duc Uln	15	NE¼,N¼ANW¼,SE¼ANW¼	280.00	280.00	all minerals	280.00	all minerals	280.00
4S	1W	Duc Uln	15	SW¼NW¼,NW¼SW¼	80.00	80.00	all minerals	80.00	all minerals	80.00
4S	1W	Duc Uln	15	S¼SW¼,NE¼SW¼,SE¼	280.00	280.00	all minerals	280.00	all minerals	280.00
4S	1W	Duc	16	N¼N¼,SW¼ANW¼	200.00	200.00	all minerals	200.00	all minerals	200.00

Twp.	Rng.	County	Sec.	Legal Description:	UTM Gross Acres	UTM Net Acres	Use Tribal Mineral Ownership	UTS Gross Acres
4S	1W	Duc	16	SE1/4NE1/4, NE1/4SE1/4	80.00	80.00	all minerals	0.00
4S	1W	Duc	16	SW1/4NE1/4, SE1/4NW1/4, NE1/4SW1/4, NW1/4SE1/4	160.00	160.00	all minerals	0.00
4S	1W	Duc	16	S1/2S1/2	160.00	160.00	all minerals	0.00
4S	1W	Duc	17	N1/2NE1/4	80.00	80.00	all minerals	0.00
4S	1W	Duc	17	S1/2SW1/4, W1/2SE1/4	160.00	160.00	oil and gas only	0.00
4S	1W	Duc	17	SE1/4SE1/4	40.00	40.00	all minerals	0.00
4S	1W	Duc	18	E1/2SW1/4, S1/2SE1/4	160.00	160.00	all minerals	0.00
4S	1W	Duc	19	W1/2NE1/4, E1/2NW1/4	160.00	160.00	all minerals	0.00
4S	1W	Duc	19	Lot 4 SE1/2SW1/4, W1/2SE1/4	154.51	154.51	all minerals	0.00
4S	1W	Duc	20	N1/2SE1/4, SW1/4SE1/4, SE1/4SW1/4	160.00	160.00	all minerals	0.00
4S	1W	Duc	21	E1/2NE1/4	80.00	80.00	all minerals	0.00
4S	1W	Duc	21	W1/2NE1/4, NE1/4NW1/4, NW1/4SE1/4	160.00	160.00	all minerals	0.00
4S	1W	Duc	21	NE1/4SE1/4	40.00	40.00	all minerals	0.00
4S	1W	Duc	22	NW1/4	160.00	160.00	all minerals	0.00
4S	1W	Duc	22	NW1/4SW1/4	40.00	40.00	all minerals	0.00
4S	1W	Uln	23	E1/2NE1/4, SW1/4NE1/4, SE1/4NW1/4	160.00	160.00	oil and gas only	0.00
4S	1W	Uln	24	SE1/4NW1/4, NE1/4SW1/4, S1/2SW1/4	160.00	160.00	all minerals	160.00
4S	1W	Uln	25	Lots 1, 2, 3, 4, 5, NW1/2NE1/4, N1/2NW1/4	283.45	283.45	all minerals	283.45
4S	1W	Duc	29	Lots 2, 3	17.00	17.00	all minerals	0.00
4S	1W	Duc	30	Lots 2, 3, 4	24.74	24.74	all minerals	0.00
Total All UTM Acres - Block B					9,237.12	9,237.12	Total UTS Acres - Block B	5,054.57

Drilling Block C				UTE TRIBAL LANDS	MINERALS	SURFACE		
4S	1E	Uln	1	Lots 1, 2, 3, 4, S1/2N1/2	320.00	320.00	oil, gas, oil shale and nitrogen only	0.00
4S	1E	Uln	1	S1/2	320.00	320.00	oil, gas, oil shale and nitrogen only	0.00
4S	1E	Uln	2	Lots 1, 2, 3, 4, S1/2N1/2	320.00	320.00	oil, gas, oil shale and nitrogen only	0.00
4S	1E	Uln	2	S1/2	320.00	320.00	oil, gas, oil shale and nitrogen only	0.00
4S	1E	Uln	3	N1/2	320.00	320.00	oil, gas, oil shale and nitrogen only	0.00
4S	1E	Uln	3	S1/2	320.00	320.00	oil, gas, oil shale and nitrogen only	0.00
4S	1E	Uln	4	N1/2	320.00	320.00	oil, gas, oil shale and nitrogen only	0.00
4S	1E	Uln	4	S1/2	320.00	320.00	oil, gas, oil shale and nitrogen only	0.00
4S	1E	Uln	5	All	640.00	640.00	all minerals	640.00
4S	1E	Uln	6	All	648.00	648.00	all minerals	648.00
4S	1E	Uln	7	All	649.44	649.44	all minerals	649.44
4S	1E	Uln	8	All	640.00	640.00	all minerals	640.00
4S	1E	Uln	9	N1/2	320.00	320.00	oil, gas, oil shale and nitrogen only	0.00
4S	1E	Uln	9	S1/2	320.00	320.00	oil, gas, oil shale and nitrogen only	0.00
4S	1E	Uln	10	N1/2	320.00	320.00	oil, gas, oil shale and nitrogen only	0.00
4S	1E	Uln	10	S1/2	320.00	320.00	oil, gas, oil shale and nitrogen only	0.00

Twp.	Range	County	Section	Legal Description:	UTM Gross Acres	UTM Net Acres	Use Tribal Mineral Ownership	UTS Gross Acres	
4S	1E	Uin	11	N½	320.00	320.00	oil, gas, oil shale and nitrogen only	0.00	
4S	1E	Uin	11	S½	320.00	320.00	oil, gas, oil shale and nitrogen only	0.00	
4S	1E	Uin	12	N½	320.00	320.00	oil, gas, oil shale and nitrogen only	0.00	
4S	1E	Uin	12	S½	320.00	320.00	oil, gas, oil shale and nitrogen only	0.00	
4S	1E	Uin	14	N½	320.00	320.00	oil, gas, oil shale and nitrogen only	0.00	
4S	1E	Uin	14	S½	320.00	320.00	oil, gas, oil shale and nitrogen only	0.00	
4S	1E	Uin	15	N½	320.00	320.00	oil, gas, oil shale and nitrogen only	0.00	
4S	1E	Uin	15	S½	320.00	320.00	oil, gas, oil shale and nitrogen only	0.00	
4S	1E	Uin	17	All	640.00	640.00	all minerals	640.00	
4S	1E	Uin	18	All	651.12	651.12	all minerals	651.12	
4S	1E	Uin	20	All	640.00	640.00	all minerals	640.00	
4S	1E	Uin	21	All	640.00	640.00	HBP by third parties	640.00	
4S	1E	Uin	22	All	0.00	0.00	HBP by third parties	649.00	
4S	1E	Uin	23	All	0.00	0.00	oil, gas, oil shale and nitrogen only	0.00	
4S	1E	Uin	23	SW¼SE¼	320.00	320.00	HBP by third parties	40.00	
4S	1E	Uin	23	SW¼SE¼	0.00	0.00	HBP by third parties	280.00	
4S	1E	Uin	24	N½	280.00	280.00	all minerals	0.00	
4S	1E	Uin	24	S½	320.00	320.00	oil, gas, oil shale and nitrogen only	0.00	
4S	1E	Uin	25	All	0.00	0.00	HBP by third parties	640.00	
4S	1E	Uin	26	Lot 1, N½, N¼S½, SE¼SW¼, S½SE¼	0.00	0.00	HBP by third parties	638.25	
4S	1E	Uin	27	N½	0.00	0.00	HBP by third parties	320.00	
4S	1E	Uin	28	N½	0.00	0.00	HBP by third parties	320.00	
4S	1E	Uin	29	N½	0.00	0.00	HBP by third parties	320.00	
4S	1E	Uin	29	N¼	320.00	320.00	all minerals	0.00	
4S	1E	Uin	29	Lots 1, 2, 3, 4, NE¼SW¼, N¼SE¼	239.55	239.55	oil, gas, oil shale and nitrogen only	0.00	
4S	1E	Uin	30	Lots 1, 2, 3, NE¼, NE¼NW¼	354.21	354.21	all minerals	354.21	
4S	1E	Uin	30	Lots 4, 5	53.65	53.65	oil, gas, oil shale and nitrogen only	0.00	
4S	1E	Uin	32	Lot 1 (All)	1.58	1.58	oil, gas, oil shale and nitrogen only	0.00	
4S	1E	Uin	35	Lots 1, 2, 3, 4, 12, 13, S½NW¼, NE¼SW¼, N¼SE¼	353.72	353.72	all minerals	353.72	
4S	1E	Uin	35	Lots 5, 6, 7	16.60	16.60	oil, gas, oil shale and nitrogen only	0.00	
4S	1E	Uin	35	Lots 8, 9, 10, 11	71.00	71.00	all minerals	71.00	
4S	1E	Uin	36	Lots 3, 4, 5, 6, 8, 10, 11, 12, 13, 14, N¼NE¼, NE¼NW¼, NW¼SW¼	393.22	393.22	all minerals	393.22	
Total All UTM Acres - Block C					13,952.09	13,952.09	Total UTS Acres - Block C	9,527.96	
Drilling Block D					UTE TRIBAL LANDS			SURFACE	
4S	2E	Uin	19	Lots 3, 4, 5, 6, 7, S½NE¼, SE¼NW¼, E½SW¼, W½SE¼, E½SE¼	576.49	576.49	Third party lease (all minerals) expires 4/08 with 1 year extension to 4/09	0.00	
4S	2E	Uin	20	All	640.00	640.00	Third party lease (all minerals) expires 4/08 with 1 year extension to 4/09	0.00	
MINERALS					0.00				

Twp.	Rng.	County	Sec.	Legal Description:	UTM Gross Acres	UTM Net Acres	Use Tribal Mineral Ownership	UTS Gross Acres
4S	2E	Uin	21	All	640.00	640.00	Third party lease (all minerals) expires 4/08 with 1 year extension to 4/09	0.00
4S	2E	Uin	23	Lots 1,2,3,4,6,7,8,9,10,11,W/2NE1/4,SE1/4NE1/4	451.83	451.83	all minerals	451.83
4S	2E	Uin	24	SW1/4NW1/4	40.00	40.00	all minerals	40.00
4S	2E	Uin	26	Lots 1,2,5,6,9,10,NW1/4NE1/4,NE1/4NW1/4	260.24	260.24	all minerals	260.24
4S	2E	Uin	27	S1/4	320.00	320.00	all minerals	320.00
4S	2E	Uin	28	N1/4	320.00	320.00	oil, gas, oil shale and nitrogen only	0.00
4S	2E	Uin	28	S1/4	320.00	320.00	oil, gas, oil shale and nitrogen only	0.00
4S	2E	Uin	28	All	640.00	640.00	Third party lease (all minerals) expires 4/08 with 1 year extension to 4/09	0.00
4S	2E	Uin	30	All	690.90	690.90	Third party lease (all minerals) expires 4/08 with 1 year extension to 4/09	690.90
4S	2E	Uin	31	Lots 1,2,3,4,5,6,7,NE1/4,E1/2NW1/4,N1/2SE1/4	568.21	568.21	all minerals	568.21
4S	2E	Uin	32	Lots 1,2,3,4,N1/2S1/4	328.76	328.76	oil, gas, oil shale and nitrogen only	0.00
4S	2E	Uin	32	N1/4	320.00	320.00	oil, gas, oil shale and nitrogen only	0.00
4S	2E	Uin	33	Lots 1,2,3,4,N1/2S1/4	325.72	325.72	oil, gas, oil shale and nitrogen only	0.00
4S	2E	Uin	33	N1/4	320.00	320.00	oil, gas, oil shale and nitrogen only	0.00
4S	2E	Uin	34	All	644.20	644.20	all minerals	644.20
4S	2E	Uin	35	Lots 4,5,6,7,8,9,10,11,12	337.01	337.01	all minerals	337.01
4S	2E	Uin	36	Lots 2,3,4,5,6,7,8,9,10,11,12,N1/2NW1/4,SE1/4NW1/4,SE1/4	595.80	595.80	all minerals	595.80
4S	3E	Uin	19	Lots 3,4,9,NE1/4,E1/2NW1/4,SE1/4SE1/4	376.65	376.65	all minerals	0.00
4S	3E	Uin	19	Uin RIVER	26.09	26.09	all minerals	26.09
4S	3E	Uin	20	Lots 1,2,3,4,8,9,10,11	228.99	228.99	all minerals	228.90
4S	3E	Uin	28	Lots 1,2	0.00	0.00	HBP by third parties	40.74
4S	3E	Uin	28	Green River	0.00	0.00	HBP by third parties	26.00
4S	3E	Uin	29	Lots 3,4	0.00	0.00	HBP by third parties	80.00
4S	3E	Uin	29	Lots 7,8,9,10,S1/4S1/4	0.00	0.00	HBP by third parties	318.25
4S	3E	Uin	30	Lots 1,2,SE1/4NE1/4	88.00	88.00	all minerals	88.00
4S	3E	Uin	30	Lots 13,14	78.45	78.45	all minerals	78.45
4S	3E	Uin	30	NE1/4SE1/4,S1/2SE1/4 east of river	75.37	75.37	all minerals	75.37
4S	3E	Uin	30	UINTAH RIVER	32.35	32.35	all minerals	32.35
4S	3E	Uin	31	Lots 8,9	43.40	43.40	all minerals	43.40
4S	3E	Uin	31	Lots 2,3,4,5,13,14,E1/2NE1/4 west of river	261.07	261.07	all minerals	261.07
4S	3E	Uin	31	UINTAH RIVER	21.68	21.68	all minerals	21.68
4S	3E	Uin	32	Lots 1,2,3,4,5,6,7,8,9,10,11,12,13	481.65	481.65	all minerals	481.65
4S	3E	Uin	32	Lots 14,15,16	88.96	88.96	all minerals	88.96
4S	3E	Uin	32	Lot 17,NW1/4SW1/4 west of river	22.08	22.08	all minerals	22.08
4S	3E	Uin	32	UINTAH GREEN RIVER	47.13	47.13	all minerals	47.13
4S	3E	Uin	33	Lots 1,2,3,4,5,6,SW1/4NW1/4,NW1/4SW1/4	0.00	0.00	HBP by third parties	254.22

Twp.	Range	County	Sec.	Legal Description:	UTM Gross Acres	UTM Net Acres	Use Tribal Mineral Ownership	UTS Gross Acres
55	3E	Ulin	33	Green River	0.00	0.00	HBP by third parties	114.00
55	1E	Ulin	1	Lot 1,2,3,4,5,6,7,SE1/4NE1/4	294.58	294.58	all minerals	294.58
55	1E	Ulin	2	Lot 1 (All)	18.53	18.53	oil, gas, oil shale and nitrogen only	18.53
55	2E	Ulin	1	Lots 2,5,6,7,9,10,NE1/4SW1/4	259.02	259.02	all minerals	259.02
55	2E	Ulin	1	Green River	61.20	61.20	all minerals	61.20
55	2E	Ulin	2	Lots 1,2,15,17,NW1/4NE1/4,N1/2NW1/4,SW1/4NW1/4	323.44	323.44	all minerals	323.44
55	2E	Ulin	2	Lots 19,20,21,22,23,24,25,26	53.66	53.66	all minerals	53.66
55	2E	Ulin	3	All	640.00	640.00	all minerals	640.00
55	2E	Ulin	4	Lots 1,2,3,4,5,EX1/4,NE1/4,N1/2NW1/4	450.20	450.20	all minerals	450.24
55	2E	Ulin	5	Lots 1,2,3,4,5,6,7,8,9,10,11,12,13,14,SW1/4NW1/4,W1/2SW1/4,SW1/4SE1/4	540.24	540.24	all minerals	540.24
55	2E	Ulin	6	Lots 1-10,SW1/4NE1/4,SE1/4NW1/4,NW1/4SW1/4,SE1/4	558.58	558.58	all minerals	558.58
55	2E	Ulin	7	All	96.42	96.42	all minerals	96.42
55	2E	Ulin	8	All	469.99	469.99	all minerals	469.99
55	2E	Ulin	9	All	640.00	640.00	all minerals	640.00
55	2E	Ulin	10	All	640.00	640.00	all minerals	640.00
55	2E	Ulin	11	Lots 3,4,5,10,11,13-16,	198.31	198.31	all minerals	198.31
55	2E	Ulin	11	Green River	95.66	95.66	oil, gas, oil shale and nitrogen only	0.00
55	2E	Ulin	12	All	85.66	85.66	all minerals	85.66
55	2E	Ulin	12	Green River	130.15	130.15	all minerals	130.15
55	2E	Ulin	14	Lots 1,2,3	131.95	131.95	all minerals	131.95
55	2E	Ulin	14	Lot 4	28.98	28.98	oil, gas, oil shale and nitrogen only	0.00
55	2E	Ulin	14	Green River	141.88	141.88	all minerals	141.88
55	2E	Ulin	15	All	588.10	588.10	all minerals	588.10
55	2E	Ulin	16	All	242.79	242.79	all minerals	242.79
55	2E	Ulin	23	All	15.78	15.78	oil, gas, oil shale and nitrogen only	0.00
55	2E	Ulin	23	Green River	34.19	34.19	all minerals	34.19
55	3E	Ulin	5	Lot 4	31.94	31.94	all minerals	31.94
55	3E	Ulin	5	Green River	53.79	53.79	all minerals	53.79
55	3E	Ulin	6	Lots 1,2,SW1/4NE1/4,SE1/4	320.40	320.40	all minerals	320.40
55	3E	Ulin	6	Green River	5.10	5.10	all minerals	5.10
55	3E	Ulin	7	Lots 5,9,10,11	145.94	145.94	all minerals	145.94
55	3E	Ulin	7	Green River	72.17	72.17	all minerals	72.17
55	3E	Ulin	8	Lots 2,3,4	96.30	96.30	all minerals	96.30
55	3E	Ulin	8	Green River	32.44	32.44	all minerals	32.44
Total UTM Acres - Block D					17,708.40	17,708.40	Total UTS Acres - Block D	13,594.52
UTE TRIBAL LANDS (ALLOTTED)								
55	3E	Ulin	5	Lots 1,2	57.10	57.10	all minerals	0.00
55	3E	Ulin	6	Lots 7,8	75.70	2.16	all minerals	0.00
55	3E	Ulin	7	Lots 2,3,6,7,8,12,13	223.98	6.40	all minerals	0.00

Twp.	Rng.	County	Sec.	Legal Description:	UTM Gross Acres	UTM Net Acres	Ute Tribal Mineral Ownership	UTS Gross Acres
4S	3E	Uln	31	Lots 6,7,11,12	160.00	160.00	all minerals	0.00
4S	3E	Uln	31	Lots 10,15,16,17	153.70	153.70	all minerals	0.00
Total UTM [Allotted] Acres - Block D					670.48	379.36	Total UTS [Allotted] Acres - Block D	0.00
Total All UTM Acres - Block D					18,378.88	18,087.76	Total All UTS Acres - Block D	13,594.52
TOTAL UTE TRIBAL LAND ACRES					47,345.25	46,898.21		28,358.45
Bonus Payment per Net Ute Tribal Mineral Acre =					\$22.50	\$1,055,209.73	= Total Bonus Payment:	





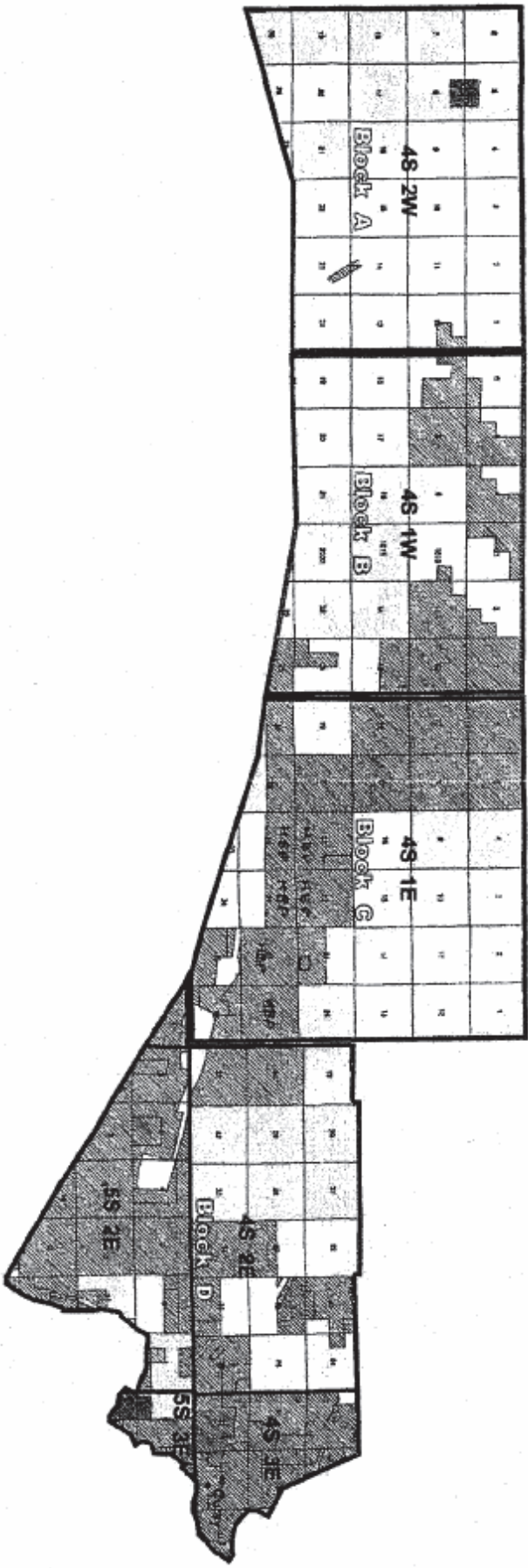

Exhibit A-2; CONTRACT LANDS to Exploration and Development Agreement between the Ute Indian Tribe, Newfield Production Company and the Ute Distribution Company







← Show HSP as in Block A-1 Ridge EOA map

Newfield Drilling Areas

-  Block A
-  Block B
-  Block C
-  Block D

Land Ownership

-  Tribal 100% Purchased from Allottee
-  Allotted-Tribal-Fee
-  Ute Tribal Minerals
-  Ute Tribal Surface

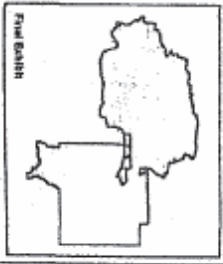

EXHIBIT C
to
Assignment and Assumption Agreement
dated effective March 5, 2010

EXHIBIT C

**UTE INDIAN TRIBE/UTE ENERGY/UDC/NEWFIELD
BRIDGELAND EXPLORATION AND DEVELOPMENT AGREEMENT**

UTE TRIBAL MINERALS ACREAGE DESCRIPTION

**Drilling Block G,
Duchesne County, Utah**

Township	Range	Section	Legal Description	Acres
4S	3W	1	Lot 4	41.30
4S	3W	2	Lots 7,8	80.79
4S	3W	3	Lots 4,5	81.90
4S	3W	4	Lots 1,2,3,4,7,8	245.49
4S	3W	5	Lots 1,2	80.94
4S	3W	10	SWSE	40.00
4S	3W	12	N/2SE, SESE	120.00
4S	3W	13	NENE, S/2NE, NW/4, S/2	600.00
4S	3W	14	NENE, S/2NE, NW/W, S/2NW, S/2	560.00
4S	3W	15	NENE,S/2NE,SESW, S/2	480.00
4S	3W	16	NE/4SE/4,S/2SE/4	120.00
4S	3W	20	E/2NE,NESE	120.00
4S	3W	21	All	640.00
4S	3W	22	All	640.00
4S	3W	23	All	640.00
4S	3W	25	N/2,NWSW,S/2SW, Lots 1,2,N/2SE	582.29
4S	3W	26	All	640.00
4S	3W	27	All	640.00
4S	3W	28	All	640.00
4S	3W	29	SENE,SESW,S/2SE, NESE	200.00
4S	3W	31	Lots1,2,3,4,5,7,E2NW, NESW, NESE, NWNE	481.01
4S	3W	32	NE/4,E/2NW,SWNW, N2S2, Lot 1, 2, 3, 4	582.40
4S	3W	35	NWNW,Lots 1-6	237.96
4S	3W	36	Lot 1	25.75
			Total For Township 4 South Range 3 West	8,519.83

**Drilling Block H,
Duchesne County, Utah
Township 4 South, Range 4 West, Salt Lake Meridian**

Township	Range	Section	Legal Description	Acres
4S	4W	1	S/2NW, SW/4	240
4S	4W	2	SENE, S/2NW, SW/4, NESE, S/2SE	400
4S	4W	3	Lots 2, 3, 4, S/2N/2, S/2	604.17
4S	4W	4	Lots 1,2,3, 4, S1/2N1/2, S1/2	644.72
4S	4W	5	S/2	320
4S	4W	6	S/2SE	80
4S	4W	10	N/2	320
4S	4W	19	Lots 1,2, 3, 4, NE/4, E/2 NW, E/2 SW/4, SE/4	637.66
4S	4W	20	All	640
4S	4W	21	N/2	320
4S	4W	22	N/2	320
4S	4W	25	S/2	320
4S	4W	30	Lots 1,2, NE/4,E/2 NW/4	319.63
4S	4W	32	All	640
4S	4W	33	All	640
Total For Township 4 South Range 4 West				6,446.18

ADDITIONAL LANDS SUBJECT TO PRIOR LEASE TERMINATION

Township	Range	Section	Legal Description	Acres
4S	3W	24	Lease # 4891, All	640.00
4S	3W	25	Lease # 4892, NE/4SW/4	40
4S	4W	9	Lease # 5351, S/2	320
Total for Lease # 4891, #4892 and #5351				1,000.00

Grand Total	15,966.01
--------------------	------------------

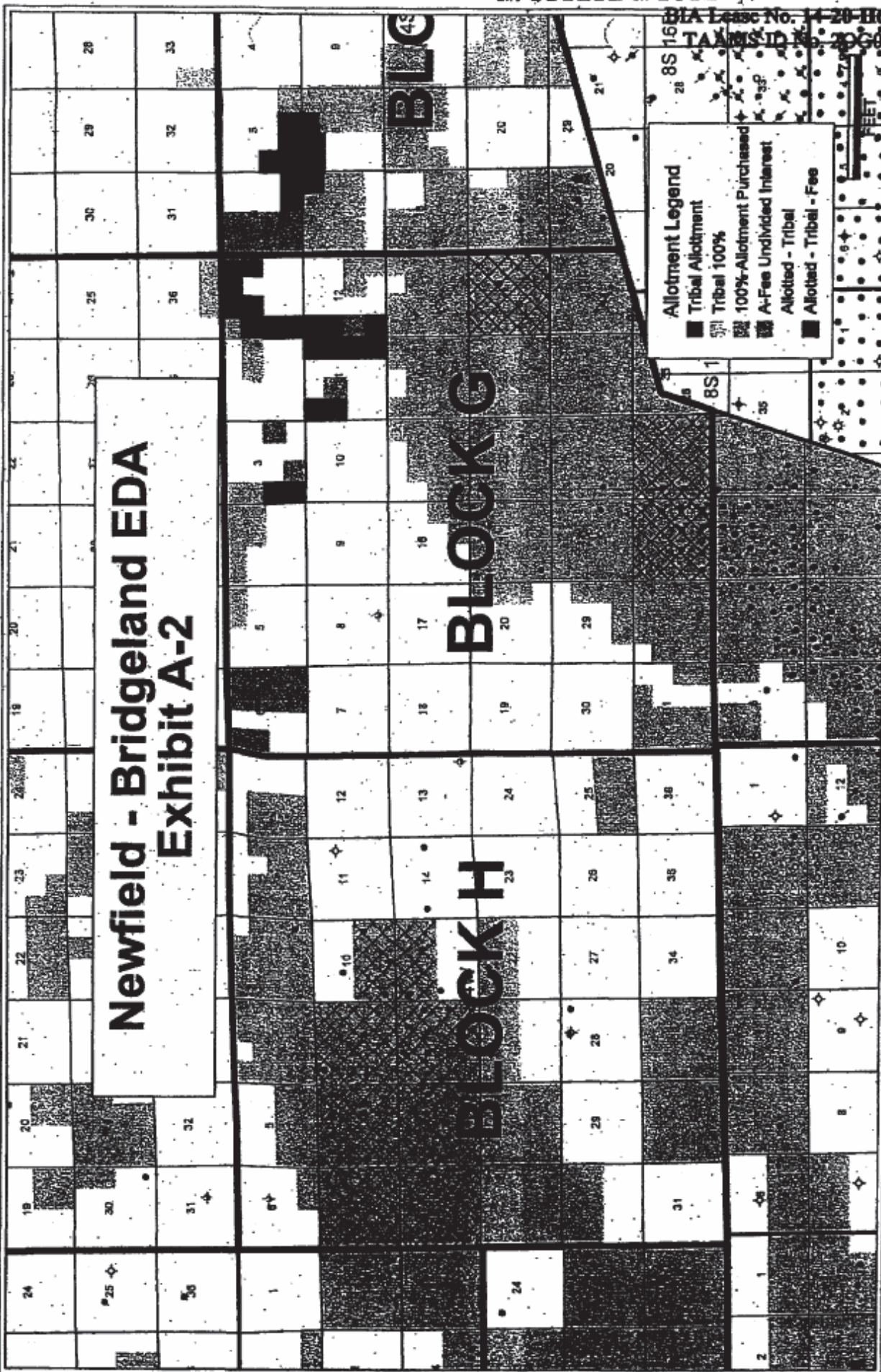

**Newfield - Bridgeland EDA
Exhibit A-2**

Allotment Legend

- ▀ Tribal Allotment
- ▨ Tribal 100%
- ▩ 100%-Allotment Purchased
- ▧ A-Fee Undivided Interest
- ▧ Allotted - Tribal
- ▧ Allotted - Tribal - Fee

EXHIBIT D
to
Assignment and Assumption Agreement
dated effective March 5, 2010

EXHIBIT D
LAKE CANYON PROPERTIES

Lake Canyon EDA

The Exploration and Development Agreement dated July 13, 2004 and amended and restated September 24, 2004 among Bill Barrett Corporation, Berry Petroleum Company and the Tribe, as the same may be amended, modified or supplemented in accordance with the terms of this Agreement.

Tribal Lands Covered by Lake Canyon EDA

See map for project outline.

County	Township	Range	Section	Lot and Description	Net Mineral Acres
Duchesne	3 S	7 W	30	Lot 3, 4, E $\frac{1}{2}$ S W $\frac{1}{4}$, S B $\frac{1}{4}$	310.23
Duchesne	3 S	7 W	31	Lot 1, 2, E $\frac{1}{2}$ N W $\frac{1}{4}$, N B $\frac{1}{4}$	310.93
Duchesne	3 S	7 W	31	Lot 3, 4, E $\frac{1}{2}$ S W $\frac{1}{4}$, S B $\frac{1}{4}$	311.75
Duchesne	3 S	8 W	25	N $\frac{1}{4}$	320.00
Duchesne	3 S	8 W	25	S $\frac{1}{4}$	320.00
Duchesne	3 S	8 W	26	N $\frac{1}{4}$	320.00
Duchesne	3 S	8 W	26	S $\frac{1}{4}$	320.00
Duchesne	3 S	8 W	27	S B $\frac{1}{2}$ N B $\frac{1}{4}$	40.00
Duchesne	3 S	8 W	27	W $\frac{1}{2}$ N B $\frac{1}{4}$, S $\frac{1}{2}$ N W $\frac{1}{4}$	160.00
Duchesne	3 S	8 W	27	S W $\frac{1}{4}$	160.00
Duchesne	3 S	8 W	27	W $\frac{1}{2}$ S B $\frac{1}{4}$	80.00
Duchesne	3 S	8 W	27	E $\frac{1}{2}$ S B $\frac{1}{4}$	80.00
Duchesne	3 S	8 W	28	N E $\frac{1}{2}$ N B $\frac{1}{4}$	40.00

Duchesse	3 S	8 W	28	S 1/4		320.00
Duchesse	3 S	8 W	29	S 1/2 N 1/4		80.00
Duchesse	3 S	8 W	29	W 1/2 S 1/4		80.00
Duchesse	3 S	8 W	29	E 1/2 S 1/4, W 1/2 S 1/4		160.00
Duchesse	3 S	8 W	29	E 1/2 S 1/4		80.00
Duchesse	3 S	8 W	30	S 1/2 N 1/4		80.00
Duchesse	3 S	8 W	30	Lot 1, 2, E 1/2 N 1/4		155.75
Duchesse	3 S	8 W	30	Lot 3, 4, E 1/2 S 1/4, S 1/4		316.05
Duchesse	3 S	8 W	31	Lot 1, 2, E 1/2 N 1/4, N 1/4		316.45
Duchesse	3 S	8 W	31	Lot 3, 4, E 1/2 S 1/4, S 1/4		316.95
Duchesse	3 S	8 W	32	N 1/4, N 1/2 N 1/4		240.00
Duchesse	3 S	8 W	32	S 1/4		160.00
Duchesse	3 S	8 W	33	N 1/4		320.00
Duchesse	3 S	8 W	33	S 1/4		320.00
Duchesse	3 S	8 W	34	N 1/2 N 1/4		40.00
Duchesse	3 S	8 W	34	N 1/2 N 1/4, N 1/2 N 1/4		80.00
Duchesse	3 S	8 W	34	W 1/2 N 1/4, S 1/2 N 1/4, S 1/2 N 1/4		160.00
Duchesse	3 S	8 W	34	S 1/2 N 1/4, N 1/2 S 1/4		80.00
Duchesse	3 S	8 W	34	S 1/4, W 1/4 S 1/4, S 1/4 S 1/4		280.00
Duchesse	3 S	8 W	35	N 1/4, E 1/2 S 1/4, S 1/4		560.00
Duchesse	3 S	8 W	35	W 1/4 S 1/4		80.00
Duchesse	3 S	8 W	36	N 1/4		320.00
Duchesse	3 S	8 W	36	S 1/4		320.00
Duchesse	3 S	9 W	13	E 1/2 S 1/4, W 1/2 S 1/4		160.00
Duchesse	3 S	9 W	14	W 1/2 E 1/4		160.00
Duchesse	3 S	9 W	15	E 1/4 W 1/4		160.00
Waerich	3 S	9 W	17	W 1/2 N 1/4		80.00

Wasatch	3 S	9 W	18	NE $\frac{1}{2}$ NE $\frac{1}{4}$	40.00
Wasatch	3 S	9 W	20	SE $\frac{1}{4}$ SE $\frac{1}{4}$	40.00
Wasatch	3 S	9 W	21	S $\frac{1}{2}$ S $\frac{1}{2}$ W $\frac{1}{4}$,S $\frac{1}{2}$ W $\frac{1}{4}$ SE $\frac{1}{4}$	120.00
Duchesne	3 S	9 W	22	W $\frac{1}{2}$ NE $\frac{1}{4}$	80.00
Duchesne	3 S	9 W	23	NE $\frac{1}{4}$	160.00
Duchesne	3 S	9 W	23	SW $\frac{1}{4}$ SW $\frac{1}{4}$	40.00
Duchesne	3 S	9 W	23	S $\frac{1}{2}$ SE $\frac{1}{4}$,SE $\frac{1}{2}$ SW $\frac{1}{4}$	120.00
Duchesne	3 S	9 W	24	S $\frac{1}{2}$ S $\frac{1}{2}$ W $\frac{1}{4}$,S $\frac{1}{2}$ W $\frac{1}{4}$ SE $\frac{1}{4}$	120.00
Duchesne	3 S	9 W	26	N $\frac{1}{2}$ NW $\frac{1}{4}$	80.00
Duchesne	3 S	9 W	26	N $\frac{1}{2}$ S $\frac{1}{2}$	160.00
Duchesne	3 S	9 W	27	N $\frac{1}{2}$ NE $\frac{1}{4}$	80.00
Duchesne	3 S	9 W	27	SW $\frac{1}{4}$ NW $\frac{1}{4}$,NW $\frac{1}{4}$ SW $\frac{1}{4}$	80.00
Duchesne	3 S	9 W	27	NE $\frac{1}{4}$ S $\frac{1}{2}$ W $\frac{1}{4}$,N $\frac{1}{2}$ SE $\frac{1}{4}$	120.00
Wasatch	3 S	9 W	29	N $\frac{1}{2}$ NE $\frac{1}{4}$,NE $\frac{1}{4}$ NW $\frac{1}{4}$,S $\frac{1}{2}$ NW $\frac{1}{4}$	200.00
Wasatch	3 S	9 W	30	S $\frac{1}{2}$ NE $\frac{1}{4}$,SE $\frac{1}{2}$ NW $\frac{1}{4}$	120.00
Duchesne	4 S	5 W	19	Lot 1,2,3,4,B/2W/2,B/2	640.32
Duchesne	4 S	5 W	20	All	640.00
Duchesne	4 S	5 W	21	N $\frac{1}{2}$ NE $\frac{1}{4}$,SW $\frac{1}{4}$ NE $\frac{1}{4}$,W/2,SE $\frac{1}{4}$ SE $\frac{1}{4}$	480.00
Duchesne	4 S	5 W	21	SE $\frac{1}{4}$ NE $\frac{1}{4}$,N $\frac{1}{2}$ SE $\frac{1}{4}$,SW $\frac{1}{4}$ SE $\frac{1}{4}$	160.00
Duchesne	4 S	5 W	22	E/2,S/2NW $\frac{1}{4}$,SW $\frac{1}{4}$	560.00
Duchesne	4 S	5 W	22	N $\frac{1}{2}$ NW $\frac{1}{4}$	80.00
Duchesne	4 S	5 W	23	All	640.00
Duchesne	4 S	5 W	24	S/2	320.00
Duchesne	4 S	5 W	24	N/2	320.00
Duchesne	4 S	5 W	25	All	640.00
Duchesne	4 S	5 W	26	All	640.00

Duchesne	4 S	5 W	27	All		640.00
Duchesne	4 S	5 W	28	B/2,SE/4NW/4,SW/4		520.00
Duchesne	4 S	5 W	29	N/2,NE/4,NW/4,NW/4SW/4, S/2SE/4		360.00
Duchesne	4 S	5 W	29	SW/4NE/4		40.00
Duchesne	4 S	5 W	30	Lot 1,2,3,4,B/2W/2,B/2		642.72
Duchesne	4 S	5 W	31	Lot 1,2,3,4,B/2NW/4, NW/4NE/4, S/2SE/4, NE/4SE/4		405.25
Duchesne	4 S	5 W	31	B/2SW/4		80.00
Duchesne	4 S	5 W	32	B/2,B/2NW/4,SW/4NW/4,SW/4		600.00
Duchesne	4 S	5 W	33	All		640.00
Duchesne	4 S	5 W	34	N/2		320.00
Duchesne	4 S	5 W	34	S/2		320.00
Duchesne	4 S	5 W	35	N/2		320.00
Duchesne	4 S	5 W	35	S/2		320.00
Duchesne	4 S	5 W	36	N/2		320.00
Duchesne	4 S	5 W	36	S/2		320.00
Duchesne	4 S	6 W	19	All		636.40
Duchesne	4 S	6 W	20	N/2		320.00
Duchesne	4 S	6 W	20	S/2		320.00
Duchesne	4 S	6 W	21	All		640.00
Duchesne	4 S	6 W	22	All		640.00
Duchesne	4 S	6 W	23	N/2		320.00
Duchesne	4 S	6 W	23	S/2		320.00
Duchesne	4 S	6 W	24	All		640.00
Duchesne	4 S	6 W	25	All		640.00
Duchesne	4 S	6 W	26	N/2		320.00
Duchesne	4 S	6 W	26	S/2		320.00

Duchesne	4S	6W	27	N $\frac{1}{2}$		320.00
Duchesne	4S	6W	27	S $\frac{1}{2}$		320.00
Duchesne	4S	6W	28	Lot 1, E $\frac{1}{2}$, NE $\frac{1}{4}$, NW $\frac{1}{4}$, SE $\frac{1}{4}$, SW $\frac{1}{4}$		437.90
Duchesne	4S	6W	28	Lot 2, 4, SW $\frac{1}{4}$, SW $\frac{1}{4}$		101.45
Duchesne	4S	6W	28	W $\frac{1}{2}$, NW $\frac{1}{4}$		80.00
Duchesne	4S	6W	29	E $\frac{1}{2}$, NE $\frac{1}{4}$		80.00
Duchesne	4S	6W	29	W $\frac{1}{2}$, E $\frac{1}{2}$, W $\frac{1}{2}$		480.00
Duchesne	4S	6W	29	E $\frac{1}{2}$, SE $\frac{1}{4}$		80.00
Duchesne	4S	6W	30	Lot 3, 4, E $\frac{1}{2}$, SW $\frac{1}{4}$, SE $\frac{1}{4}$, NE $\frac{1}{4}$, E $\frac{1}{2}$, NW		554.56
Duchesne	4S	6W	31	All		639.20
Duchesne	4S	6W	32	N $\frac{1}{2}$		320.00
Duchesne	4S	6W	33	N $\frac{1}{2}$		320.00
Duchesne	4S	6W	33	S $\frac{1}{2}$		320.00
Duchesne	4S	6W	34	N $\frac{1}{2}$		320.00
Duchesne	4S	6W	34	S $\frac{1}{2}$		320.00
Duchesne	4S	6W	35	N $\frac{1}{2}$		320.00
Duchesne	4S	6W	35	SW $\frac{1}{4}$		160.00
Duchesne	4S	6W	35	SE $\frac{1}{4}$		160.00
Duchesne	4S	6W	36	N $\frac{1}{2}$, N $\frac{1}{2}$, SW $\frac{1}{4}$, SE $\frac{1}{4}$, SW $\frac{1}{4}$, SE $\frac{1}{4}$		600.00
Duchesne	4S	6W	36	SW $\frac{1}{4}$, SW $\frac{1}{4}$		40.00
Duchesne	4S	7W	6	Lot 1-5, S $\frac{1}{2}$, NE $\frac{1}{4}$, SE $\frac{1}{4}$, NW $\frac{1}{4}$		312.50
Duchesne	4S	7W	6	Lot 6, 7, E $\frac{1}{2}$, SW $\frac{1}{4}$, SE $\frac{1}{4}$		313.18
Duchesne	4S	7W	7	Lot 1, 2, W $\frac{1}{2}$, NE $\frac{1}{4}$, E $\frac{1}{2}$, NW $\frac{1}{4}$, SE $\frac{1}{4}$, NE $\frac{1}{4}$		273.84
Duchesne	4S	7W	7	Lot 3, 4, E $\frac{1}{2}$, SW $\frac{1}{4}$, SE $\frac{1}{4}$		314.48
Duchesne	4S	7W	17	N $\frac{1}{2}$, N $\frac{1}{2}$, SW $\frac{1}{4}$, NE $\frac{1}{4}$, SE $\frac{1}{4}$, NW $\frac{1}{4}$		240.00
Duchesne	4S	7W	17	SE $\frac{1}{4}$, NE $\frac{1}{4}$, NE $\frac{1}{4}$, SE $\frac{1}{4}$		80.00
Duchesne	4S	7W	17	S $\frac{1}{2}$, S $\frac{1}{2}$		160.00

Duchesne	4S	7W	18	Lot 1,2,NE $\frac{1}{4}$,E $\frac{1}{2}$,NW $\frac{1}{4}$	315.14
Duchesne	4S	7W	18	Lot 3,NE $\frac{1}{4}$,SW $\frac{1}{4}$,SE $\frac{1}{4}$	237.82
Duchesne	4S	7W	19	Lot 1,2,NE $\frac{1}{4}$,E $\frac{1}{2}$,NW $\frac{1}{4}$	316.50
Duchesne	4S	7W	19	Lot 3,4,E $\frac{1}{2}$,SW $\frac{1}{4}$,SE $\frac{1}{4}$	317.18
Duchesne	4S	7W	20	N $\frac{1}{2}$	320.00
Duchesne	4S	7W	20	Lot 1,2,SW $\frac{1}{4}$,N $\frac{1}{2}$,SE $\frac{1}{4}$	299.45
Duchesne	4S	7W	21	N $\frac{1}{2}$,N $\frac{1}{2}$	160.00
Duchesne	4S	7W	21	NE $\frac{1}{4}$,SE $\frac{1}{4}$	40.00
Duchesne	4S	7W	22	E $\frac{1}{2}$	320.00
Duchesne	4S	7W	22	NW $\frac{1}{4}$	160.00
Duchesne	4S	7W	22	SW $\frac{1}{4}$	160.00
Duchesne	4S	7W	23	Lot 1,W $\frac{1}{2}$,NE $\frac{1}{4}$,SE $\frac{1}{4}$,NW $\frac{1}{4}$,W $\frac{1}{2}$,SE $\frac{1}{4}$	634.85
Duchesne	4S	7W	26	N $\frac{1}{2}$	320.00
Duchesne	4S	7W	27	Lot 1,2,SE $\frac{1}{4}$,NE $\frac{1}{4}$,NW $\frac{1}{4}$	299.35
Duchesne	4S	7W	27	S $\frac{1}{2}$	320.00
Duchesne	4S	7W	28	NE $\frac{1}{4}$	160.00
Duchesne	4S	7W	28	NW $\frac{1}{4}$,SE $\frac{1}{4}$	320.00
Duchesne	4S	7W	28	SW $\frac{1}{4}$	160.00
Duchesne	4S	7W	29	All	640.00
Duchesne	4S	7W	30	Lot 1,2,NE $\frac{1}{4}$,E $\frac{1}{2}$,NW $\frac{1}{4}$	317.84
Duchesne	4S	7W	31	All	638.80
Duchesne	4S	7W	32	N $\frac{1}{2}$	320.00
Duchesne	4S	7W	32	S $\frac{1}{2}$	320.00
Duchesne	4S	7W	35	S $\frac{1}{2}$	320.00
Duchesne	4S	7W	36	Lot 1,2,NE $\frac{1}{4}$,NE $\frac{1}{4}$,SE $\frac{1}{4}$,N $\frac{1}{2}$,NW $\frac{1}{4}$,NW $\frac{1}{4}$,NW $\frac{1}{4}$,S $\frac{1}{2}$	639.65
Duchesne	4S	8W	1	Lot 1,4,S $\frac{1}{2}$,N $\frac{1}{2}$	319.60

Duchesse	4S	8W	1	S½		320.00
Duchesse	4S	8W	2	Lot 1-4		159.20
Duchesse	4S	8W	2	S½NE¼,SE¼		240.00
Duchesse	4S	8W	2	W½SW¼		80.00
Duchesse	4S	8W	3	Lot 1-4,S½N½		319.96
Duchesse	4S	8W	3	S½		320.00
Duchesse	4S	8W	10	N½		320.00
Duchesse	4S	8W	10	S½		320.00
Duchesse	4S	8W	11	NE¼		160.00
Duchesse	4S	8W	11	W½NW¼		80.00
Duchesse	4S	8W	11	NW½SW¼,S½S½,NE¼SE¼		240.00
Duchesse	4S	8W	12	N½		320.00
Duchesse	4S	8W	12	S½		320.00
Duchesse	4S	8W	13	N½		320.00
Duchesse	4S	8W	13	N½S½,SE¼SE¼		200.00
Duchesse	4S	8W	14	N½		320.00
Duchesse	4S	8W	14	S½		320.00
Duchesse	4S	8W	15	All		640.00
Duchesse	4S	8W	16	All		640.00
Duchesse	4S	8W	17	All		640.00
Duchesse	4S	8W	18	All		637.48
Duchesse	4S	8W	19	Lot 1,2,NE¼,E½NW¼		318.94
Duchesse	4S	8W	19	Lot 3,4,E½SW¼,SE¼		319.38
Duchesse	4S	8W	20	N½		320.00
Duchesse	4S	8W	20	S½		320.00
Duchesse	4S	8W	21	N½		320.00
Duchesse	4S	8W	22	S½N½,S½		480.00

Duchenne	4S	8W	23	N½,N¼	160.00
Duchenne	4S	8W	23	S½,N¼,S¼	480.00
Duchenne	4S	8W	24	NE½,NB¼,S½,N¼	200.00
Duchenne	4S	8W	24	S¼	320.00
Duchenne	4S	8W	25	Lot 1-4,N¼,SW¼	602.85
Duchenne	4S	8W	26	All	640.00
Duchenne	4S	8W	27	N¼	320.00
Duchenne	4S	8W	27	S¼	320.00
Duchenne	4S	8W	28	N¼	320.00
Duchenne	4S	8W	29	N¼	320.00
Duchenne	4S	8W	29	S¼	320.00
Duchenne	4S	8W	30	Lot 1,2,NB¼,B½,NW¼	319.57
Duchenne	4S	8W	30	Lot 3,4,B½,SW¼,SB¼	319.51
Duchenne	4S	8W	31	Lot 1,2,NB¼,B½,NW¼	319.61
Duchenne	4S	8W	31	Lot 3,4,B½,SW¼,SB¼	319.87
Duchenne	4S	8W	32	N¼	320.00
Duchenne	4S	8W	32	S¼	320.00
Duchenne	4S	8W	33	N¼	320.00
Duchenne	4S	8W	33	S¼	320.00
Duchenne	4S	8W	34	N¼	320.00
Duchenne	4S	8W	34	S¼	320.00
Duchenne	4S	8W	35	All	640.00
Duchenne	4S	8W	36	N¼	320.00
Duchenne	4S	8W	36	S¼	320.00
Wasatch	4S	9W	7	Lot 3,NE½,SW¼	79.17
Wasatch	4S	9W	7	Lot 4,SE½,SW¼	79.19
Wasatch	4S	9W	9	N¼	320.00

Duchesne	4S	9W	9	S½		320.00
Duchesne	4S	9W	10	All		640.00
Duchesne	4S	9W	11	All		640.00
Duchesne	4S	9W	12	N½		320.00
Duchesne	4S	9W	12	S½		320.00
Duchesne	4S	9W	13	N½, N½S½, SE½, SB½		520.00
Duchesne	4S	9W	13	S½, SW¼, SW½, SE½		120.00
Duchesne	4S	9W	14	N½		320.00
Duchesne	4S	9W	14	S½		320.00
Duchesne	4S	9W	15	N½		320.00
Duchesne	4S	9W	15	N½, S½		160.00
Duchesne	4S	9W	15	S½, SW¼		80.00
Duchesne	4S	9W	15	SE½, SB½		40.00
Wasatch	4S	9W	16	N½		320.00
Wasatch	4S	9W	16	N½, SB½, NB½, SW¼		120.00
Wasatch	4S	9W	16	NW½, SW¼, S½, S½		200.00
Wasatch	4S	9W	17	N½		320.00
Wasatch	4S	9W	17	S½		320.00
Wasatch	4S	9W	18	Lot 1, 2, B½, NW¼, NB½		318.63
Wasatch	4S	9W	18	Lot 3, 4, E½, SW¼, SB½		319.09
Wasatch	4S	9W	19	Lot 1, 2, B½, NW¼, NB½		319.37
Wasatch	4S	9W	19	Lot 3, 4, B½, SW¼, SB½		319.47
Wasatch	4S	9W	20	N½		320.00
Wasatch	4S	9W	20	S½		320.00
Wasatch	4S	9W	21	N½		320.00
Duchesne	4S	9W	22	N½, NB½, SE½, NB½		120.00
Duchesne	4S	9W	22	NE½, SE½		40.00
Duchesne	4S	9W	23	N½		320.00

Duchesne	4 S	9 W	23	S½		320.00
Duchesne	4 S	9 W	24	N½		320.00
Duchesne	4 S	9 W	24	S½		320.00
Duchesne	5 S	5 W	6	All		
Duchesne	5 S	5 W	7	All		
Duchesne	5 S	5 W	18	All		
Duchesne	5 S	5 W	19	All		
Duchesne	5 S	5 W	30	All		
Duchesne	5 S	5 W	31	All		
Duchesne	5 S	6 W	1	Lot 2,3,4, SW¼, NW¼, NW¼, SW¼, SB¼		
Duchesne	5 S	6 W	2	Lot 1-4, S½N½		309.96
Duchesne	5 S	6 W	2	S½		320.00
Duchesne	5 S	6 W	3	Lot 1-4, S½N½		310.04
Duchesne	5 S	6 W	3	S½		320.00
Duchesne	5 S	6 W	4	Lot 1-4, S½N½		311.88
Duchesne	5 S	6 W	4	S½		320.00
Duchesne	5 S	6 W	5	Lot 1-4, S½N½		312.28
Duchesne	5 S	6 W	5	S½		320.00
Duchesne	5 S	6 W	7	NE¼		160.00
Duchesne	5 S	6 W	7	Lot 1,2, B½, NW¼		155.88
Duchesne	5 S	6 W	7	Lot 3,4, B½, SW¼, SB¼		315.80
Duchesne	5 S	6 W	8	All		640.00
Duchesne	5 S	6 W	9	N½		320.00
Duchesne	5 S	6 W	9	S½		320.00
Duchesne	5 S	6 W	10	N½		320.00
Duchesne	5 S	6 W	10	S½		320.00

Duchesne	5S	6W	11	W $\frac{1}{2}$ N $\frac{1}{2}$ NE $\frac{1}{4}$,NW $\frac{1}{4}$	240.00
Duchesne	5S	6W	11	N $\frac{1}{2}$ S $\frac{1}{2}$ W $\frac{1}{2}$,NW $\frac{1}{2}$ SE $\frac{1}{4}$,S $\frac{1}{2}$ S $\frac{1}{2}$ W $\frac{1}{2}$,SW $\frac{1}{2}$ SE $\frac{1}{4}$	240.00
Duchesne	5S	6W	11	SE $\frac{1}{4}$ SE $\frac{1}{4}$,NE $\frac{1}{4}$ SE $\frac{1}{4}$	80.00
Duchesne	5S	6W	12	S $\frac{1}{2}$,NE $\frac{1}{4}$,E $\frac{1}{2}$ NW $\frac{1}{4}$,SW $\frac{1}{2}$ NW $\frac{1}{4}$	
Duchesne	5S	6W	13	All	
Duchesne	5S	6W	14	E $\frac{1}{2}$ N $\frac{1}{2}$ NE $\frac{1}{4}$,E $\frac{1}{2}$ S $\frac{1}{2}$ W $\frac{1}{2}$,SE $\frac{1}{4}$,NE $\frac{1}{4}$ NW $\frac{1}{4}$, SW $\frac{1}{2}$ NW $\frac{1}{4}$,W $\frac{1}{2}$ S $\frac{1}{2}$ W $\frac{1}{2}$	480.00
Duchesne	5S	6W	15	NW $\frac{1}{4}$ N $\frac{1}{2}$ NE $\frac{1}{4}$,N $\frac{1}{2}$ NW $\frac{1}{4}$,SW $\frac{1}{2}$ NW $\frac{1}{4}$,E $\frac{1}{2}$ S $\frac{1}{2}$ W $\frac{1}{2}$, N $\frac{1}{2}$ SE $\frac{1}{4}$,SW $\frac{1}{2}$ SE $\frac{1}{4}$,SE $\frac{1}{4}$ NW $\frac{1}{4}$,E $\frac{1}{2}$ N $\frac{1}{2}$ NE $\frac{1}{4}$,S W $\frac{1}{2}$ N $\frac{1}{2}$ NE $\frac{1}{4}$	520.00
Duchesne	5S	6W	16	N $\frac{1}{2}$	320.00
Duchesne	5S	6W	16	SW $\frac{1}{2}$,N $\frac{1}{2}$ SE $\frac{1}{4}$	240.00
Duchesne	5S	6W	17	All	640.00
Duchesne	5S	6W	18	Lot 1,2,NE $\frac{1}{4}$,E $\frac{1}{2}$ NW $\frac{1}{4}$	315.72
Duchesne	5S	6W	18	Lot 3,4,E $\frac{1}{2}$ S $\frac{1}{2}$ W $\frac{1}{2}$,SE $\frac{1}{4}$	315.64
Duchesne	5S	6W	19	Lot 1-4,7,NE $\frac{1}{4}$,E $\frac{1}{2}$ NW $\frac{1}{4}$,NE $\frac{1}{4}$ SW $\frac{1}{4}$, NW $\frac{1}{2}$ SE $\frac{1}{4}$	470.77
Duchesne	5S	6W	20	Lot 1- 7,SE $\frac{1}{4}$ N $\frac{1}{2}$ NE $\frac{1}{4}$,N $\frac{1}{2}$ NW $\frac{1}{4}$,E $\frac{1}{2}$ SE $\frac{1}{4}$,NW $\frac{1}{2}$ SW $\frac{1}{4}$ & mining claims	440.00
Duchesne	5S	6W	21	All	640.00
Duchesne	5S	6W	22	NW $\frac{1}{2}$ N $\frac{1}{2}$ NE $\frac{1}{4}$,NW $\frac{1}{4}$,NW $\frac{1}{2}$ SW $\frac{1}{4}$	240.00
Duchesne	5S	6W	22	S $\frac{1}{2}$ N $\frac{1}{2}$ NE $\frac{1}{4}$	80.00
Duchesne	5S	6W	22	E $\frac{1}{2}$ SE $\frac{1}{4}$,SW $\frac{1}{2}$ SE $\frac{1}{4}$	120.00
Duchesne	5S	6W	23	All	640.00
Duchesne	5S	6W	24	All	
Duchesne	5S	6W	25	All	
Duchesne	5S	6W	26	N $\frac{1}{2}$	320.00
Duchesne	5S	6W	26	S $\frac{1}{2}$	320.00

Duchesne	SS	6W	27	NE $\frac{1}{4}$,E $\frac{1}{2}$ NW $\frac{1}{4}$,SW $\frac{1}{2}$ NW $\frac{1}{4}$	280.00
Duchesne	SS	6W	27	NW $\frac{1}{4}$ NW $\frac{1}{4}$	40.00
Duchesne	SS	6W	27	S $\frac{1}{2}$	320.00
Duchesne	SS	6W	28	N $\frac{1}{2}$ NB $\frac{1}{4}$,SW $\frac{1}{2}$ NB $\frac{1}{4}$,NW $\frac{1}{4}$	280.00
Duchesne	SS	6W	28	SW $\frac{1}{4}$	160.00
Duchesne	SS	6W	28	SE $\frac{1}{4}$ SE $\frac{1}{4}$	40.00
Duchesne	SS	6W	29	N $\frac{1}{2}$	320.00
Duchesne	SS	6W	29	S $\frac{1}{2}$	320.00
Duchesne	SS	6W	30	Lot 3-6,S $\frac{1}{2}$ NB $\frac{1}{4}$,SE $\frac{1}{2}$ NW $\frac{1}{4}$,E $\frac{1}{2}$ SW $\frac{1}{4}$,SE $\frac{1}{4}$	494.57
Duchesne	SS	6W	31	All	631.52
Duchesne	SS	6W	32	N $\frac{1}{2}$	320.00
Duchesne	SS	6W	32	S $\frac{1}{2}$	320.00
Duchesne	SS	6W	33	N $\frac{1}{2}$	320.00
Duchesne	SS	6W	33	S $\frac{1}{2}$	320.00
Duchesne	SS	6W	34	N $\frac{1}{2}$	320.00
Duchesne	SS	6W	34	S $\frac{1}{2}$	320.00
Duchesne	SS	6W	35	All	
Duchesne	SS	6W	36	N $\frac{1}{2}$	
Duchesne	SS	7W	1	All	634.32
Duchesne	SS	7W	2	All	637.60
Duchesne	SS	7W	3	All	638.80
Duchesne	SS	7W	4	Lot 1-4,S $\frac{1}{2}$ N $\frac{1}{2}$	318.40
Duchesne	SS	7W	4	S $\frac{1}{2}$	320.00
Duchesne	SS	7W	5	All	637.28
Duchesne	SS	7W	6	Lot 3-5,SE $\frac{1}{2}$ NW $\frac{1}{4}$	149.63
Duchesne	SS	7W	6	Lot 6,7,NB $\frac{1}{4}$ SW $\frac{1}{4}$	112.61
Duchesne	SS	7W	7	Lot 1,2,SE $\frac{1}{2}$ NW $\frac{1}{4}$	112.42

Duchesse	SS	7W	7	Lot 3,4,B $\frac{1}{2}$ SW $\frac{1}{4}$	152.30
Duchesse	SS	7W	8	All	640.00
Duchesse	SS	7W	9	N $\frac{1}{2}$	320.00
Duchesse	SS	7W	9	S $\frac{1}{2}$	320.00
Duchesse	SS	7W	10	All	640.00
Duchesse	SS	7W	11	N $\frac{1}{2}$,SW $\frac{1}{4}$,N $\frac{1}{2}$ SE $\frac{1}{4}$,SW $\frac{1}{2}$ SE $\frac{1}{4}$	600.00
Duchesse	SS	7W	13	All	640.00
Duchesse	SS	7W	14	B $\frac{1}{2}$ SW $\frac{1}{4}$,SE $\frac{1}{4}$	240.00
Duchesse	SS	7W	15	N $\frac{1}{2}$,SW $\frac{1}{4}$,N $\frac{1}{2}$ SE $\frac{1}{4}$,SW $\frac{1}{2}$ SE $\frac{1}{4}$	600.00
Duchesse	SS	7W	16	N $\frac{1}{2}$	320.00
Duchesse	SS	7W	16	S $\frac{1}{2}$	320.00
Duchesse	SS	7W	17	N $\frac{1}{2}$	320.00
Duchesse	SS	7W	17	S $\frac{1}{2}$	320.00
Duchesse	SS	7W	18	Lot 1,2,NE $\frac{1}{4}$,E $\frac{1}{2}$,NW $\frac{1}{4}$	312.29
Duchesse	SS	7W	19	Lot 1,2,NB $\frac{1}{4}$,E $\frac{1}{2}$,NW $\frac{1}{4}$	312.36
Duchesse	SS	7W	19	Lot 3,4,E $\frac{1}{2}$ SW $\frac{1}{4}$,SE $\frac{1}{4}$	312.20
Duchesse	SS	7W	20	N $\frac{1}{2}$	320.00
Duchesse	SS	7W	20	S $\frac{1}{2}$	320.00
Duchesse	SS	7W	21	N $\frac{1}{2}$,SW $\frac{1}{4}$,N $\frac{1}{2}$ SE $\frac{1}{4}$	560.00
Duchesse	SS	7W	22	N $\frac{1}{2}$,NW $\frac{1}{4}$,SW $\frac{1}{2}$,NW $\frac{1}{4}$	120.00
Duchesse	SS	7W	22	SE $\frac{1}{2}$,SW $\frac{1}{4}$,E $\frac{1}{2}$,SE $\frac{1}{4}$,SW $\frac{1}{2}$,SE $\frac{1}{4}$	160.00
Duchesse	SS	7W	22	NW $\frac{1}{2}$,SE $\frac{1}{4}$	40.00
Duchesse	SS	7W	23	All	640.00
Duchesse	SS	7W	24	N $\frac{1}{2}$	320.00
Duchesse	SS	7W	24	S $\frac{1}{2}$	320.00
Duchesse	SS	7W	25	N $\frac{1}{2}$,N $\frac{1}{2}$,SW $\frac{1}{2}$,NW $\frac{1}{4}$,SE $\frac{1}{2}$,SW $\frac{1}{4}$,SE $\frac{1}{4}$	400.00
Duchesse	SS	7W	26	N $\frac{1}{2}$,SW $\frac{1}{4}$,N $\frac{1}{2}$,SE $\frac{1}{4}$,SW $\frac{1}{2}$,SE $\frac{1}{4}$	600.00
Duchesse	SS	7W	27	N $\frac{1}{2}$	320.00

Duchesse	SS	7W	27	S%		320.00
Duchesse	SS	7W	28	NE/ANB/4		40.00
Duchesse	SS	7W	28	S%		320.00
Duchesse	SS	7W	29	Lot 1,4,B/ANB/4,N/4SW/4		222.55
Duchesse	SS	7W	29	Lot 2,3,W/4NW/4		156.80
Duchesse	SS	7W	30	Lot 1,2,NB/4,B/ANW/4		312.23
Duchesse	SS	7W	30	Lot 3,4,B/4SW/4,SB/4		312.45
Duchesse	SS	7W	31	Lot 1,2,W/4NE/4,B/ANW/4		232.61
Duchesse	SS	7W	31	Lot 3,4,B/4SW/4,NW/4SE/4		192.71
Duchesse	SS	7W	32	NB/4NE/4,S/4N/4,NB/4NW/4		240.00
Duchesse	SS	7W	35	S/4SW/4		80.00
Duchesse	SS	8W	1	All		631.60
Duchesse	SS	8W	2	Lot 1-4,S/4NW/4,W/4SW/4, B/4SE/4,SW/4SE/4		432.40
Duchesse	SS	8W	2	SE/4NE/4		40.00
Duchesse	SS	8W	3	Lot 1,SE/4NE/4		78.22
Duchesse	SS	8W	3	S/4		320.00
Duchesse	SS	8W	9	N/4		320.00
Duchesse	SS	8W	10	All		640.00
Duchesse	SS	8W	11	B/4,SE/4NW/4,B/4SW/4		440.00
Duchesse	SS	8W	11	SW/4SW/4		40.00
Duchesse	SS	8W	12	All		640.00
Duchesse	SS	8W	13	N/4		320.00
Duchesse	SS	8W	13	S/4		320.00
Duchesse	SS	8W	14	NB/4,B/4NW/4		240.00
Duchesse	SS	8W	14	W/4NW/4,NW/4SW/4		120.00
Duchesse	SS	8W	14	B/4SW/4,SW/4SW/4,SB/4		280.00
Duchesse	SS	8W	15	B/4NE/4		80.00

Duchesse	SS	8W	15	W $\frac{1}{2}$ B $\frac{1}{4}$, W $\frac{1}{2}$	480.00
Duchesse	SS	8W	15	NE $\frac{1}{4}$ SE $\frac{1}{4}$	40.00
Duchesse	SS	8W	15	SE $\frac{1}{4}$ SE $\frac{1}{4}$	40.00
Duchesse	SS	8W	16	All	640.00
Duchesse	SS	8W	19	Lot 1,2,NE $\frac{1}{4}$,E $\frac{1}{2}$ NW $\frac{1}{4}$	306.56
Duchesse	SS	8W	19	Lot 3,4,E $\frac{1}{2}$ SW $\frac{1}{4}$,SE $\frac{1}{4}$	306.08
Duchesse	SS	8W	20	All	640.00
Duchesse	SS	8W	21	All	640.00
Duchesse	SS	8W	22	N $\frac{1}{2}$ NE $\frac{1}{4}$,SW $\frac{1}{4}$ NE $\frac{1}{4}$	120.00
Duchesse	SS	8W	22	NW $\frac{1}{4}$,W $\frac{1}{2}$ SW $\frac{1}{4}$,E $\frac{1}{2}$ SE $\frac{1}{4}$,SW $\frac{1}{4}$ SE $\frac{1}{4}$	360.00
Duchesse	SS	8W	22	SE $\frac{1}{4}$ NE $\frac{1}{4}$	40.00
Duchesse	SS	8W	23	All	640.00
Duchesse	SS	8W	24	N $\frac{1}{2}$	320.00
Duchesse	SS	8W	24	S $\frac{1}{4}$	320.00
Duchesse	SS	8W	25	N $\frac{1}{2}$	320.00
Duchesse	SS	8W	25	S $\frac{1}{4}$	320.00
Duchesse	SS	8W	26	All	640.00
Duchesse	SS	8W	27	E $\frac{1}{2}$,E $\frac{1}{2}$ SW $\frac{1}{4}$,SW $\frac{1}{4}$ SW $\frac{1}{4}$	440.00
Duchesse	SS	8W	27	NW $\frac{1}{4}$ NW $\frac{1}{4}$	40.00
Duchesse	SS	8W	28	N $\frac{1}{2}$ NE $\frac{1}{4}$,NW $\frac{1}{4}$	240.00
Duchesse	SS	8W	28	NW $\frac{1}{4}$ SW $\frac{1}{4}$	40.00
Duchesse	SS	8W	28	S $\frac{1}{4}$ SE $\frac{1}{4}$	80.00
Duchesse	SS	8W	29	N $\frac{1}{2}$	320.00
Duchesse	SS	8W	29	S $\frac{1}{4}$	320.00
Duchesse	SS	8W	30	Lot 1,2,NE $\frac{1}{4}$,E $\frac{1}{2}$ NW $\frac{1}{4}$	305.63
Duchesse	SS	8W	30	Lot 3,4,E $\frac{1}{2}$ SW $\frac{1}{4}$,SE $\frac{1}{4}$	305.21
Duchesse	SS	8W	31	Lot 1,2,NE $\frac{1}{4}$,E $\frac{1}{2}$ NW $\frac{1}{4}$	305.45
Duchesse	SS	8W	31	Lot 3,4,E $\frac{1}{2}$ SW $\frac{1}{4}$,SE $\frac{1}{4}$	306.35

Duchesse	5S	8W	32	NW $\frac{1}{2}$ NB $\frac{1}{4}$ NW $\frac{1}{4}$ W $\frac{1}{2}$ SW $\frac{1}{4}$ E $\frac{1}{2}$ SB $\frac{1}{4}$	360.00
Duchesse	5S	8W	33	E $\frac{1}{2}$ E $\frac{1}{2}$ NW $\frac{1}{4}$ SW $\frac{1}{4}$ NW $\frac{1}{4}$ SW $\frac{1}{4}$	600.00
Duchesse	5S	8W	34	All	640.00
Duchesse	5S	8W	35	N $\frac{1}{2}$	320.00
Duchesse	5S	8W	35	S $\frac{1}{2}$	320.00
Duchesse	5S	8W	36	N $\frac{1}{2}$	320.00
Duchesse	5S	8W	36	S $\frac{1}{2}$	320.00
Duchesse	5S	9W	25	All	640.00
Duchesse	5S	9W	26	N/2	320.00
Duchesse	5S	9W	27	N/2	320.00
Wasatch	5S	9W	33	N/2NB/4	80.00
Duchesse	5S	9W	34	SE $\frac{1}{4}$ NB $\frac{1}{4}$ SE/2NW $\frac{1}{4}$	120.00
Duchesse	5S	9W	34	W/2NW $\frac{1}{4}$	80.00
Duchesse	5S	9W	35	SW/4NW/4	40.00
Duchesse	5S	9W	36	N/2	320.00
Duchesse	5S	9W	36	S/2	320.00
Duchesse	6S	8W	5	Lot 1,2,S $\frac{1}{2}$ NB	161.11
Duchesse	6S	8W	5	E $\frac{1}{2}$ SW $\frac{1}{4}$ SE $\frac{1}{4}$	240.00
Duchesse	6S	8W	6	Lot 4	33.31
Duchesse	6S	8W	6	Lot 6,7,E $\frac{1}{2}$ SW $\frac{1}{4}$ SB $\frac{1}{4}$	305.36
Duchesse	6S	8W	7	Lot 1,2,NB $\frac{1}{4}$ E $\frac{1}{2}$ NW $\frac{1}{4}$	304.74
Duchesse	6S	8W	7	Lot 3,4,E $\frac{1}{2}$ SW $\frac{1}{4}$ SB $\frac{1}{4}$	304.46
Duchesse	6S	8W	8	NB $\frac{1}{4}$ N $\frac{1}{2}$ NW $\frac{1}{4}$	240.00
Duchesse	6S	8W	8	S $\frac{1}{2}$ NW $\frac{1}{4}$	80.00
Duchesse	6S	8W	8	W $\frac{1}{2}$ SW $\frac{1}{4}$	80.00
Duchesse	6S	8W	8	E $\frac{1}{2}$ SW $\frac{1}{4}$ SB $\frac{1}{4}$	240.00

Duchesne	6 S	8 W	17	NE $\frac{1}{4}$, NE $\frac{1}{4}$, NW $\frac{1}{4}$	200.00
Duchesne	6 S	8 W	17	W $\frac{1}{2}$ NW $\frac{1}{4}$, SE $\frac{1}{4}$ NW $\frac{1}{4}$, NE $\frac{1}{4}$ SW $\frac{1}{4}$	160.00
Duchesne	6 S	8 W	18	Lot 1, 2, NE $\frac{1}{4}$, E $\frac{1}{2}$ NW $\frac{1}{4}$	304.25
Duchesne	6 S	8 W	18	Lot 3, 4, E $\frac{1}{2}$ SW $\frac{1}{4}$, SE $\frac{1}{4}$	304.08
Duchesne	6 S	9 W	1	Lot 1, 2, 3, 4, S $\frac{1}{2}$ NW $\frac{1}{4}$, SW $\frac{1}{4}$ NE $\frac{1}{4}$	279.60
Duchesne	6 S	9 W	1	N $\frac{1}{2}$ SW $\frac{1}{4}$, NW $\frac{1}{4}$ SE $\frac{1}{4}$	120.00
Duchesne	6 S	9 W	2	Lot 1, 2, 3, 4, S $\frac{1}{2}$ NE $\frac{1}{4}$	320.09
Duchesne	6 S	9 W	2	SW $\frac{1}{4}$, W $\frac{1}{2}$ SE $\frac{1}{4}$, SE $\frac{1}{4}$ SE $\frac{1}{4}$	280.00
Duchesne	6 S	9 W	2	NE $\frac{1}{4}$ SE $\frac{1}{4}$	40.00
Tribal Net Mineral Acres =					124,555.50

Surface Use and Access Agreements

None

Water Permits

None

Business Leases of Facilities

None

Gas Sales or Transportation Contracts

None

Wells

None

Pipelines and Facilities

None

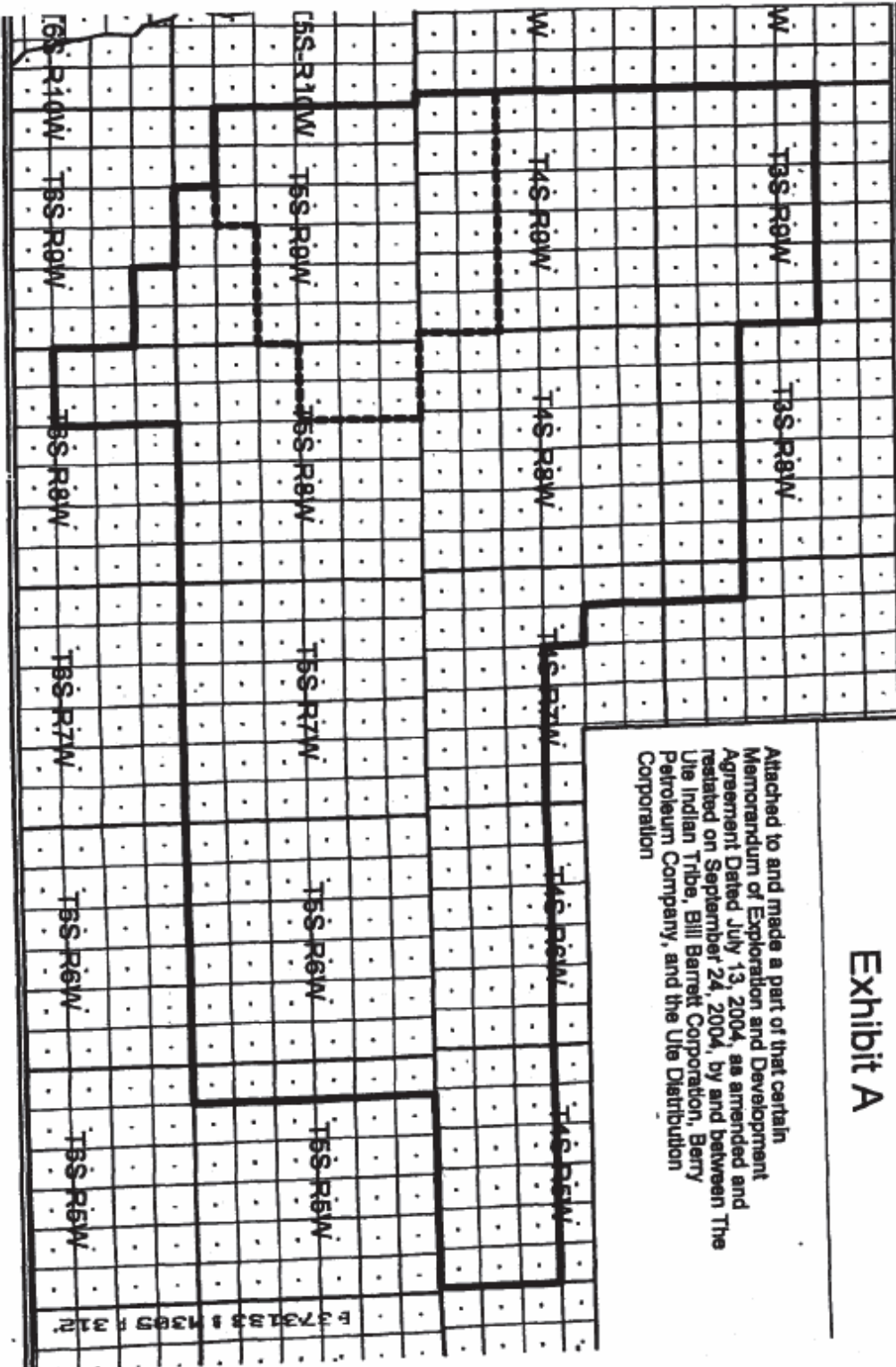

Attached to and made a part of that certain
 Memorandum of Exploration and Development
 Agreement Dated July 13, 2004, as amended and
 restated on September 24, 2004, by and between The
 Ute Indian Tribe, Bill Barrett Corporation, Berry
 Petroleum Company, and the Ute Distribution
 Corporation

Exhibit A

EXHIBIT E
to
Assignment and Assumption Agreement
dated effective March 5, 2010

EXHIBIT E

UTE INDIAN TRIBE / QUESTAR / UDC
EXPLORATION AND DEVELOPMENT AGREEMENT
DATED MARCH , 2005

Uintah County, Utah

<u>Township 15 South, Range 19 East, Salt Lake Meridian</u>	<u>Acres</u>
Section 1: Lot 1, 4, 5, S/2NE/4, E/2SE/4, SW/4NW/4, SW/4	477.82
Section 11: All	640.00
Section 12: W/2, SE/4, E/2NE/4	560.00
Section 13: All	640.00
Section 14: All	640.00
Section 15: All	640.00
Section 20: All	640.00
Section 21: All	640.00
Section 22: All	640.00
Section 23: All	640.00
Section 24: All	640.00
Section 25: All	640.00
Section 26: All	640.00
Section 27: All	640.00
Section 28: All	640.00
Section 29: All	640.00
Section 31: Lot 1, 2, 3, 4, E/2W/2, E/2	639.36
Section 33: All	640.00
Section 34: All	640.00
Section 35: All	640.00

Containing 12,557.18 acres, more or less

Section 1 Lands = 477.82 acres @ \$750.00/acre Bonus Payment =	\$358,365.00
Option Lands = 12,079.36 acres @ \$100.00/acre Bonus Payment =	\$1,207,936.00
TOTAL BONUS PAYMENT =	\$1,566,301.00

EXHIBIT X-4A to the MASTER AGREEMENT
WOLF FLAT PROPERTIES

Wolf Flat EDA

"Wolf Flat EDA" means the Exploration and Development Agreement among the Ute Indian Tribe, Questar Exploration and Production Company and the Ute Distribution Corporation dated March 31, 2005, covering the Oil and Gas Properties owned by the Tribe known as "Wolf Flat", as the same may be amended, modified or supplemented in accordance with the terms of this Agreement.

Tribal Lands Covered by Wolf Flat EDA

T15S-R19E: Sections 1, 11-15, 20-29, 31, 33-35, less and except non-Tribal lands in Sections 1, 12, 13, 24 and 25 (see map) as follows: Sec. 1: E/2 NW/4, W/2 SE/4; Sec. 12: W/2 E/2, E/2 SW/4; Sec. 13: W/2 E/2, E/2 SE/4; Sec. 24: W/2 E/2; Sec. 25: NW/4 NE/4, SE/4 NE/4, E/2 SE/4.

Oil and Gas Leases - None

Surface Use and Access Agreements - None

Water Permits - None

Business Leases of Facilities - None

Gas Sales or Transportation Contracts - None

Wells - None

Pipelines and Facilities - None

Attached to a part of that certain Exploration and Development Agreement dated March 31, 2005, by and between The Ute Indian Tribe, Questar Exploration and Production Company and the Ute Distribution Corporation.

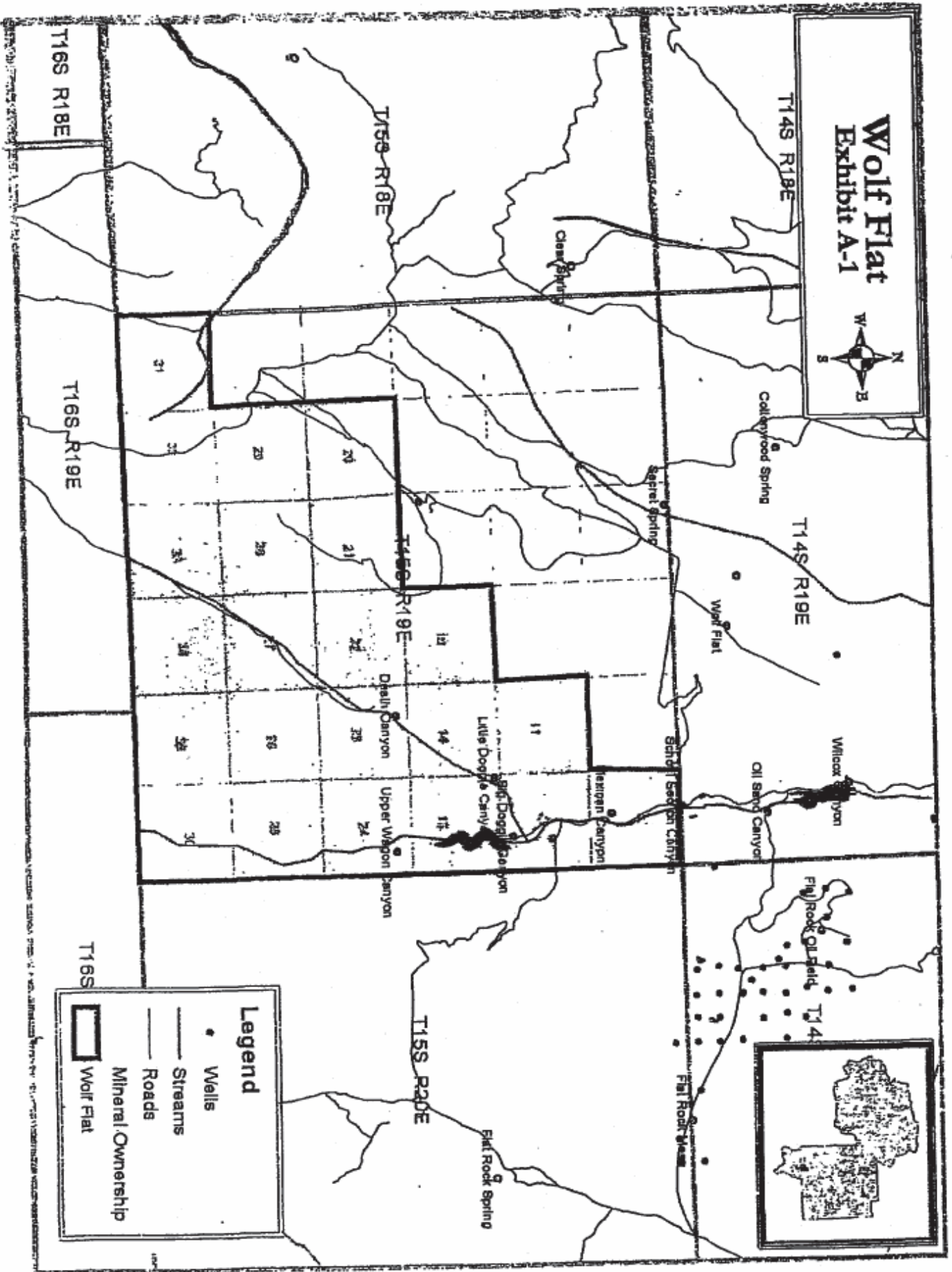

EXHIBIT F
to
Assignment and Assumption Agreement
dated effective March 5, 2010

EXHIBIT F

Attached to and made a part of that certain Joint Operating Agreement dated September 15, 2006 by and between Questar Exploration and Production Company and Ute Energy, LLC.

- I. **Lands Subject to this Agreement:**
Township 14 South, Range 19 East, SLM
Section 36: Lots 1, 2, 3 (less 1.07 acres in E/2), 4-6, N/2NW, SWNW, W/2SW (W/2)

Containing 320.00 acres, more or less
Uintah County, Utah
- II. **Restrictions as to Depths or Formations:** None
- III. **Names, Addresses and Working Interest Percentages of the Parties, and Oil & Gas Leases subject to this Agreement:**

Names, Addresses and Working Interest Percentages of the Parties:

Questar Exploration and Production Company
1050 17th Street, Suite 500
Denver, Colorado 80265
Working Interest = 90.000000%

Ute Energy, LLC
900 South 7074 East
Pt. Duchesne, Utah 84026
Working Interest = 10.000000%

Leases:

- 1) **Wilmae Shavanaux Fee Lease**

T14S, R19E, SLM, Uintah County, Utah
Sec. 36: Lot 3 (45.51)
Lessor: Wilmae Shavanaux
Lessee: Questar Exploration and Production Company

Total Acres in W/2: 44.44 acres
Effective Date: August 21, 2006

Lease Burdens: 1/6 Base Royalty Interest
- 2) **Christina Shavanaux Bedolla Fee Lease**

T14S, R19E, SLM, Uintah County, Utah
Sec. 36: Lot 3 (45.51)
Lessor: Christina Shavanaux Bedolla
Lessee: Turner Petroleum Land Services, Inc.

Total Acres in W/2: 44.44 acres
Effective Date: May 23, 2006

Lease Burdens: 1/6 Base Royalty Interest
- 3) **Steven A. Malnar and Bennie Lynn Malnar Fee Lease**

T14S, R19E, SLM, Uintah County, Utah
Sec. 36: Lot 3 (45.51)
Lessor: Steven A. Malnar & Bennie Lynn Malnar
Lessee: Turner Petroleum Land Services, Inc.

Total Acres in W/2: 44.44 acres
Effective Date: April 12, 2005

Lease Burdens: 1/6 Base Royalty Interest

4) Heirs of 569 UNC. - Towave Fee Lease

T14S, R19E, SLM, Uintah County, Utah
Sec. 36: Lot 3 (45.51)
Lessor: Heirs of 569 UNC. - Towave
Lessee: Ute Energy, LLC

Total Acres in W/2: 44.44 acres
Effective Date: November 3, 2005

Lease Burdens: 20.5% Base Royalty Interest

5) Utah SITLA Mineral Lease - ML-49279

T14S, R19E, SLM, Uintah County, Utah
Sec. 36: Lots 1, 2, 4, 5, 6, NE/4, N/2NW/4, SW/4NW/4, W/2SW/4, E/2SE/4, NW/4SE/4
Lessor: State of Utah
Lessee: Questar Exploration and Production Company

Total Acres in W/2: 275.56 acres
Effective Date: February 6, 2004

Lease Burdens: 1/6 Base Royalty Interest