

P.O. BOX 30960 Rm. 213-C
80 80 3rd E.
SLC UT 84125

R/W 73586

3451606

RIGHT-OF-WAY EASEMENT

700
REC'D OF
MOUNTAIN BELLE
JUL 9 10 20 AM '80
KATIE L. DIXON
RECORDER
SALT LAKE COUNTY,
UTAH
DEVIDA DONT

The Undersigned Grantors for and in consideration of TEN AND NO/100 DOLLARS (\$10.00) in hand paid by the Grantee, the receipt whereof is hereby acknowledged, hereby grants, bargains and conveys unto The Mountain States Telephone and Telegraph Company, a Colorado corporation, 931 14th Street, Denver, Colorado, 80202, Grantee, its successors, assigns, lessees, licensees and agents, a Right-of-Way Easement and the right to construct, operate, maintain and remove such communication and other facilities, from time to time, as said Grantee may require upon, over, under and across the following described land which the Grantors own or in which the Grantors have any interest, to-wit:

Commencing at the Northeast corner of Block 188, Plat "D", Salt Lake City Survey, and running thence South 89°51'43" East 130 feet; thence North 0°00'24" West 559.66 feet, more or less, to the Southerly line of Lot 11, North Hills Plat "A"; thence North 80° West 19.5 feet; thence Northwesterly around a 400 foot radius curve to the right a distance of 91 feet; thence North 89°59'10" West 923.98 feet; thence South 0°00'24" East 180 feet; thence South 48°30' West 260 feet; thence South 0°00'24" East 50 feet; thence South 89°51'43" East 50 feet; thence Southeasterly around a 75 foot radius curve to the right a distance of 117.62 feet; thence South 0°00'24" East 109 feet; thence South 89°51'43" East 224.53 feet; thence North 0°00'24" West 100 feet; thence South 89°51'43" East 745.64 feet; thence South 0°00'24" East 100 feet to the point of beginning, Being in the Southeast Quarter of Section 30, Township 1 North, Range 1 East, Salt Lake Meridian. (See Exhibit "A" attached.)

situate in County of Salt Lake, State of Utah,

TOGETHER with the right of ingress over and across the lands of the Grantors to and from the above-described property, the right to clear and keep cleared all trees and other obstructions as may be necessary and the right to permit other utility companies to use the right of way jointly with Grantee for their utility purposes.

The Grantors reserve the right to occupy, use, and cultivate said property for all purposes not inconsistent with the rights herein granted.

Signed and delivered this 19th day of June A.D., 1980.

Attest:

Arlene S. Kirton
Secretary

BLUE JAY, INCORPORATED

By Wilford W. Kirton, Jr.
President

Attest:

[Signature]
Secretary

DERRICK INVESTMENT CORPORATION

By [Signature]
President

STATE OF UTAH,)
) :ss.
COUNTY OF SALT LAKE)

On the 19th day of June, A.D. 1980 personally appeared before me WILFORD W. KIRTON, JR. and ARLENE S. KIRTON who being by me duly sworn did say, each for himself, that he, the said WILFORD W. KIRTON, JR. is the president, and she, the said ARLENE S. KIRTON is the secretary of BLUE JAY, INCORPORATED, and that the within and foregoing instrument was signed in behalf of said corporation by authority of a resolution of its board of directors and said WILFORD W. KIRTON, JR. and ARLENE S. KIRTON each duly acknowledged to me that said corporation executed the same and that the seal affixed is the seal of said corporation.

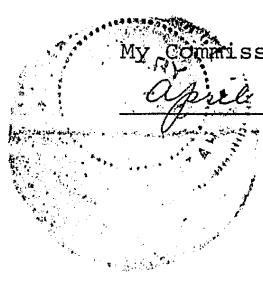

My Commission Expires:
April 15, 1981

Maughn W. Pace
Notary Public in and for the State of Utah residing at Salt Lake City, Utah.

STATE OF UTAH)
 :ss.
COUNTY OF SALT LAKE)

On the 19th day of June, A.D. 1980 personally appeared before me JAMES R. DERRICK and DAVID G. DERRICK who being by me duly sworn did say, each for himself, that he, the said JAMES R. DERRICK is the president, and he, the said DAVID G. DERRICK is the secretary of DERRICK INVESTMENT CORPORATION, and that the within and foregoing instrument was signed in behalf of said corporation by authority of a resolution of its board of directors and said JAMES R. DERRICK and DAVID G. DERRICK each duly acknowledged to me that said corporation executed the same and that the seal affixed is the seal of said corporation.

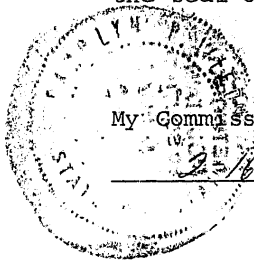

My Commission Expires:

3-16-81

Carolyn P. Weed
Notary Public in and for the
State of Utah residing at
Salt Lake City, Utah.

3

R/W
73586

North Point Estates

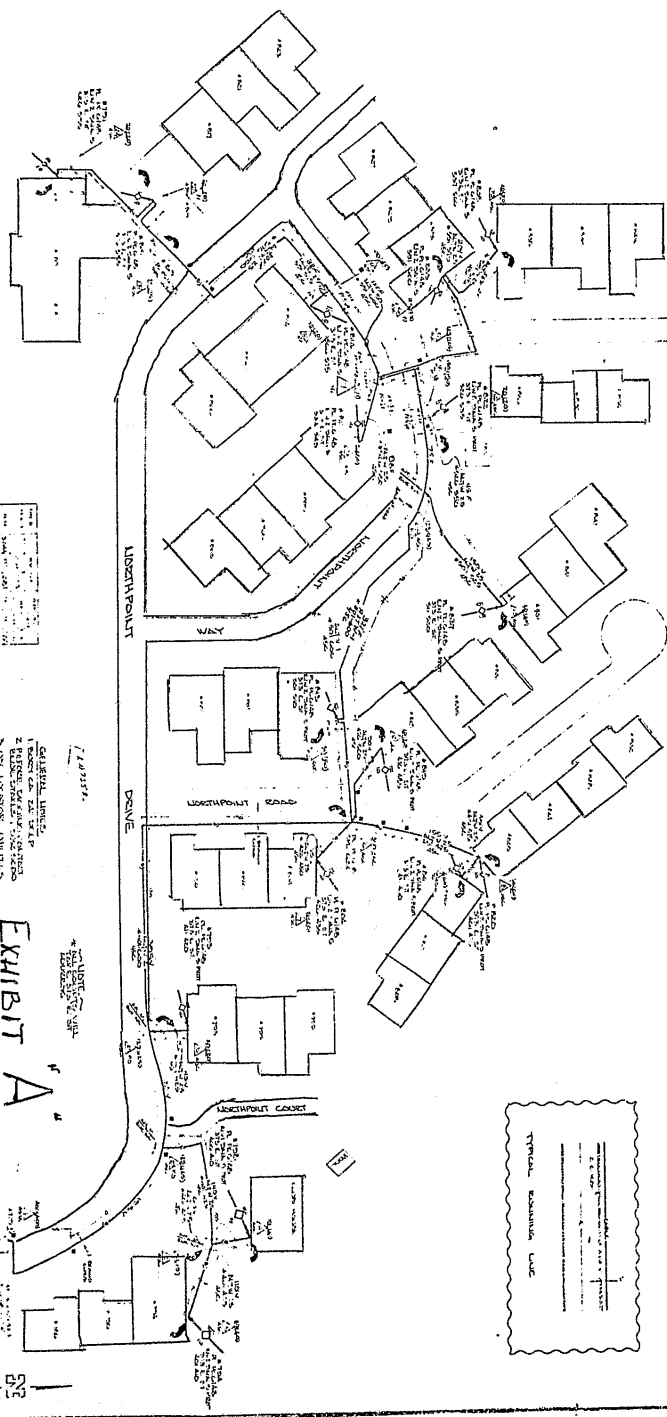

1	100' x 100'
2	100' x 100'
3	100' x 100'
4	100' x 100'
5	100' x 100'
6	100' x 100'
7	100' x 100'
8	100' x 100'
9	100' x 100'
10	100' x 100'
11	100' x 100'
12	100' x 100'
13	100' x 100'
14	100' x 100'
15	100' x 100'
16	100' x 100'
17	100' x 100'
18	100' x 100'
19	100' x 100'
20	100' x 100'
21	100' x 100'
22	100' x 100'
23	100' x 100'
24	100' x 100'
25	100' x 100'
26	100' x 100'
27	100' x 100'
28	100' x 100'
29	100' x 100'
30	100' x 100'
31	100' x 100'
32	100' x 100'
33	100' x 100'
34	100' x 100'
35	100' x 100'
36	100' x 100'
37	100' x 100'
38	100' x 100'
39	100' x 100'
40	100' x 100'
41	100' x 100'
42	100' x 100'
43	100' x 100'
44	100' x 100'
45	100' x 100'
46	100' x 100'
47	100' x 100'
48	100' x 100'
49	100' x 100'
50	100' x 100'
51	100' x 100'
52	100' x 100'
53	100' x 100'
54	100' x 100'
55	100' x 100'
56	100' x 100'
57	100' x 100'
58	100' x 100'
59	100' x 100'
60	100' x 100'
61	100' x 100'
62	100' x 100'
63	100' x 100'
64	100' x 100'
65	100' x 100'
66	100' x 100'
67	100' x 100'
68	100' x 100'
69	100' x 100'
70	100' x 100'
71	100' x 100'
72	100' x 100'
73	100' x 100'
74	100' x 100'
75	100' x 100'
76	100' x 100'
77	100' x 100'
78	100' x 100'
79	100' x 100'
80	100' x 100'
81	100' x 100'
82	100' x 100'
83	100' x 100'
84	100' x 100'
85	100' x 100'
86	100' x 100'
87	100' x 100'
88	100' x 100'
89	100' x 100'
90	100' x 100'
91	100' x 100'
92	100' x 100'
93	100' x 100'
94	100' x 100'
95	100' x 100'
96	100' x 100'
97	100' x 100'
98	100' x 100'
99	100' x 100'
100	100' x 100'

EXHIBIT A

GENERAL NOTES:
 1. REFER TO THE PLAN FOR THE LOCATION OF THE LOT.
 2. THE DISTANCE BETWEEN THE CENTER OF THE LOT AND THE CENTER OF THE ADJACENT LOT SHALL BE MAINTAINED.
 3. THE DISTANCE BETWEEN THE CENTER OF THE LOT AND THE CENTER OF THE ADJACENT LOT SHALL BE MAINTAINED.
 4. THE DISTANCE BETWEEN THE CENTER OF THE LOT AND THE CENTER OF THE ADJACENT LOT SHALL BE MAINTAINED.
 5. THE DISTANCE BETWEEN THE CENTER OF THE LOT AND THE CENTER OF THE ADJACENT LOT SHALL BE MAINTAINED.
 6. THE DISTANCE BETWEEN THE CENTER OF THE LOT AND THE CENTER OF THE ADJACENT LOT SHALL BE MAINTAINED.

DATE: 10/27/11

TYPICAL SIDEWALK CURB