

3240869

(BLACKJACK EXTENSION)

DEED OF EASEMENT

SNOWBIRD, LTD., a Limited Partnership of the State of Utah, GRANTOR, for valuable consideration, does hereby grant, bargain, sell and convey to SALT LAKE COUNTY SERVICE AREA NO. 3 - SNOWBIRD, a body corporate and politic of the State of Utah, GRANTEE, a perpetual, non-exclusive sanitary sewer line easement, including the right to enter and be upon Grantor's land for the purpose of constructing, installing, servicing, repairing, operating and maintaining a buried sewer outfall line. The easement granted hereby consists of a strip of land ten feet (10') in width, five feet (5') on each side of the centerline of said easement and the sewer outfall line, which centerline is described with particularity as follows:

An easement located in Salt Lake County Service Area No. 3 in unsurveyed land in Salt Lake County, Utah, which if surveyed would lie within Section 6, T. 3 S., R. 3 E., S.L.B. & M. as follows:

Beginning at the existing Sanitary Sewer Manhole No. 9, Engineering Station 17+82.2 of the aforesaid Service Area No. 3 Sewer Line, said point of beginning being 1338.20 ft. S. 24°28'12" W. from the Hellgate Mining Monument (State Plane Coordinate X=821,391.72, Y=1,958,457.82); thence N. 68°55' E. 72.50 ft.; thence N. 67°21' E. 178.22 ft.; thence N. 80°30' E. 150.61 ft.; thence N. 80°35' E. 219.02 ft. to a point in the center of a manhole on the easterly side of the Alta Bypass Road, said point being 1063.42 ft. S. 2°17'10" E. from said Hellgate Mining Monument.

Note: Basis for bearing is Utah Department of Transportation survey extending State Plane Coordinates into the Snowbird and Alta area in July, 1969. Distances given in description are ground distances using a combined adjustment factor of 1.0003526.

The above described easement is granted and conveyed only wherever and to the extent that it lies within boundaries of the Grantor's land located in Section 6, 3 South, Range 3 East, S.L.B. & M.

BOOK 4818 PAGE 648

REC'D  
FEB 21 10 16 AM '79  
SALT LAKE COUNTY, UTAH  
KATIE L. DIXON  
RECORDER  
SALT LAKE COUNTY,  
UTAH  
Myle J. S. Service  
Over # 3  
Snowbird, Utah  
84070

The Grantor reserves the right to cross over, under or along the easement granted hereby and to grant other easements to do the same, provided, however, that such other easements and the uses related thereto shall not in any way interfere with, hinder, defeat or prevent the Grantee's use and enjoyment of the easement granted hereby; and provided, further, the Grantor shall not build or erect any building or other structure upon, around or under said easement, or permit the same, without the written permission of the Grantee or its successors in interest.

IN WITNESS WHEREOF, the Grantor has caused this Deed of Easement to be duly executed by its authorized officer or partner this 13<sup>th</sup> day of December, 1978.

GRANTOR:

SNOWBIRD, LTD., a limited partnership of the State of Utah

By Richard D. Bass  
RICHARD D. BASS, General Partner

STATE OF Texas )  
County of Dallas ) ss.

On the 13th day of December, 1978, personally appeared before me RICHARD D. BASS, who duly acknowledged to me that he is a General Partner of Snowbird, Ltd., a limited partnership of the State of Utah, that he signed the within instrument for and in behalf of Snowbird, Ltd. by authority therefor and that Snowbird, Ltd. duly executed the same.

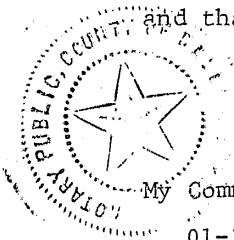

My Commission Expires:  
01-31-79

C. E. Phillips  
NOTARY PUBLIC  
Residing in Dallas, Dallas County,  
Texas

BOOK 4818  
PAGE 649

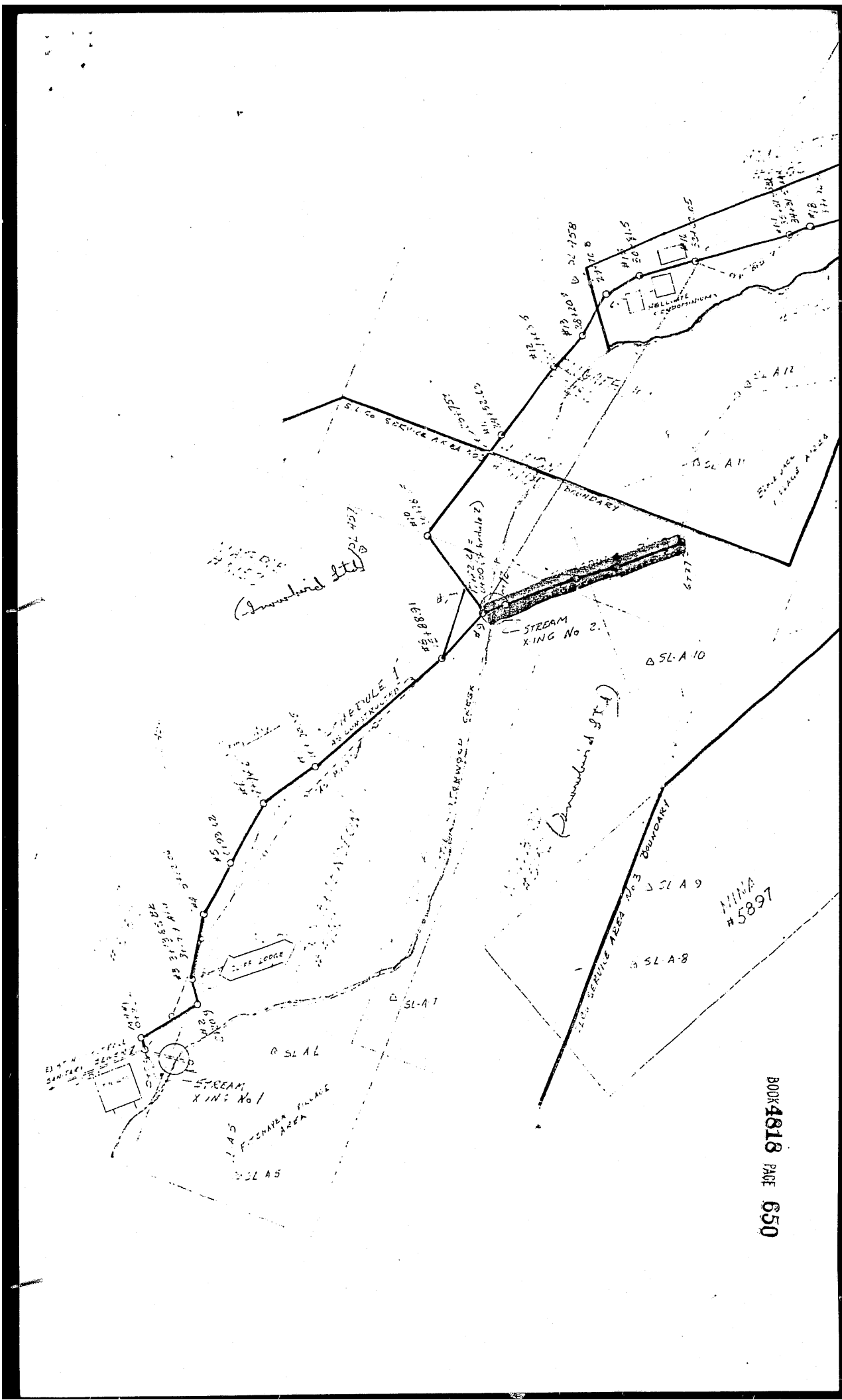

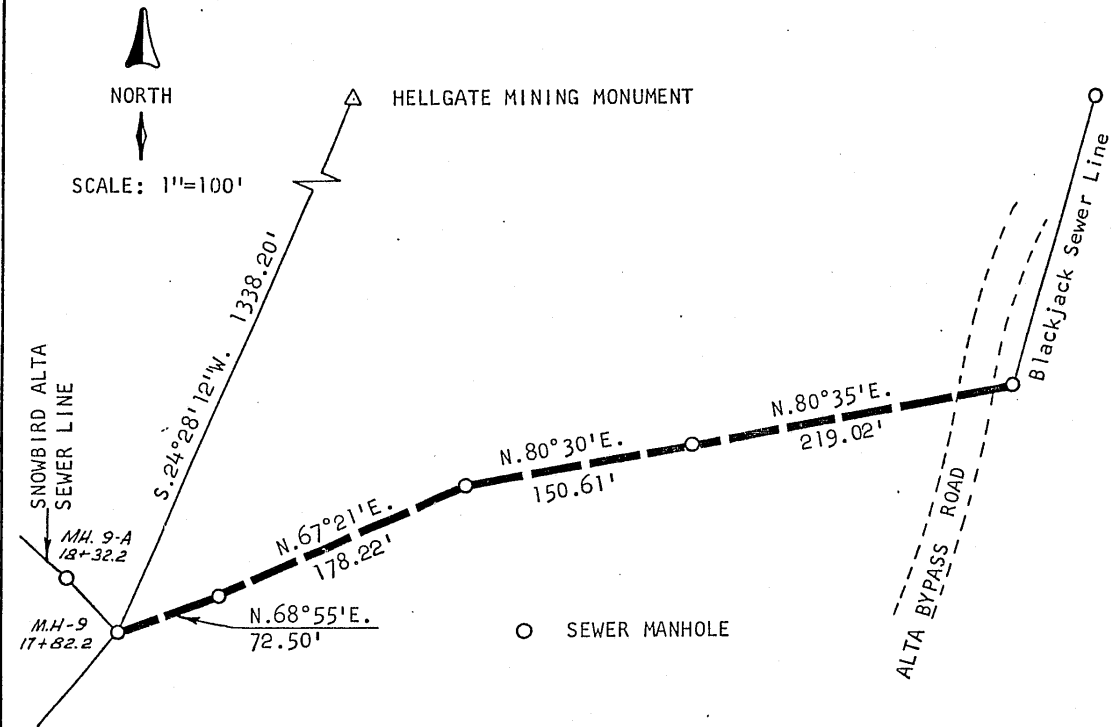

**SURVEYOR'S CERTIFICATE**

I, Joseph F. Vároz, of Salt Lake City, Utah, do hereby certify that I am a registered Land Surveyor and hold Certificate No. 3839 as prescribed by the laws of the State of Utah and have made survey of the following described easement.

An easement located in Salt Lake Service Area No. 3 in unsurveyed land in Salt Lake County, Utah, which if surveyed would lie within Section 6, T. 3 S., R. 3 E., S.L.B.& M. Said easement is a strip of land 10.0 ft. in width, 5.0 ft. on each side of the following described centerline:

Beginning at the existing Sanitary Sewer Manhole No. 9, Engineering Station 17+82.2 of the Snowbird-Alta Sewer Line, said point of beginning is 1338.20 ft. S.24°28'12"W. from the Hellgate Mining Monument (State Plane Coordinate X=821,391.72, Y=1,958,457.82); thence N. 68°55' E. 72.50 ft.; thence N. 67°21' E. 178.22 ft.; thence N. 80°30' E. 150.61 ft.; thence N. 80°35' E. 219.02 ft. to a point in the center of a manhole on the easterly side of the Alta Bypass Road, said point is 1063.42 ft. S. 2°17'10" E. from said Hellgate Mining Monument.

Note: Basis for bearing is Utah Department of Transportation survey extending State Plane Coordinates into the Snowbird and Alta area in July, 1969. Distances given in description are ground distances using a combined adjustment factor of 1.0003526.

I further certify that this plat correctly shows the true dimensions of the property surveyed.

Blackjack Sewer outfall line  
Salt Lake County Service Area No. 3  
Snowbird, Utah

*Joseph F. Vároz*  
Registered Land Surveyor

DATE: JANUARY 17, 1978

<b>VAROZ, LARSON &amp; ASSOCIATES</b>	
ENGINEERING - LAND SURVEYS	
SALT LAKE CITY, UTAH	
JOB NO. <u>78004</u>	PREPARED BY <u>J.F.V.</u>
DATE <u>1-17-78</u>	CHECKED BY <u>G.R.L.</u>

BOOK 4818 PAGE 651