



W2118735

RESOLUTION NO. 2005-9 A

A RESOLUTION OF THE OGDEN CITY COUNCIL PROVIDING FOR THE ADJUSTMENT OF THE CURRENT BOUNDARIES OF THE BONA VISTA WATER IMPROVEMENT DISTRICT WITHIN THE MUNICIPAL BOUNDARIES OF OGDEN CITY BY ELIMINATING CERTAIN OVERLAPPING AREAS FROM THE DISTRICT, WHICH AREAS ARE BEING SERVED BY OGDEN CITY.

WHEREAS, the Bona Vista Water Improvement District (hereinafter the "District") is a quasi-municipal corporation and improvement district duly organized and existing under the laws of the State of Utah;

WHEREAS, Ogden City (hereinafter the "City") is a Utah municipality that operates a water utility for properties located within its municipal boundaries;

WHEREAS, certain properties currently within the boundaries of the District are also within the municipal boundaries of the City, which properties do not receive services from the District and are served by the City, which properties are described in Exhibit A attached hereto and incorporated herein by reference (the "Property");

WHEREAS, the legislative body of the City and the board of trustees of the District have:

- A. Adopted resolutions indicating their intent to complete a boundary adjustment, and
- B. Held a public hearing after providing notice in accordance with State law;

WHEREAS, no written protest have been filed by the owners of private real property within the area proposed for adjustment.

NOW, THEREFORE, be it resolved by the City Council of Ogden City, Utah, that:

A. Property Disconnected and Excluded. The Council of Ogden City hereby approves the adjustment of the overlapping boundaries with the District, pursuant to Section 17B-2-602 and 17B-2-516, et.seq., Utah Code Annotated 1953. The Property described in the attached Exhibit A is hereby approved to be disconnected and excluded from the boundaries of Bona Vista Water Improvement District, such territory to continue within the corporate limits of Ogden City.

B. Resolution Recorded. The City Recorder is hereby directed to record in the Office of the Weber County Recorder a certified copy of this resolution and to otherwise comply with the requirements of Section 17B-2-517(6).

E# 2118735 PG1 OF7
DOUG CROFTS, WEBER COUNTY RECORDER
29-JUL-05 823 AM FEE \$1.00 DEP BB
REC FOR: OGDEN.CITY

C. Effective date. This resolution, and the boundary adjustment approved herein, shall become effective when the Board of Trustees of the District has adopted a resolution disconnecting and excluding the Property from the boundaries of the District.

PASSED AND ADOPTED by the Council of Ogden City this 28 day of

June 2005.



CHAIR

ATTEST:



Gloria Berrett, City Recorder

APPROVED AS TO FORM:



City Attorney



EXHIBIT A

All of the attached parcels identified by parcel identification number (APN) assigned by the Weber County Recorder's Office, together with all adjacent public streets located within the municipal boundaries of Ogden City, which parcels are also referenced by either the subdivision in which the parcel is located or by the ordinance effecting the annexation into Ogden City. A map depicting the affected area is also attached.

APN	ORD/SUB
08-002-0001	2000-31
08-002-0005	93-28
08-002-0032	93-28
08-005-0006	96-10
08-272-0001	96-10
08-272-0002	96-10
08-272-0003	96-10
08-272-0004	96-10
08-272-0005	96-10
08-272-0006	96-10
08-272-0007	96-10
08-272-0008	96-10
08-272-0009	96-10
08-272-0010	96-10
08-272-0011	96-10
08-272-0012	96-10
08-272-0013	96-10
08-272-0014	96-10
08-316-0001	96-10
08-316-0002	96-10
08-316-0003	96-10
08-340-0001	96-10
08-348-0001	99-32
08-348-0003	99-32
08-370-0001	96-10
08-382-0001	96-10
11-021-0060	29-72
11-022-0004	29-72
11-023-0022	29-72
11-023-0029	29-72
11-023-0039	29-72
11-023-0040	29-72
11-023-0041	29-72
11-023-0042	29-72
11-023-0044	29-72
11-023-0045	29-72
11-023-0046	29-72
11-023-0047	29-72
11-023-0049	29-72
11-023-0050	29-72
11-023-0051	29-72
11-023-0052	29-72
11-027-0051	94-39
11-226-0001	EAST OAKS
11-226-0002	EAST OAKS
11-226-0003	EAST OAKS
11-226-0004	EAST OAKS
11-226-0005	EAST OAKS
11-226-0006	EAST OAKS

11-226-0007	EAST OAKS
11-226-0008	EAST OAKS
11-226-0009	EAST OAKS
11-226-0010	EAST OAKS
11-226-0011	EAST OAKS
11-226-0012	EAST OAKS
11-226-0013	EAST OAKS
11-226-0014	EAST OAKS
11-226-0015	EAST OAKS
11-226-0016	EAST OAKS
11-226-0017	EAST OAKS
11-226-0018	EAST OAKS
11-226-0019	EAST OAKS
11-226-0020	EAST OAKS
11-226-0021	EAST OAKS
11-226-0022	EAST OAKS
11-226-0023	EAST OAKS
11-226-0024	EAST OAKS
11-226-0025	EAST OAKS
11-226-0026	EAST OAKS
11-226-0027	EAST OAKS
11-226-0028	EAST OAKS
11-226-0029	EAST OAKS
11-226-0030	EAST OAKS
11-226-0031	EAST OAKS
11-226-0032	EAST OAKS
11-226-0033	EAST OAKS
11-226-0034	EAST OAKS
11-226-0035	EAST OAKS
11-226-0036	EAST OAKS
11-226-0037	EAST OAKS
11-226-0038	EAST OAKS
11-226-0039	EAST OAKS
11-226-0040	EAST OAKS
11-226-0041	EAST OAKS
11-226-0042	EAST OAKS
11-226-0043	EAST OAKS
11-226-0044	EAST OAKS
11-226-0045	EAST OAKS
11-281-0001	MEADOW RIDGE #2
11-281-0002	MEADOW RIDGE #2
11-281-0003	MEADOW RIDGE #2
11-281-0004	MEADOW RIDGE #2
11-281-0005	MEADOW RIDGE #2
11-281-0006	MEADOW RIDGE #2
11-281-0007	MEADOW RIDGE #2
11-281-0008	MEADOW RIDGE #2
11-281-0009	MEADOW RIDGE #2
11-281-0010	MEADOW RIDGE #2
11-281-0011	MEADOW RIDGE #2

11-281-0012	MEADOW RIDGE #2
11-281-0013	MEADOW RIDGE #2
11-281-0014	MEADOW RIDGE #2
11-281-0015	MEADOW RIDGE #2
11-281-0016	MEADOW RIDGE #2
11-281-0017	MEADOW RIDGE #2
11-281-0018	MEADOW RIDGE #2
11-281-0019	MEADOW RIDGE #2
11-281-0020	MEADOW RIDGE #2
11-281-0021	MEADOW RIDGE #2
11-281-0022	MEADOW RIDGE #2
11-281-0023	MEADOW RIDGE #2
11-281-0024	MEADOW RIDGE #2
11-281-0025	MEADOW RIDGE #2
11-281-0026	MEADOW RIDGE #2
11-281-0027	MEADOW RIDGE #2
11-281-0028	MEADOW RIDGE #2
11-291-0003	2000-33
11-291-0004	2000-33
11-291-0005	2000-33
11-291-0006	2000-33
11-291-0007	96-44
11-291-0008	96-44
11-291-0009	96-44
11-291-0010	96-44
11-298-0003	98-24
11-298-0004	98-24
11-298-0005	98-24
11-298-0006	98-24
11-298-0007	98-24
11-298-0008	98-24
11-298-0009	98-24
11-298-0010	98-24
11-298-0011	98-24
11-298-0012	98-24
11-298-0013	98-24
11-298-0014	98-24
11-298-0015	98-24
11-298-0016	98-24
11-298-0017	98-24
11-309-0001	29-72
11-317-0003	2000-33
11-317-0004	2000-33
11-317-0005	2000-33
11-327-0002	2000-33
11-327-0003	2000-33
11-327-0004	2000-33
11-327-0005	2000-33
11-327-0006	2000-33
11-334-0001	96-44

4/14/2005

11-334-0004	96-44
11-346-0002	29-72
11-346-0005	29-72
11-350-0012	98-24
11-350-0013	98-24
11-350-0014	98-24
11-350-0015	98-24
11-350-0016	98-24
11-350-0017	98-24
11-350-0018	98-24
11-350-0034	98-24
12-094-0033	29-72
12-094-0039	29-72
12-094-0040	29-72
12-094-0042	29-72
12-094-0045	29-72
12-094-0046	29-72
12-094-0048	29-72
12-094-0051	29-72
12-094-0052	29-72
12-094-0056	29-72
12-094-0057	29-72
12-100-0013	9-88
12-100-0016	34-89
12-100-0026	34-89
12-176-0001	29-72
12-176-0001	29-72
12-177-0001	29-72
12-179-0001	29-72
12-196-0001	29-72
12-196-0002	29-72
12-197-0003	29-72
12-197-0004	29-72
12-197-0005	29-72
12-197-0006	29-72
12-197-0007	29-72
12-197-0008	29-72
12-198-0001	29-72
12-198-0002	29-72
14-030-0009	93-17
14-030-0011	93-17
14-030-0012	93-17
14-030-0013	93-17
14-030-0014	93-17
14-030-0015	93-17
14-030-0025	93-17
14-031-0048	93-17
15-001-0016	29-72
15-032-0039	29-72
15-032-0040	29-72

15-062-0032	31-76
15-067-0003	93-17
15-067-0032	93-17
15-067-0035	93-17
15-067-0057	93-17
15-068-0005	1-92
15-097-0013	2000-32
15-098-0003	2004-61
15-098-0008	2004-61
15-098-0015	2004-61
15-098-0016	2004-61
15-102-0010	2003-70
15-102-0025	2003-70
15-102-0044	97-65
15-198-0002	1-92
15-212-0001	1-92
15-212-0002	1-92
15-212-0006	1-92
15-212-0007	1-92
15-212-0008	1-92
15-212-0009	1-92
15-212-0010	1-92
15-222-0003	1-92
15-228-0002	1-92
15-228-0003	1-92
15-236-0001	1-92
15-236-0002	1-92
15-236-0003	1-92
15-236-0004	1-92
15-251-0001	1-92
15-251-0003	1-92
15-263-0001	1-92
15-263-0002	1-92
15-271-0001	1-92
15-271-0002	1-92
15-271-0003	1-92
15-271-0004	1-92
15-284-0001	1-92
15-284-0002	1-92
15-285-0001	2000-32
15-285-0002	2000-32
15-285-0003	2000-32
15-285-0004	2000-32
15-285-0005	2000-32
15-285-0006	2000-32
15-339-0001	2000-32
15-339-0002	2000-32
15-345-0001	1-92
15-345-0002	1-92
15-345-0003	1-92

15-349-0001	29-72
15-349-0002	29-72
15-366-0001	2000-32
15-366-0002	2000-32
15-366-0003	2000-32
15-366-0004	2000-32
15-369-0001	1-92
15-369-0002	1-92
15-369-0003	1-92

Legend

— Ogdan City Limits

Parcels to be De-annexed

- Ord.# 1-92
- Ord.# 2000-31
- Ord.# 2000-32
- Ord.# 2000-33
- Ord.# 2003-70
- Ord.# 2004-61
- Ord.# 29-72
- Ord.# 31-76
- Ord.# 34-69
- Ord.# 9-88
- Ord.#93-17
- Ord.# 93-28
- Ord.# 94-39
- Ord.# 96-10
- Ord.# 96-44
- Ord.# 97-65
- Ord.# 98-24
- Ord.# 98-32
- EAST OAKS
- MEADOW RIDGE #2

ogden.DBQ.parcels_co

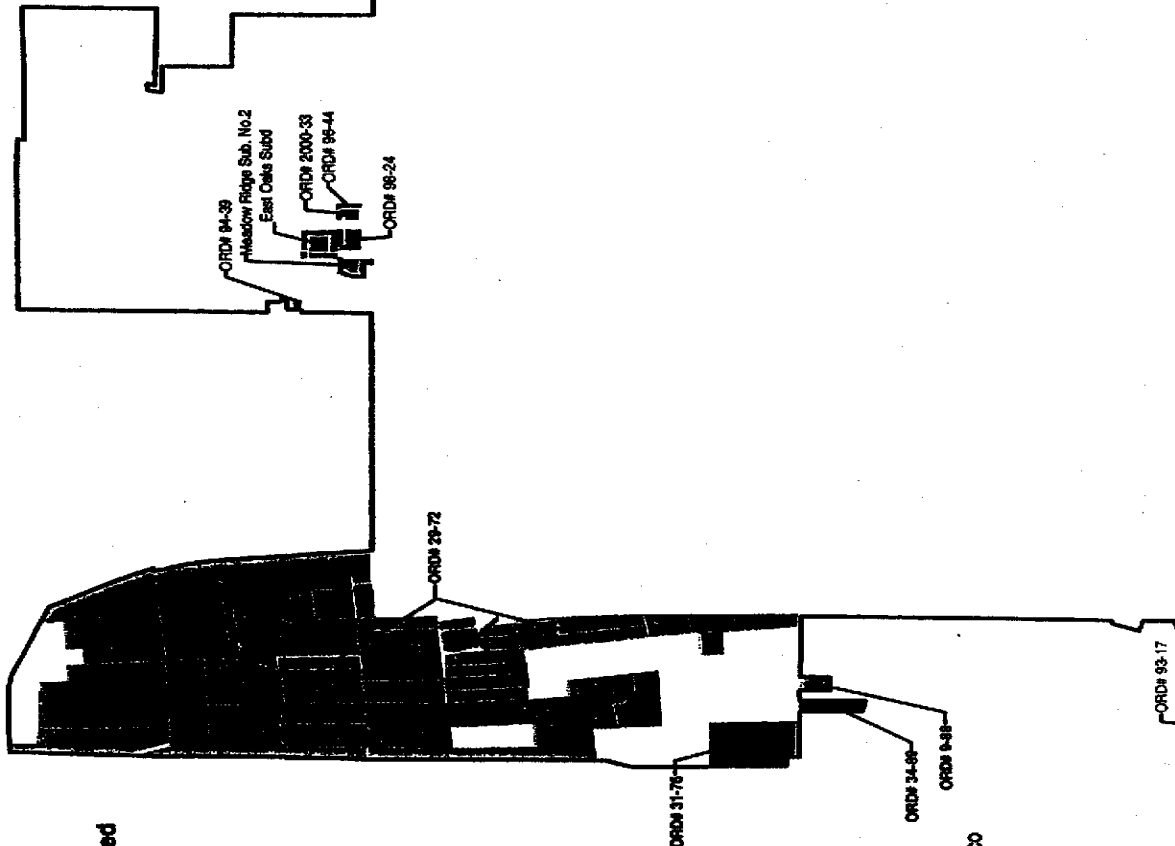



ORD# 2000-32
 ORD# 2004-61
 ORD# 2003-76
 ORD# 97-46
 ORD# 99-32
 ORD# 98-10
 ORD# 2000-31
 ORD# 93-28



Map Date: 11-16-04

Bona Vista Water Service De-Annexation Map