

R/W 74487

RIGHT-OF-WAY EASEMENT

The Undersigned Grantor (and each and all of them if more than one) for and in consideration of TEN AND NO/100 dollars (\$ 10.00) in hand paid by the Grantee, the receipt whereof is hereby acknowledged, hereby grants, bargains and conveys unto The Mountain States Telephone and Telegraph Company, a Colorado corporation, 931 14th Street, Denver, Colorado, 80202, Grantee, its successors, assigns, lessees, licensees and agents, a Right-of-Way Easement and the right to construct, operate, maintain and remove such communication and other facilities, from time to time, as said Grantee may require upon, over, under and across the following described land which the Grantor owns or in which the Grantor has any interest, to-wit:

A five foot easement being 2½ feet on each side of the buried telephone cable as shown on Exhibit "A" attached hereto and made a part hereon on the following described property:

See attached rider

situate in County of Summit, State of Utah,
TOGETHER with the right of ingress and egress over and across the lands of the Grantor to and from the above-described property, the right to clear and keep cleared all trees and other obstructions as may be necessary and the right to permit other utility companies to use the right of way jointly with Grantee for their utility purposes.

The Grantor reserves the right to occupy, use, and cultivate said property for all purposes not inconsistent with the rights herein granted.

Signed and delivered this 23 day of June A.D., 1980
At Park West, Utah J E Roberts, for
SNYDERVILLE DEVELOPMENT Co.

STATE OF UTAH }
County of Salt Lake } ss.

On the 23 day of June, A.D. 1980, personally
appeared before me J E Roberts,

the (signer) ~~(signers)~~ of the above instrument, who duly acknowledged to me that (he) ~~(she)~~ ~~(they)~~ executed the same.

WITNESS my hand and official seal this 23 day of June

My commission expires 3-17-84

David J. Cuttenden
Notary Public

Entry No.	168725	Book	m/63
RECORDED	7-22-80	at	9:45 AM
Page	424		
REQUEST of	Mountain Bell		
FEE		WANDA Y. SPRIGGS, SUMMIT CO. RECORDER	
\$	6.00	By Wanda Y. Spriggs	
INDEXED		ABSTRACT	

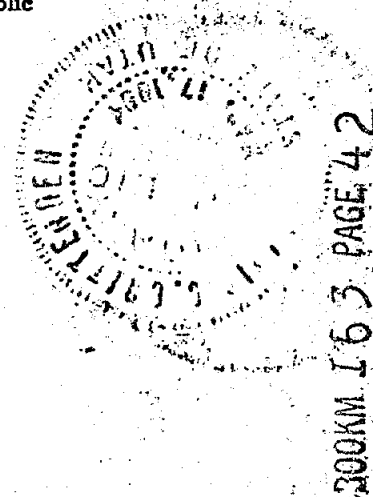

R/w

R I D E R

Beginning at a point North 61.2 feet of the Southeast corner of Section 36, Township 1 South, Range 3 East, Salt Lake Base and Meridian, and running thence West 680.73 feet to a point on a 636.62 foot radius curve to the left, the radius point of which bears North $85^{\circ}24'04''$ West 636.62 feet; thence Northwesterly along the arc of said curve 162.21 feet to a point of tangency; thence North $10^{\circ}00'$ West 132.75 feet; thence North $80^{\circ}00'$ East 46.54 feet to a point of a 500.00 foot radius curve to the right, the radius point of which bears South $10^{\circ}00'$ East 500.00 feet; thence Easterly along the arc of said curve 87.27 feet to a point of tangency; thence East 224.26 feet to a point of a 80.00 foot radius curve to the left, the radius point of which bears North 80.00 feet; thence Northeasterly along the arc of said curve 82.48 feet; thence South $48^{\circ}00'$ East 181.28 feet; thence North $42^{\circ}00'$ East 24.00 feet; thence South $48^{\circ}00'$ East 46.00 feet; thence East 100.91 feet; thence South 212.64 feet to the point of beginning,

RED PINE ROAD

SAFE SHEET # 1130011

BOOKM 163 PAGE 444

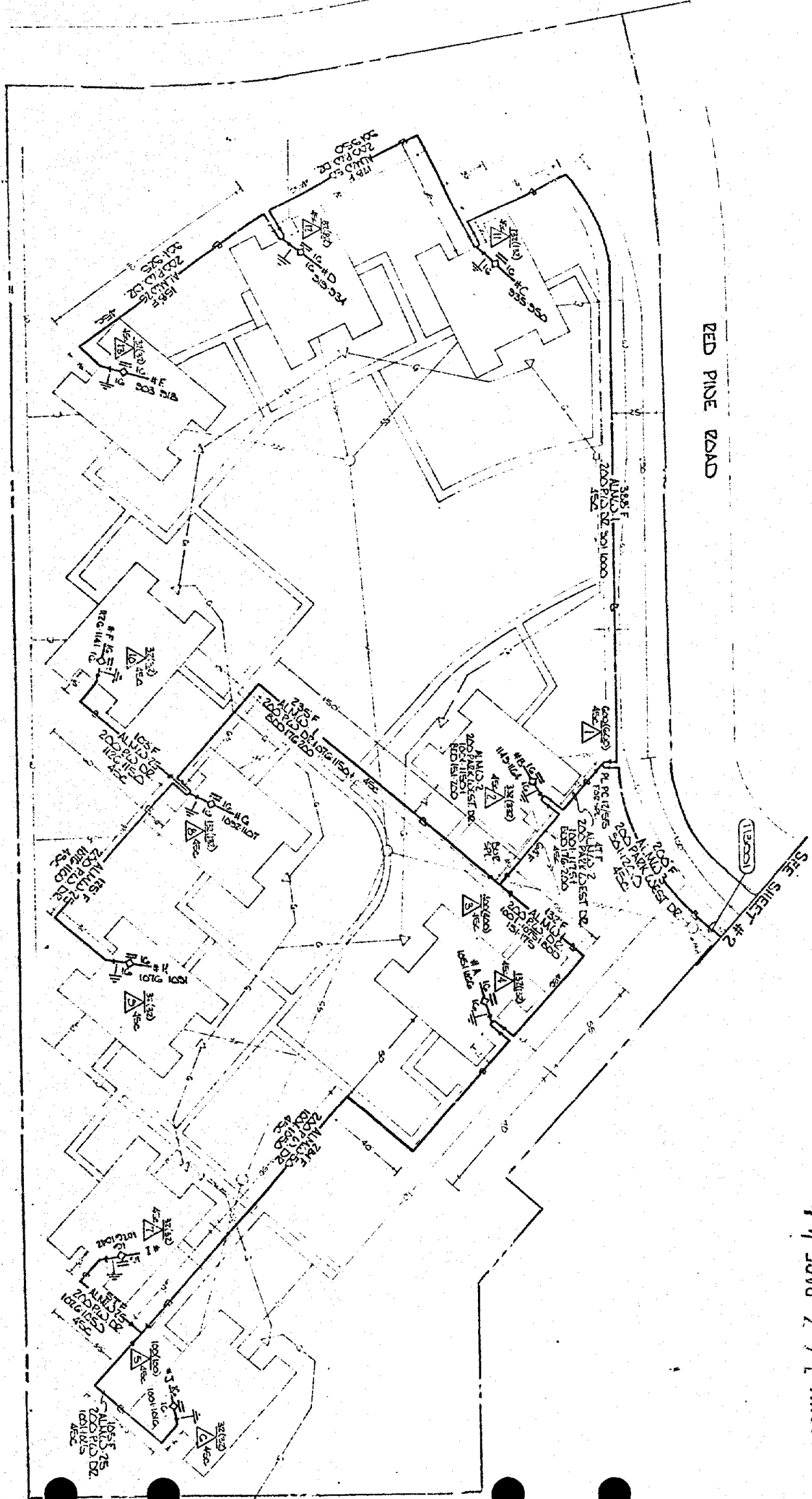

TRENCH DETAIL

GENERAL NOTES

ATTACHED EXHIBIT

A

- [illegible]