

SURVEYOR'S CERTIFICATE

I, Shane Johanson, do hereby certify that I am a Professional Land Surveyor in the State of Utah and that I hold License No. 7075114. I do hereby certify that a Final Local Entity Plat, in accordance with Section 17-23-20 of Utah State Code, was made by me, or under my direction, and shown hereon is a true and correct representation of said Final Local Entity Plat. I further certify that by authority of the Owners, I have prepared this plat for the purpose of depicting those properties within Salt Lake County to be annexed into Holladay City.

BOUNDARY DESCRIPTION

A parcel of land that is described as Block D & E Royal Holladay Hills Subdivision #2, platted, and recorded as Entry #13700581, in Book 2021P, on Page 171, in the office of the Salt Lake County Recorder. Said parcel of land is also located in the Northeast quarter of Section 9 and in the Northwest quarter of Section 10, Township 2 South, Range 1 East, Salt Lake Base and Meridian.

More Particular described as follows: Beginning at the point that is the Southwest corner of Block E Royal Holladay Hills Subdivision #2, recorded June 25, 2021, as Entry Number 13700581; said point lies North 00°03' 51" West a distance of 451.83 feet and West 607.32 feet from the East Quarter Corner of Section 9 Township 2 South, Range 1 East, Salt Lake Base and Meridian.

Thence running around the perimeter of said block E and block D of said Royal Holladay Subdivision # 2 the following courses N 39° 48' 39" W a distance of 606.63 feet to the beginning of a curve, said curve bears to the right through 00° 01' 38", having a radius of 41472.00 feet along the arc a distance of 19.65, and whose long chord bears N 39° 47' 50" W a distance of 19.65 feet to the beginning of a non-tangential curve. Said curve bears to the right through an angle of 00° 04' 27", having a radius of 9215.99 feet along the arc a distance of 11.95, and whose long chord bears N 39° 44' 23" W a distance of 11.95 feet to a point of intersection with a non-tangential line, Thence N 48° 41' 17" E a distance of 307.35 feet, Thence N 31° 40' 15" E a distance of 113.75 feet, Thence S 62° 58' 33" E a distance of 268.49 feet, Thence S 41° 18' 43" E a distance of 421.76 feet, Thence S 48° 41' 17" W a distance of 531.98 feet to the point of beginning.

Containing 326,812 Square Feet or 7.50 Acres

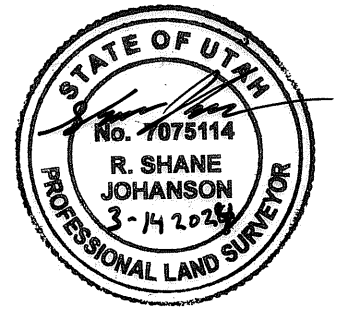

Made 11/2024
 Date: R. Shane Johanson
 P.L.S. 7075114

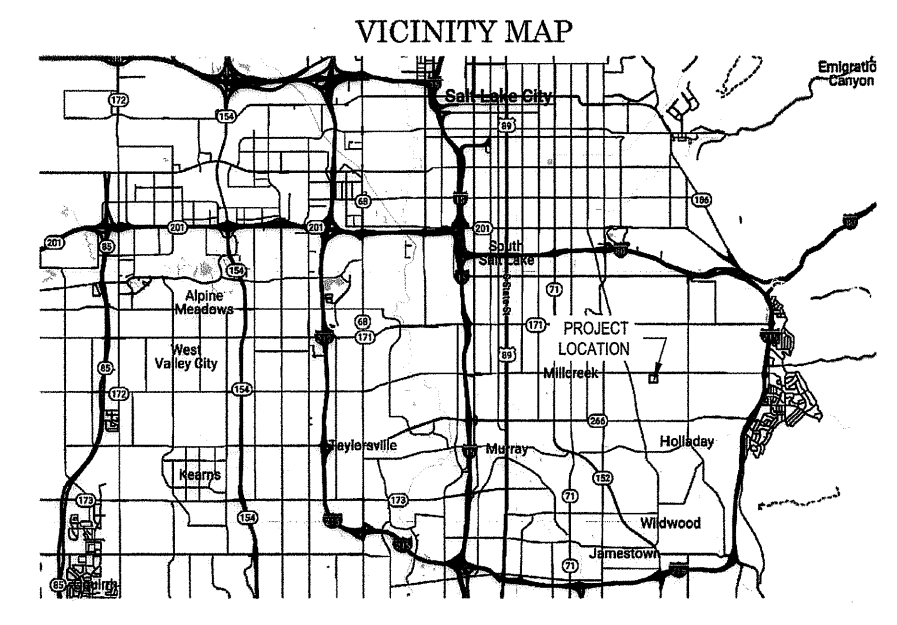

ENTITY PLAT NOTES:
 1. THIS IS A PLAT FOR IMPROVEMENT DISTRICT BOUNDARIES AND SERVICES AREA(S). SEE ROYAL HOLLADAY HILLS PLAT FOR ADDITIONAL INFORMATION DIMENSIONS, NOTES, AND CALCULATIONS. RECORDED 06-25-2021 ENTRY # 13700581.

FINAL LOCAL ENTITY PLAT
HH PUBLIC INFRASTRUCTURE DISTRICT # 1
 APART OF ROYAL HOLLADAY HILLS BLOCK D & E HOLLADAY HILLS SUBDIVISION #2
 LOCATED WITHIN, SALT LAKE COUNTY UTAH. A PART OF THE NORTHWEST QUARTER
 OF SECTION 10, TOWNSHIP 2 SOUTH, RANGE 1 EAST, SALT LAKE BASE & MERIDIAN.
 CITY OF HOLLADAY, UTAH. RMU ZONE

OWNER: S: KMW DEVELOPMENT, DEVELOPER: KMW Development LLC., a Utah limited liability company, 2733 E. Parleys Way Suite 300 Salt Lake City, UT, 84109

JOHANSON SURVEYING
 PROFESSIONAL LAND SURVEYORS
 R. SHANE JOHANSON
 LICENSE NO. 7075114
 PREPARED: 3/11/2024

LEGEND

- SECTIONAL CORNER
- STREET MONUMENT
- REBAR & CAP TO BE SET
- REPRESENTS PROPERTY LINE
- TYP. P.U.E. & PRIVATE UTILITY & EGRESS/INGRESS EASE
- POWER EASE
- PID AREA AS PER PLAT

SALT LAKE COUNTY SURVEYOR
 APPROVED THIS 15 DAY OF March, 2024, BY THE SALT LAKE COUNTY SURVEYOR AS A FINAL LOCAL ENTITY PLAT, PURSUANT TO SECTION 17-23-20 OF UTAH STATE CODE.
 [Signature] for 3/15/24
 Salt Lake County Surveyor Date

ACCEPTANCE LEGISLATIVE BODY
 Approved and accepted this 15 day of March, A.D. 2024. By the Holladay City.
 [Signature] City Manager
 [Signature] City Recorder

Salt Lake County Recorder
 Recorded # 14248075
 State of Utah, County of Salt Lake, recorded and filed at the request of City of Holladay
 Date 06/04/2024 Time 10:16 AM Book 2024P Page 190
 No Fee Fee \$ M.ke Zeiger Deputy Salt Lake County Recorder

Number _____
 Account _____
 Sheet _____
 of _____ Sheets

22-09-29-046
 22-09-28-042
 22-09-22