

4
WHEN RECORDED, MAIL TO:
City Attorney's Office
Murray City Corporation
5025 South State Street
Murray, Utah 84107

12898048
12/05/2018 02:21 PM \$0.00
Book - 10736 Pg - 1750-1753
ADAM GARDINER
RECORDER, SALT LAKE COUNTY, UTAH
MURRAY CITY
5025 S STATE ST
MURRAY UT 84107
BY: NPP, DEPUTY - MI 4 P.

Warranty Deed (TRUSTEE)

Salt Lake County

Tax ID No. 22-17-477-026
Pin No. 11987
Project No. F-LC35(242)
Parcel No. LC35:152:C

David K. Suyehiro and Nadine K. Suyehiro, Trustees of The Suyehiro Trust, dated November 14, 2001, Grantor, of San Mateo, County of San Mateo, State of California, hereby CONVEYS AND WARRANTS to the MURRAY CITY CORPORATION, Grantee, at 5025 South State Street, Murray, Utah 84107, for the sum of TEN (\$10.00) Dollars, and other good and valuable consideration, the following described parcel of land in Salt Lake County, State of Utah, to-wit:

A parcel of land in fee, being part of an entire tract of property, situate Lots 18 and 19, Woodstock Subdivision, according to the official plat thereof, recorded March 20, 1956 as Entry No. 1474872 in Book Q on Page 39 of plats, situate in the SE1/4 SE1/4 of Section 17, T.2S., R.1E., S.L.B.&M., for the construction of improvements incident to the Vine Street 900 East to 1300 East Project, known as project number F-LC35(242).

Beginning at the southeast corner of said entire tract, which point is on the northerly right of way line of said Vine Street, which point is 921.00 feet North and 626.49 feet West and 142.20 feet South from the record location of the Southeast Corner of said Section 17, which point is also 258.18 feet S.89°57'15"W. and 33.00 feet North from Salt Lake County Monument 2S1E171C located at the intersection of said Vine Street and 1300 East Street; thence along the southerly boundary line of said entire tract and said right of way line S.89°57'15"W. 70.50 feet, more or less, to the southwest corner of

CONTINUED ON PAGE 2
TRUSTEE RW-01T (11-01-03)

Ent 12898048 BK 10736 PG 1750

Pin No. 11987
Project No. F-LC35(242)
Parcel No. LC35:152:C

said entire tract; thence along the westerly boundary line of said entire tract North 6.00 feet to a point which is 39.00 feet perpendicularly distant northerly from the control line of said project, at Engineer Station 130+90.46; thence N.89°57'15"E. 42.60 feet to a point of curvature, which point is also 39.00 feet perpendicularly distant northerly from the control line of said project, at Engineer Station 131+33.06; thence easterly 27.91 feet along the arc of a 715.00-foot radius curve to the right, through a central angle of 02°14'12", the chord of which bears S.88°55'40"E. 27.91 feet, more or less, to the easterly boundary line of said entire tract, which point is also 39.00 feet radially distant northerly from the control line of said project, at Engineer Station 131+59.45; thence along said boundary line South 5.46 feet, more or less, to the point of beginning. The above described part of an entire tract of land contains 418 square feet or 0.010 acre in area, more or less.

(Note: Rotate above bearings 00°14'51" *clockwise* to equal project bearings.)

Pin No. 11987
Project No. F-LC35(242)
Parcel No. LC35:152:C

WITNESS, the hand of said Grantor, this 16 day of August, A.D. 20 18.

Signed in the presence of:

David K. Suyehiro, Trustee

Nadine K. Suyehiro, Trustee

STATE OF California)
COUNTY OF San Mateo) ss.

David K. Suyehiro, Trustee
David K. Suyehiro, Trustee

Nadine K. Suyehiro, Trustee
Nadine K. Suyehiro, Trustee

On the date first above written personally appeared before me, David K. Suyehiro and Nadine K. Suyehiro, Trustees of The Suyehiro Trust, dated November 14, 2001, who, being by me duly sworn, acknowledged to me that ___he signed the within and foregoing instrument in accordance with the authority as Trustee given under the instrument creating said Trust, and that as Trustee ___he executed the same.

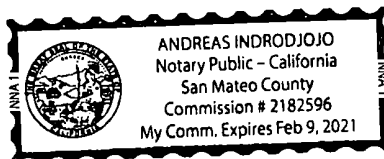

Notary Public

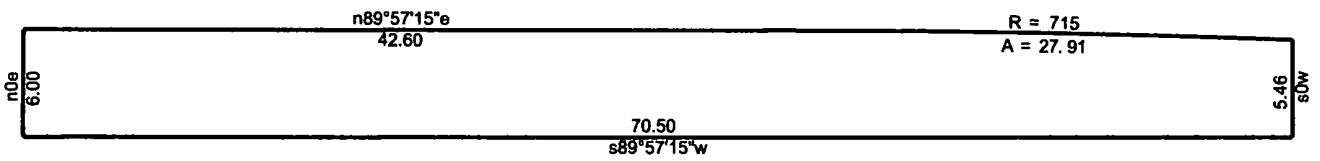

Parcel 152:C

4/24/2018

Scale: 1 inch= 10 feet

File: 11987_F-LC35(242)_02P_152_C_DeedPlot.ndp

Tract 1: 0.0096 Acres (418 Sq. Feet), Closure: n47.0924w 0.01 ft. (1/22599), Perimeter=152 ft.

01 s89.5715w 70.50

02 n0e 6.00

03 n89.5715e 42.60

04 Rt, r=715.00, delta=002.1412, arc=27.91, chord=s88.5540e 27.91

05 s0w 5.46