

11641027  
05/14/2013 02:06 PM \$12.00  
Book - 10138 Pg - 1961-1962  
GARY W. OTT  
RECORDER, SALT LAKE COUNTY, UTAH  
DR HORTON INC  
12351 S GATEWAY PARK STE D 100  
DRAPER UT 84020  
BY: HNP, DEPUTY - WI 2 P.

**WHEN RECORDED, MAIL TO:**

Attn: Jon Thornley  
D.R. Horton, Inc.  
12351 S. Gateway Park Place  
Suite D-100  
Draper, UT 84020

**AFFIDAVIT**

This document is made and executed this 14<sup>th</sup> day of May, 2013, to inform concerned persons of changes to the plat of the Rosecrest Village P.U.D. Plat 3 Amended 6, recorded as Entry No. 11622101 in Book 2013P at Page 69. The changes to the plat are as follows:

1. The changes as follows:

- Unit numbers for Buildings 78-81 have been changed to read east to west and north to south.
- Building 160 unit numbers have been changed to read east to west.
- See exhibit "A" for changes

In witness whereof, I swear that the above changes are correct and cause the same to be duly executed this 14<sup>th</sup> day of May, 2013.

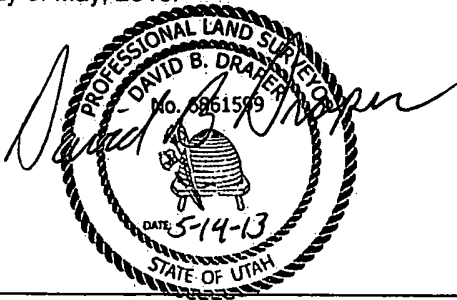

David B Draper, P.L.S.

STATE OF UTAH                    )  
  :SS  
COUNTY OF SALT LAKE        )

On this 14<sup>th</sup> day of May, 2013, personally appeared before me, David B. Draper, signer of the foregoing instrument who duly acknowledged to me that they executed the same.

  
\_\_\_\_\_  
NOTARY PUBLIC

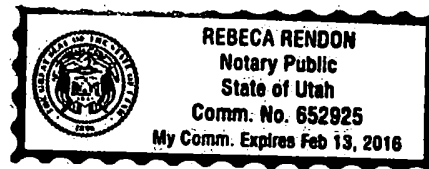

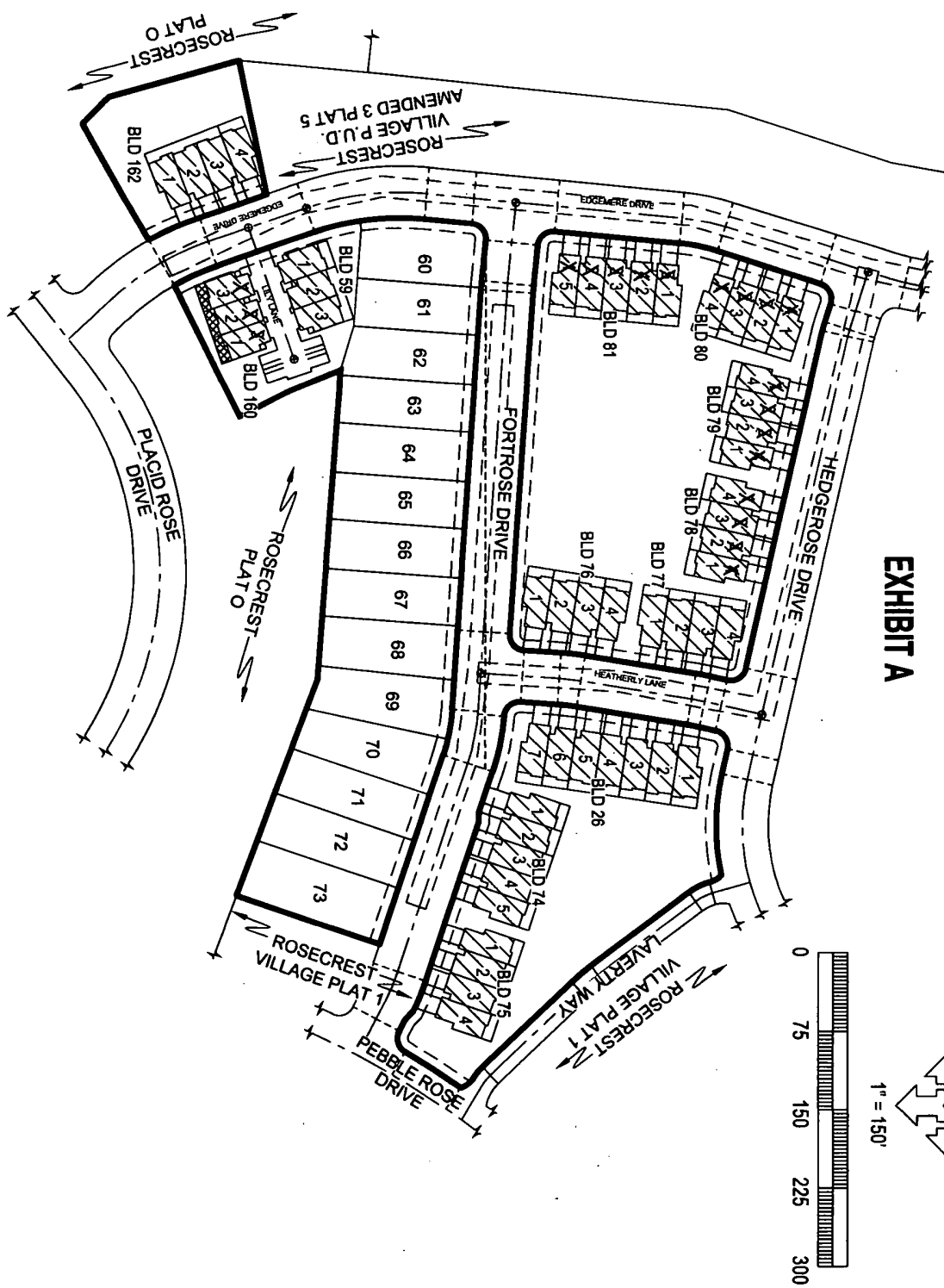

**EXHIBIT A**

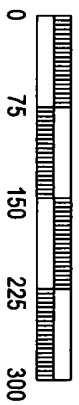
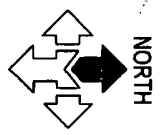

S:\2010Files\10570\Survey\Prod Dwg\PU\10570\006a.dwg May 14, 2013 - 7:40am

McNEIL ENGINEERING - CIVIL, L.C.

McNEIL ENGINEERING STRUCTURAL, L.C.

McNEIL ENGINEERING - ST. GEORGE, L.C.

**ROSECREST VILLAGE P.U.D. PLAT 3 AMENDED 6**  
**D.R. HORTON**  
 HERRIMAN, UTAH  
 LOCATED IN THE SEC 29, T 4 S, R 2 E, S.L.B. & M.

**McNEIL ENGINEERING**  
*Designing for the Future Since 1983*

8610 So. Sandy Parkway, Suite 200 Sandy, Utah 84070  
 TEL. (801) 255-7700 FAX (801) 255-8071  
 E-MAIL info@mcneileng.com WEB SITE AT www.mcneil-group.com

PROJECT NO.: 10570  
 CHECKED BY: DBD  
 DRAWN BY: KSL  
 DATE: 5-14-13