

WHEN RECORDED RETURN TO:

City Recorder
Grantsville City Corporation
429 East Main Street
Grantsville, UT 84029

E 115520 B 0518 P 0858
Date 28-JUL-1998 15:54pm
Fee: No Fee Check
DONNA S. MCKENDRICK, Recorder
Filed By RGO
For GRANTSVILLE CITY CORP
TOOELE COUNTY CORPORATION

"LETTER OF INTENT" FOR LAND USE AGREEMENT

An intended agreement between Grantsville City and landowner, "property owner" (Figure 1), will be implemented if the drinking water source proves to be an acceptable source. The following land use agreement will be recorded in the County Recorder's office. Grantsville City is located in Tooele County, Utah.

THE PARTY upon acceptance of the drinking water source intends to agree as follows:

1. Grantsville City hereby acknowledges the Drinking Water Source Protection Plan for the water well located approximately North 1,720 feet and East 2,290 feet from SW Cor. of Sec. 7, T3S, R5W, SLBM (the "Well").
pt 1-74-19

2. Landowner owns land encompassing Zone 2, (see attached Figure and table for exact dimensions). Figure 1 includes the location of the real estate, located in Tooele, Utah (the "Property") and made part of this Agreement.

3. The landowner agrees not to locate pollution sources, as defined in R309-113-2(a) of the Utah Administrative Code, within Zone 2 (as shown on the attached figure), unless design standards are implemented to prevent contaminated discharges.

4. The restrictions and covenant of this Agreement shall be binding upon all heirs, successors, and assigns of the parties to this Agreement.

IN WITNESS WHEREOF, the parties hereto have caused this Agreement to be executed upon acceptance of the drinking water source as a potable source.

Date: 7/10/98

By:

Alon D. B.
Shelly C. Johnson
Owner

The foregoing instrument was acknowledged before me by Land Owner.

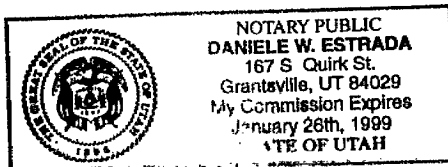

Daniele W. Estrada
Notary Public

F:\projects\whpp\swilow\intent.wpd

000

ENGINEERING EWP

E 115520 B 0518 P 0858
171 108 80:81 FAX 86/80/10

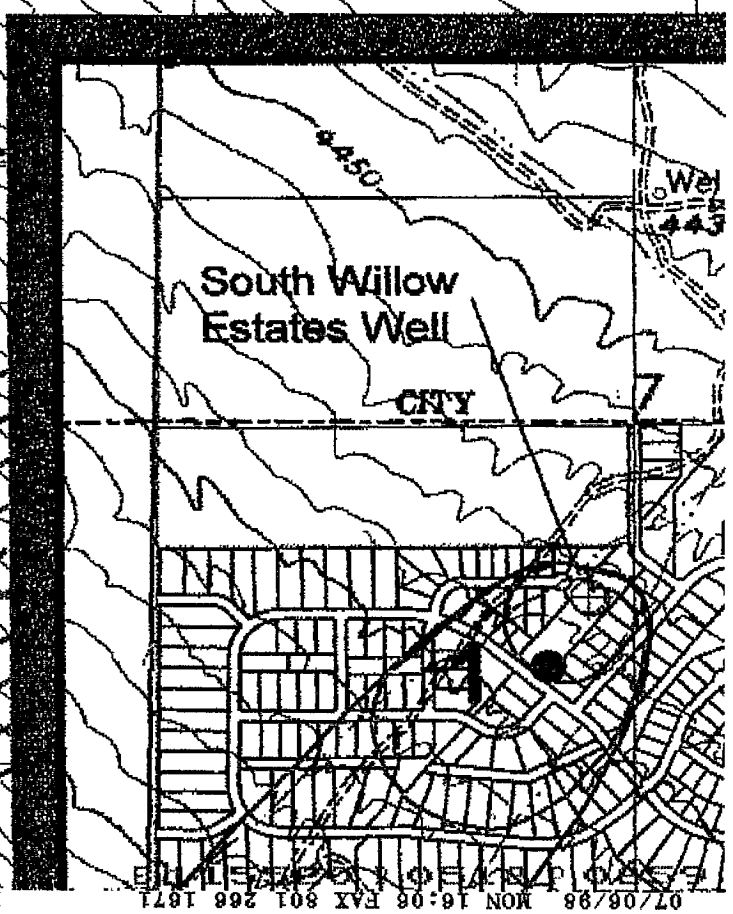
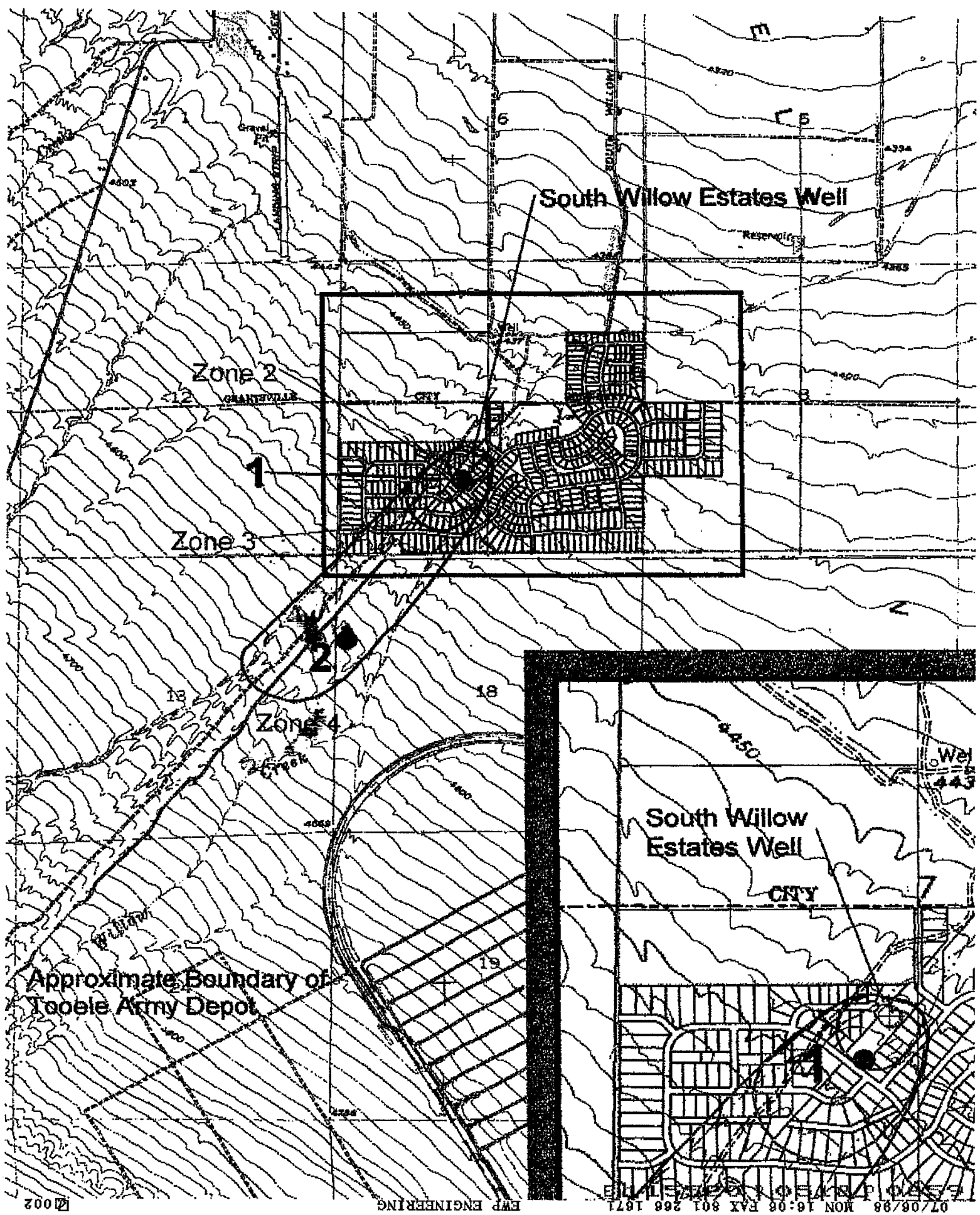

EMP ENGINEERING

07/06/98 MON 16:08 FAX 801 266 1671

2002