

ORDINANCE 98-07

AN ORDINANCE OF THE TOOELE CITY COUNCIL CORRECTING STREET NAMES AND HOUSE NUMBERS ON CERTAIN CITY STREETS

WHEREAS, the Administration, with the help of Tooele residents, has identified certain streets which are incorrectly named and certain houses which are incorrectly numbered on the following City streets: Cedar Road, Valley View Drive, Seventh Street, 850 East, 830 East, 1700 North, 570 East, 180 North Street, 220 North, and Settlers Court;

WHEREAS, the errors in most instances resulted from the incorrect assumption that the street name reflects the street coordinate, e.g., that 7th Street equals 700 East;

WHEREAS, the Administration and City Council find that for public safety reasons and for reasons of general order and welfare of Tooele residents, these street names and house numbers should be changed to comply with City ordinances [§4-8-8(c)] and to correctly reflect the geometric City Addressing Grid;

WHEREAS, Jesse Peterson, Chief of Police, and Richard Jorgensen, drafting technician in the Engineering Department, have determined which houses need to be renumbered, and what the correct numbers should be, and have reported their conclusions in Exhibit 1, attached to and made a part of this Ordinance;

WHEREAS, on March 18, 1998, the City Council convened a public hearing, according to the provisions of U.C.A. 10-8-8.4, during its regularly scheduled business meeting, and considered all public comment received;

WHEREAS, as a courtesy, the Administration has notified each affected property, by regular first-class mail, of the imminent house number change, of the reasons for said change, and of the date, time, and location of the City Council action on this Ordinance;

NOW, THEREFORE, BE IT ORDAINED BY THE TOOELE CITY COUNCIL that the incorrect house numbers identified in Exhibit 1 be changed as recommended in Exhibit 1, that the streets identified in Exhibit 1 be renamed, that each property owner or resident be notified of the change, and that a copy of this Ordinance, with Exhibit 1, be delivered to utilities and services providers.

This Ordinance is necessary for the immediate preservation of the peace, health, and safety of the residents of Tooele City and shall become effective upon passage.

IN WITNESS WHEREOF, this Ordinance is passed by the Tooele City Council this 18 day of MARCH, 1998.

TOOELE CITY COUNCIL

(For)

(Against)

Lawrence F. Sulcox

Carl Cole

John K. Schuff

Charles H. Brown

Colleen Johnson

ABSTAINING: _____

MAYOR OF TOOELE CITY

(Approved)

(Disapproved)

Charlie Spahr

ATTEST:

Patrick H. Dunlavy

Patrick H. Dunlavy, City Recorder

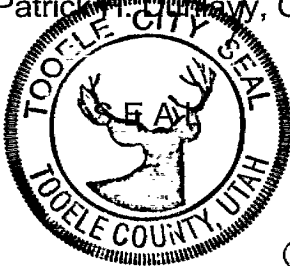

Approved as to Form:

Roger Evans Baker
Roger Evans Baker, Tooele City Attorney

**Street Name Changes and Address Changes
Tooele City
March 1998**

Cedar Road changed to Cedarwood Road

Subdivision = Cedarwood Estates No. 1

Reason for change: Already have a Cedar Street, Cedar road is not different enough for safety.

Old Address	New Address	Parcel Serial Number
881 Cedar Road	881 Cedarwood Road	11-86-010
823 Cedar Road	823 Cedarwood Road	11-86-009
1047 Cedar Road	1047 Cedarwood Road	11-86-008
1051 Cedar Road	1051 Cedarwood Road	11-86-007
1046 Cedar Road	1046 Cedarwood Road	11-86-006
1038 Cedar Road	1038 Cedarwood Road	11-86-005
834 Cedar Road	834 Cedarwood Road	11-86-004
828 Cedar Road	828 Cedarwood Road	11-86-003
818 Cedar Road	818 Cedarwood Road	11-86-002
806 Cedar Road	806 Cedarwood Road	11-86-001

830 East Street changed to 780 East Street

Subdivision = Spring Meadows No. 1

Reason for change: Street address names are ½ block off correct coordinate for house numbers.
Would need to change street names or house numbers to eliminate error.

Old Address	New Address	Parcel Serial Number
595 North 830 East	595 North 780 East	11-84-115
587 North 830 East	587 North 780 East	11-84-114
579 North 830 East	579 North 780 East	11-84-113
569 North 830 East	569 North 780 East	11-84-112
559 North 830 East	559 North 780 East	11-84-111
549 North 830 East	549 North 780 East	11-84-110
541 North 830 East	541 North 780 East	11-84-109
539 North 830 East	539 North 780 East	11-84-108
584 North 830 East	584 North 780 East	11-84-124
592 North 830 East	592 North 780 East	11-84-123
566 North 830 East	606 North 780 East	11-84-122

850 East Street changed to 800 East Street

Subdivision = Spring Meadows No. 1

No building lots use this street for house addresses.

Address Number Changes on Valley View Drive

Subdivision = Spring Meadows No. 2

Reason: Older homes on Valley View Drive already using 500 to 600 range numbers so need to address the end of Valley View Drive with 800 range East numbers for safety.

Old Address	New Address	Parcel Serial Number
617 Valley View Drive	823 Valley View Drive	12-20-212
609 Valley View Drive	829 Valley View Drive	12-20-213
603 Valley View Drive	835 Valley View Drive	12-20-214
597 Valley View Drive	841 Valley View Drive	12-20-215
587 Valley View Drive	847 Valley View Drive	12-20-216
579 Valley View Drive	853 Valley View Drive	12-20-217
571 Valley View Drive	859 Valley View Drive	12-20-218
565 Valley View Drive	865 Valley View Drive	12-20-219
555 Valley View Drive	871 Valley View Drive	12-20-220
542 Valley View Drive	877 Valley View Drive	12-20-221
536 Valley View Drive	883 Valley View Drive	12-20-222
532 Valley View Drive	889 Valley View Drive	12-20-223
528 Valley View Drive	888 Valley View Drive	12-20-224
525 Valley View Drive	882 Valley View Drive	12-20-225
558 Valley View Drive	868 Valley View Drive	12-20-229
566 Valley View Drive	862 Valley View Drive	12-20-230
574 Valley View Drive	856 Valley View Drive	12-20-231
592 Valley View Drive	844 Valley View Drive	12-20-241
598 Valley View Drive	838 Valley View Drive	12-20-242
606 Valley View Drive	832 Valley View Drive	12-20-243
614 Valley View Drive	824 Valley View Drive	12-20-244

Note: Corner Lots may have two addresses, if vacant lot may still have two available address.

Address Number Changes on Seventh Street, 180 North Street, 570 East

Subdivision = Oquirrh Meadows No. 1

Reason: Odd and Even is wrong, 7th Street is 520 East so numbers must be larger,

Old Address	New Address	Parcel Serial Number
137 N. Seventh Street	126 N. Seventh Street	12-25-105
147 N. Seventh Street	136 N. Seventh Street	12-25-104
157 N. Seventh Street	146 N. Seventh Street	12-25-103
167 N. Seventh Street	156 N. Seventh Street	12-25-102
515 E. 180 North Street	525 E. 180 North Street	12-25-100
538 E. 180 North Street	524 E. 180 North Street	12-25-101
578 E. 180 North Street	572 E. 180 North Street	12-26-217

118 N. 570 East Street	117 N. 570 East Street	12-26-220
128 N. 570 East Street	127 N. 570 East Street	12-26-221
138 N. 570 East Street	137 N. 570 East Street	12-26-222
148 N. 570 East Street	147 N. 570 East Street	12-26-223
158 N. 570 East Street	157 N. 570 East Street	12-26-224

670 E. 220 North Street	672 E. 220 North Street	12-39-333
-------------------------	-------------------------	-----------

Street Number Change from 1700 North Street to 2000 North Street

Subdivision= Smart Subdivision

Reason: Adjust City address to match County addressing on Northside of Tracks

Old Address	New Address	Parcel Serial Number
10 East 1700 North	10 East 2000 North Street	10-21F-1
60 East 1700 North	60 East 2000 North Street	2-126-11

Change House Number

Subdivision: Settlement Pointe No. 3

Reason: Odd-Even wrong

Old Address	New Address	Parcel Serial Number
287 Settler's Court	288 Settler's Court	11-69-236

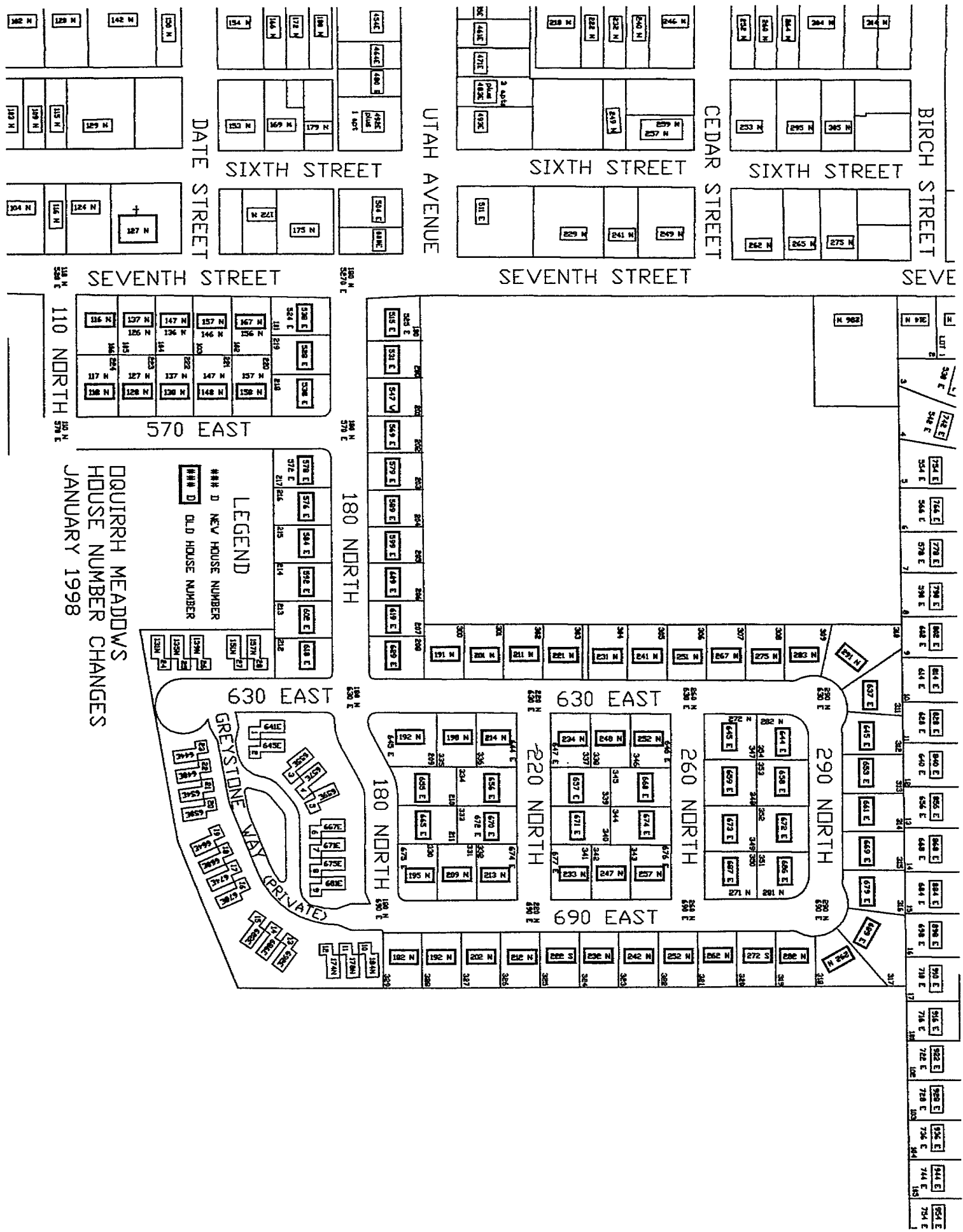

DOIRRH MEADOWS
HOUSE NUMBER CHANGES
JANUARY 1998

LEGEND
D NEW HOUSE NUMBER
E OLD HOUSE NUMBER

MAIN STREET

1665 N

1685 N

LOT 1

10 E

PROGRESS WAY

2000 NORTH

400 EAST

60 E

E 109780 B 0500 P 0669 *



E 109780 B 0500 P 0670

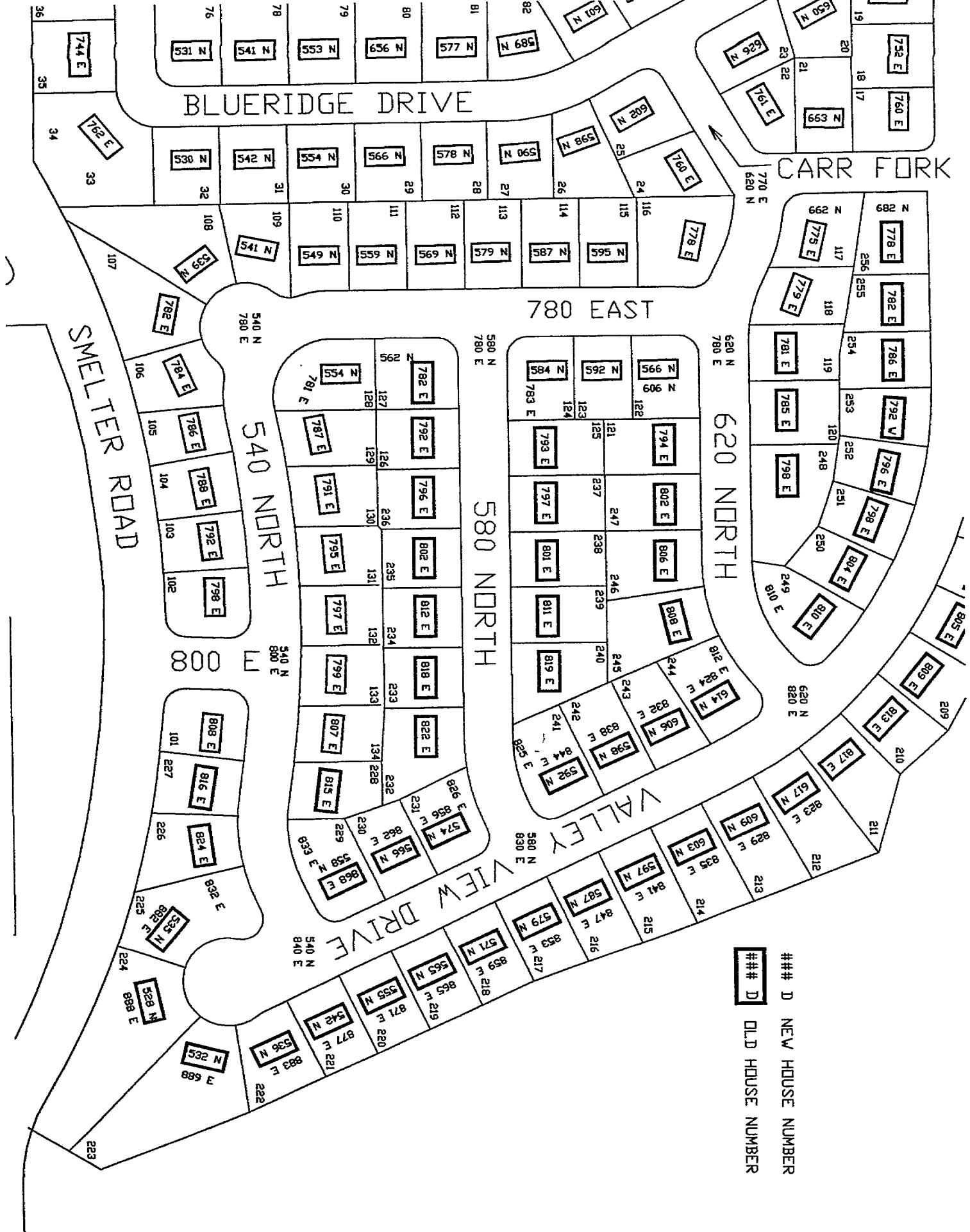

D NEW HOUSE NUMBER
 ### D OLD HOUSE NUMBER