

6893746

6893746
03/17/98 11:18 AM 67.00
NANCY WORKMAN
RECORDER, SALT LAKE COUNTY, UTAH
JAMES R. BOUD
6 BIRCHTREE LANE
SANDY, UTAH 84092
REC BY: N ZELAYA , DEPUTY - WI

NAME:
SHADOW CREST OFFICE PARK CONDOMINIUMS

DESCRIPTION:
28-3-11

FEE:
\$67.00

OF PAGES: 2

PLAT

See fiche

SHADOWCREST OFFICE PARK CONDOMINIUMS

LOCATED IN THE NORTHWEST QUARTER OF SECTION 5, TOWNSHIP 3 SOUTH, RANGE 1 EAST,
SALT LAKE BASE AND MERIDIAN

SCALE: 1" = 10'

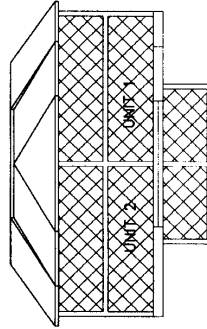
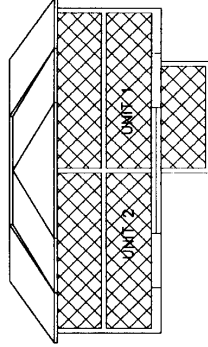
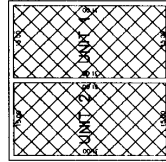
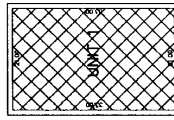
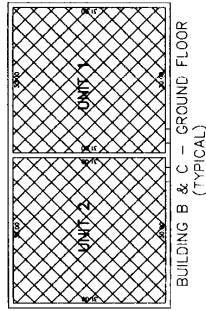
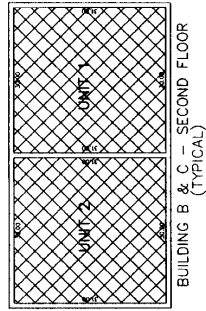
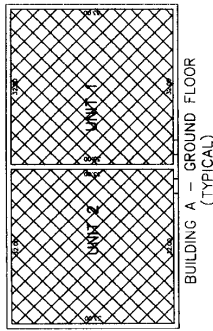
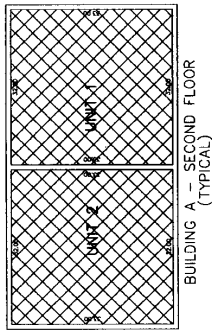
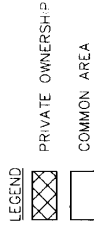

NOTE: UNITS ARE FINISH FLOOR RELATIVE TO THE
TOP FINISH OF EXISTING FREE HYDRANT ON THE EAST
SIDE OF GREEN WAY
1.54' E.L. 4592.60

UNIT AREA - BUILDING A		UNIT AREA - BUILDING B		UNIT AREA - BUILDING C	
UNIT #	AREA (SQ. FT.)	UNIT #	AREA (SQ. FT.)	UNIT #	AREA (SQ. FT.)
1	212	1	212	1	212
2	212	2	212	2	212

BUILDING ELEVATIONS		
BUILDING "A"	BUILDING "B"	BUILDING "C"
BASEMENT	BASEMENT	BASEMENT
4526.42	4504.62	4502.10
MAIN FLOOR	MAIN FLOOR	MAIN FLOOR
4516.42	4514.62	4512.10
SECOND FLOOR	SECOND FLOOR	SECOND FLOOR
4526.42	4524.62	4522.10