

8655147

When Recorded, Mail To:
Gibbons Realty Company
3098 S. Highland Dr.
Suite 350A
Salt Lake City, Utah 84106

8655147
05/19/2003 12:05 PM NO FEE
Book - 8799 Pg - 6157-6160
GARY W. OTT
RECORDER, SALT LAKE COUNTY, UTAH
SANDY CITY
19000 CENTENNIAL PARKWAY
SANDY UT 84070
BY: RDJ, DEPUTY - MA 4 P.

Parcel I.D.# 28-05-401-003

RELEASE OF EASEMENT

KNOW ALL MEN BY THESE PRESENTS:

That the undersigned for and in consideration of the sum of TEN DOLLARS AND OTHER VALUABLE CONSIDERATION, the receipt of which is hereby acknowledged, does hereby release and convey to GIBBONS REALTY COMPANY all of its right, title and interest in and to the following slope easement:

A portion of that certain slope easement granted to Sandy City September 4, 1987 by instrument found as Entry No. 4519006 in Book 5959 at Page 422 in the office of the Salt Lake County Recorder, the portion of said slope easement to be released is described in Exhibit "A". The portion of said slope easement to be retained by Sandy City is described in Exhibit "B".

IN WITNESS WHEREOF, the undersigned Corporation has caused these presents to be executed by its officers hereunto duly authorized and its corporate seal to be hereunto affixed this 12th day of May, 2003.

SANDY CITY CORPORATION, a Utah
municipal corporation



x Tom Dolan
By: Thomas M. Dolan, Mayor

Dianne H. Aubrey
Attest: Dianne H. Aubrey, City Recorder

BK8799PG6157

TO GIBBONS REALTY COMPANY
Exhibit "A"

Beginning at a point which lies South 89°21'40" East 113.09 feet along the section line and North 530.11 feet (base of bearing is North 00°07' East on the 700 East St. monument line) from the South Quarter Corner of Section 5, T 3 S, R 1 E, SLB&M; said point is on the arc of a curve to the right; thence Northwesterly 1136.97 feet along the arc of said curve whose center bears North 53°10'53" East 1763.86 feet, has a central angle of 36°55'57" and a long chord bearing and length of North 18°21'08" West 1117.39 feet; thence North 00°06'50" East 417.96 feet to a point of curvature with a curve to the left, thence Northwesterly 436.34 feet along the arc of said curve whose center bears North 89°53'10 West 769.20 feet, has a central angle of 32°30'06" and a long chord bearing and length of North 16°08'13" West 430.51 feet;
thence North 57°36'44" East 45.47 feet;
thence South 19°01'41" East 71.34 feet;
thence South 13°10'23" East 112.17 feet;
thence South 18°01'49" East 109.45 feet;
thence South 22°06'17" East 132.62 feet;
thence South 08°22'23" West 153.05 feet;
thence South 07°21'55" East 74.58 feet;
thence South 00°06'49" West 226.96 feet;
thence South 06°31'23" East 126.27 feet;
thence South 06°36'13" East 150.97 feet;
thence South 11°38'57" East 150.96 feet;
thence South 17°00'37" East 169.82 feet;
thence South 25°47'19" East 113.27 feet;
thence South 18°08'40" East 83.50 feet;
thence South 28°12'20" East 107.71 feet;
thence South 31°14'55" East 74.64 feet;
thence South 14°58'38" East 139.47 feet to the point of beginning.

RETAINED BY SANDY CITY
Exhibit "B"

Beginning at a point which lies North 2420.92 feet and West 357.56 feet (basis of bearing is North 00°07' East on the 700 East St. monument line) from the South Quarter Corner of Section 5, Township 3 South, Range 1 East, Salt Lake Base and Meridian; said point is on a curve to the left; thence Northwesterly 109.99 feet along the arc of said curve whose center bears South 57°36'44" West 769.20 feet, has a central angle of 8°11'35" and a long chord bearing and length of North 36°29'04" West 109.90 feet; thence North 00°06'50" East 90.00 feet; thence South 38°33'32" East 124.67 feet; thence South 19°01'41" East 44.89 feet; thence South 57°36'44" West 45.47 feet to the point of beginning.

BK8799PG6159

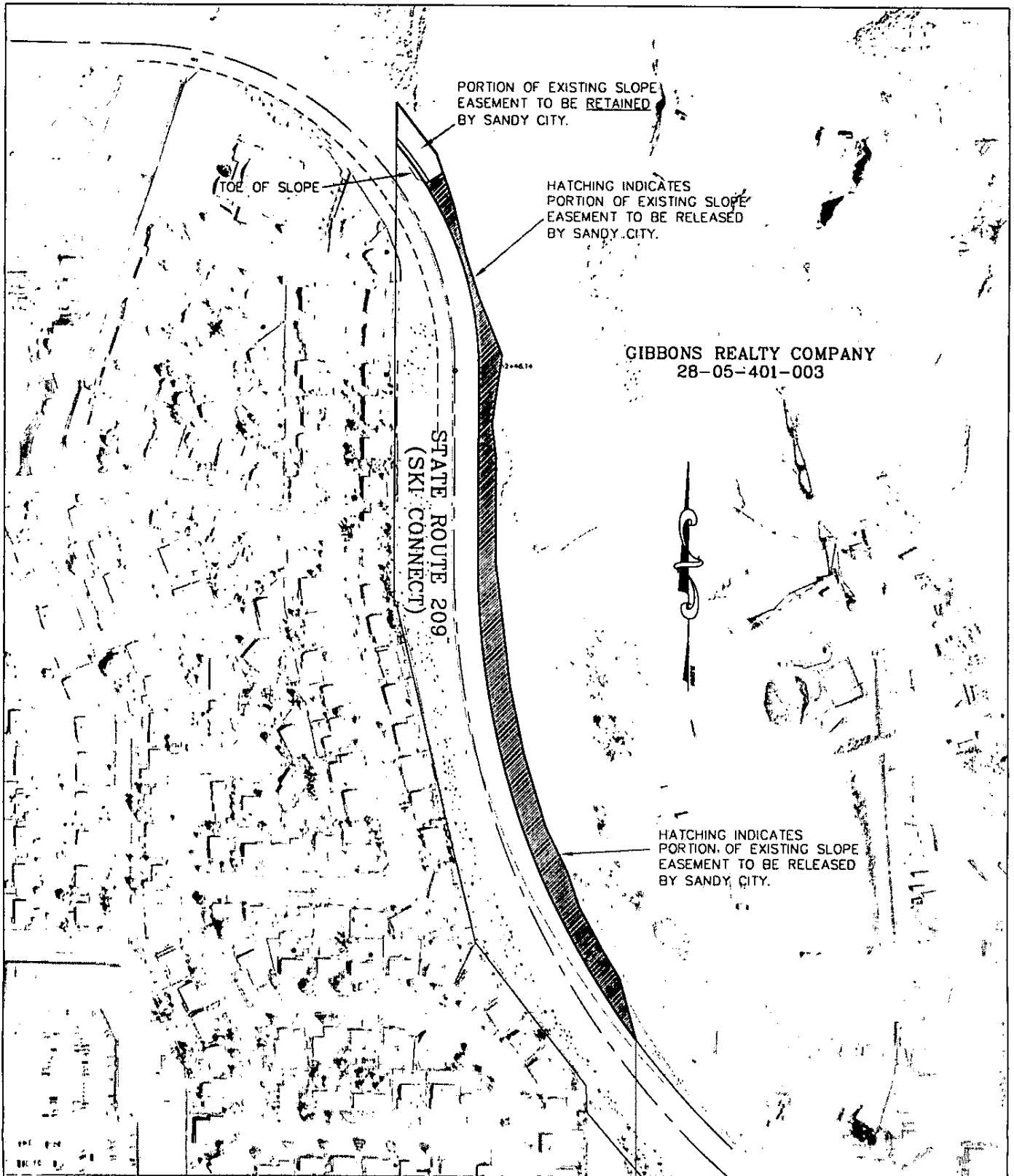

PREPARED BY:
 NOLAN C. HATHCOCK
 SANDY CITY SURVEYOR
 8775 S 700 W
 SANDY, UTAH 84070
 PHONE: 801-568-2965

PLAT TO ACCOMPANY DESCRIPTIONS
 THAT OF PORTION OF AN EXISTING SLOPE EASEMENT
 TO BE RELEASED BY SANDY CITY TO GIBBONS REALTY COMPANY
 AND THAT PORTION OF SAID EXISTING SLOPE EASEMENT
 TO BE RETAINED BY SANDY CITY.

MAY 8, 2003

BK8799PG6160