

Return to Layla @

LAYTON CITY PLANNING DEPT.  
437 WASATCH DRIVE  
LAYTON, UTAH 84041

ORDINANCE 99-59

E 1570666 B 2607 P 139  
SHERYL L. WHITE, DAVIS CNTY RECORDER  
2000 JAN 20 8:18 AM FEE .00 DEP JB  
REC'D FOR LAYTON CITY

**CHANGING 1200 WEST (ANGEL STREET) TO 1200 WEST (UNIVERSITY PARK BOULEVARD).**

**WHEREAS**, 1200 West Street presently known as Angel Street runs from 2000 North, also known as Antelope Drive, north to the city limits of Clearfield City; and

**WHEREAS**, said street continues north through Clearfield City to State Road 193 and this street is to be one of the primary access points to the proposed university location; and

**WHEREAS**, Clearfield City has named the portion of said street within its corporate limits "University Park Boulevard"; and

**WHEREAS**, Layton City has been petitioned to change that portion of 1200 West (Angel Street) to 1200 West (University Park Blvd.)

**WHEREAS**, it has been determined that said change will not be detrimental to the general public interest to do so.

**NOW THEREFORE, BE IT ORDAINED BY THE CITY COUNCIL OF LAYTON CITY:**

**Section I: Repealer.** Any ordinance inconsistent with the provisions of this ordinance is hereby repealed.

**Section II: Enactment.** This ordinance is hereby enacted, declaring that 1200 West (Angel Street) from 2000 North (Antelope Drive) to the Clearfield City limits shall be known as 1200 West (University Park Blvd.). (see attachment provided).

**Section III: Severability.** If any section, subsection, sentence, clause or phrase of this ordinance is declared invalid or unconstitutional by a court of competent jurisdiction, said portion shall be severed and such declaration shall not affect the validity of the remainder of this ordinance.

**Section IV: Effective Date.** This Ordinance, being necessary for the peace, health and safety of the City, shall become effective at the expiration of the 20<sup>th</sup> day after publication or posting, or the 30<sup>th</sup> day after final passage, as noted below, or whichever of said days is the more remote from the date of passage thereof.

**PASSED AND ADOPTED** by the City Council of Layton, Utah, this **2th day of December, 1999.**

ATTEST:

*Steven M. Ashby*  
STEVEN M. ASHBY, City Recorder

*Jerry Stevenson*  
JERRY STEVENSON, Mayor

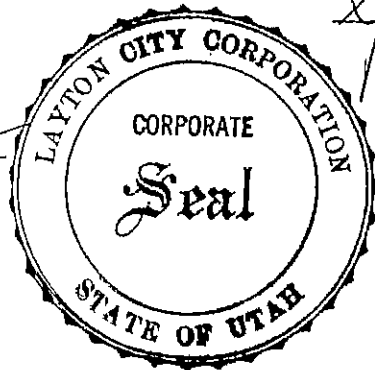

SW 1/4-8-47N-16W  
Spring Creek PRUD, Lots 1, 7, 8 + common area  
Robins Estates, Parcels 1 + 4  
Dawn Dev. Plat A, Lots 1, 11, 12, 13  
N 1/2-7-47N-16W

RANGE WEST

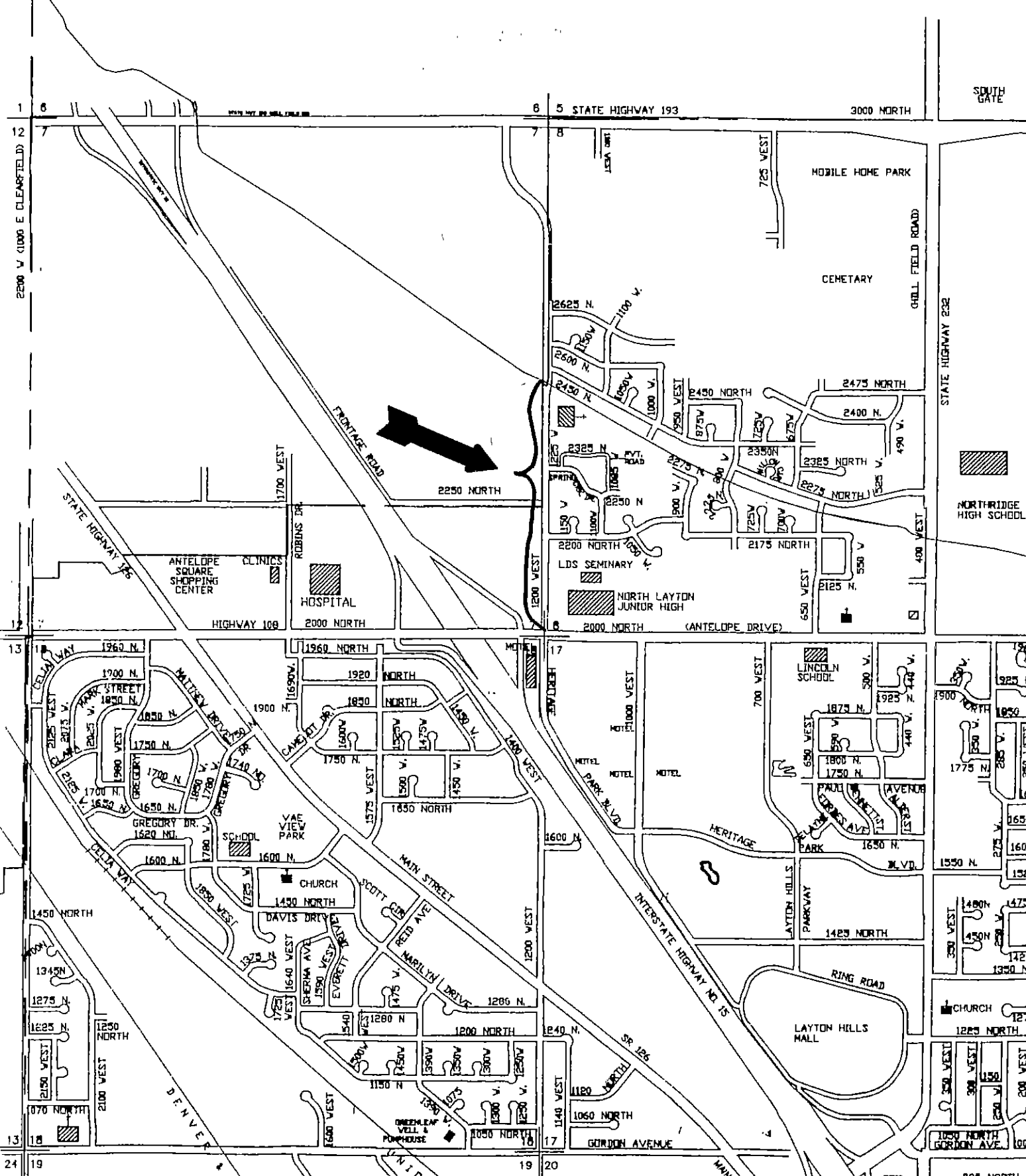

09-036-0006, 0001, 0005, 0025

09-043-0001, 0011, 0012, 0013

E 1570666 B 2607 P 141

09-289-0001, 0007, 0008, 0051

09-023-0009, 0032, 0025, 0026, 0056, 0057, 0068, 0066

09-281-0001, 0004

LILD LAND INDEX SYSTEM LEGAL DESCRIPTION

SERIAL# 09-036-0001 ✓ ACRES .385 ACRES PAGE 1. INFO DATE 01/20/2000  
TAX NAME 2001: CORPORATION OF PRESIDING BISHOP OF LDS CHURCH  
PROP. ADDRESS: 1100 WEST ANTELOPE DRIVE LAYTON

E 1570666 B 2607 P 142

LEGAL DESCRIPTION:

BEG 680.74 FT N OF N LN OF A STR & ON E LN OF ANOTHER STR, AT APT N 0°14'30"E 71  
3.74 FT ALG W LN OF SEC & E 33.0 FT FROM SW COR OF SEC 8, T4N-R1W; SLM: TH S 0°1  
4'30" W 112.0 FT ALONG E LINE OF SD STR; TH E 150.0 FT; TH N 0°14'30"E 112.0 FT;  
TH W 150.0 FT TO POB. CONT. 0.385 ACRES.

LILD LAND INDEX SYSTEM LEGAL DESCRIPTION

SERIAL# 09-036-0005 ✓ ACRES 3.4 ACRES PAGE 1. INFO DATE 01/20/2000  
TAX NAME 2001: DAVIS COUNTY HOUSING AUTHORITY  
PROP. ADDRESS: 2100 NORTH 1200 WEST LAYTON

LEGAL DESCRIPTION:

BEG ON E LINE OF STR N 0°14'30"E 713.74 FT ALG SEC LINE & E 33 FT FR SW COR SEC  
8; T4N-R1W; SLM: TH N 0°14'30"E 175 FT ALONG E LN SD STR; TH E 846.82 FT; TH S 0  
°14'30"W 175 FT; TH W 846.82 FT TO POB. CONT. 3.40 ACRES

LILD LAND INDEX SYSTEM LEGAL DESCRIPTION

SERIAL# 09-036-0006 ✓ ACRES 19.415 ACRE PAGE 1. INFO DATE 01/20/2000  
TAX NAME 2001: DAVIS COUNTY SCHOOL DISTRICT BOARD OF EDUCATION  
PROP. ADDRESS: 1100 WEST ANTELOPE DRIVE LAYTON

LEGAL DESCRIPTION:

BEG 33.0 FT N & 33.0 FT E FR SW COR OF SEC 8, T4N-R1W; SLM: E 1267.0 FT ALG N  
LN OF A ST & 33.0 FT N OF S LN SD SEC; N 0°14'30"E 680.74 FT PAR TO W LN SD SEC  
TH W 1117 FT; TH S 0°14'30"W 112 FT; TH W 150 FT; TO E LN OF A ST 33.0 FT E OF W  
LN SD SEC; TH S 0°14'30"W 568.74 FT ALG SD ST TO POB CONT. 19.415 ACRES

LILD LAND INDEX SYSTEM LEGAL DESCRIPTION

SERIAL# 09-036-0025 ✓ ACRES 1.135 ACRES PAGE 1. INFO DATE 01/20/2000  
TAX NAME 2001: BINDRUP, WILLIAM K & DRELL C-TRUSTEES-ETAL  
PROP. ADDRESS:

LEGAL DESCRIPTION:

BEG ON THE E LINE OF A STR AT A PT N 0°10'30" E 1035.54 FT ALG THE SEC LINE & S  
89°49'30" E 33.0 FT FR THE SW COR OF THE NW 1/4 OF THE SW 1/4 OF SEC 8-T4N-R1W S  
LM & RUN TH N 0°10'30" E 87.46 FT ALG SD STR; TH N'LY 90.93 FT ALG THE ARC OF A  
352.6 FT RADIUS CURVE TO THE RIGHT ALG SD STR (CHORD IS N 7°33'48" E 90.68 FT);  
TH N'LY 45.82 FT ALG THE ARC OF A 418.45 FT RADIUS CURVE TO THE LEFT ALG SD STR  
(CHORD IS N 11°48'53" E 45.79 FT); TH S 61°28'09" E 469.24 FT ALG THE S'LY LINE  
OF AMENDED LAKELAND SUBD #1 TO A PT S 89°44'28" E OF THE POB; TH N 89°44'28" W 4  
33.83 FT ALG A FENCE TO THE POB; CONT. 1.135 ACRES. SUBJ TO CANAL R/W

LILD LAND INDEX SYSTEM LEGAL DESCRIPTION

SERIAL# 09-043-0001 ✓ ACRES .194 ACRES PAGE 1. INFO DATE 01/20/2000  
TAX NAME 2001: BURTON, DUANE C  
PROP. ADDRESS: 2198 NORTH 1200 WEST LAYTON

LEGAL DESCRIPTION:

ALL OF LOT 1, DAWN DEVELOPMENT PLAT A CONT. 0.194 ACRES.

LILD LAND INDEX SYSTEM LEGAL DESCRIPTION

SERIAL# 09-043-0011 ✓ ACRES .21 ACRES PAGE 1. INFO DATE 01/20/2000  
TAX NAME 2001: TENNIS, ROBERT SCOTT & LANAE  
PROP. ADDRESS: 1188 WEST 2200 NORTH LAYTON

E 1570666 B 2607 P 143

LEGAL DESCRIPTION:  
ALL OF LOT 11, DAWN DEVELOPMENT PLAT A. CONT. 0.21 ACRES.

LILD LAND INDEX SYSTEM LEGAL DESCRIPTION

SERIAL# 09-043-0012 ✓ ACRES .207 ACRES PAGE 1. INFO DATE 01/20/2000  
TAX NAME 2001: WILSON, SCOTT D - ETAL  
PROP. ADDRESS: 2220 NORTH 1200 WEST LAYTON

LEGAL DESCRIPTION:  
ALL OF LOT 12, DAWN DEVELOPMENT PLAT A CONT. 0.207 ACRES.

LILD LAND INDEX SYSTEM LEGAL DESCRIPTION

SERIAL# 09-043-0013 ✓ ACRES .207 ACRES PAGE 1. INFO DATE 01/20/2000  
TAX NAME 2001: ROBINS, KELLY  
PROP. ADDRESS: 2234 NORTH 1200 WEST LAYTON

LEGAL DESCRIPTION:  
ALL OF LOT 13, DAWN DEVELOPMENT PLAT A. CONT. 0.207 ACRES.

LILD LAND INDEX SYSTEM LEGAL DESCRIPTION

SERIAL# 09-023-0009 ✓ ACRES 52. ACRES PAGE 1. INFO DATE 01/20/2000  
TAX NAME 2001: JOSEPH B ADAMS FAMILY INVESTMENTS LLC  
PROP. ADDRESS:

LEGAL DESCRIPTION:  
BEG SE COR OF NE1/4 OF SE1/4 OF SEC 7, 4N, 1W, SLM, N 78 RDS TO SW'LY LINE OF  
DAVIS & WEBER CO. CANAL, NW'LY ALG CANAL TO W LINE OF SE1/4 OF NE1/4, S 131 RDS,  
E 80 RDS TO BEG. CONT. 54.00 ACRES. LESS THE SD 66 FT IN 856-1024 2.00 ACRE  
S. REMAINDER 52.00 ACRES.

LILD LAND INDEX SYSTEM LEGAL DESCRIPTION

SERIAL# 09-023-0032 ✓ ACRES 2. ACRES PAGE 1. INFO DATE 01/20/2000  
TAX NAME 2001: UTAH DEPT OF TRANSPORTATION  
PROP. ADDRESS:

LEGAL DESCRIPTION:  
BEG AT THE SE COR OF SD NE1/4 SE1/4; TH W 1318.63 FT, MOL, ALG THE S LN OF SD NE  
1/4 SE1/4 TO THE W LN OF SD NE1/4 SE1/4; TH N 66 FT ALG SD W LN TO APT 33 FT PER  
D'LY DIST N'LY FR THE CENTER LN OF SD FRONTAGE ROAD AT APPROX'LY ENGINEER STATIO  
N 25+60; TH E 1318.63 FT; MOL, TO THE E LN OF SD SEC 7; T4N-R1W; SLM: BEING THE  
CENTER LN OF ANGEL STR; TH S 66 FT ALG SD E LN TO THE POB AS SHOWN ON THE OFFICI  
AL MAP OF SD PROJECT ON FILE IN THE OFFICE OF THE UTAH DEPT OF TRANSPORTATION  
CONT. 2.00 ACRES OUT OF 09-023-0009

LILD LAND INDEX SYSTEM LEGAL DESCRIPTION

SERIAL# 09-023-0025 ✓ ACRES 4.43 ACRES PAGE 1. INFO DATE 01/20/2000  
TAX NAME 2001: VAN SCHAACK HOLDINGS, LTD  
PROP. ADDRESS: 2195 NORTH 1200 WEST LAYTON

E 1570666 B 2607 P 144

LEGAL DESCRIPTION:  
BEG AT A PT N 0°11'03" E 1029.37 FT ALG SEC LINE & S 89°47' W 33 FT FROM SE COR  
SEC 7; T4N-R1W; SLM: TH N 0°11'03" E 291.45 FT; TH S 89°47' W 661.58 FT; TH S 0°  
11'03" W 291.45 FT; TH N 89°47' E 661.58 FT TO POB. CONT. 4.43 ACRES

LILD LAND INDEX SYSTEM LEGAL DESCRIPTION

SERIAL# 09-023-0026 ✓ ACRES 4.43 ACRES PAGE 1. INFO DATE 01/20/2000  
TAX NAME 2001: VAN SCHAACK HOLDINGS LTD  
PROP. ADDRESS:

LEGAL DESCRIPTION:  
BEG N 0°11'03" E 737.92 FT ALONG SEC LN & S 89°47' W 33 FT FROM SE CORNER SEC 7;  
T4N-R1W; SLM: TH N 0°11'03" E 291.45 FT TH S 89°47' W 661.58 FT; TH S 0°11'03"  
W 291.45 FT; TH N 89°47' E 661.58 FT TO POB. CONT. 4.43 ACRES

LILD LAND INDEX SYSTEM LEGAL DESCRIPTION

SERIAL# 09-023-0056 ✓ ACRES .83 ACRES PAGE 1. INFO DATE 01/20/2000  
TAX NAME 2001: VAN SCHAACKK HOLDINGS, LTD  
PROP. ADDRESS:

LEGAL DESCRIPTION:  
BEG AT A PT N 0°11'03" E 683.25 FT ALG SEC LINE & S 89°47' W 33 FT FR SE COR OF  
SEC 7-T4N-R1W SLM; TH N 0°11'03" E 54.67 FT; TH S 89°47' W 661.58 FT; TH S 0°11'  
'03" W 54.67 FT M/L TO N'LY LINE OF PPTY CONV IN 1453-122; TH N 89°47' E 661.58  
FT M/L TO POB. CONT. 0.830 ACRES. (WENT TO 09-023-0057)

LILD LAND INDEX SYSTEM LEGAL DESCRIPTION

SERIAL# 09-023-0057 ✓ ACRES 5.973 ACRES PAGE 1. INFO DATE 01/20/2000  
TAX NAME 2001: IHC HOSPITALS, INC (DBA) MCKAY DEE HOSPITAL  
PROP. ADDRESS:

LEGAL DESCRIPTION:  
BEG AT THE NW COR OF THE INTERSEC OF 1200 W & 2000 N STRS; SD PT BEING N 00°11'0  
3" E ALG THE SEC LN 66.00 FT & S 89°47'00" W 33.00 FT FR THE SE COR OF SEC 7-T4N  
-R1W, SLM, & RUN TH S 89°47'00" W ALG THE N R/W LN OF 2000 N STR 167.15 FT TO TH  
E E'LY LN OF STATE ROAD COMM PPTY; TH N 03°36'39" W ALG SD E'LY LN 11.13 FT TO A  
PT OF A CURVE TO THE LEFT THE RADIUS PT BEING N 89°53'58" W 223.62 FT; TH NW'LY  
ALG THE ARC OF SD CURVE & E'LY LN THRU A CENTRAL ANGLE OF 54°20'02" A DISTANCE  
OF 212.06 FT TO A PT OF TANGENCY; TH N 54°14' W ALG SD E'LY LN 492.06 FT; TH N 0  
°11'03" E 134.83 FT; TH N 89°47' E 661.58 FT TO THE W LN OF 1200 W STR; TH S 0°1  
1'03" W ALG SD W LN 617.25 FT TO THE POB. CONT. 5.973 ACRES.

LILD

LAND INDEX SYSTEM

LEGAL DESCRIPTION

SERIAL# 09-023-0068 / ACRES .84 ACRES PAGE 1. INFO DATE 01/20/2000  
TAX NAME 2001: IHC HEALTH SERVICES INC  
PROP. ADDRESS:

E 1570666 B 2607 P 145

LEGAL DESCRIPTION:

A TRACT OF LAND SITUATE IN THE SE1/4 SE1/4 OF SEC 7-T4N-R1W, SLM; THE BNDRY OF S D TRACT OF LAND DESC AS FOLLOWS: BEG AT THE SE COR OF SD ENTIRE TRACT AT A PT 6 6 FT N 0^11'03" E & 198 FT S 89^47' W FR THE SE COR OF SD SEC 7, DESIGNATED AS P T "A" & RUN TH N 63^18'19" W 159.77 FT TO THE NE'LY R/W & NO-ACCESS LINE OF THE RAMP OF A FREEWAY KNOWN AS INTERSTATE 15; TH ALG SD NE'LY R/W & NO-ACCESS LINE T HE FOLLOWING TWO (2) COURSES: (1) NW'LY 235.06 FT ALG THE ARC OF A 233.62 FT RA DIUS CURVE TO THE LEFT (NOTE: CHORD FOR SD CURVE BEARS N 28^43'30" W 225.27 FT); (2) N 57^33' W 287.41 FT DESIGNATED AS PT "C"; TH N 0^11'03" E 59.32 FT; TH ALG SD NE'LY BNDRY LINE THE FOLLOWING THREE (3) COURSES: (1) S 54^14' E 492.06 FT; (2) S'LY 214.77 FT ALG THE ARC OF A 226.48 FT RADIUS CURVE TO THE RIGHT (NOTE: CHORD FOR SD CURVE BEARS S 27^04'00" E 206.81 FT; (3) S 0^06' W 11.09 FT TO THE POB. CONT. 0.84 ACRES

LILD

LAND INDEX SYSTEM

LEGAL DESCRIPTION

SERIAL# 09-023-0066 / ACRES .99 ACRES PAGE 1. INFO DATE 01/20/2000  
TAX NAME 2001: STATE ROAD COMM OF UTAH  
PROP. ADDRESS:

LEGAL DESCRIPTION:

A PARCEL OF LAND FOR A NORTH BOUND ON-RAMP & ADJACENT FRONTAGE RD INCIDENT TO CO NST OF SYRACUSE RD INTERCHANGE, IN SE 1/4 SE 1/4 OF SEC 7-T4N-R1W, SLM; BNDY DES C AS FOLLOWS: BEG IN N'LY R/W LINE OF SYRACUSE ROAD AT A PT APPROX 200.71 FT W & 33 FT N FR SE COR OF SD SEC 7, TH N 83^25'27" W 195.57 FT ALG SD N'LY R/W LINE OF SYRACUSE ROAD TO AN E'LY R/W LINE OF AN EXIST FRONTAGE ROAD; TH N 15^15'57" W 144.55 FT ALG SD E'LY R/W LINE OF SD EXIST FRONTAGE ROAD TO A PT ANGLING TO LE FT; TH N 47^28'27" W 356.80 FT ALG A NE'LY R/W LINE OF SD EXIST FRONTAGE ROAD TO W LINE OF SD ENTIRE TRACT; TH N 0^11'03" E 8.21 FT, MOL, ALG SD W LINE TO NW CO R OF SD ENTIRE TRACT; TH N 89^47' E 72.90 FT ALG N LINE OF SD ENTIRE TRACT; TH S 57^33' E 201.82 FT TO A PT ON A 233.62 FT RADIUS CURVE TO THE RIGHT 235.06 FT (LC BEARS S 28^43'30" E 225.27 FT), TH S 63^18'19" E 159.77 FT; TH S 3^36'39" E 32.37 FT TO POB. CONT. 0.99 ACRES STATE ROAD PARCEL NO 15-7:4:A

LILD

LAND INDEX SYSTEM

LEGAL DESCRIPTION

SERIAL# 09-289-0001 / ACRES . ACRES PAGE 1. INFO DATE 01/20/2000  
TAX NAME 2001: SPRING CREEK DEVELOPMENT CORP  
PROP. ADDRESS: 1181 WEST 2300 NORTH LAYTON

LEGAL DESCRIPTION:

ALL OF LOT 1, SPRING CREEK PRUD.

LILD

LAND INDEX SYSTEM

LEGAL DESCRIPTION

SERIAL# 09-289-0007 / ACRES . ACRES PAGE 1. INFO DATE 01/20/2000  
TAX NAME 2001: SPRING CREEK DEVELOPMENT CORP  
PROP. ADDRESS: 2309 NORTH 1175 WEST LAYTON

LEGAL DESCRIPTION:

ALL OF LOT 7, SPRING CREEK PRUD.

LILD	LAND INDEX SYSTEM	LEGAL DESCRIPTION
SERIAL# 09-289-0008 ✓	ACRES . ACRES	PAGE 1. INFO DATE 01/20/2000
TAX NAME 2001: SPRING CREEK DEVELOPMENT CORP		
PROP. ADDRESS: 2315 NORTH 1175 WEST LAYTON		
LEGAL DESCRIPTION:		E 1570666 B 2607 P 146
ALL OF LOT 8, SPRING CREEK PRUD.		

LILD	LAND INDEX SYSTEM	LEGAL DESCRIPTION
SERIAL# 09-289-0051 ✓	ACRES 6.75 ACRES	PAGE 1. INFO DATE 01/20/2000
TAX NAME 2001: SPRING CREEK OWNERS' ASSOCIATION		
PROP. ADDRESS:		
LEGAL DESCRIPTION:		
COMMON AREA AS DEFINED BY THE PLAT OF SPRING CREEK PRUD, RECORDED 4-7-1999 AS E# 1502679, BK 2478, PG 214. CONT. 6.75 ACRES		

LILD	LAND INDEX SYSTEM	LEGAL DESCRIPTION
SERIAL# 09-281-0001 ✓	ACRES 5.28 ACRES	PAGE 1. INFO DATE 01/20/2000
TAX NAME 2001: CORP OF PRESIDING BISHOP OF LDS CHURCH		
PROP. ADDRESS: 2402 NORTH 1200 WEST (ANGEL STREET) LAYTON		
LEGAL DESCRIPTION:		
ALL OF LOT 1, ROBINS ESTATES SUBD. CONT. 5.28 ACRES		

LILD	LAND INDEX SYSTEM	LEGAL DESCRIPTION
SERIAL# 09-281-0004 ✓	ACRES 1.14 ACRES	PAGE 1. INFO DATE 01/20/2000
TAX NAME 2001: ROBINS, KELLY		
PROP. ADDRESS: 2246 NORTH 1200 WEST (ANGEL STREET) LAYTON		
LEGAL DESCRIPTION:		
ALL OF LOT 4, ROBINS ESTATES SUBD. CONT. 1.14 ACRES		