

When Recorded Return To:  
Mr. Woodrow S. Mickelsen, Manager  
Salt Lake County Sewerage  
Improvement District No. 1  
930 East 12400 South  
Draper, UT 84020

Page 1 of 4

4356533

EASEMENT

For the sum of One Dollar (\$1.00) and other good and valuable consideration, the receipt and sufficiency of which is hereby acknowledged, the undersigned GRANTORS hereby grant, convey, sell, and set over unto the Salt Lake County Sewerage Improvement District No. 1, a body politic of the State of Utah, hereinafter referred to as GRANTEE, its successors and assigns, a perpetual right-of-way and easement to lay, maintain, operate, repair, inspect, protect, install, remove and replace sewer pipelines, manholes, laterals and other sewer collection and transmission structures and facilities, hereinafter called Facilities, said right-of-way and easement being situated in Salt Lake County, State of Utah over and through a parcel of the GRANTOR'S land lying within a strip twenty (20) feet wide, said strip extending ten (10) feet on each side of and laying parallel and adjacent to a line of reference and projection thereof, more particularly described as follows:

Beginning at a point located 1315 feet south along the west section line from the West 1/4 corner of Section 9, T.3S., R.1W., SLB&M and running thence East 5.00 feet; thence S. 74° 52' 34" E. 38.32 feet; thence east parallel to and 5 feet south of the North line of the South half of the South West 1/4 of said section, 1604.2 feet; thence N. 57° 43' 28" E. 41.2 feet to an existing sewer manhole on the Utah Lake Distributing Canal Right-of-way.

Contains: 0.77 acres, more or less.

TO HAVE AND TO HOLD the same unto the said GRANTEE, its successors and assigns, so long as such Facilities shall be maintained, with the right of ingress and egress in said Grantee, its officers, employees, representatives, agents, and assigns to enter upon the above described property with such equipment as is necessary to install, maintain, operate, repair, inspect, protect, remove and replace said Facilities. During construction periods, GRANTEE and its agents may use such portion of Grantors property along and adjacent to said right-of-way as may be reasonably necessary in connection with the construction or repair of said Facilities. The contractor performing the work shall restore all property through which the work traverses, to as near its original condition as is reasonably possible. GRANTORS shall have the right to use said premises except for the purpose for which this right-of-way and easement is granted to the said GRANTEE, provided such use shall not interfere with the Facilities or with the collection and conveyance of sewage through said Facilities, or any other rights granted to the GRANTEE hereunder.

GRANTORS shall not build or construct or permit to be built or constructed, any building or other improvement over or across said right-of-way nor change the contour thereof without the written consent of GRANTEE. This right-of-way and easement grant shall be binding upon and inure to the benefit of the successors and assigns of the GRANTORS and the successors and assigns of the GRANTEE, and may be assigned in whole or in part by GRANTEE.

dsk: TLA77

8054  
5045  
7102  
658

IN WITNESS WHEREOF, the GRANTORS have executed this right-of-way and easement this 6<sup>th</sup> day of November, 1986.

County Parcel Number

27-09-300-001  
27-09-300-010

Acreage

0.25±AC  
0.05±AC

Grantors

Tateoka Farms ~~Inc~~

By: Tateoka Farms  
Its Matt Tateoka

STATE OF UTAH )  
                                  : SS  
COUNTY OF SALT LAKE )

On the 6<sup>th</sup> day of November, 1986, personally appeared before me, Matt Tateoka, the signers of the above instrument, who duly acknowledged to me they executed the same.

Notary Public  
Residing in Salt Lake City, Utah

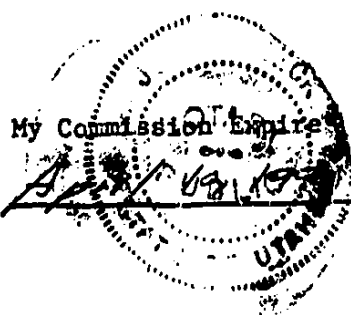

Mrs  
Jee  
NOV 26 3 59 AM '86  
Salt Lake County  
REC OF  
\$ \_\_\_\_\_ DEPT. OF \_\_\_\_\_  
Sewerage  
KATIE L. DIXON  
RECORDER  
SALT LAKE COUNTY,  
UTAH  
BOB 5845 PACE 659

RECEIVED

JUL 28 1986

Templeton, Link & Associates

Page 3 of 4

IN WITNESS WHEREOF, the GRANTORS have executed this right-of-way and easement this

25 day of July, 1986.

County Parcel Number

27-09-300-002

Acreage

0.35±AC

Grantors

Jim Tateoka  
Jim Tateoka

Ko T. Tateoka  
Ko T. Tateoka

STATE OF ~~UTAH~~ Idaho )

: ss

COUNTY OF ~~SALT LAKE~~ )

Minidoka

On the 25th day of July, 1986, personally appeared before me,

\_\_\_\_\_, the signers of the above instrument,  
who duly acknowledged to me they executed the same.

Eldora Richman  
Notary Public  
Residing in ~~Salt Lake City, Utah~~  
Rupert, Idaho

My Commission Expires 8-1-88



BOOK 5845 PAGE 650

IN WITNESS WHEREOF, the GRANTORS have executed this right-of-way and easement this 2nd day of October, 1986.

County Parcel Number  
27-09-300-019

Acreage  
0.12±AC

Grantors  
Dell Wheadon  
Dell Wheadon  
Norma A. Wheadon  
Norma A. Wheadon

STATE OF UTAH )  
                  : ss  
COUNTY OF SALT LAKE )

On the 2nd day of October, 1986, personally appeared before me, Dell Wheadon & Norma A. Wheadon the signers of the above instrument, who duly acknowledged to me they executed the same.

Marjorie G. [Signature]  
Notary Public  
Residing in Salt Lake City, Utah

My Commission Expires  
March 1, 1990

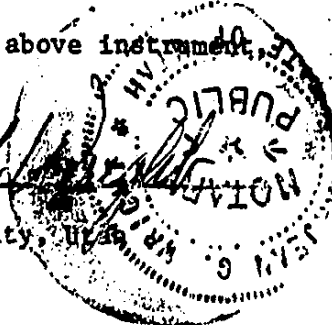

BOOK 5845 PAGE 661

WEST 1/4 CORNER  
SECTION 9, T3S., R.1W.,  
SALT LAKE BASE & MERIDIAN

1320.0'

27-09-300-001  
TATEOKA FARMS, INC.

NO. LINE OF SO. 1/2 OF  
SOUTHWEST 1/4 OF  
SECTION 9, T3S., R.1W., SLB&M  
1604.2'

POINT OF  
BEGINNING

SEE DETAIL  
THIS SHEET

SANITARY SEWER

264.0'

WEST SECTION LINE  
SOUTH 1315.0'

3200 WEST STREET

27-09-300-001  
TATEOKA  
FARMS, INC.

27-09-300-002  
TATEOKA, JIM & KO T.

WEST SECTION LINE

**DETAIL**

NO SCALE

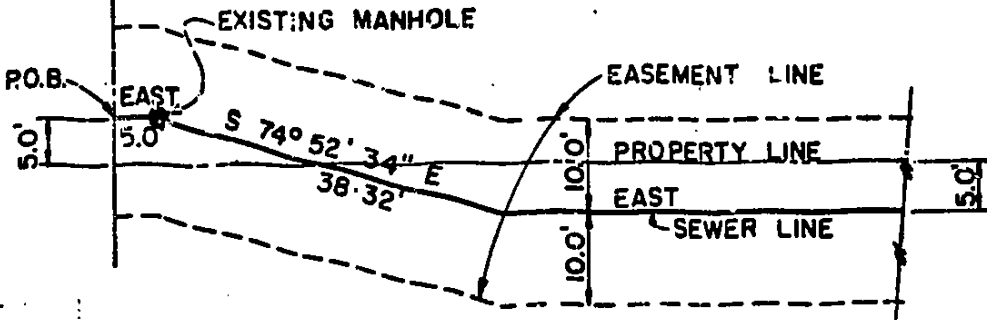

27-09-300-010  
TATEOKA FARMS, INC.

N.57°43'28"E. 41.2'

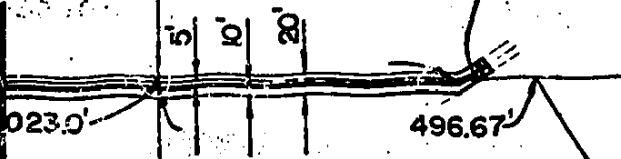

27-09-300-019  
WHEADON, DELL & NORMA A.

N

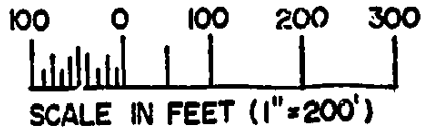

BODY 5845 PAGE 623

5					
4					
3					
2					
1					
NO	DATE	REVISION	BY	CHK	APP

SALT LAKE COUNTY  
SEWERAGE IMPROVEMENT DIST. NO. 1  
SEWAGE COLLECTION SYSTEM  
SANITARY SEWER EASEMENT  
10,000 SQ.-3000 W. TO 3200 W.

TEMPLETON, LINKE & ASSOCIATES  
CONSULTING ENGINEERS 20 West 200 South Salt Lake City, Utah 84115 Tel: (801) 466-9127

DESIGNER HR	CHECKED	DRAWING NUMBER 2
DATE JULY, 1986	APPROVED	FILE NUMBER 128-28-8