



**EXHIBIT "A"**  
**EAST SIDE OF RIVER ROAD PERPETUAL SLOPE EASEMENT**

Beginning at a point on the easterly right-of-way line of River Road approximately 25 feet northwesterly of intersecting point of River Road and the south line of Section 32, Township 42 South, Range 15 West, SLB&M and running thence northwesterly along said easterly right-of-way line of River Road 960 feet to a point approximately 985 feet northwesterly from said south line of section 32. Said point being the terminating point of this easement.

**WEST SIDE OF RIVER ROAD RIGHT-OF-WAY  
PERPETUAL SLOPE EASEMENT**

Beginning at a point on the south line of Section 32, Township 42 south, Range 15 West SLB&M where the section line and the west right-of-way line of River Road intersect and running thence northwesterly along said west right-of-way line 178 feet to the north end of area number 1; thence beginning area number 2 at a point northwesterly 217 feet from said intersecting point; thence northwesterly 105 feet along said west right-of-way line to a point 322 feet north of said intersecting point being the end of area number 2; thence beginning at a point northwesterly 635 feet from said intersecting point being the beginning of area number 3; thence northwesterly 752 feet along said right-of-way line to a point 1,387 feet from the section line intersecting point and the end of area number 3 being the terminating point of this easement.

SECTION LINE

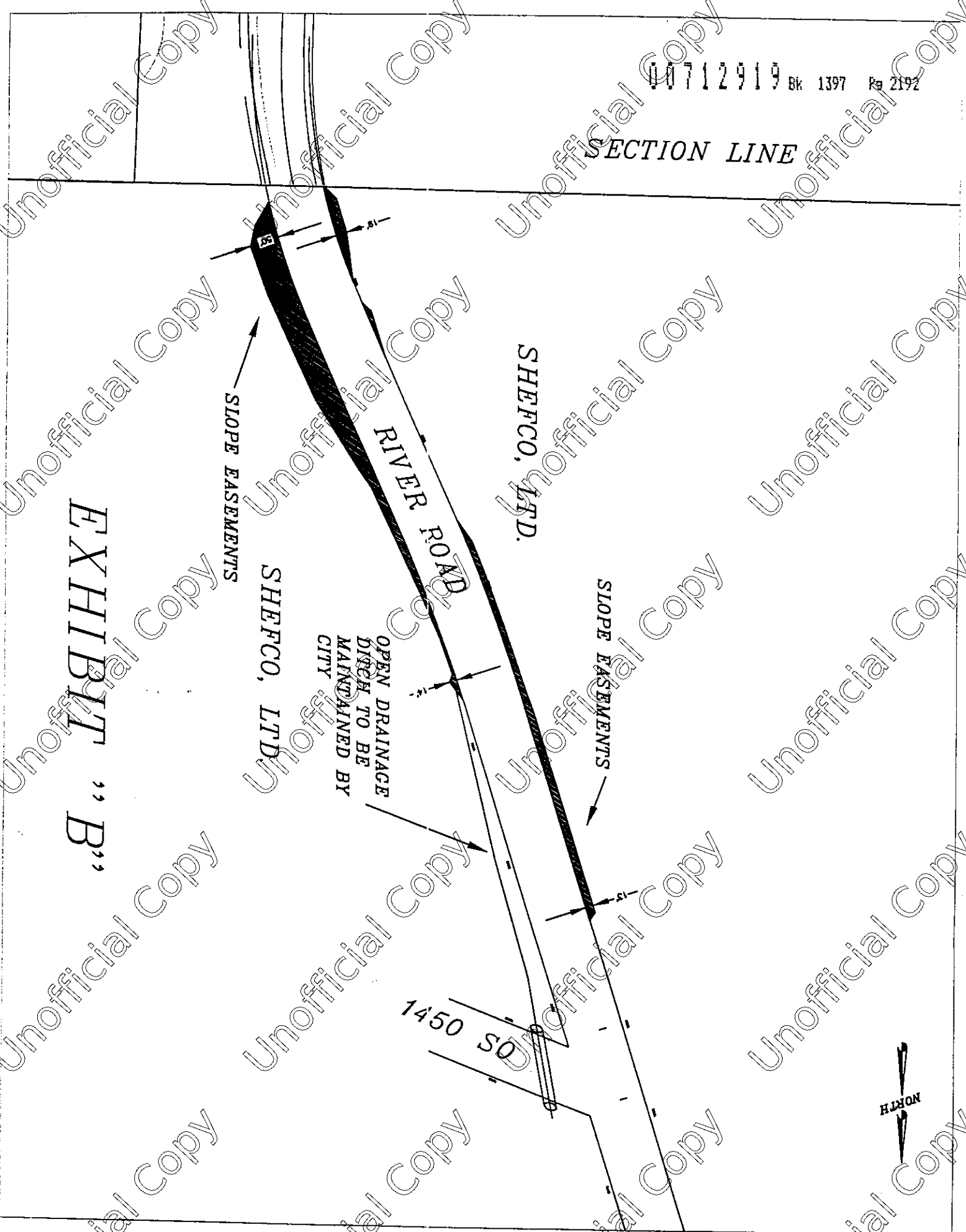

EXHIBIT "B"

Unofficial Copy