

4

When Recorded Return to:  
Mr. Craig L. White  
South Valley Sewer District  
P.O. Box 629  
Riverton, UT 84065

13832895  
11/24/2021 01:35 PM \$0.00  
Book - 11274 Pg - 204-207  
RASHELLE HOBBS  
RECORDER, SALT LAKE COUNTY, UTAH  
SOUTH VALLEY SEWER DISTRICT  
PO BOX 629  
RIVERTON UT 84065  
BY: ZHA, DEPUTY - WI 4 P.

PARCEL I.D.# 28-30-401-044-0000  
GRANTOR: DRAPER SCHOOL DEVELOPMENT, LLC  
(Rasmussen Family Farms Subdivision)  
Page 1 of 4

## EASEMENT

A twenty (20) foot wide sanitary sewer easement located in the Southeast Quarter of Section 30, Township 3 South, Range 1 East, Salt Lake Base and Meridian, U.S. Survey.

For the sum of One Dollar (\$1.00) and other good and valuable consideration, the receipt and sufficiency of which is hereby acknowledged, the undersigned as GRANTORS hereby grant, convey, sell, and set over unto South Valley Sewer District, a body politic of the State of Utah, hereinafter referred to as GRANTEE, its successors and assigns, a perpetual right-of-way and easement to construct, maintain, operate, repair, inspect, protect, install, remove and replace sewer pipelines, valves, valve boxes and other sewer transmission and distribution structures and facilities, hereinafter called the FACILITIES, said right-of-way and easement, being situate in Salt Lake County, State of Utah, over and through a parcel(s) of the GRANTORS' land lying within a strip twenty (20) feet wide, more particularly described as follows:

See Exhibit "A" attached hereto and by this reference made a part hereof.

Contains: 14,989 square feet or 0.344 acres

TO HAVE AND HOLD the same unto the GRANTEE, its successors and assigns, with the right of ingress and egress in the GRANTEE, its officers, employees, agents and assigns to enter upon the above-described property with such equipment and vehicles as is necessary to construct, install, maintain, operate, repair, inspect, protect, remove and replace the FACILITIES. During construction periods, GRANTEE and its contractors may use such portion of GRANTORS' property along and adjacent to the right-of-way and easement as may be reasonably necessary in connection with the construction or repair of the FACILITIES. The contractor performing the work shall restore all property, through which the work traverses, to as near its original condition as is reasonably possible. GRANTORS shall have the right to use the above-described property except for the purposes for which this right-of-way and easement is granted to the GRANTEE, provided such use shall not interfere with the FACILITIES or with the discharge and conveyance of sewage through the FACILITIES, or any other rights granted to the GRANTEE hereunder.

GRANTORS shall not build or construct, or permit to be built or constructed, any building or other



## Exhibit 'A'

### 20' Sanitary Sewer Easement #1 (12200 South Street)

A part of the Southeast Quarter of Section 30, Township 3 South, Range 1 East, Salt Lake Base and Meridian, U.S. Survey, Draper City, Salt Lake County, Utah

Beginning at a point which is 2266.95 feet North 0°03'00" West along the Quarter Section line and 80.00 feet North 89°57'00" East from the South Quarter corner of said Section 30: running thence North 55°49'49" East 4.36 feet; thence North 89°56'54" East 88.06 feet; thence North 0°03'00" West 22.99 feet; thence North 89°57'11" East 20.00 feet; thence South 0°03'00" East 22.98 feet; thence North 89°57'05" East 122.06 feet; thence South 62°17'21" East 108.85 feet; thence South 36°32'33" East 103.22 feet; thence North 38°49'21" East 23.10 feet to a point of curvature; thence 21.57 feet Southeasterly along the arc of a 167.00 foot Radius curve to the left through a Delta Angle of 7°24'01", and Long Chord of South 29°16'57" East 21.55 feet (Center bears North 64°25'03" East); thence South 38°49'21" West 19.21 feet; thence South 43°49'46" East 90.56 feet; thence South 80°14'01" East 100.94 feet; thence South 0°01'04" East 20.30 feet; thence North 80°14'01" West 98.28 feet; thence South 13°18'53" West 22.72 feet to a point of curvature; thence 20.49 feet Northwesterly along the arc of a 233.00 foot Radius curve to the right through a Delta Angle of 5°02'18", and Long Chord of North 64°13'08" West 20.48 feet (Center bears North 23°15'43" East); thence North 13°18'53" East 22.25 feet; thence North 43°49'46" West 97.83 feet; thence North 36°32'33" West 112.23 feet; thence North 62°17'21" West 99.34 feet; thence South 89°57'05" West 118.30 feet; thence South 08°13'22" West 23.27 feet; thence South 89°57'00" West 20.21 feet; thence North 08°13'22" East 23.27 feet; thence South 89°56'54" West 80.52 feet; thence South 55°49'49" West 17.64 feet to a point of curvature; thence 28.02 feet Northerly along the arc of a 80.00 foot Radius curve to the left through a Delta Angle of 20°03'53", and Long Chord of North 9°58'39" East 27.87 feet (Center bears North 69°59'24" West) to the point of beginning.

Contains: 14,989 sq.ft. or 0.344 acres

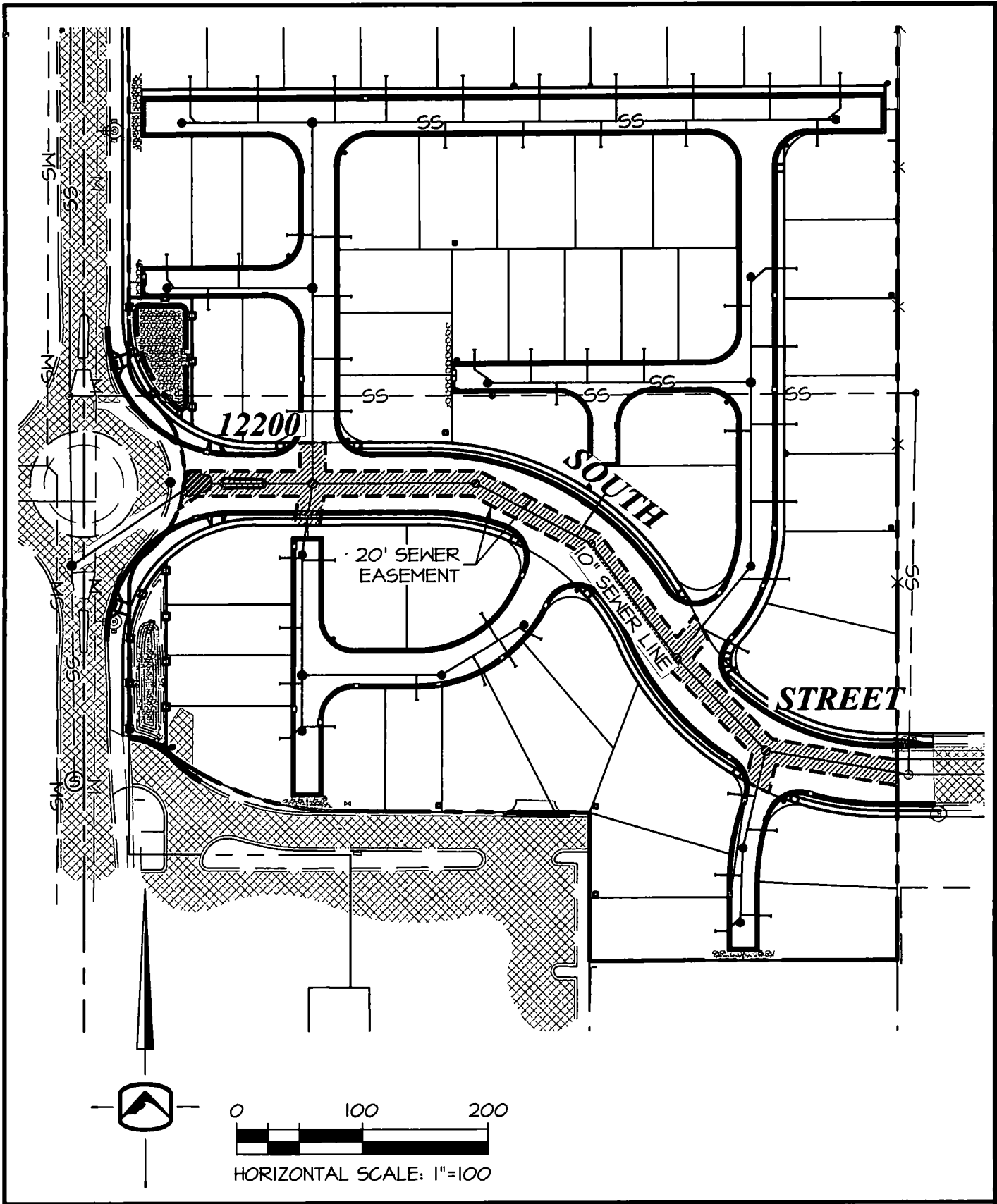

**SILVERPEAK**  
ENGINEERING



177 E. ANTELOPE DR. STE. B  
LAYTON, UT 84041  
PHONE: (801) 499-5054

STRUCTURAL CIVIL SURVEY WWW.SILVERPEAKENG.COM

**RASMUSSEN FARMS**  
12230 SOUTH 300 EAST  
DRAPER, UT

SEWER  
EASEMENT #1 EXHIBIT

DATE: 10/19/2021  
PROJECT: AW-058  
DRAWN BY: JTF