

LEGEND

- FOUND BRASS CAP
- FOUND 1/2" IRON PIN
- SET 1/2" X 24" IRON PIN WITH PLASTIC CAP, LS 333098
- △ CALCULATED POINT NOT SET
- PROPERTY BOUNDARY
- - - CENTERLINE
- - - LOT LINE
- - - SECTION LINE
- ① LOT NUMBER
- - - EASEMENT
- (708.00') GRID DIST.

CURVE DATA:

CURVE	RADIUS	LENGTH	CHORD	BEARING	DELTA
C-1	367.00'	110.26'	109.85'	N81°15'29"W	171°2'51"
C-2	367.00'	145.97'	145.01'	N61°15'24"W	224°7'18"
C-3	367.00'	176.45'	174.76'	N12°11'02"W	27°32'52"
C-4	25.00'	32.95'	30.61'	N53°50'12"E	75°30'25"
C-5	55.00'	5.28'	5.28'	N18°50'01"E	95°30'03"
C-6	55.00'	151.60'	107.97'	N79°27'22"W	157°53'49"
C-7	55.00'	45.32'	44.06'	S23°07'02"W	47°13'00"
C-8	367.00'	256.23'	251.06'	N69°51'57"W	40°00'09"

STATE PLANE COORDINATE TABLE

POINT	X	Y
A	1922160.05	739301.32
B	1922570.65	739297.34
C	1922569.31	739139.71
D	1922835.28	739138.77
E	1922824.23	737633.72
F	1922694.81	737634.02
G	1922459.16	737720.41
H	1922375.14	737791.25
I	1922390.10	738330.22
J	1921764.12	738347.59
K	1921727.24	738518.37
L	1921729.80	738610.57
M	1922437.33	738590.93
N	1922451.26	739092.81
O	1922158.39	739100.74
P	1922820.64	737944.07

SURVEYOR'S CERTIFICATE
 I, GARY W. WIER DO HEREBY CERTIFY THAT I AM A REGISTERED LAND SURVEYOR, AND THAT I HOLD CERTIFICATE NO. 333098 AS PRESCRIBED UNDER THE LAWS OF THE STATE OF UTAH, I FURTHER CERTIFY BY AUTHORITY OF THE OWNERS, I HAVE MADE A SURVEY OF THE TRACT OF LAND SHOWN ON THIS PLAT AND DESCRIBED BELOW, AND HAVE SUBDIVIDED SAID TRACT OF LAND INTO LOTS, BLOCKS, STREETS, AND EASEMENTS AND THE SAME HAS BEEN CORRECTLY SURVEYED AND STAKED ON THE GROUND AS SHOWN ON THIS PLAT AND THAT THIS IS TRUE AND CORRECT.

BOUNDARY DESCRIPTION
 COMMENCING NORTH 44.88 FEET AND EAST 662.99 FEET FROM THE N 1/4 OF SECTION 25 TOWNSHIP 5 SOUTH, RANGE 1 EAST, S1&B&M, UTAH COUNTY, UTAH, THENCE AS FOLLOWS:

COURSE	DISTANCE	REMARKS
S 89°26'40" E	410.73'	ALONG THE NORTH PROPERTY LINE
S 00°29'07" W	157.67'	TO THE NE CORNER OF LOT 32, PLAT G, UTAH VALLEY BUSINESS PARK SUBDIVISION
S 89°47'45" E	266.04'	TO THE NORTHEAST CORNER OF PROPERTY
S 00°42'08" W	1195.11'	TO THE NE CORNER OF LOT 32, PLAT G, UTAH VALLEY BUSINESS PARK SUBDIVISION
S 00°39'46" E	310.47'	ALONG THE BOUNDARY OF SAID LOT 32
N 89°52'00" W	129.46'	TO THE BEGINNING OF A CURVE TO THE RIGHT
ALONG ARC OF CURVE	256.23'	CHORD BEARS N 89°51'57" W 251.06 FEET
N 49°51'53" W	109.93'	TO THE NE CORNER OF LOT 34, PLAT H, UTAH VALLEY BUSINESS PARK SUBDIVISION
N 01°35'24" E	539.32'	TO A POINT ON A CURVE TO THE RIGHT
N 88°24'36" W	626.39'	ALONG ARC OF CURVE
ALONG ARC OF CURVE	176.45'	CHORD BEARS N 12°11'02" W 174.76 FEET
N 01°35'24" E	92.27'	TO THE SE CORNER OF LOT 3, PLAT F, UTAH VALLEY BUSINESS PARK SUBDIVISION
S 88°24'36" E	708.00'	ALONG THE BOUNDARY OF SAID LOT 3
N 01°35'24" E	502.01'	ALONG THE BOUNDARY OF SAID LOT 3
N 88°24'36" W	293.05'	TO THE REAL POINT OF BEGINNING
N 00°28'08" E	200.64'	TO THE REAL POINT OF BEGINNING

CONTAINS 19.912 ACRES MORE OR LESS
 (BASIS OF BEARING UTAH STATE PLANE COORDINATE SYSTEM, CENTRAL ZONE)

3-9-99 DATE
 Gary W. Wier SURVEYOR (SEE SEAL BELOW)

OWNER'S DEDICATION
 KNOW ALL MEN BY THESE PRESENTS THAT WE, ALL OF THE UNDERSIGNED OWNERS OF ALL OF THE PROPERTY DESCRIBED IN THE SURVEYOR'S CERTIFICATE HEREON AND SHOWN ON THIS MAP AND SUBJECT TO ANY CONDITIONS AND RESTRICTIONS STATED HEREON, HAVE CAUSED THE SAME TO BE SUBDIVIDED INTO LOTS, BLOCKS, STREETS AND EASEMENTS AND DO HEREBY DEDICATE THE STREETS AND OTHER PUBLIC AREAS AS INDICATED HEREON FOR PERPETUAL USE OF THE PUBLIC.

IN WITNESS WHEREOF WE HAVE HEREUNTO SET OUR HANDS THIS 10TH DAY OF MARCH A.D. 1999
 NORTH VALLEY INVESTMENT GROUP L.C. Division of Fossil Labs
 Michael Ford, Manager of W. Richards Woodbury, Manager
 T. MICHAEL FORD STATE OF UTAH COUNTY OF UTAH S.S.
 W. RICHARDS WOODBURY

ACCEPTANCE BY LEGISLATIVE BODY
 ON THE 10TH DAY OF MARCH A.D. 1999, PERSONALLY APPEARED BEFORE ME THE SIGNERS OF THE FOREGOING DEDICATION WHO DULY ACKNOWLEDGE TO ME THAT THEY DID EXECUTE THE SAME.
 MY COMMISSION EXPIRES MARCH 28, 2002
 Notary Public (SEE SEAL BELOW)

BOARD OF HEALTH
 APPROVED SUBJECT TO THE FOLLOWING CONDITIONS:
 CITY-COUNTY HEALTH DEPARTMENT

FIRE MARSHAL
 APPROVED SUBJECT TO THE FOLLOWING CONDITIONS:
 FIRE MARSHAL

PLANNING COMMISSION APPROVAL
 APPROVED THIS 17 DAY OF February, A.D. 1999, BY THE American Fork PLANNING COMMISSION.
 Rick M. All Director-Secretary
 J. S. S. Chairman, PLANNING COMMISSION

CONDITIONS OF APPROVAL

AMENDED PLAT 'J'
UTAH VALLEY BUSINESS PARK
 AMMEND LOT 36 PLAT 'H' & LOT 32 PLAT 'G' (ADDITIONAL AREA ADDED)

ENT 826-01 Map # 7254
 RANDALL A. COVINGTON
 UTAH COUNTY RECORDER
 1999 Mar 11 1:44 PM FEE 36.00 BY 55
 RECORDED FOR AMERICAN FORK CITY

HUBBLE ENGINEERING, INC.
 ENGINEERING-SURVEYING-PLANNING

1471 N. 1200 W.
 OREM, UTAH 84057
 (801) 802-8992

HE CIVIL ENGINEERS AND SURVEYORS

7954-92

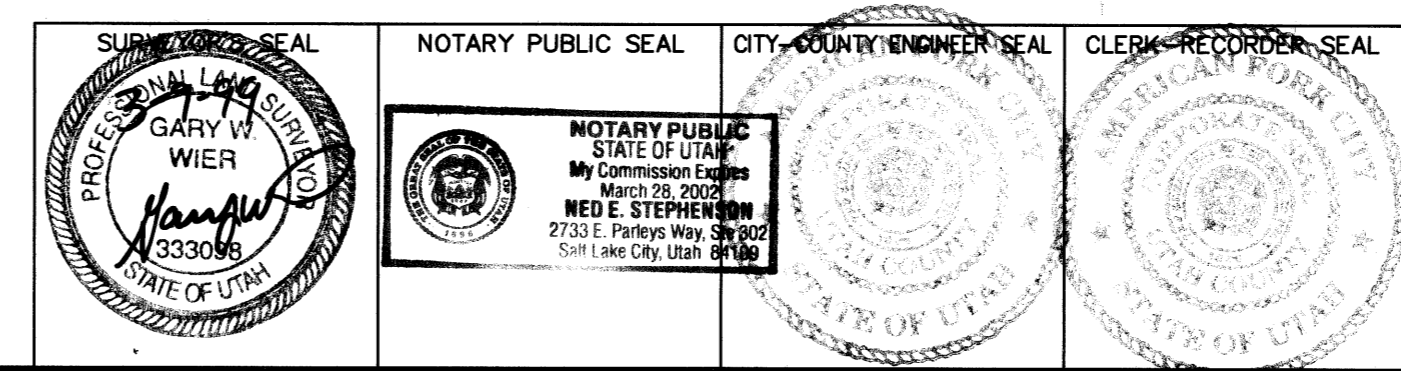

UTAH VALLEY BUSINESS PARK J
 79-060 O.K.T.W.O