

LOT 3 AMENDED
WESTLAKES BUSINESS PARK

589.50' 10" W - 679.20'

LOT 6B
2490 SOUTH
AREA = 378,986.444 SQ. FT.
OR 8.40 ACRES

LOT 6A
2338 SOUTH
AREA = 130,658.388 SQ. FT.
OR 3.00 ACRES

LOT 2 WESTLAKES
BUSINESS PARK

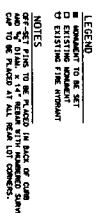
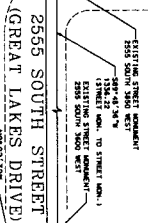

BRK&G ENGINEERING INC.
1425 WEST 202 NORTH
SALT LAKE CITY, UT 84119
801.324.9271 FAX 801.324.9271

PLANNING COMMISSION
APPROVED THIS 28th DAY OF APRIL, 1992, BY THE WEST VALLEY CITY PLANNING COMMISSION.

WEST VALLEY CITY ENGINEERING DIVISION
APPROVED THIS 28th DAY OF APRIL, 1992, BY THE WEST VALLEY CITY ENGINEERING DIVISION.

BOARD OF HEALTH
APPROVED THIS 28th DAY OF APRIL, 1992, BY THE BOARD OF HEALTH.

LANDMARK DISTRICT
APPROVED THIS 28th DAY OF APRIL, 1992, BY THE LANDMARK DISTRICT.

APPROVAL AS TO FORM
APPROVED AS TO FORM THIS 28th DAY OF APRIL, 1992, BY THE CITY CLERK.

WEST VALLEY CITY COMMISSION
APPROVED TO THE WEST VALLEY CITY COMMISSION THIS 28th DAY OF APRIL, 1992, BY THE WEST VALLEY CITY COMMISSION.

RECORDED AT 6:43:33 AM
STATE OF UTAH, COUNTY OF SALT LAKE, RECORD AND FILED AT THE REGISTER OF DEEDS, SALT LAKE COUNTY, UTAH.

WESTLAKES BUSINESS PARK & LOT 6, AMENDED AND CREATING LOTS 6A & 6B
LOCATED IN THE SOUTHWEST 1/4 OF SECTION 20, TOWNSHIP 1 SOUTH, RANGE 1 WEST, SALT LAKE MERIDIAN, WEST VALLEY CITY, UTAH

SUBJECT'S DESCRIPTION
THE PROPERTY DESCRIBED IN THE SUPERIOR CERTIFICATE HEREON AND BOOK SHEETS AND EASEMENTS TO BE HEREON SHOWN AS THE SUBJECT OF THIS MAP IS THE PROPERTY DESCRIBED IN THE SUPERIOR CERTIFICATE HEREON AND BOOK SHEETS AND EASEMENTS TO BE HEREON SHOWN AS THE SUBJECT OF THIS MAP.

OWNER'S DECLARATION
I, the undersigned owner of the property described in the Superior Certificate hereon and book sheets and easements to be hereon shown as the subject of this map, do hereby certify that I am the owner of the property described in the Superior Certificate hereon and book sheets and easements to be hereon shown as the subject of this map, and that I am the owner of the property described in the Superior Certificate hereon and book sheets and easements to be hereon shown as the subject of this map, and that I am the owner of the property described in the Superior Certificate hereon and book sheets and easements to be hereon shown as the subject of this map.

WESTLAKES BUSINESS PARK & LOT 6, AMENDED AND CREATING LOTS 6A & 6B
A ZONE RECLASSIFICATION
A ZONE RECLASSIFICATION
A ZONE RECLASSIFICATION

CORPORATE ACKNOWLEDGMENT
STATE OF UTAH, COUNTY OF SALT LAKE, CITY OF WEST VALLEY, UTAH, I, the undersigned, do hereby certify that I am the president of the corporation named herein, and that I am duly qualified to execute this instrument on behalf of the corporation.

DRAWING NUMBER 97-0367
DRAWING NUMBER
DRAWING NUMBER