



ENT 24625:2019 PG 1 of 6
JEFFERY SMITH
UTAH COUNTY RECORDER
2019 Mar 26 3:03 pm FEE 1057.00 BY MA
RECORDED FOR LEHI CITY CORPORATION

When Recorded Return To:

Mark B. Durrant, Esq.
Dorsey & Whitney LLP
111 South Main Street, Suite 2100
Salt Lake City, UT 84101

FIRST AMENDMENT TO AGREEMENT

THIS FIRST AMENDMENT TO AGREEMENT (this "**First Amendment**") is made and entered into by and between LEHI CITY, a municipality and political subdivision of the State of Utah ("**City**"), and GARDNER-PLUMB, L.C., a Utah limited liability company ("**Developer**"), collectively the "**Parties.**"

RECITALS:

A. City and Developer previously entered into that certain Agreement (the "**Agreement**") dated as of March 24, 2015 and recorded on April 20, 2015 in the Office of the Utah County Recorder as Entry #32455:2015.

B. City and Developer desire to amend the Agreement, as hereinafter set forth.

AGREEMENT:

NOW, THEREFORE, for good and valuable consideration, the receipt and sufficiency of which are hereby acknowledged, the Parties agree as follows:

1. **Modification of Project Plan.** The Exhibit B attached to the Agreement is hereby replaced and superceded by the Exhibit B attached to this First Amendment. In addition, Sections 3.b. and 3.c. of the Agreement are hereby deleted in their entirety and replaced with the following:

"b. The Amended Project Plan also specifies: i) the zoning designation for each parcel within the project (collectively the "Project"); ii) that the total number of ERUs that maybe constructed for the south portion of the Property is 1,733 ERUs; and iii) that the total number of ERUs that may be constructed for the north portion of the Property is 200 ERUs.

c. If Developer constructs less than the maximum number of ERUs per acre within a given zoning designation on the south portion of the Property, those ERUs may be transferred by Developer to another area within the south portion of the Property, even if it exceeds the maximum density allowed under the existing zoning for said area within the south portion of the Property. In no event may Developer transfer any excess ERUs outside the south portion of the Property. The intent of the parties is that 1,733 ERUs are either constructed on the south portion of the Property or are forfeited."

2. **Capitalized Terms.** Any capitalized term not defined herein shall have the same meaning as set forth in the Agreement.

3. **Effective Date.** The "Effective Date" of this First Amendment shall be the later of the following dates: (1) the date of City's signature; or (2) the date of Developer's signature.

4. **Counterparts and Electronic Signatures.** This First Amendment may be executed in one or more counterparts, each of which shall be deemed an original, but all of which together shall constitute one and the same instrument. In addition, if any party uses facsimile-transmitted signed documents, or signed documents which have been electronically scanned and transmitted by email, the other party is authorized to rely upon such documents as if they bore original signatures.

[Signature Page to Follow]

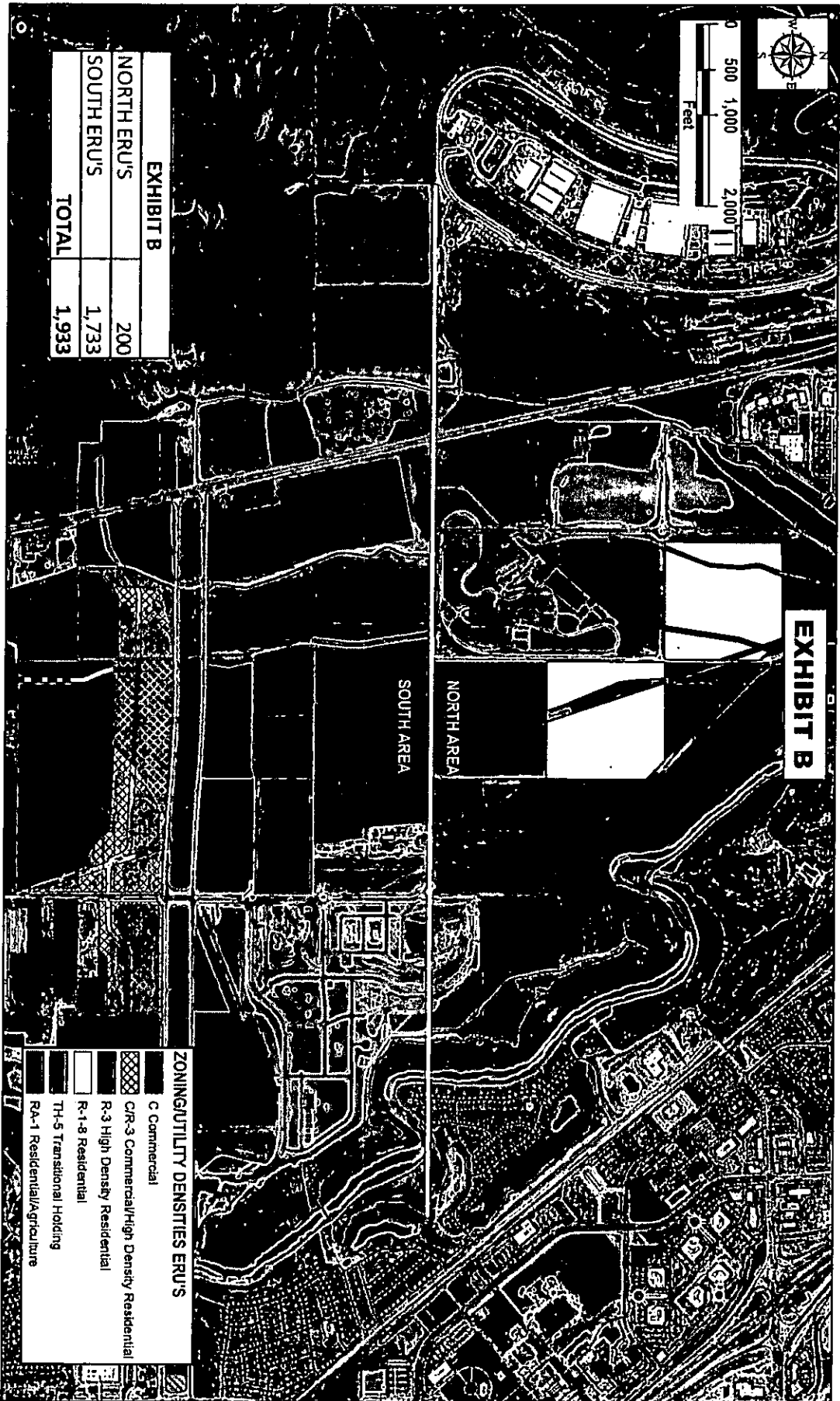

EXHIBIT B

SOUTH AREA

NORTH AREA

EXHIBIT B	
NORTH ERUS	200
SOUTH ERUS	1,733
TOTAL	1,933

ZONING/UTILITY DENSITIES ERUS

[Symbol: Solid black]	C Commercial
[Symbol: Cross-hatch]	C/R-3 Commercial/High Density Residential
[Symbol: Horizontal lines]	R-3 High Density Residential
[Symbol: Vertical lines]	R-1-8 Residential
[Symbol: Diagonal lines /]	TH-5 Transitional Holding
[Symbol: Diagonal lines \]	RA-1 Residential/Agriculture

EXHIBIT "A" CONTINUED

LEGAL DESCRIPTIONS

Parcel 58:021:0072 Legal Description: COM S 585.11 FT FR W 1/4 COR. SEC. 2, T5S, R1W, SLB&M.; S 0 DEG 0' 1" W 484.5 FT; E 249.99 FT; S 250.03 FT; N 89 DEG 59' 58" E 294.46 FT; N 24 DEG 43' 38" W 67.42 FT; N 23 DEG 16' 43" W 90.72 FT; N 29 DEG 23' 33" W 54.07 FT; N 32 DEG 6' 29" W 52.9 FT; N 38 DEG 38' 53" W 161.88 FT; N 45 DEG 21' 15" W 52.85 FT; N 39 DEG 6' 30" W 56.56 FT; N 35 DEG 16' 39" W 55.71 FT; N 39 DEG 53' 46" W 107.09 FT; N 37 DEG 13' 58" W 54.84 FT; N 35 DEG 17' 17" W 54.1 FT; N 45 DEG 36' 32" W 53.04 FT; N 52 DEG 44' 17" W 49.92 FT; N 47 DEG 18' 8" W 11.48 FT TO BEG. AREA 3.752 AC.

Parcel 58:021:0097 Legal Description: COM S 391.48 FT FR W 1/4 COR. SEC. 2, T5S, R1W, SLB&M.; E 811.02 FT; S 14 DEG 5' 8" E 957.3 FT; W 499.38 FT; N 24 DEG 43' 38" W 67.82 FT; N 23 DEG 16' 43" W 90.72 FT; N 29 DEG 23' 33" W 54.07 FT; N 32 DEG 6' 29" W 52.9 FT; N 38 DEG 38' 53" W 161.88 FT; N 45 DEG 21' 15" W 52.85 FT; N 39 DEG 6' 30" W 56.56 FT; N 35 DEG 16' 39" W 55.71 FT; N 39 DEG 53' 46" W 107.09 FT; N 37 DEG 13' 58" W 54.84 FT; N 35 DEG 17' 17" W 54.1 FT; N 45 DEG 36' 32" W 53.04 FT; N 52 DEG 44' 17" W 49.92 FT; N 47 DEG 18' 8" W 11.48 FT; N 193.63 FT TO BEG. AREA 14.579 AC.

Parcel 58:021:0099 Legal Description: COM AT NW COR. SW 1/4 OF SEC. 2, T5S, R1W, SLB&M.; E 683.69 FT; S 33 DEG 34' 32" E 38.72 FT; S 12 DEG 1' 37" E 367.3 FT; W 781.64 FT; N 391.48 FT TO BEG. AREA 6.645 AC.

Parcel 58:021:0096 Legal Description: COM S .01 FT & E 831.32 FT FR W 1/4 COR. SEC. 2, T5S, R1W, SLB&M.; E 67.6 FT; S 0 DEG 1' 59" W 10.82 FT; S 38 DEG 58' 57" W 21.74 FT; S 11 DEG 57' 56" E 166.18 FT; S 8 DEG 37' 19" E 64.62 FT; S 89 DEG 31' 48" E 243.83 FT; N 85 DEG 57' 52" E 326.8 FT; E 144 FT; N 85 DEG 11' 0" E 178.63 FT; S 31 FT; E 100 FT; N 86 DEG 38' 1" E 408.7 FT; S 89 DEG 7' 18" E 310.86 FT; S 1090.05 FT; W 1493.68 FT; N 13 DEG 25' 19" W 1357.06 FT TO BEG. AREA 40.536 AC.

Parcel 58:021:0162 Legal Description: COM N 660 FT & W 18.01 FT FR SE COR. SEC. 2, T5S, R1W, SLB&M.; W 10.58 FT; N 0 DEG 9' 7" W 667.47 FT; N 0 DEG 3' 28" W 436.8 FT; W 704.69 FT; S 89 DEG 59' 53" W 127.56 FT; S 32 DEG 30' 18" W 28.45 FT; S 48 DEG 49' 17" W 225.18 FT; S 21 DEG 18' 49" W 269.97 FT; S 19 DEG 42' 33" W 104.04 FT; S 14 DEG 48' 54" W 56.86 FT; S 13 DEG 11' 2" W 76.5 FT; S 19 DEG 10' 50" W 63.52 FT; S 14 DEG 1' 27" W 81.45 FT; S 22 DEG 15' 26" W 41.33 FT; S 29 DEG 53' 29" W 33.75 FT; S 34 DEG 7' 10" W 77.16 FT; S 26 DEG 38' 13" W 110.94 FT; S 27 DEG 45' 12" W 94.41 FT; W 1216.92 FT; N 1754.7 FT; N 87 DEG 30' 4" E 251.69 FT; ALONG A CURVE TO R (CHORD BEARS: S 87 DEG 19' 19" E 1164.51 FT, RADIUS = 14819.5 FT) ARC LENGTH = 1164.81 FEET; ALONG A CURVE TO L (CHORD BEARS: S 86 DEG 29' 9" E 750.09 FT, RADIUS = 15180.5 FT) ARC LENGTH = 750.17 FEET; S 84 DEG 31' 31" E 141.64 FT; ALONG A CURVE TO L (CHORD BEARS: S 88 DEG 51' 51" E 227.64 FT, RADIUS = 15189.5 FT) ARC LENGTH = 227.64 FEET; S 43 DEG 22' 11" E 70.88 FT; N 89 DEG 17' 29" E 37.73 FT; S 0 DEG 7' 51" E 1596.01 FT TO BEG. AREA 73.856 AC.

Parcel 58:021:0089 Legal Description: COM N 0 DEG 7' 6" W 660 FT & W 27.23 FT FR SE COR. SEC. 2, T5S, R1W, SLB&M.; W 1394.47 FT; N 27 DEG 45' 12" E 94.41 FT; N 26 DEG 38' 13" E 110.94 FT; N 34 DEG 7' 10" E 77.16 FT; N 29 DEG 53' 29" E 33.75 FT; N 22 DEG 15' 26" E 41.33 FT; N 14 DEG 1' 27" E 81.45 FT; N 19 DEG 10' 50" E 63.52 FT; N 13 DEG 11' 2" E 76.5 FT; N 14 DEG 48' 54" E 56.86 FT; N 19 DEG 42' 33" E 104.04 FT; N 21 DEG 18' 33" E 269.98 FT; N 48 DEG 49' 17" E 225.18 FT; N 32 DEG 30' 18" E 28.45 FT; N 89 DEG 59' 53" E 127.56 FT; S 0 DEG 3' 27" E 428.57 FT; S 89 DEG 19' 48" E 704.75 FT; S 0 DEG 9' 7" E 667.47 FT TO BEG. AREA 22.103 AC.

Parcel 58:020:0223 Legal Description: COM S 405.46 FT & E 17.11 FT FR W 1/4 COR. SEC. 1, T5S, R1W, SLB&M.; S 0 DEG 7' 51" E 901.52 FT; E 9.76 FT; N 0 DEG 15' 52" W 242.01 FT; N 89 DEG 52' 54" E 871.17 FT; S 0 DEG 15' 52" E 243.81 FT; E 420.74 FT; N 960.58 FT; W 1209.73 FT; S 43 DEG 8' 15" W 82.18 FT; N 88 DEG 37' 44" W 37.83 FT TO BEG. AREA 23.768 AC.

Parcel 58:020:0191 Legal Description: COM N 19.87 FT & E 1320.01 FT FR W 1/4 COR. SEC. 1, T5S, R1W, SLB&M.; N 426.29 FT; S 67 DEG 50' 0" W 1105.97 FT; E 123.97 FT; S 87 DEG 7' 18" E 179.23 FT; E 721.25 FT TO BEG. AREA 5.073 AC.

Parcel 58:021:0121 Legal Description: COM N 89.93 FT & W 1321.91 FT FR E 1/4 COR. SEC. 2, T5S, R1W, SLB&M.; ALONG A CURVE TO L (CHORD BEARS: N 87 DEG 36' 10" W 1171.75 FT, RADIUS = 15185.48 FT); N 89 DEG 48' 50" W 104.23 FT; N 8 DEG 0' 0" E 254.73 FT; N 13 DEG 0' 0" W 277.2 FT; E 1301.85 FT; S 571.7 FT TO BEG. AREA 15.626 AC.

Parcel 58:021:0157 Legal Description: COM S 1320 FT & W 13.49 FT FR NE COR. SEC. 2, T5S, R1W, SLB&M.; S 0 DEG 7' 51" E 660 FT; W 1308.02 FT; N 660 FT; E 1306.51 FT TO BEG. AREA 19.796 AC.

Parcel 58:005:0061 Legal Description: COM N 1332.64 FT & E 4.1 FT & S 89 DEG 59' 4" E 16.44 FT FR S 1/4 COR. SEC. 35, T4S, R1W, SLB&M.; N 0 DEG 10' 26" E 1327.73 FT; N 89 DEG 48' 57" E 1160.78 FT; S 45 DEG 59' 0" E 199.06 FT; S 0 DEG 9' 24" W 1193.5 FT; N 89 DEG 59' 4" W 1304.7 FT TO BEG. AREA 39.580 AC. ALSO COM N 2663.95 FT & E 1328.92 FT FR S 1/4 COR. SEC. 35, T4S, R1W, SLB&M.; N 89 DEG 56' 32" W 71.41 FT; S 45 DEG 59' 0" E 99.03 FT; N 0 DEG 9' 24" E 68.74 FT TO BEG. AREA 0.056 AC. TOTAL AREA 39.636 AC.

CONTINUED**LEGAL DESCRIPTIONS**

Parcel 58:005:0049 Legal Description: COM S 1454.23 FT & E 2653.82 FT FR NW COR. SEC. 35, T4S, R1W, SLB&M.; ALONG A CURVE TO L (CHORD BEARS: S 38 DEG 2' 11" E 310.23 FT, RADIUS = 1146.4 FT); S 45 DEG 59' 0" E 1342.87 FT; S 89 DEG 48' 57" W 1152.64 FT; N 1085.63 FT; N 41 DEG 30' 3" W 6.78 FT; N 0 DEG 10' 24" E 90.46 FT TO BEG. AREA 14.860 AC.

Parcel 58:005:0050 Legal Description: COM S 1298.38 FT & E 2654.29 FT FR NW COR. SEC. 35, T4S, R1W, SLB&M.; S 89 DEG 54' 16" E 917.33 FT; S 30 DEG 56' 19" E 308.52 FT; S 44 DEG 45' 0" E 1017.86 FT; S 35 DEG 42' 28" E 425.62 FT; N 89 DEG 56' 32" W 811.6 FT; N 45 DEG 59' 0" W 1394.81 FT; ALONG A CURVE TO R (CHORD BEARS: N 35 DEG 35' 32" W 389.05 FT, RADIUS = 1095.92 FT); N 0 DEG 10' 24" E 48.23 FT TO BEG. AREA 28.149 AC.

Parcel 58:005:0044 Legal Description: COM S 1460.94 FT & E 2535.38 FT FR NW COR. OF SEC. 35, T4S, R1W, SLB&M.; S 41 DEG 30' 0" E 128.5 FT; S 0 DEG 10' 31" W 1084.2 FT; S 89 DEG 48' 57" W 315.3 FT; N 8 DEG 21' 0" E 844.59 FT; N 17 DEG 47' 0" E 363.1 FT TO BEG. AREA 5.909 AC.

Parcel 58:005:0043 Legal Description: COM S 1314.14 FT & E 1317.81 FT FR NW COR. OF SEC. 35, T4S, R1W, SLB&M.; N 89 DEG 15' 53" E 1075.57 FT; S 41 DEG 30' 0" E 147.24 FT; S 17 DEG 47' 0" W 402.19 FT; S 8 DEG 21' 0" W 852.16 FT; S 89 DEG 48' 57" W 929.66 FT; N 0 DEG 7' 46" E 1331.48 FT TO BEG. AREA 31.639 AC.