

# MAP OF

# ASBURY PARK

# ADDITION

# SALT LAKE CITY, UTAH.

Scale 100 feet to an inch

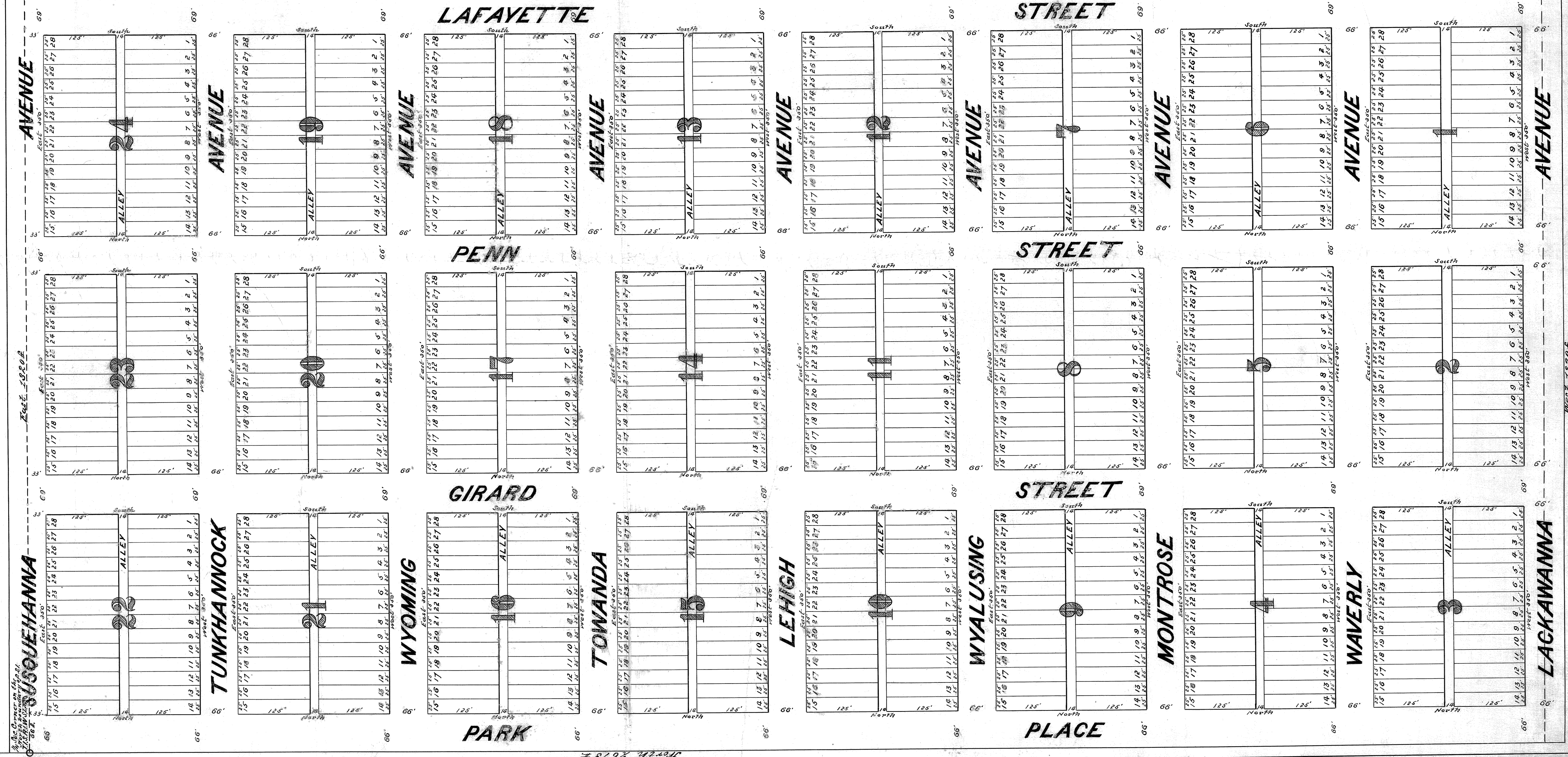
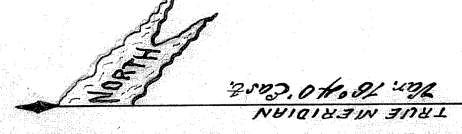

Asbury Park

West Park City, Utah  
 August 28th, 1890  
 I, Charles C. Burt, a Civil Engineer and Surveyor  
 residing in West Park City, Utah Territory, do hereby  
 certify that the above entitled "Map of Asbury Park  
 Addition to West Park City, Utah," being a map  
 of a block of ground situated in the West 1/2 of the  
 North East 1/4 of Section 21 Township 1 South Range  
 1 East of West 1st Meridian and containing an  
 area of 81 Acres is correctly made from an actual  
 survey made by me and others correctly  
 the actual connection of said plat with the  
 Townships 1 South Range 1 East of West 1st Meridian  
 and also with and describe, say the course of  
 ground lines and all situated by their boundaries  
 intended for Avenues, Streets, Alley, Alley, Alley, Alley,  
 -Town and other public use, together with such  
 as may be reserved for public purposes,  
 I further certify that to the best of my knowl-  
 edge and belief the above entitled "Map of Asbury  
 Park Addition to West Park City, Utah," correctly  
 and in all respects conforms with an Act of  
 the Territorial Legislature of Utah entitled, "An  
 Act concerning the laying out and platting of Cities  
 and Towns," and approved March 13th, 1890, and  
 that any person or persons with the reading of  
 this map will have no difficulty in understanding  
 the true meaning and intent of the same  
 -Signed Charles C. Burt  
 Civil Engineer & Surveyor

I, Alfred C. Alvord and Emma B. Alvord, his  
 wife of Grand Lodge County, Nebraska do  
 hereby declare that the above map entitled, "Map  
 of Asbury Park Addition to West Park City, Utah,"  
 being in the West 1/2 of the North East 1/4 of Section  
 21, Township 1 South, Range 1 East of West 1st  
 Meridian and containing an area of 81 Acres  
 shown correctly all the parcels of ground so  
 laid out and are situated by their boundaries, course  
 and extent and that they are intended for  
 Avenues, Streets, Alley, Alley and Common  
 or other public use, together with such as  
 may be reserved for public purposes in ac-  
 -cordance with an Act of the Territorial Legis-  
 -lature entitled, "A Bill concerning the laying  
 out and platting of Cities and Towns," and ap-  
 -proved March 13th, 1890.

WE have read, examined, verified and approved  
 the same and we by these presents do cer-  
 -tify, attest, ratify, approve, declare and  
 publish the above map as our act and deed  
 in witness whereof we have hereunto set our  
 hands and seals and the seal of the County  
 of Grand Lodge, Nebraska, this 1st day of  
 September, 1890.  
 Alfred C. Alvord and Emma B. Alvord his wife  
 the signers of the above instrument, who  
 duly subscribed to the same.  
 Alford C. Alvord  
 Emma B. Alvord

State of Nebraska } s.s.  
 County of Lodge }  
 I, A. D. 1890, personally appeared before  
 me the undersigned a Notary Public in and for the  
 State of Nebraska and Emma B. Alvord his wife  
 the signers of the above instrument, who  
 duly subscribed to the same.  
 Alford C. Alvord  
 Emma B. Alvord

My Commission expires  
 Oct 1st 1895.  
 Approved July 4, 1890.  
 J. M. Gardner  
 Probate Judge.

# 27 250  
 Filed April 24th 1890 at 4 pm.  
 and recorded in City Book C Page 47  
 J. M. Gardner  
 Recorder-Clerk  
 Utah

C 47